

- GENERAL NOTES
- G1. DO NOT SCALE THIS DRAWING.
- G2. ANY DIMENSIONAL DISCREPANCIES SHOULD BE NOTIFIED TO THE ENGINEER IMMEDIATELY.
- G3. ALL DIMENSIONS ARE IN METRES - (m) UNLESS NOTED OTHERWISE.
- G4. NORTH SHOWN INDICATIVE ONLY
- G5. THIS DRAWING IS TO BE READ IN CONJUNCTION WITH ALL RELEVANT; SPECIFICATIONS; DRAWINGS; DETAILS AND OTHER DESIGN INFORMATION.
- G6. ALL DRAWINGS AND WRITTEN MATERIAL CONTAINED WITHIN, CONSTITUTE ORIGINAL AND UNPUBLISHED WORK OF THE ENGINEER AND MAY NOT BE DUPLICATED, USED, REPRODUCED OR DISCLOSED WITHOUT WRITTEN CONSENT OR EXPRESS PERMISSION FROM THE ENGINEER.
- G7. ALL INFORMATION CONTAINED IN THIS DOCUMENT IS COPYRIGHT ©
- G8. THE DESIGNS ARE BASED ON ORDNANCE SURVEY MASTERMAP MAPPING. THEREFORE, ALL DIMENSIONS ARE APPROXIMATE.
- G9. PROPOSED CYCLE TRACK/ LANE WIDTHS TO BE REVIEWED ONCE TOPOGRAPHICAL SURVEY AND TRAFFIC COUNT DATA IS AVAILABLE.

- KEY
- EXISTING ROAD MARKINGS
  - PROPOSED WHITE ROAD MARKINGS
  - PROPOSED KERB REALIGNMENT
  - HMPE

- CROSS-SECTION KEY
- CYCLEWAY
  - SHARED-USE
  - BUFFER
  - VERGE
  - CARRIAGEWAY
  - PARKING
  - FOOTWAY
  - CENTRAL MEDIAN
  - BUS LANE

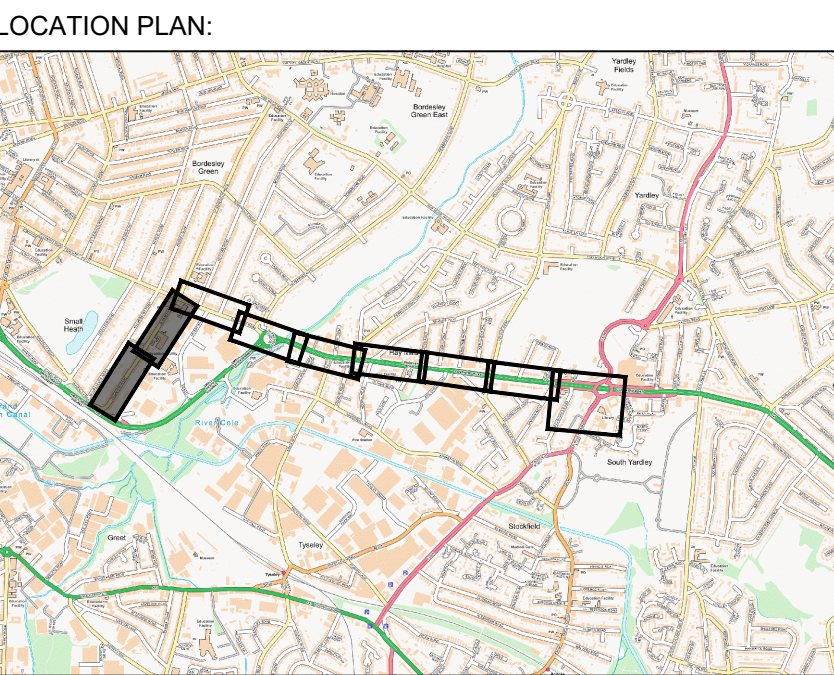

FOR INFORMATION

P03	POST DESIGN REVIEW PANEL UPDATE	DH	DH	MS	SB	25.04.25
P02	UPDATED FOLLOWING CLIENT COMMENTS	DH	DH	MS	SB	11.04.25
P01	DRAFT ISSUE	SR	SR	DH	NY	24.03.25
REV	DESCRIPTION	DRN	DES	CHK	APP	DATE

**Pell Frischmann**  
3rd FLOOR, EDMUND HOUSE, 12-22 NEWHALL STREET, BIRMINGHAM B3 3AS  
Telephone +44 (0)121 456 1616  
Email: [pf@pellfrischmann.com](mailto:pf@pellfrischmann.com)  
[www.pellfrischmann.com](http://www.pellfrischmann.com)



Project

**A45 CYCLE ROUTE  
STAGE 1**

Drawing Title

**A45 CYCLE ROUTE  
CONCEPT DESIGN  
OPTION 5 - SHEET 1 OF 5**

DRAWING STATUS			
CONCEPT			
Drawn	Name	Date	Status Code
Designed	S.RICKETT	30.04.25	S0
Eng Chk	D.HOUNSELL	30.04.25	Scale
Approved	N.YOUNG	30.04.25	Revision
Drawing No.		P03	

110171-PEF-XX- XX - DR - H -00501





Cross-section C:  
Bi-directional cycle track at back of footway

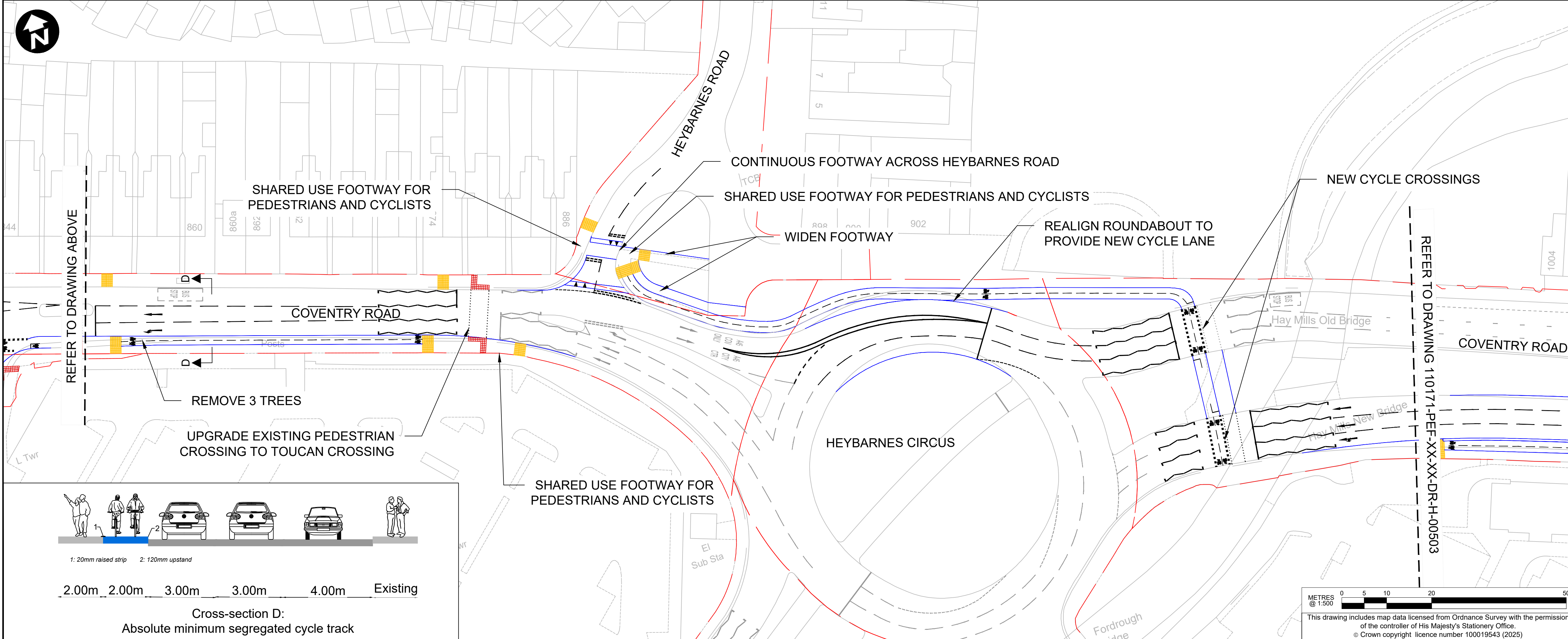

Cross-section D:  
Absolute minimum segregated cycle track

G9. PROPOSED CYCLE TRACK/ LANE WIDTHS TO BE REVIEWED ONCE TOPOGRAPHICAL SURVEY AND TRAFFIC COUNT DATA IS AVAILABLE.

110171-PEF-XX- XX - DR - H -00502



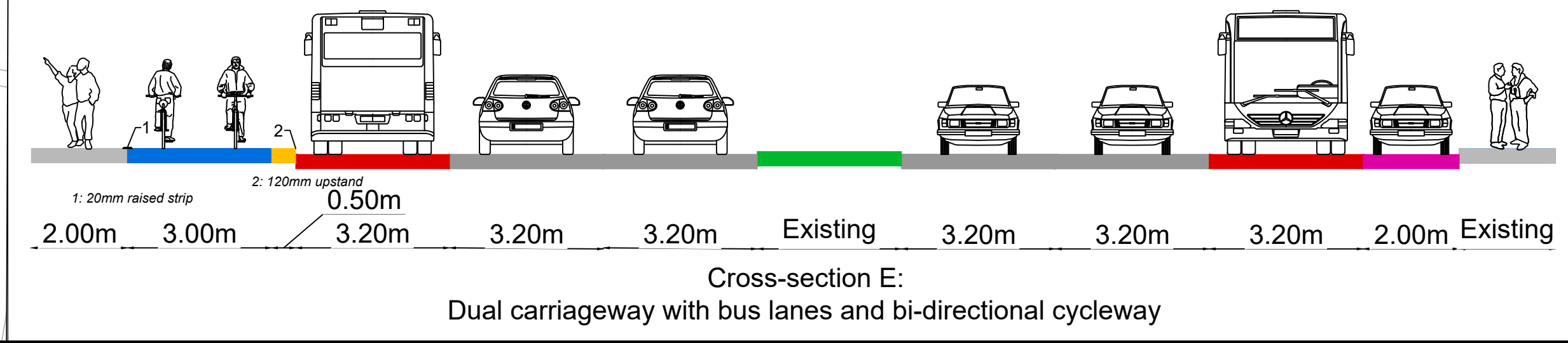
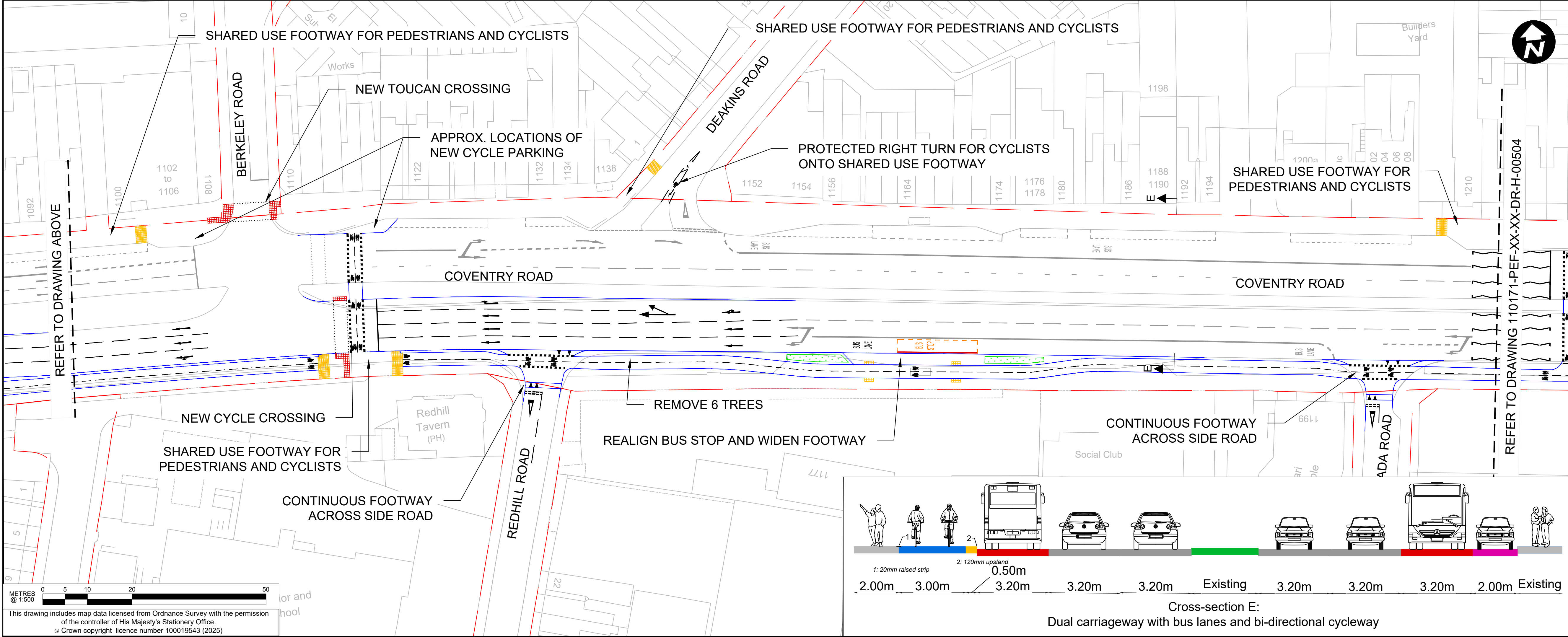
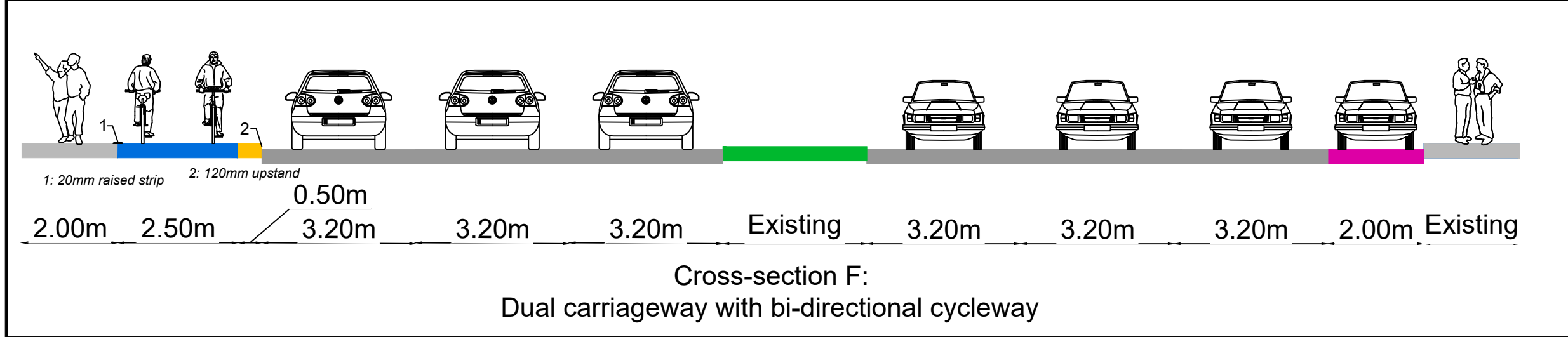
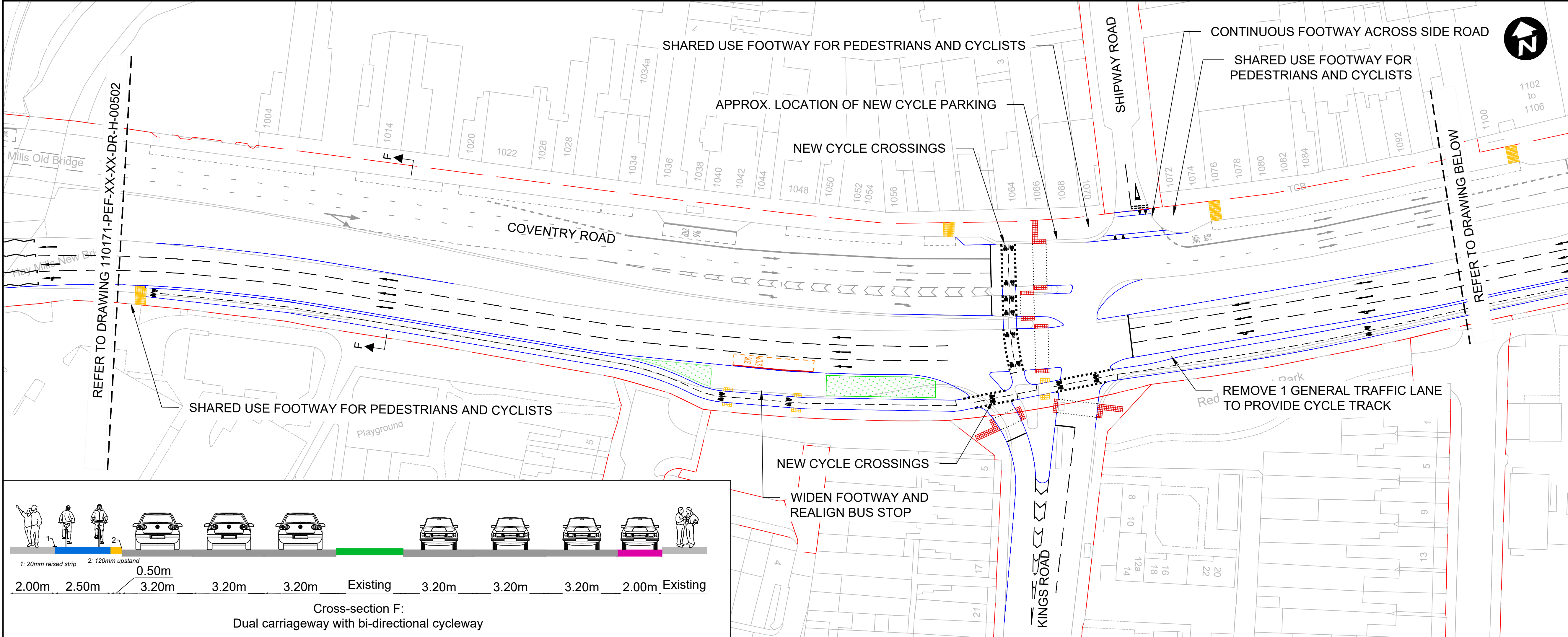

- GENERAL NOTES
- G1. DO NOT SCALE THIS DRAWING.
- G2. ANY DIMENSIONAL DISCREPANCIES SHOULD BE NOTIFIED TO THE ENGINEER IMMEDIATELY.
- G3. ALL DIMENSIONS ARE IN METRES - (m) UNLESS NOTED OTHERWISE.
- G4. NORTH SHOWN INDICATIVE ONLY
- G5. THIS DRAWING IS TO BE READ IN CONJUNCTION WITH ALL RELEVANT SPECIFICATIONS, DRAWINGS, DETAILS AND OTHER DESIGN INFORMATION.
- G6. ALL DRAWINGS AND WRITTEN MATERIAL CONTAINED WITHIN, CONSTITUTE ORIGINAL AND UNPUBLISHED WORK OF THE ENGINEER AND MAY NOT BE DUPLICATED, USED, REPRODUCED OR DISCLOSED WITHOUT WRITTEN CONSENT OR EXPRESS PERMISSION FROM THE ENGINEER.
- G7. ALL INFORMATION CONTAINED IN THIS DOCUMENT IS COPYRIGHT ©
- G8. THE DESIGNS ARE BASED ON ORDNANCE SURVEY MASTERMAP MAPPING. THEREFORE, ALL DIMENSIONS ARE APPROXIMATE.
- G9. PROPOSED CYCLE TRACK/ LANE WIDTHS TO BE REVIEWED ONCE TOPOGRAPHICAL SURVEY AND TRAFFIC COUNT DATA IS AVAILABLE.

- KEY
- EXISTING ROAD MARKINGS
  - PROPOSED WHITE ROAD MARKINGS
  - PROPOSED YELLOW ROAD MARKINGS
  - PROPOSED RED ROAD MARKINGS
  - PROPOSED KERB REALIGNMENT
  - HMPE
  - AREAS IDENTIFIED FOR LANDSCAPE IMPROVEMENTS
- CROSS-SECTION KEY
- CYCLEWAY
  - SHARED-USE
  - BUFFER
  - VERGE
  - CARRIAGEWAY
  - PARKING
  - FOOTWAY
  - CENTRAL MEDIAN
  - BUS LANE

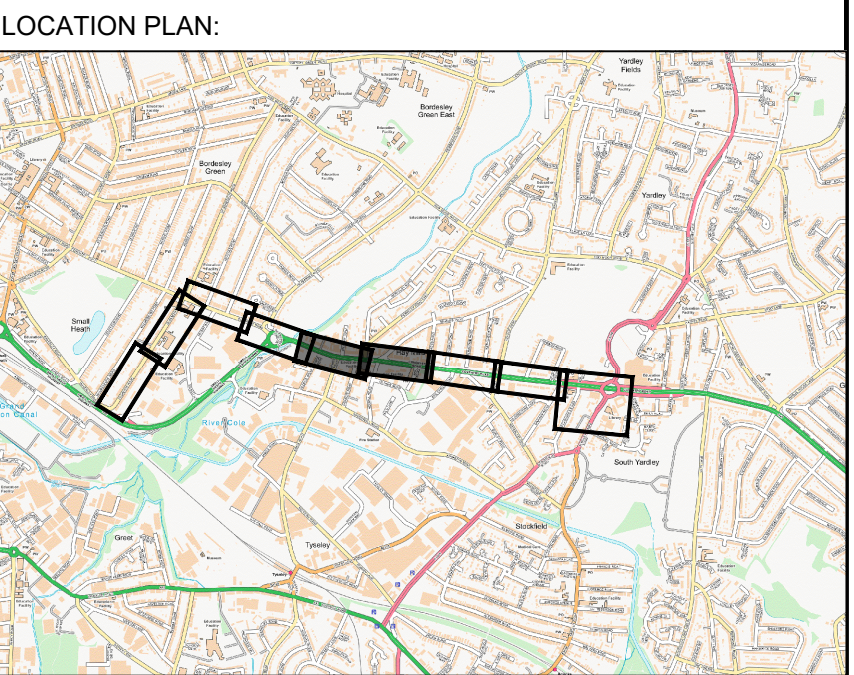

FOR INFORMATION

P03	POST DESIGN REVIEW PANEL UPDATE	DH	DH	MS	SB	25.04.25
P02	UPDATED FOLLOWING CLIENT COMMENTS	DH	DH	MS	SB	11.04.25
P01	DRAFT ISSUE	SR	SR	DH	NY	24.03.25
REV	DESCRIPTION	DRN	DES	CHK	APP	DATE

**Pell Frischmann**  
3rd FLOOR, EDMUND HOUSE, 12-22 NEWHALL STREET, BIRMINGHAM B3 3AS  
Telephone +44 (0)121 456 1616  
Email: pfbirmingham@pellfrischmann.com  
www.pellfrischmann.com



Project

**A45 CYCLE ROUTE  
STAGE 1**

Drawing Title

**A45 CYCLE ROUTE  
CONCEPT DESIGN  
OPTION 5 - SHEET 3 OF 5**

Drawing Status

CONCEPT			
Name	Date	Status Code	
Drawn	S.RICKETT	30.04.25	S0
Designed	S.RICKETT	30.04.25	Scale 1:500 @ A1
Eng Chk	D.HOUNSELL	30.04.25	Revision
Approved	N.YOUNG	30.04.25	P03

Drawing No.

**110171-PEF-XX- XX - DR - H - 00503**



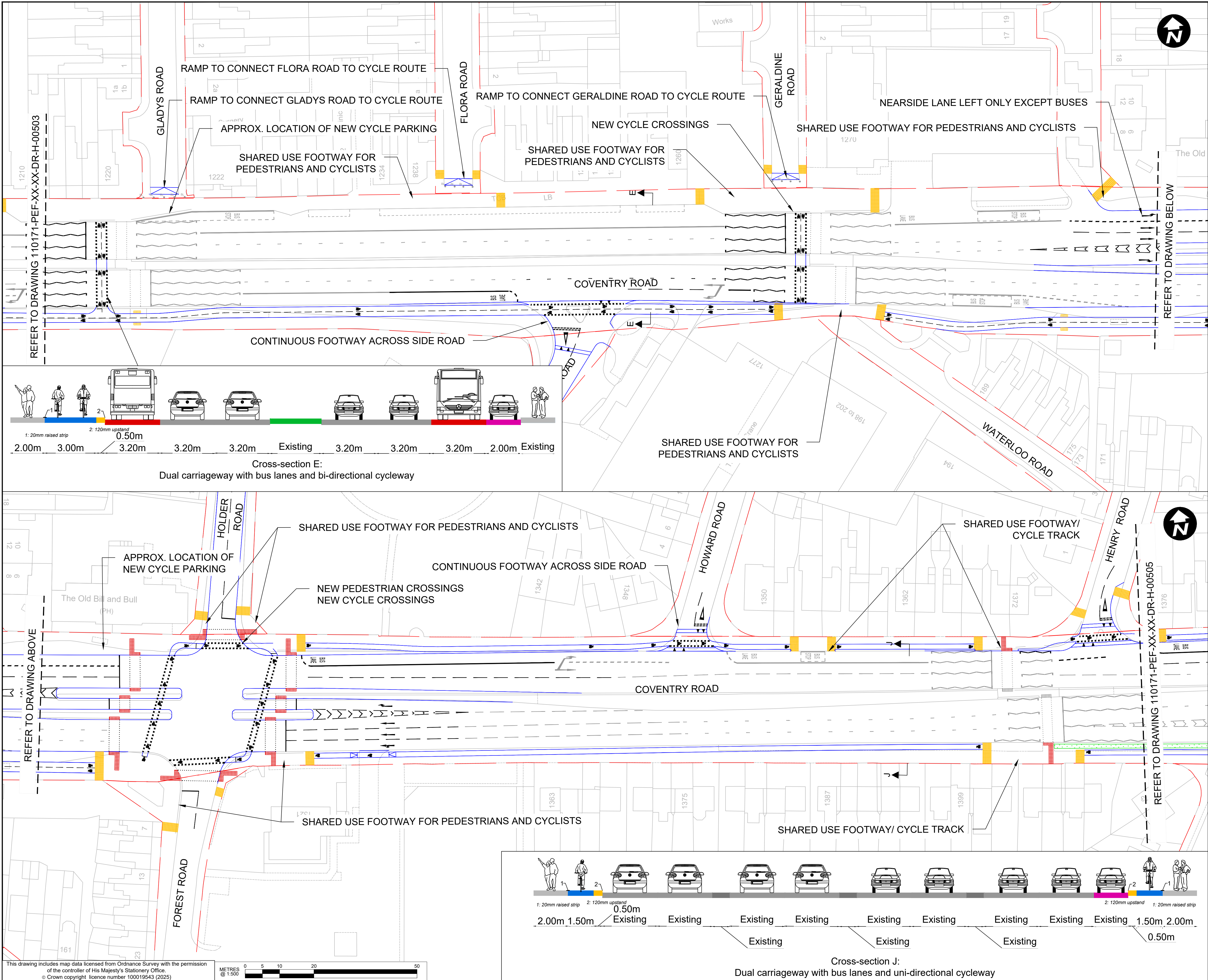

GENERAL NOTES

G1. DO NOT SCALE THIS DRAWING.

G2. ANY DIMENSIONAL DISCREPANCIES SHOULD BE NOTIFIED TO THE ENGINEER IMMEDIATELY.

G3. ALL DIMENSIONS ARE IN METRES - (m) UNLESS NOTED OTHERWISE.

G4. NORTH SHOWN INDICATIVE ONLY

G5. THIS DRAWING IS TO BE READ IN CONJUNCTION WITH ALL RELEVANT; SPECIFICATIONS; DRAWINGS; DETAILS AND OTHER DESIGN INFORMATION.

G6. ALL DRAWINGS AND WRITTEN MATERIAL CONTAINED WITHIN, CONSTITUTE ORIGINAL AND UNPUBLISHED WORK OF THE ENGINEER AND MAY NOT BE DUPLICATED, USED, REPRODUCED OR DISCLOSED WITHOUT WRITTEN CONSENT OR EXPRESS PERMISSION FROM THE ENGINEER.

G7. ALL INFORMATION CONTAINED IN THIS DOCUMENT IS COPYRIGHT ©

G8. THE DESIGNS ARE BASED ON ORDNANCE SURVEY MASTERMAP MAPPING. THEREFORE, ALL DIMENSIONS ARE APPROXIMATE.

G9. PROPOSED CYCLE TRACK/ LANE WIDTHS TO BE REVIEWED ONCE TOPOGRAPHICAL SURVEY AND TRAFFIC COUNT DATA IS AVAILABLE.

KEY

EXISTING ROAD MARKINGS

PROPOSED WHITE ROAD MARKINGS

PROPOSED YELLOW ROAD MARKINGS

PROPOSED RED ROAD MARKINGS

PROPOSED KERB REALIGNMENT

HMPE

AREAS IDENTIFIED FOR LANDSCAPE IMPROVEMENTS

CROSS-SECTION KEY

CYCLEWAY

SHARED-USE

BUFFER

VERGE

CARRIAGEWAY

PARKING

FOOTWAY

CENTRAL MEDIAN

BUS LANE

LOCATION PLAN:

FOR INFORMATION

		DH	DH	MS	SB	25.04.25
P03	POST DESIGN REVIEW PANEL UPDATE					
P02	UPDATED FOLLOWING CLIENT COMMENTS	DH	DH	MS	SB	11.04.25
P01	DRAFT ISSUE	SR	SR	DH	NY	24.03.25
REV	DESCRIPTION	DRN	DES	CHK	APP	DATE

Pell Frischmann

3rd FLOOR, EDMUND HOUSE, 12-22 NEWHALL STREET, BIRMINGHAM B3 3AS

Telephone +44 (0)121 456 1616

Email: [pbirmingham@pellfrischmann.com](mailto:pbirmingham@pellfrischmann.com)

[www.pellfrischmann.com](http://www.pellfrischmann.com)

Architect/Client/Contractor

**Birmingham City Council**

Project

A45 CYCLE ROUTE  
STAGE 1

Drawing Title

A45 CYCLE ROUTE  
CONCEPT DESIGN  
OPTION 5 - SHEET 4 OF 5

Drawing Status

CONCEPT

















Name	Date	Status Code
S.RICKETT	30.04.25	S0
S.RICKETT	30.04.25	
D.HOUNSELL	30.04.25	
N.YOUNG	30.04.25	

Drawing No.

110171-PEF-XX- XX - DR - H -00504





- KEY**
-  EXISTING ROAD MARKINGS
  -  PROPOSED WHITE ROAD MARKINGS
  -  PROPOSED YELLOW ROAD MARKINGS
  -  PROPOSED RED ROAD MARKINGS
  -  PROPOSED KERB REALIGNMENT
  -  HMPE
  -  AREAS IDENTIFIED FOR LANDSCAPE IMPROVEMENTS
- CROSS-SECTION KEY**
-  CYCLEWAY
  -  VERGE
  -  FOOTWAY
  -  SHARED-USE
  -  CARRIAGEWAY
  -  CENTRAL MEDIAN
  -  BUFFER
  -  PARKING
  -  BUS LANE

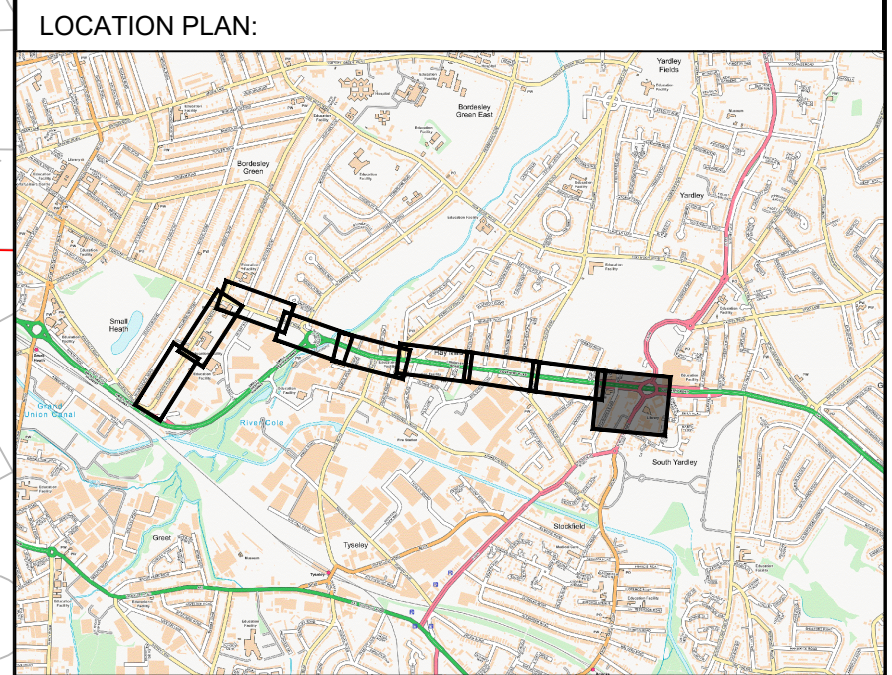

P03	POST DESIGN REVIEW PANEL UPDATE	DH	DH	MS	SB	25.04.25
P02	ISSUE FOR DESIGN REVIEW PANEL	DH	DH	MS	SB	11.04.25
P01	DRAFT ISSUE	SR	SR	DH	NY	24.03.25
REV	DESCRIPTION	DRN	DES	CHK	APP	DATE

**Pell Frischmann**  
3rd FLOOR, EDMUND HOUSE, 12-22 NEWHALL STREET, BIRMINGHAM B3 3AS  
Telephone +44 (0)121 456 1616  
Email: [ptfbirmingham@pellfrischmann.com](mailto:ptfbirmingham@pellfrischmann.com)  
[www.pellfrischmann.com](http://www.pellfrischmann.com)

Architect/Client/Contractor

 **Birmingham**  
City Council

Project	A45 CYCLE ROUTE STAGE 1
---------	----------------------------

A45 CYCLE ROUTE  
CONCEPT DESIGN  
OPTION 5 - SHEET 5 OF 5

Drawing Status				
<b>CONCEPT</b>				
	Name	Date	Status Code	
Drawn	S.RICKETT	30.04.25	S0	
Designed	S.RICKETT	30.04.25	Scale	
Eng Chk	D.HOUNSELL	30.04.25	1:500 @ A1	
Approved	N.YOUNG	30.04.25	Revision	
			P03	

110171-PEF-XX- XX - DR - H -00505



Cross-section K:  
Shared-use footway/ cycleway adjacent to  
subway ramp

