

C:\pwworking\jacobs_uk_highways_ssa\gandhi\k0317546\B2309512-JAC-HGN-05-DR-CH-0026.dwg - 06/03/2025 16:55:45 - Sheet 02 - Gandhi

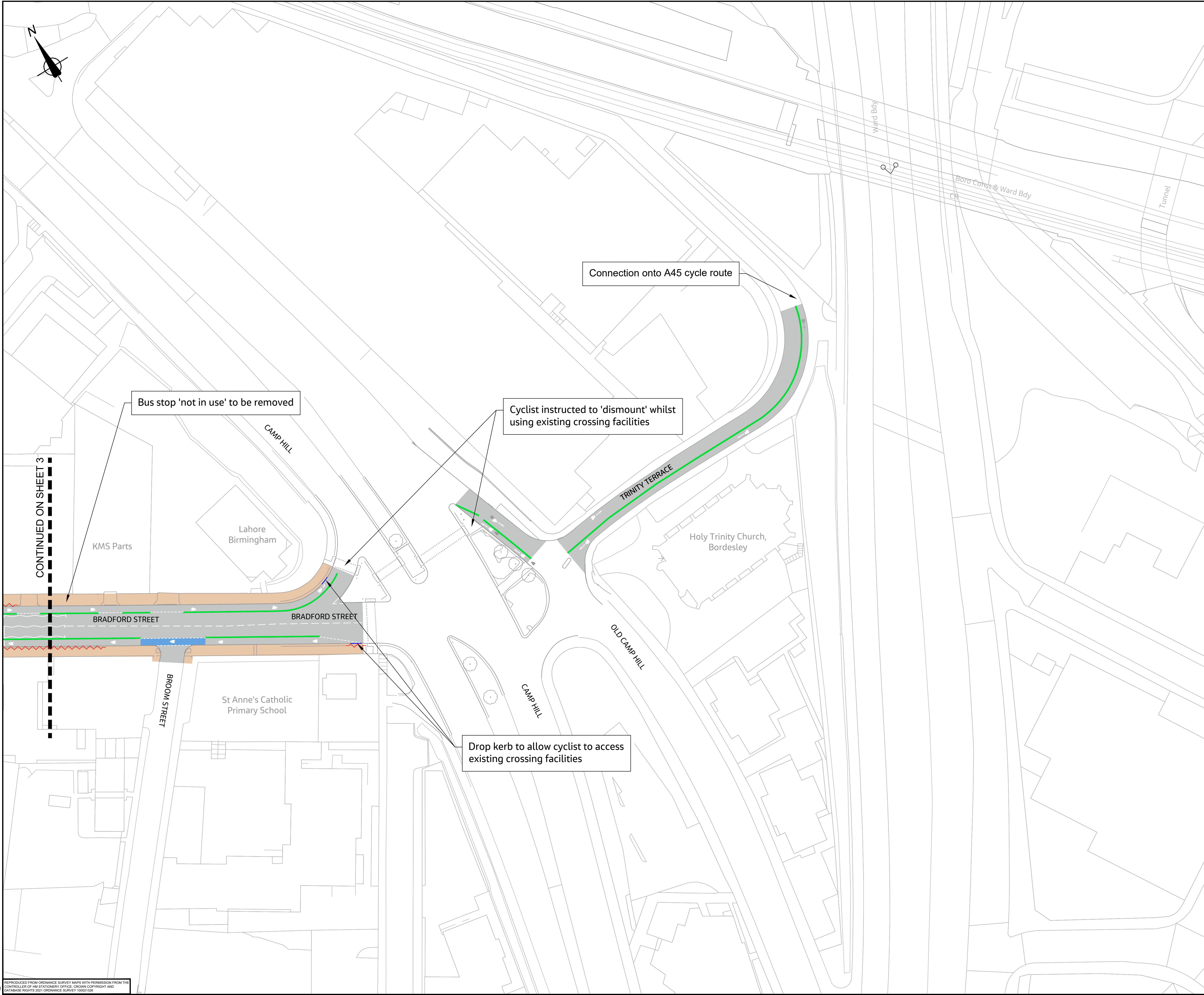

- Notes:**
1. Drawings to be printed in colour to enable correct viewing of symbols.
 2. Do not scale from this drawing.
 3. Where property requires vehicle access, gap in segregation unit will be provided. Locations to be confirmed at next stage of design.

- Key:**
- OS base
 - Proposed kerbs
 - Proposed white lining (indicative)
 - Proposed Cycle Segregation Unit
 - Blue cycleway surfacing proposed
 - Controlled pedestrian crossing
 - Uncontrolled pedestrian crossing
 - Carriageway
 - Footway
 - Existing guardrails to be removed
 - Existing parking to be removed

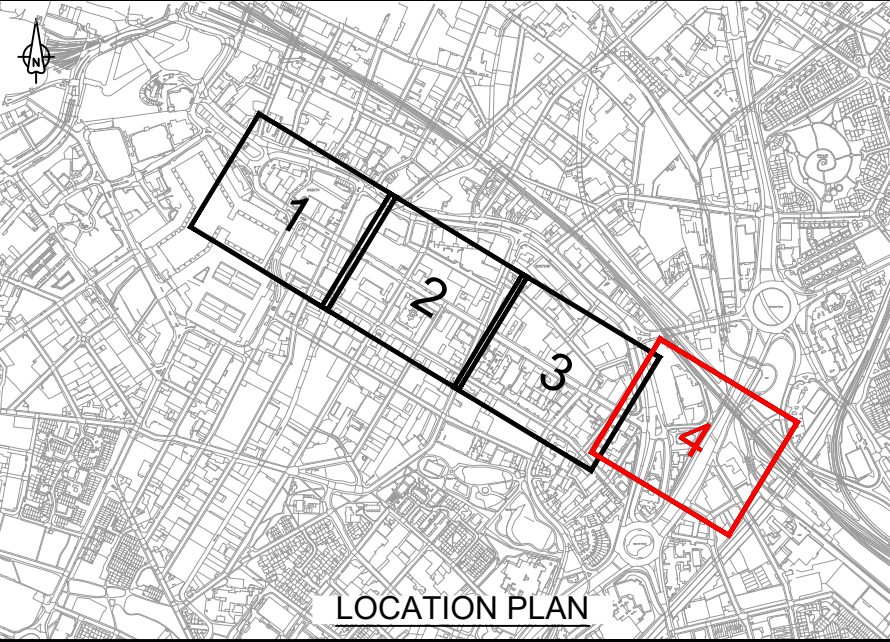
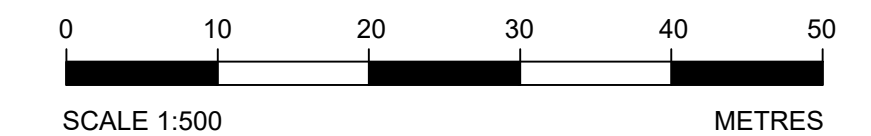

P00	06/03/25	SUITABLE FOR REVIEW AND COMMENT	KG	SE	MP	MP
Rev	Rev. Date	Purpose of revision	Drawn	Checked	Rev'd	Appr'd

Designer:

Jacobs
 7th Floor, 2 Colmore Square, 38 Colmore Circus
 Queensway, Birmingham, B4 6BN
 Tel: +44(0)121 237 4000 www.jacobs.com

Client:

Birmingham City Council **West Midlands Cycle & Walk**

Project

ACTIVE TRAVEL FUND
TRANCHE 2

Drawing title

BRADFORD STREET
CYCLE LANES
PUBLIC CONSULTATION
SHEET 4 OF 4

Drawing status		
S3 - SUITABLE FOR REVIEW AND COMMENT		
Scale	1:500@A1	DO NOT SCALE
Jacobs No.	B2309512	Rev
Client no.		P00
Drawing number		
B2309512-JAC-HGN-05-DR-CH-0026		

© Copyright 2025 Jacobs U.K. Limited. The concepts and information contained in this document are the property of Jacobs. Use or copying of this document in whole or in part without the written permission of Jacobs constitutes an infringement of copyright. Limitation: This drawing has been prepared on behalf of, and for the exclusive use of, Jacobs' Client, and is subject to, and issued in accordance with, the provisions of the contract between Jacobs and the Client. Jacobs accepts no liability or responsibility whatsoever for, or in respect of, any use of, or reliance upon, this drawing by any third party.