

C:\pwworkdir\mma-p\wadam.steeldms50926\EDG-D02-TRO-B_20-DR-HW-0006.dwg

100mm
50mm
40mm
30mm
20mm
10mm
0mm

A3

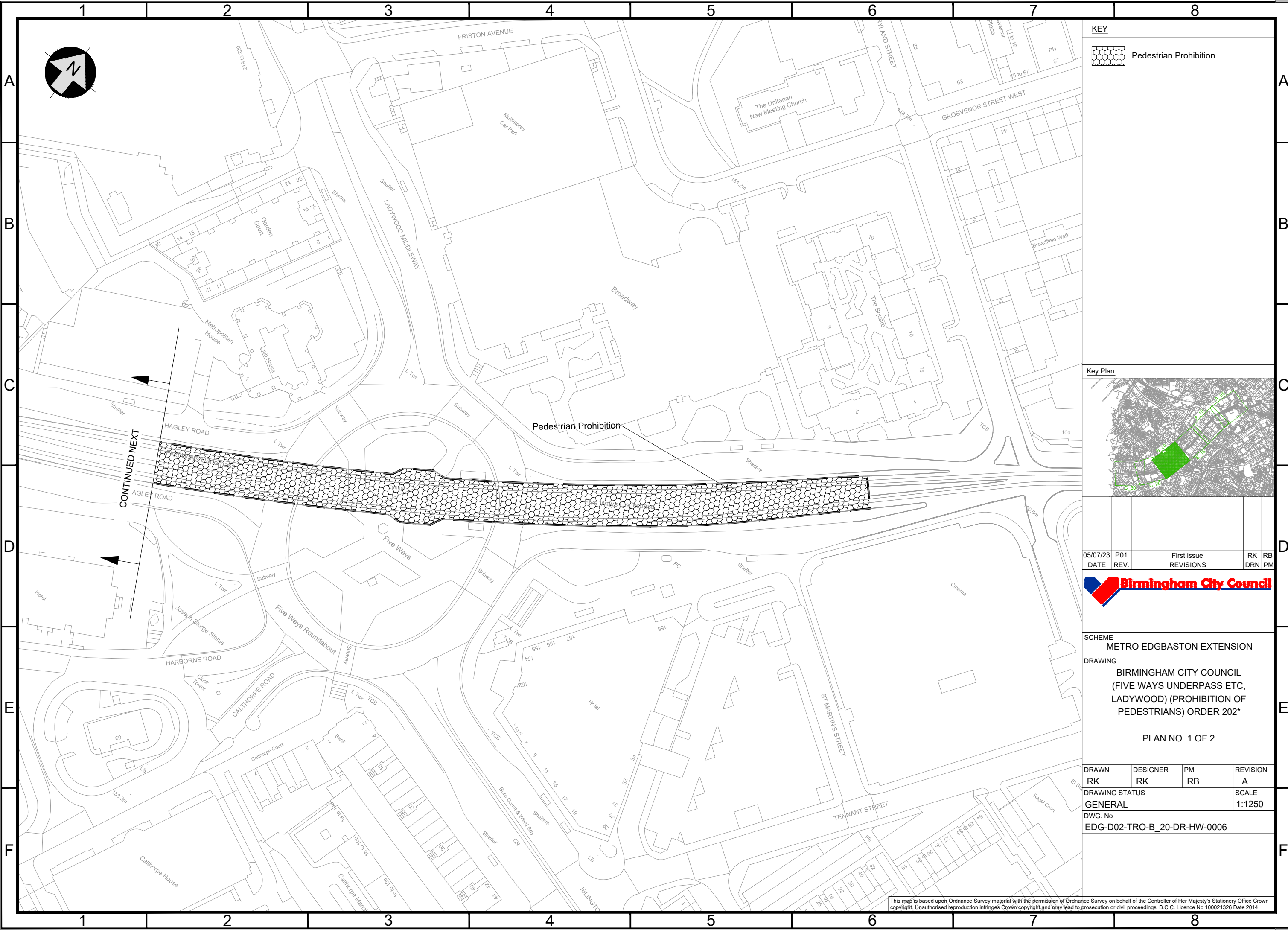

KEY

Pedestrian Prohibition

Key Plan

05/07/23	P01	First issue	RK	RB
DATE	REV.	REVISIONS	DRN	PM

Birmingham City Council

SCHEME
METRO EDGBASTON EXTENSION

DRAWING
BIRMINGHAM CITY COUNCIL
(FIVE WAYS UNDERPASS ETC,
LADYWOOD) (PROHIBITION OF
PEDESTRIANS) ORDER 202*

PLAN NO. 1 OF 2

DRAWN RK	DESIGNER RK	PM RB	REVISION A
-------------	----------------	----------	---------------

DRAWING STATUS
GENERAL

DWG. No
EDG-D02-TRO-B_20-DR-HW-0006

SCALE
1:1250

This map is based upon Ordnance Survey material with the permission of Ordnance Survey on behalf of the Controller of Her Majesty's Stationery Office Crown copyright. Unauthorised reproduction infringes Crown copyright and may lead to prosecution or civil proceedings. B.C.C. Licence No 100021326 Date 2014.

C:\pwworkdir\mma-p\wadam.steeldms50926\EDG-D02-TRO-C_25-DR-HW-0006.dwg



A3

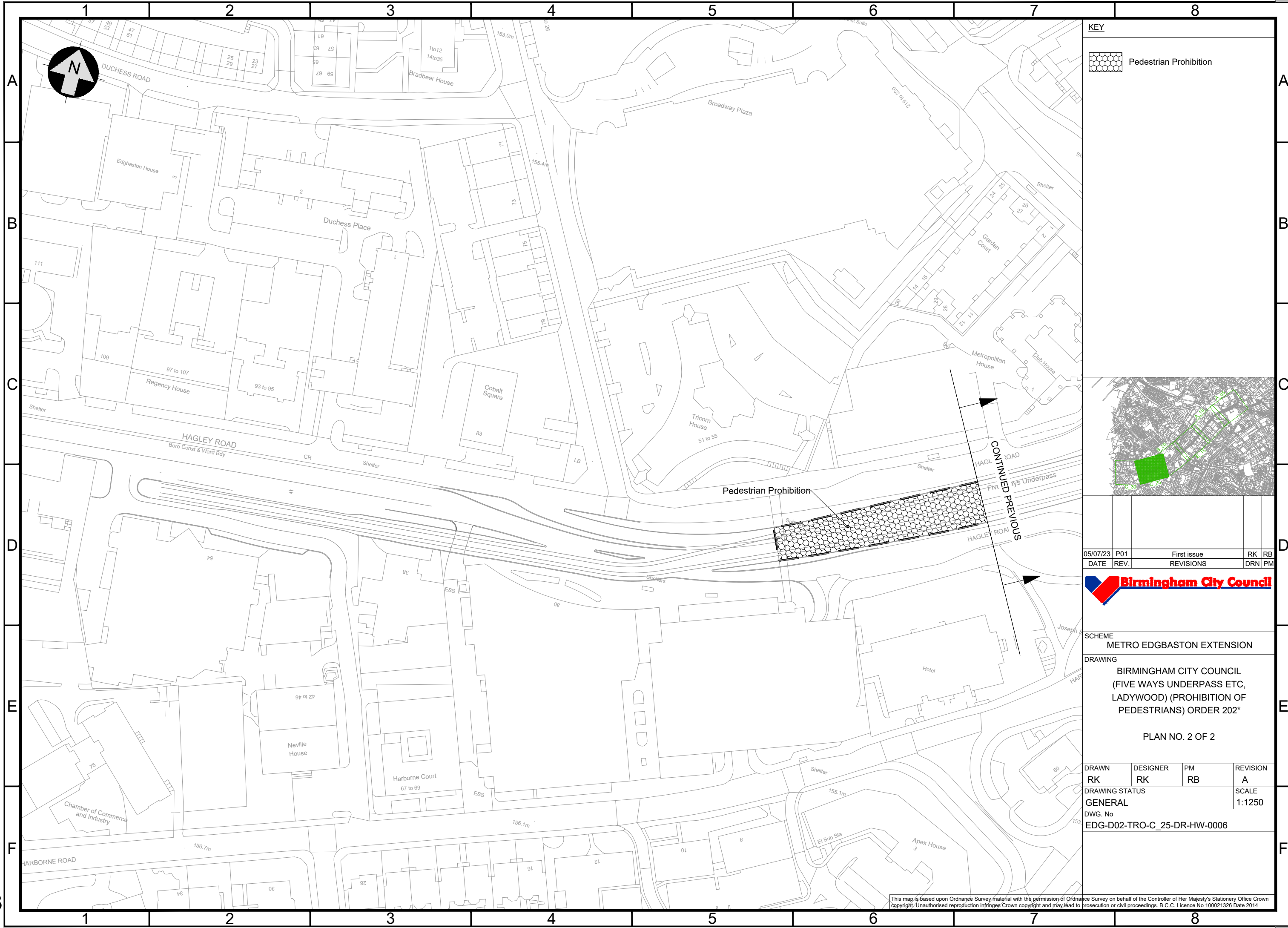

KEY

Pedestrian Prohibition

05/07/23	P01	First issue	RK	RB
DATE	REV.	REVISIONS	DRN	PM

SCHEME
METRO EDGBASTON EXTENSION

DRAWING
BIRMINGHAM CITY COUNCIL
(FIVE WAYS UNDERPASS ETC,
LADYWOOD) (PROHIBITION OF
PEDESTRIANS) ORDER 202*

PLAN NO. 2 OF 2

DRAWN RK	DESIGNER RK	PM RB	REVISION A
-------------	----------------	----------	---------------

DRAWING STATUS
GENERAL

DWG. No
EDG-D02-TRO-C_25-DR-HW-0006

SCALE
1:1250

This map is based upon Ordnance Survey material with the permission of Ordnance Survey on behalf of the Controller of Her Majesty's Stationery Office Crown copyright. Unauthorised reproduction infringes Crown copyright and may lead to prosecution or civil proceedings. B.C.C. Licence No 100021326 Date 2014.