

Copyright. All rights reserved.
 RIGHT TURNS INTO AND OUT OF
 WINDSOR ROAD TO BE PROHIBITED

CYCLE LINKS TO REA VALLEY ROUTE
 TO BE IMPROVED AS PART OF AREA
 CYCLE NETWORK PROPOSALS

MEASURES IN STIRCHLEY LOCAL CENTRE
 AS PART OF LATER PHASE OF WORKS

IMPROVED PEDESTRIAN CROSSING
 POINT ACROSS JUNCTION BELLMOUTH

PEDESTRIAN CROSSING BUILT
 OUT (APPROX 1.0M EITHER
 SIDE) THROUGH ZIG-ZAG AREA.

EXISTING "TIDAL" PARKING RESTRICTIONS
 IN THIS AREA TO REMAIN

EXISTING BUS
 STOPS TO REMAIN

CYCLE LINKS TO REA VALLEY ROUTE
 TO BE IMPROVED AS PART OF A
 SEPARATE SCHEME

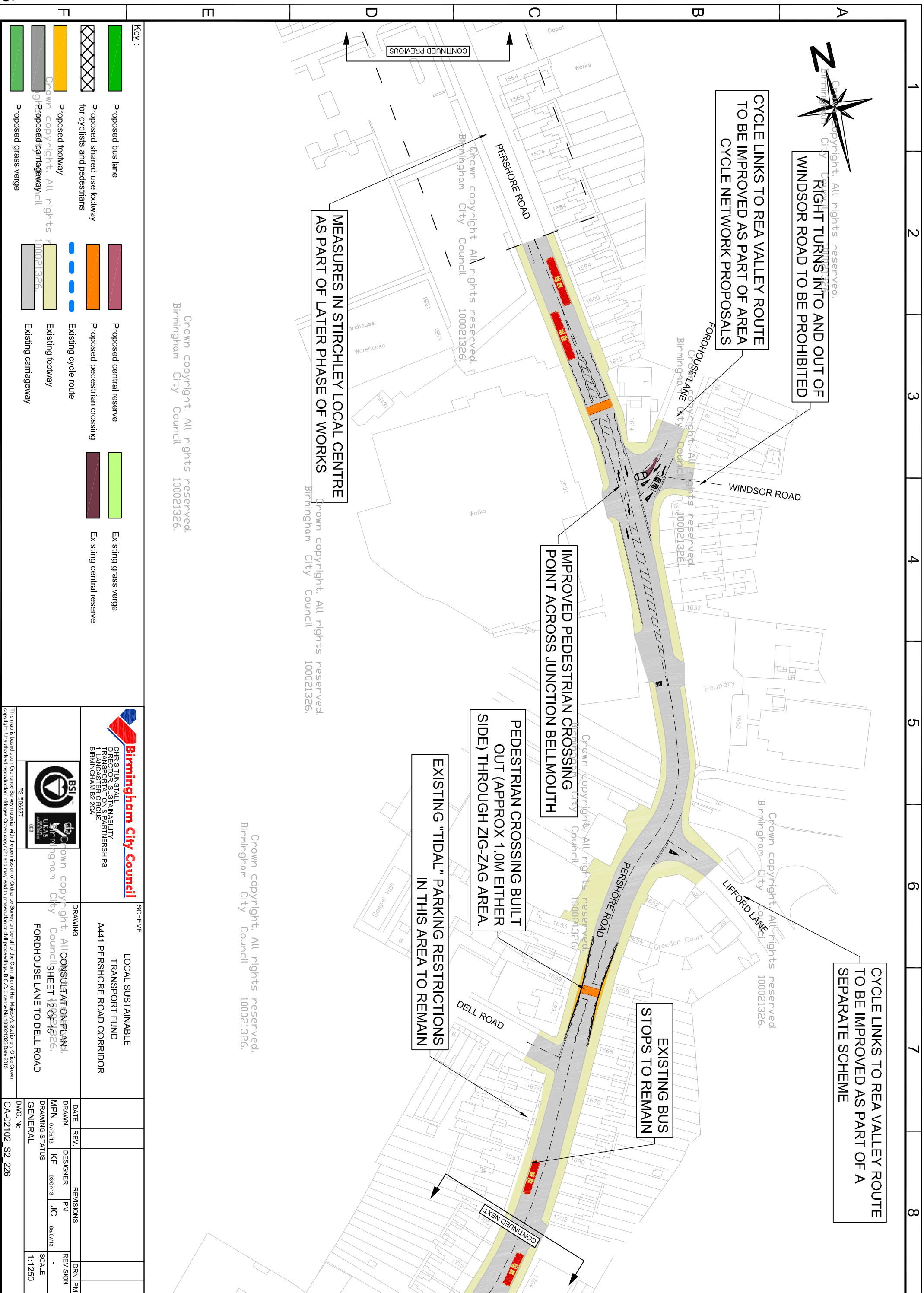

Crown copyright. All rights reserved.
 Birmingham City Council 100021326.

Crown copyright. All rights reserved.
 Birmingham City Council 100021326.

Crown copyright. All rights reserved.
 Birmingham City Council 100021326.

Key :-

	Proposed bus lane		Proposed central reserve		Existing grass verge
	Proposed shared use footway for cyclists and pedestrians		Proposed pedestrian crossing		Existing central reserve
	Proposed footway		Existing cycle route		
	Crown copyright. All rights reserved. Proposed carriageway		Existing footway		
	Proposed grass verge		Existing carriageway		

Birmingham City Council
 CHRIS TUNSTALL
 DIRECTOR SUSTAINABILITY
 TRANSPORTATION & PARTNERSHIPS
 1 LANCASTER CIRCUS
 BIRMINGHAM B2 2GA



Crown copyright. All rights reserved.
 Birmingham City Council SHEET 12 OF 1526.
 FORDHOUSE LANE TO DELL ROAD

SCHEME		LOCAL SUSTAINABLE TRANSPORT FUND	
A441 PERSHORE ROAD CORRIDOR			
DATE	REV.	REVISIONS	
MPN 07/06/13	KF	DESIGNER	PM
		JC	JC
DRAWING STATUS		DRN PM	
GENERAL		SCALE	
DWG. No		1:1250	
CA-02102_S2_226			