

FILE PATH - L:\os\Commissions\CA-02102 LSTF\02\_A441 Pershore Road Corridor\6.3 Issued\G\_CA-02102\_S2\_223 RevA Pershore Road Consultation Plan.dwg

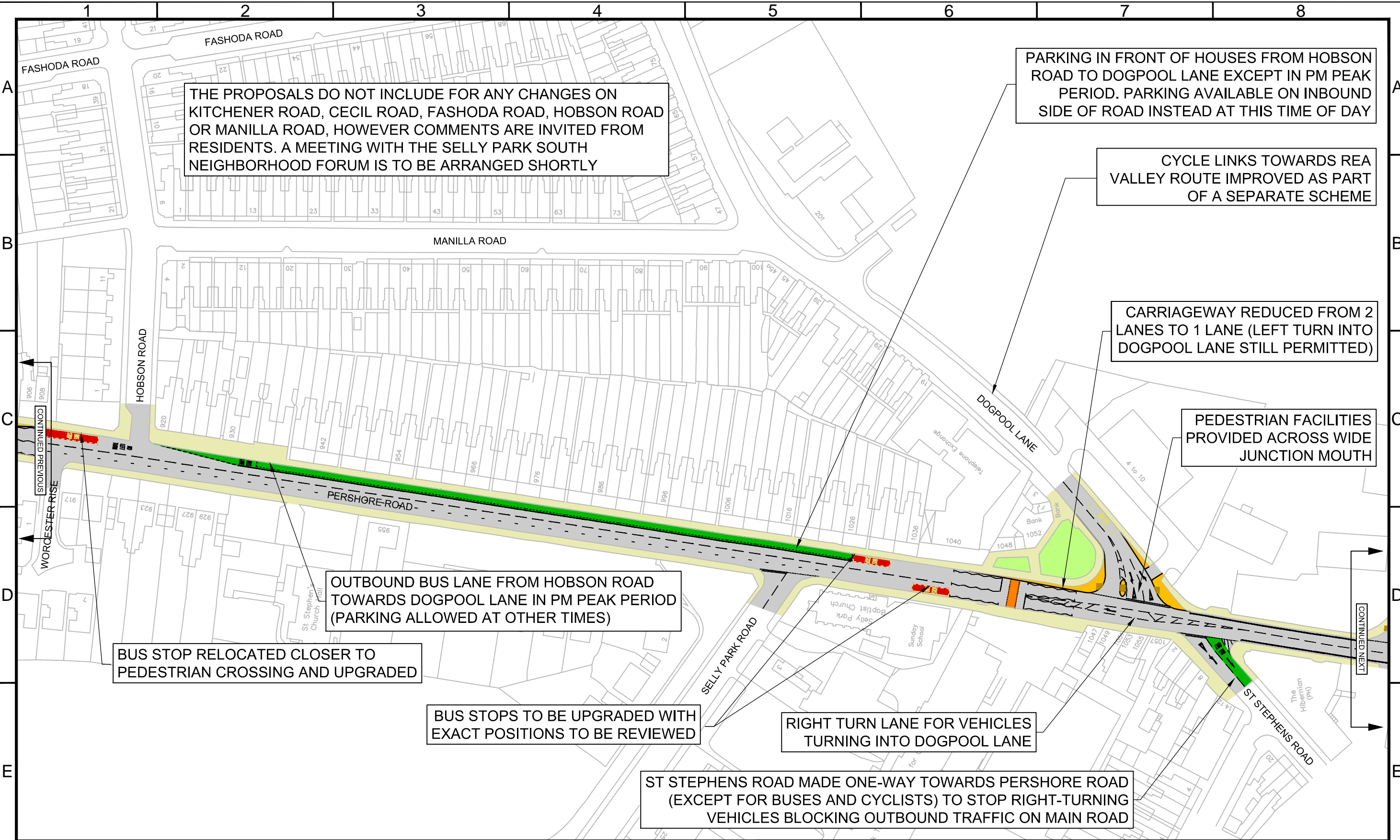

Key :-

	Proposed bus lane		Proposed central reserve		Existing grass verge
	Proposed shared use footway for cyclists and pedestrians		Proposed pedestrian crossing		Existing central reserve
	Proposed footway		Existing cycle route		Existing footway
	Proposed carriageway		Existing carriageway		
	Proposed grass verge				

**Birmingham City Council**  
 CHRIS TUNSTALL  
 DIRECTOR, SUSTAINABILITY  
 TRANSPORTATION & PARTNERSHIPS  
 1 LANCASTER CIRCUS  
 BIRMINGHAM B4 7DQ



SCHEME  
 LOCAL SUSTAINABLE  
 TRANSPORT FUND  
 A441 PERSHORE ROAD CORRIDOR

DRAWING  
 CONSULTATION PLAN  
 SHEET 9 OF 15  
 WORCESTER RISE TO  
 ST STEPHENS ROAD

05/08/13	A	NOTE ADDED	DH	PP
DATE	REV.	REVISIONS	DRN	PM
DRAWN	DESIGNER	PM	REVISION	
MPN	07/05/13	KF 03/07/13	JC 05/07/13	A
DRAWING STATUS				SCALE
GENERAL				1:1250
DWG. No				
CA-02102_S2_223				

This map is based upon Ordnance Survey material with the permission of Ordnance Survey on behalf of the Controller of Her Majesty's Stationery Office Crown copyright. Unauthorised reproduction infringes Crown copyright and may lead to prosecution or civil proceedings. B.C.C. Licence No 100021326 Date 2013