

SECTION P3(s)-01

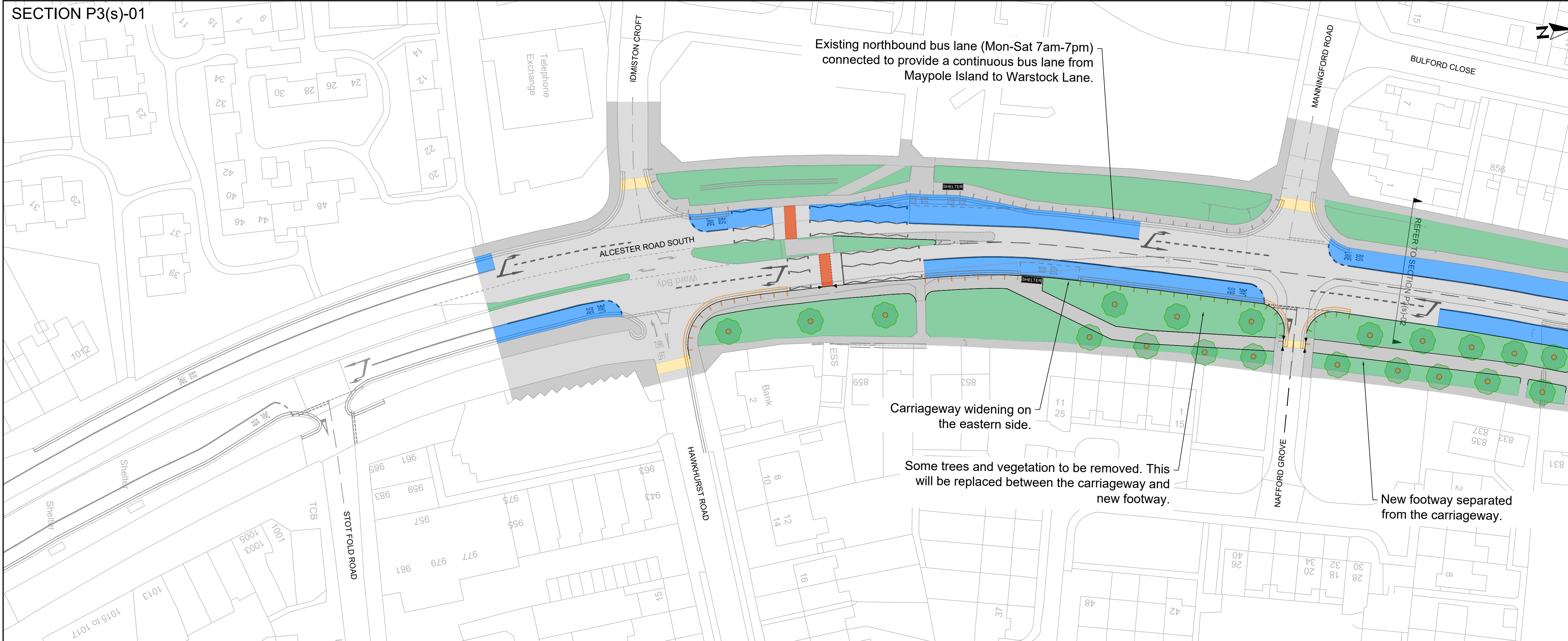

KEY

- GENERAL TRAFFIC LANE
- FOOTWAY
- BUS LANE
- CONTROLLED CROSSING
- UNCONTROLLED CROSSING
- VERGE
- TREE (SHOWN INDICATIVELY)
- SHELTER
- PROPOSED KERB

- NOTES**
- NOTES PLACED DIRECTLY ON THE LAYOUT DRAWING SUPERSEDE THOSE DETAILED IN KEYS.
 - WHERE NO CHANGE IS SHOWN, EXISTING RESTRICTIONS APPLY.

LOCATION PLAN

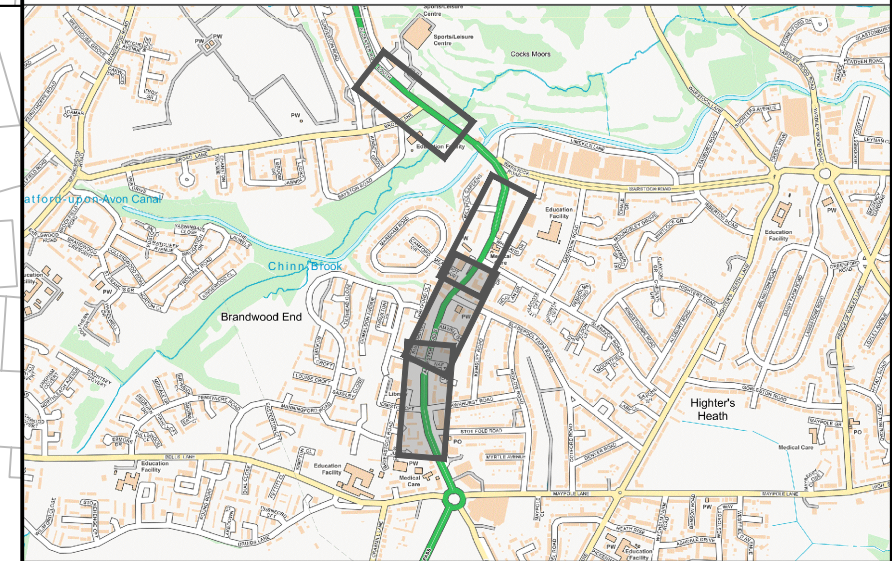

SECTION P3(s)-02

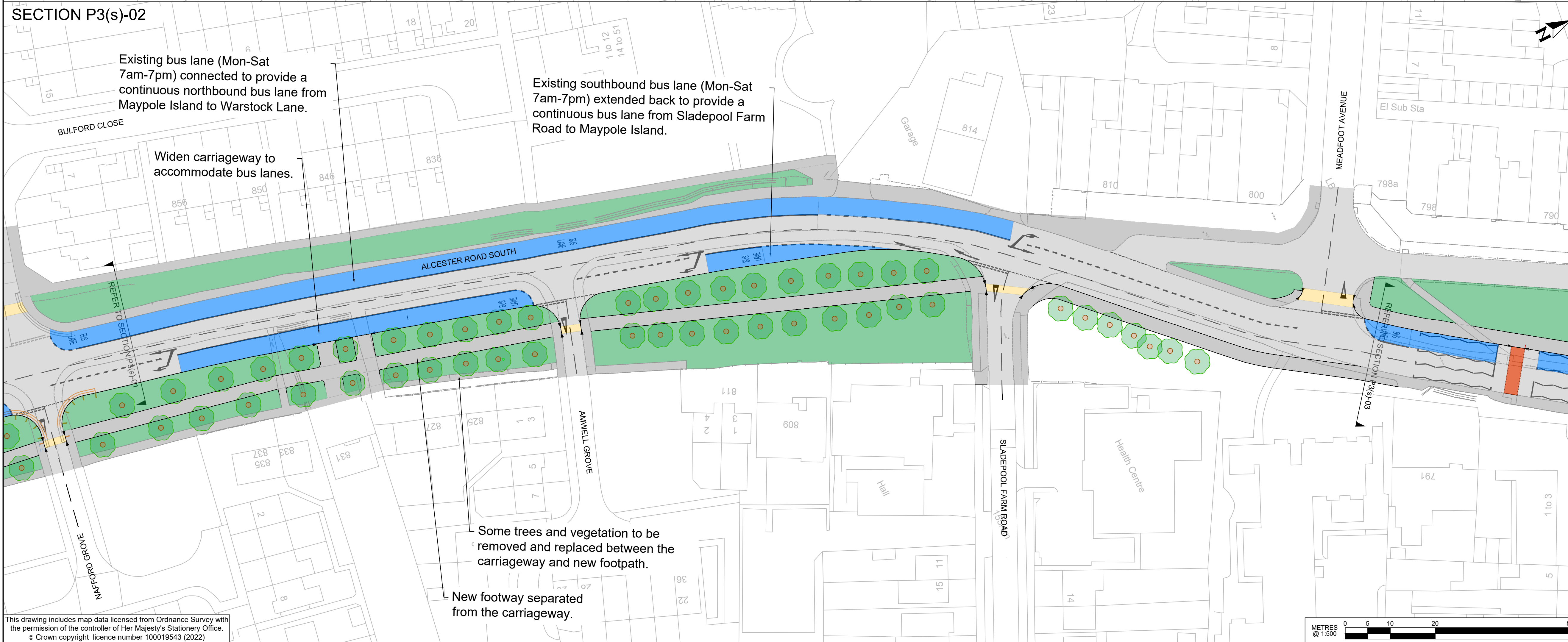

FOR CONSULTATION

| | | | | | |
|-----|-------------------|-----|-----|-----|----------|
| P01 | CONSULTATION PLAN | RGN | NY | NY | 22-07-22 |
| REV | DESCRIPTION | DRN | CHK | APP | DATE |

Pell Frischmann
 100 BROAD STREET BIRMINGHAM B15 1AE
 Telephone +44 (0)121 456 1616
 Email: pfbirmingham@pellfrischmann.com
 www.pellfrischmann.com

Architect/Client/Contractor
West Midlands Combined Authority

Project
A New Deal for the Bus Cross-City Bus

Drawing Title
Idmiston Croft to Millpool Gardens Public Consultation Plan Sheet 1 of 2

| Name | Date | Scale | 1:500 @ A1 |
|----------|------|----------|-----------------------------------|
| Drawn | RGN | 22-07-22 | |
| Designed | RGN | 22-07-22 | File No. 103788-PEF-GA-3S-DR-C |
| Checked | NY | 22-07-22 | Drawing Status PRELIMINARY DESIGN |
| Approved | NY | 22-07-22 | |

Drawing No. **103788-PEF-PC-3S-DR-C-000101** Revision **P01**

This drawing includes map data licensed from Ordnance Survey with the permission of the controller of Her Majesty's Stationery Office. © Crown copyright. licence number 100019543 (2022)