

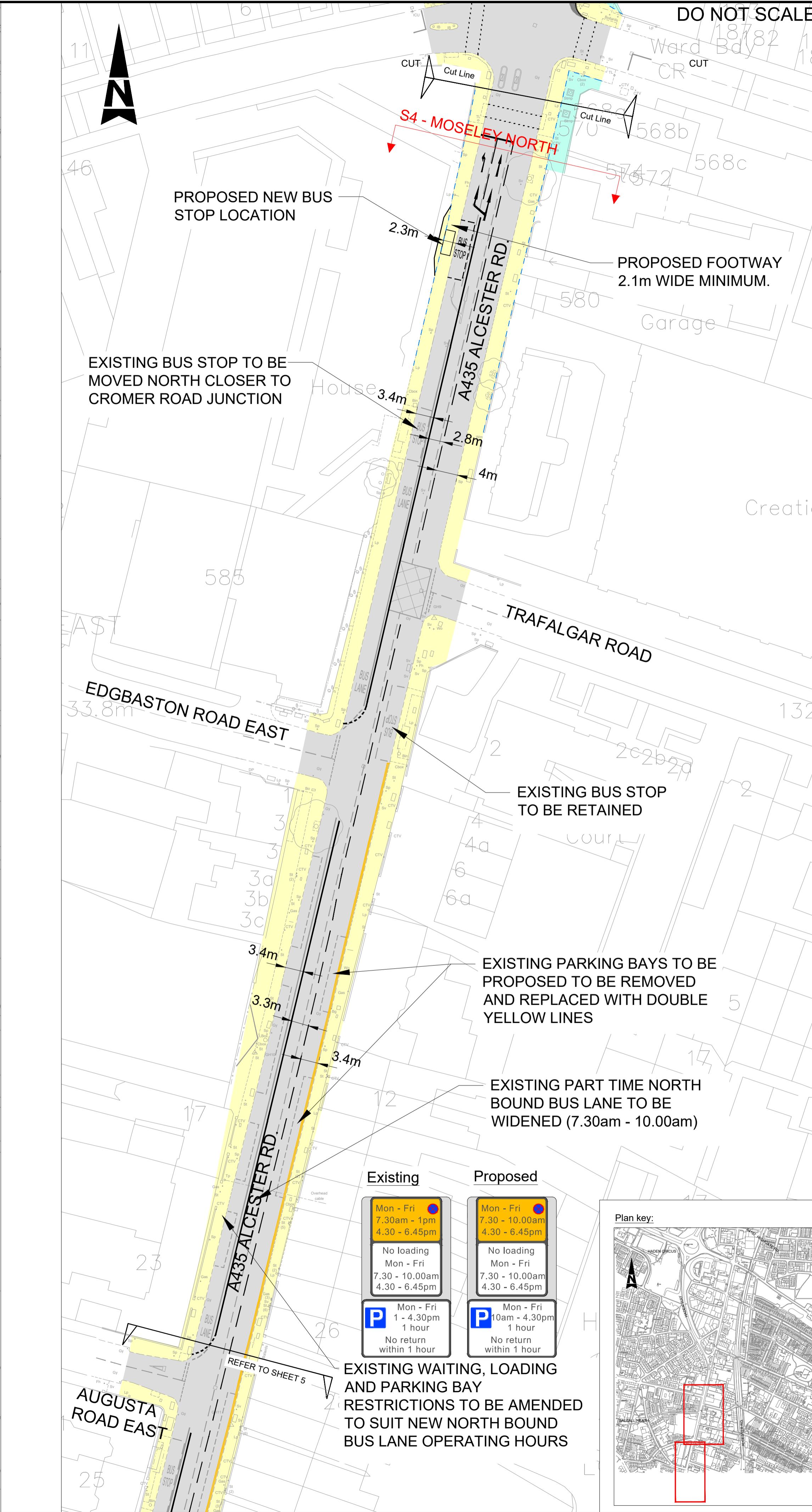

100  
0 10  
Millimetres

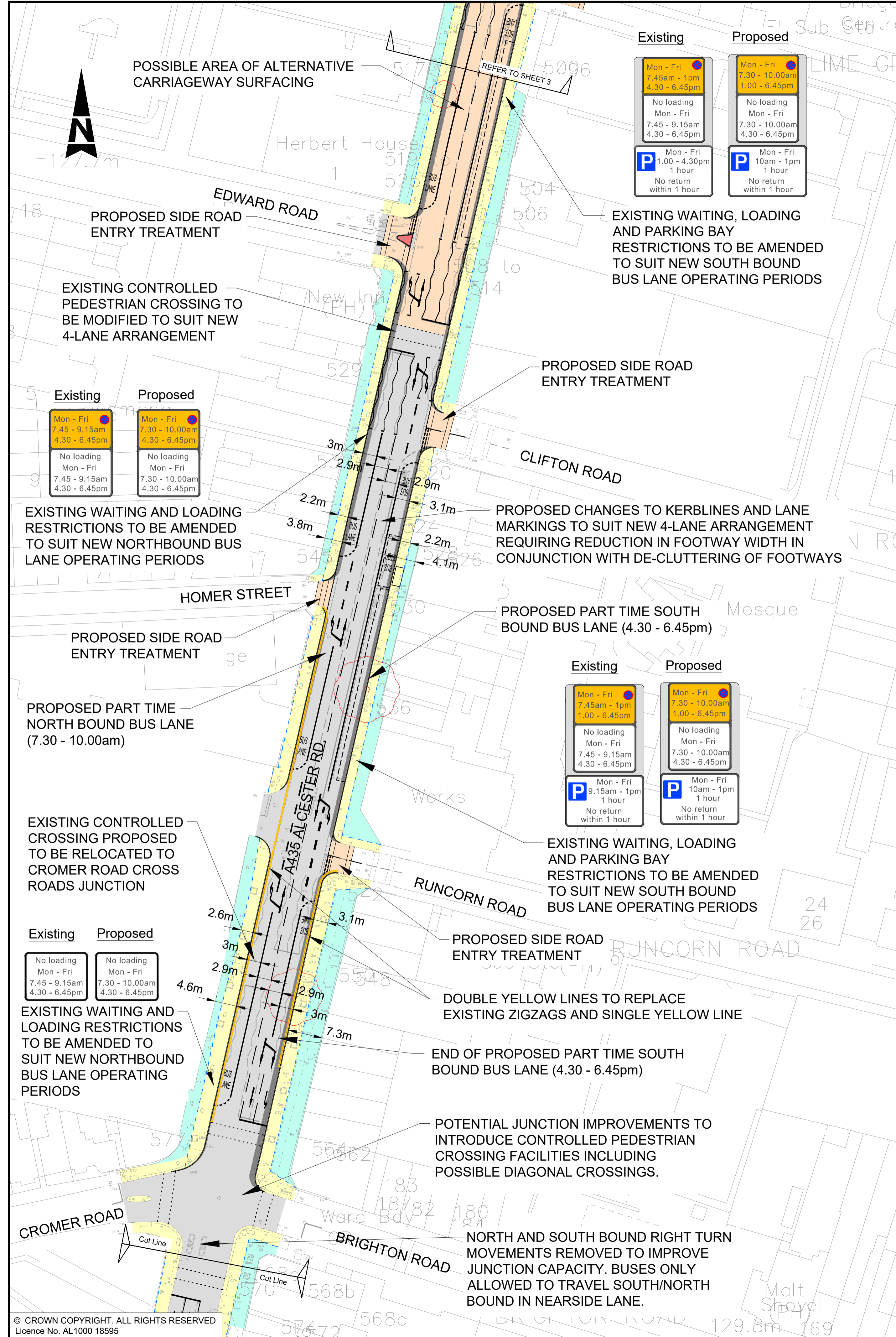



Copyright © Atkins Limited (2019)

**Notes:**  
1. Layout is preliminary design 'for information' only and subject to approval from Highway Authority.

**Key:**

- Proposed traffic island
- Existing footway
- Existing carriageway
- Proposed carriageway widening
- Proposed earthworks (sloping verge)
- Existing footway in 3rd party land
- Existing verge area
- Possible pocket park improvements
- Possible side road entry treatment/surface treatment
- Existing highway boundary
- Existing trees to be removed

**Client:** Birmingham City Council  
Transport for West Midlands

**Project Title:** BIRMINGHAM GROWTH POINT PUBLIC TRANSPORT PACKAGE

**Drawing Title:** A435 ALCESTER ROAD BUS PRIORITY REVITALISATION PUBLIC CONSULTATION SHEET 4 S3 - BALSALL HEATH/S4 - MOSELEY NORTH

0 10 100  
Millimetres

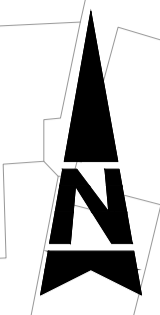

AUGUSTA ROAD EAST  
Augusta Road East

REFER TO SHEET 4

EXISTING BUS STOP  
TO BE RETAINED

Ludgate House

Existing	Proposed
<p>Mon - Fri 7.30am - 1pm 4.30 - 6.45pm</p> <p>No loading Mon - Fri 7.30 - 10.00am 4.30 - 6.45pm</p> <p>P Mon - Fri 1 - 4.30pm 1 hour No return within 1 hour</p>	<p>Mon - Fri 7.30 - 10.00am 4.30 - 6.45pm</p> <p>No loading Mon - Fri 7.30 - 10.00am 4.30 - 6.45pm</p> <p>P Mon - Fri 10am - 4.30pm 1 hour No return within 1 hour</p>

EXISTING WAITING, LOADING AND  
PARKING BAY RESTRICTIONS TO  
BE AMENDED TO SUIT NEW  
NORTH BOUND BUS LANE  
OPERATING HOURS

EXISTING PART TIME NORTH  
BOUND BUS LANE TO BE  
WIDENED (7.30 - 10.00am)

EXISTING PARKING BAYS  
TO BE REMOVED AND  
REPLACED WITH  
DOUBLE YELLOW LINES

EXISTING BUS STOP  
TO BE RETAINED

EXISTING PARKING BAYS TO  
BE REMOVED AND REPLACED  
WITH DOUBLE YELLOW LINES

Park Hill Primary School

Pond

Tank



DO NOT SCALE

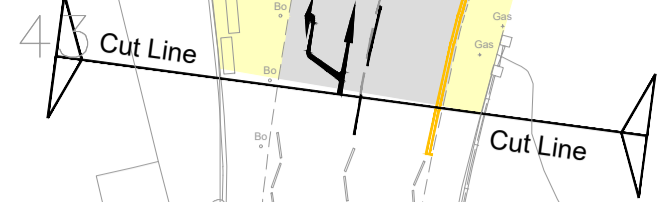

NO CHANGE TO  
EXISTING LAYOUT

Park Hill Primary School

Pond

PARK HILL  
Park Hill

Elm Court  
963-1852

94

98

100

106

108

110

116

108c

108d

55 ROAD

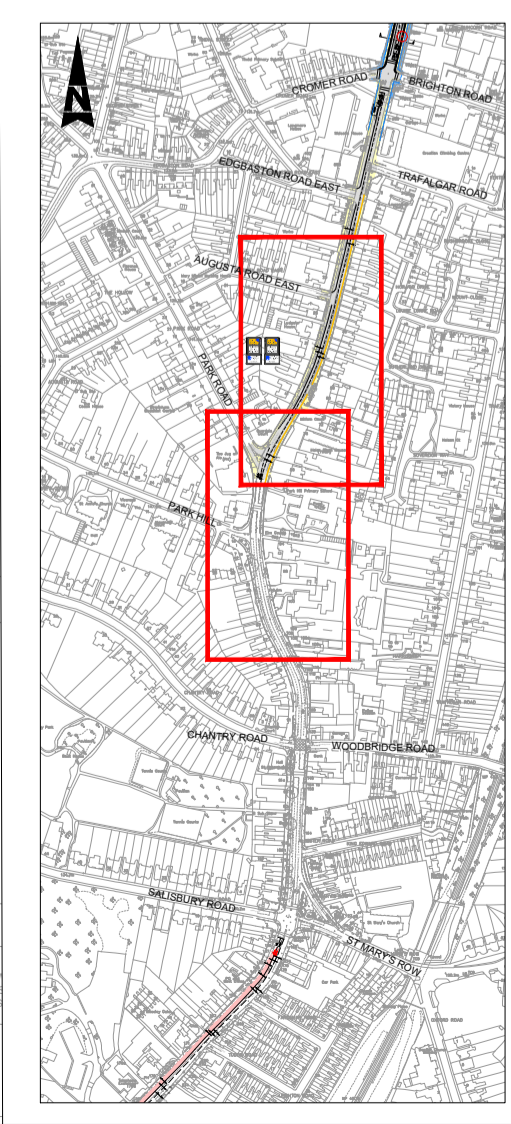

ATKINS

Copyright © Atkins Limited (2019)

Notes:

- 1. Layout is preliminary design 'for information' only and subject to approval from Highway Authority.

Key:

- Proposed traffic island
- Existing footway
- Existing carriageway
- Proposed carriageway widening
- Proposed earthworks (sloping verge)
- Existing footway in 3rd party land
- Existing verge area
- Possible pocket park improvements
- Possible side road entry treatment/surface treatment
- Existing highway boundary
- Existing trees to be removed

Client

Project Title  
BIRMINGHAM GROWTH POINT  
PUBLIC TRANSPORT PACKAGE

Drawing Title  
A435 ALCESTER ROAD  
BUS PRIORITY REVITALISATION  
PUBLIC CONSULTATION SHEET 5  
S4 - MOSELEY NORTH