

0 10 100
Millimetres

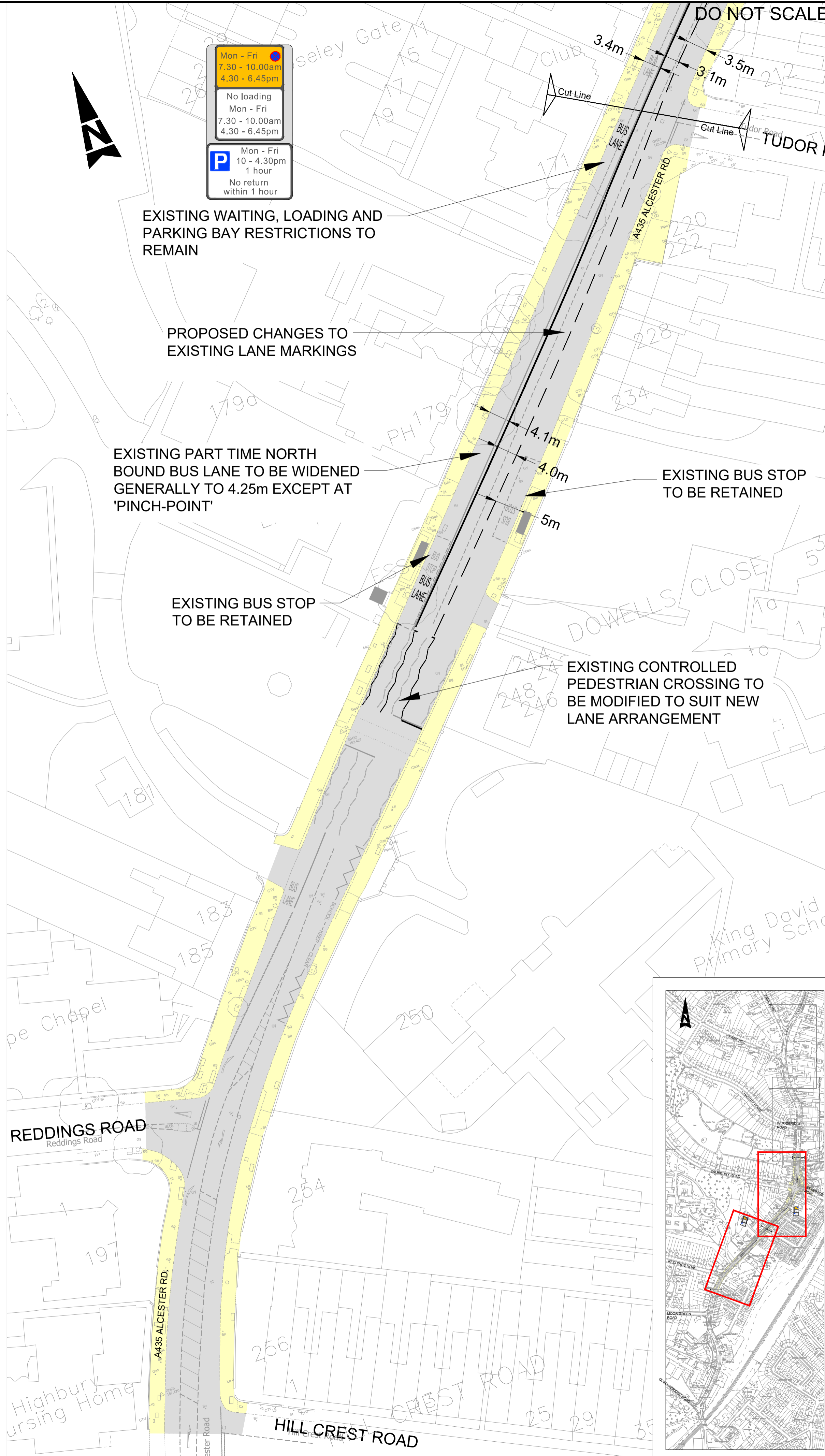
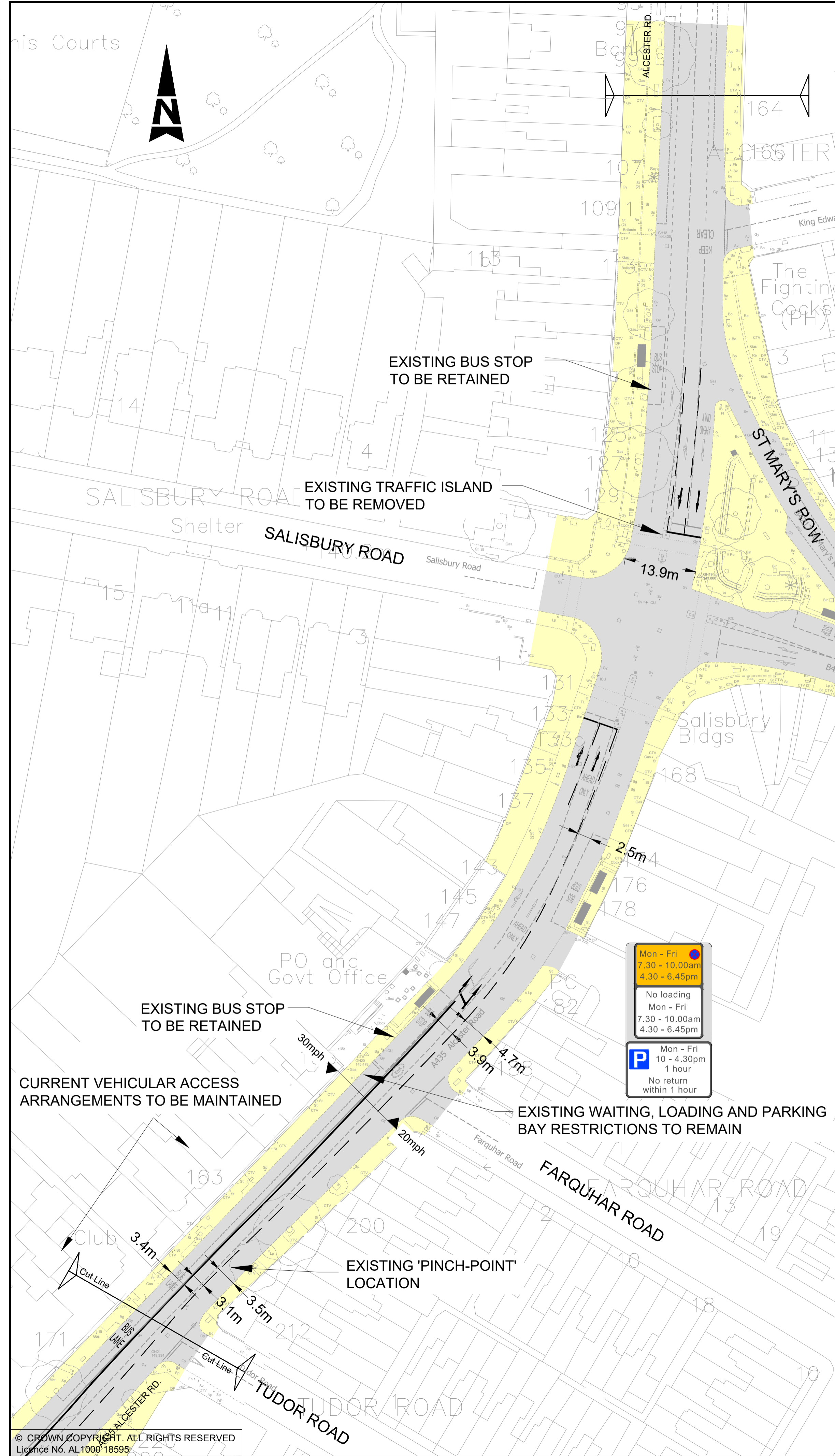

Mon - Fri	7.30 - 10.00am	4.30 - 6.45pm
No loading	Mon - Fri	7.30 - 10.00am
		4.30 - 6.45pm
P	Mon - Fri	10 - 4.30pm
		1 hour
		No return within 1 hour

Notes:
1. Layout is preliminary design 'for information' only and subject to approval from Highway Authority.

- Key:
- Proposed traffic island
 - Existing footway
 - Existing carriageway
 - Proposed carriageway widening
 - Proposed earthworks (sloping verge)
 - Existing footway in 3rd party land
 - Existing verge area
 - Possible pocket park improvements
 - Possible side road entry treatment/surface treatment
 - Existing highway boundary
 - + Existing trees to be removed

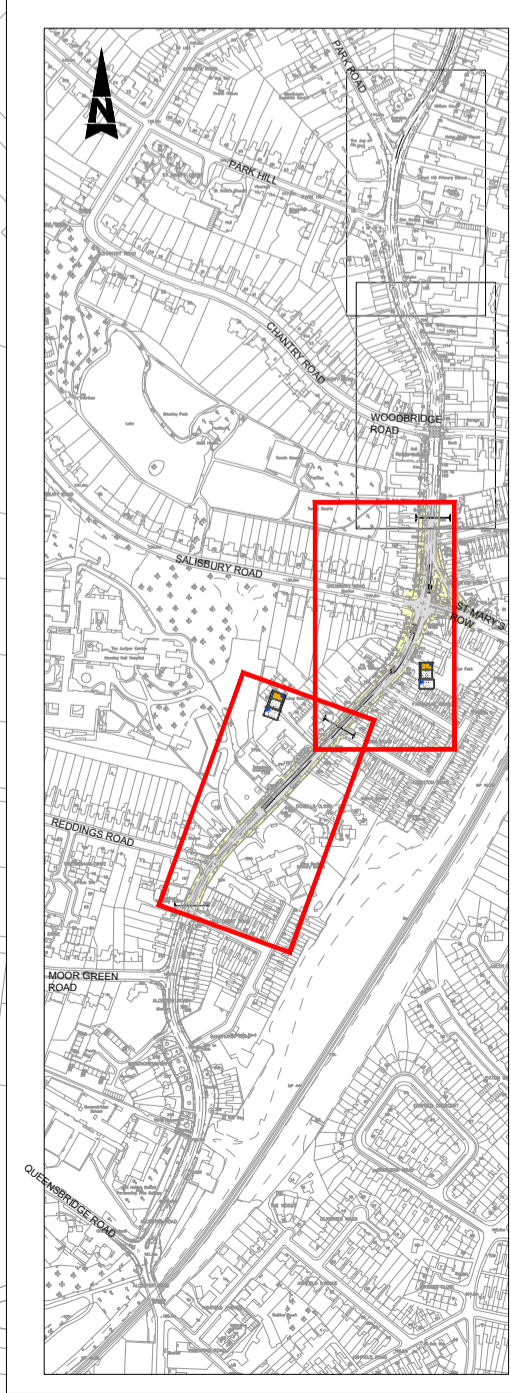

Client: **Birmingham City Council**
Transport for West Midlands

Project Title: **BIRMINGHAM GROWTH POINT PUBLIC TRANSPORT PACKAGE**

Drawing Title: **A435 ALCESTER ROAD BUS PRIORITY REVITALISATION PUBLIC CONSULTATION SHEET 6 S5 - MOSELEY SOUTH**