

B2309014 - BCC Clean Air Zone Services\B2309014 CAZ Early Measures Bus Schemes\06 Drawings\04 Hockley Hill\0000 Consultation\B2309014-JAC-CON-04\_01-DR-CH-1005 P00.1.dwg - 20/05/2019 12:54:23 - Sheet02 - mitrud

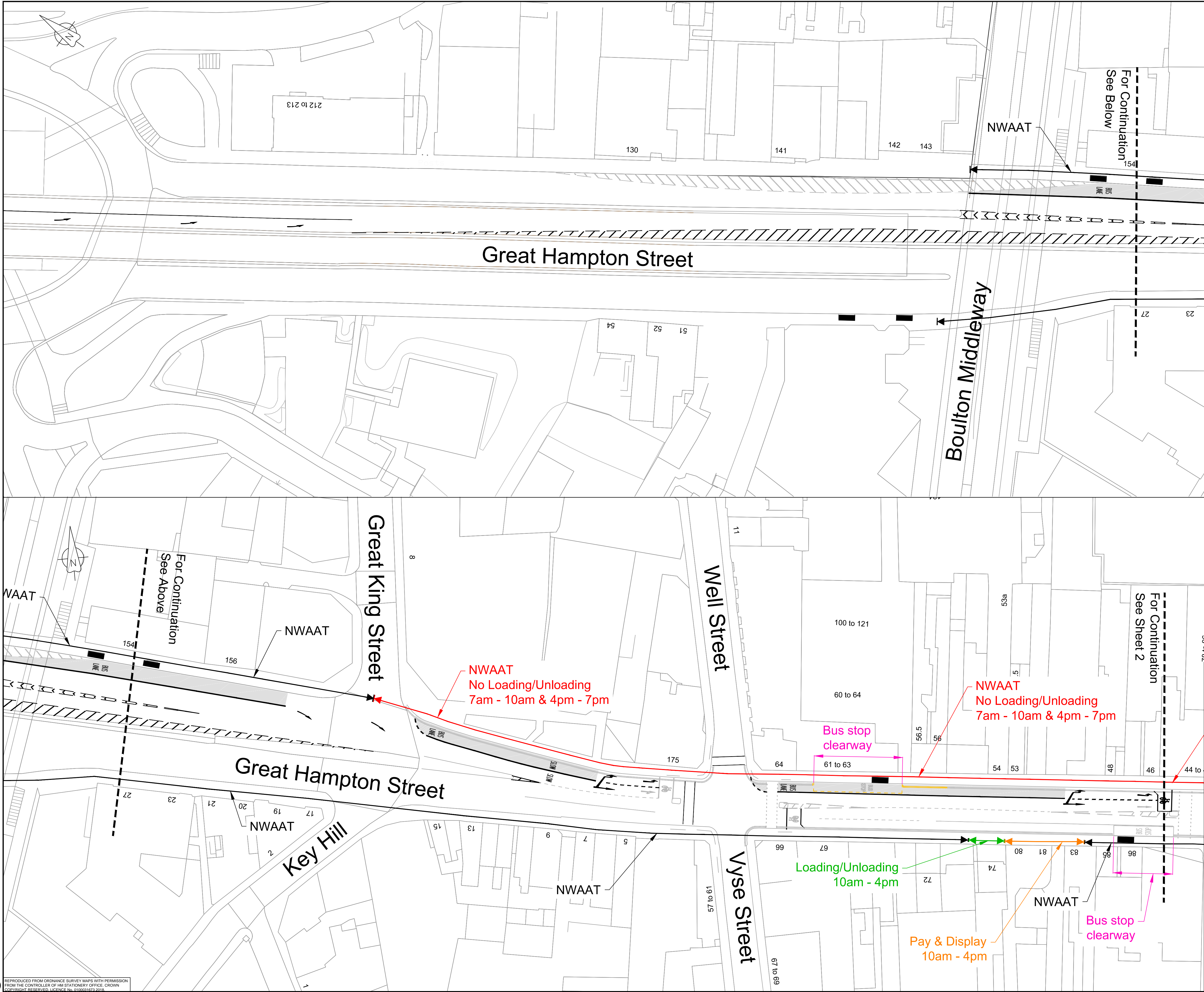

Notes:

- 1) Drawing to be printed in colour.
- 2) Do not scale from this drawing.
- 3) This drawing was produced for consultation purposes only.

Key:

- Bus lane:  
7am - 10am & 4pm - 7pm  
(colour shown for presentation only)
- Existing bus stop to be retained
- Loading/Unloading 10am-4pm
- No Waiting At Any Time (NWAAT)
- Pay & Display 10am-4pm
- Bus stop clearway
- No Waiting At Any Time; No Loading/Unloading  
7am - 10am & 4pm - 7pm
- Limited waiting 1pm-4pm  
max stay 1hour; no return within 1hour; No Waiting  
10am - 1pm; No Loading/Unloading 10am - 1pm

Rev	Rev. Date	Purpose of revision	Drawn	Checked	Rev'd	Appr'd
P00	20/05/19	FOR INFORMATION	MP	DM	DM	PE

**JACOBS**  
7th Floor, 2 Colmore Square, 38 Colmore Circus  
Queensway, Birmingham, B4 6BN  
Tel: +44(0)121 237 4000 www.jacobs.com

Client

**Birmingham City Council**

Project

**CLEAN AIR ZONE  
(EARLY MEASURES-BUS PRIORITY SCHEMES)**

Drawing title

**HOCKLEY HILL  
PUBLIC CONSULTATION  
OPTION B  
SHEET 1 OF 3**

Drawing status	FIT FOR INFORMATION	
Scale	NTS	DO NOT SCALE
Jacobs No.	B2309014	
Client no.	1807-06	
Drawing number	B2309014-JAC-CON-04_01-DR-CH-1005	Rev P00

© Copyright 2019 Jacobs U.K. Limited. The concepts and information contained in this document are the property of Jacobs. Use or copying of this document in whole or in part without the written permission of Jacobs constitutes an infringement of copyright. Limitation. This drawing has been prepared on behalf of, and for the exclusive use of, Jacobs Client, and is subject to, and issued in accordance with, the provisions of the contract between Jacobs and the Client. Jacobs accepts no liability or responsibility whatsoever for, or in respect of, any use of, or reliance upon, this drawing by any third party.



B2309014 - BCC Clean Air Zone Services\B2309014 CAZ Early Measures Bus Schemes\06 Drawings\04 Hockley Hill\0000 Consultation\B2309014-JAC-CON-04\_01-DR-CH-1006 P00.1.dwg - 20/05/2019 12:53:36 - Sheet01 - mitrud

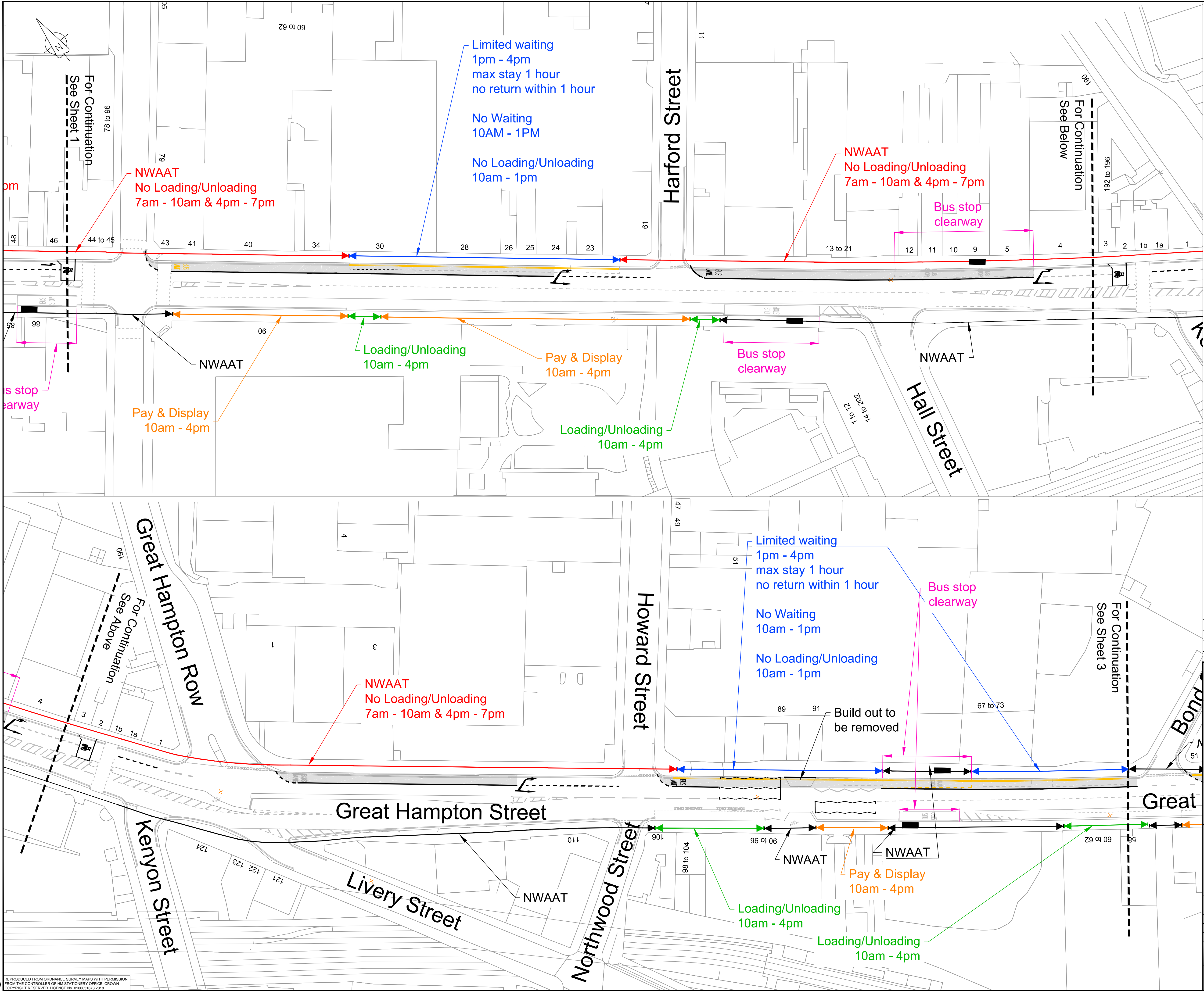

Notes:

- 1) Drawing to be printed in colour.
- 2) Do not scale from this drawing.
- 3) This drawing was produced for consultation purposes only.

Key:

- Bus lane:  
7am - 10am & 4pm - 7pm  
(colour shown for presentation only)
- Existing bus stop to be retained
- Loading/Unloading 10am-4pm
- No Waiting At Any Time (NWAAT)
- Pay & Display 10am-4pm
- Bus stop clearway
- No Waiting At Any Time; No Loading/Unloading  
7am - 10am & 4pm - 7pm
- Limited waiting 1pm-4pm  
max stay 1 hour; no return within 1 hour; No Waiting  
10am - 1pm; No Loading/Unloading 10am - 1pm

P00	20/05/19	FOR INFORMATION	MP	DM	DM	PE
Rev	Rev. Date	Purpose of revision	Drawn	Checked	Rev'd	Appr'd

**JACOBS**  
7th Floor, 2 Colmore Square, 38 Colmore Circus  
Queensway, Birmingham, B4 6BN  
Tel: +44(0)121 237 4000 www.jacobs.com

**Birmingham City Council**

Project  
**CLEAN AIR ZONE  
(EARLY MEASURES-BUS PRIORITY SCHEMES)**

Drawing title  
**HOCKLEY HILL  
PUBLIC CONSULTATION  
OPTION B  
SHEET 2 OF 3**

Drawing status	FIT FOR INFORMATION	
Scale	NTS	DO NOT SCALE
Jacobs No.	B2309014	
Client no.	1807-06	
Drawing number	B2309014-JAC-CON-04_01-DR-CH-1006	Rev P00

© Copyright 2019 Jacobs U.K. Limited. The concepts and information contained in this document are the property of Jacobs. Use or copying of this document in whole or in part without the written permission of Jacobs constitutes an infringement of copyright. Limitation. This drawing has been prepared on behalf of, and for the exclusive use of, the Client. Jacobs accepts no liability or responsibility whatsoever for, or in respect of, any use of, or reliance upon, this drawing by any third party.



B2309014 - BCC Clean Air Zone ServicesB2309014 CAZ Early Measures Bus Schemes06 Drawings04 Hockley Hill0000 ConsultationB2309014-JAC-CON-04\_01-DR-CH-1007 P00.1.dwg - 20/05/2019 12:52:55 - Sheet01 - mtrud

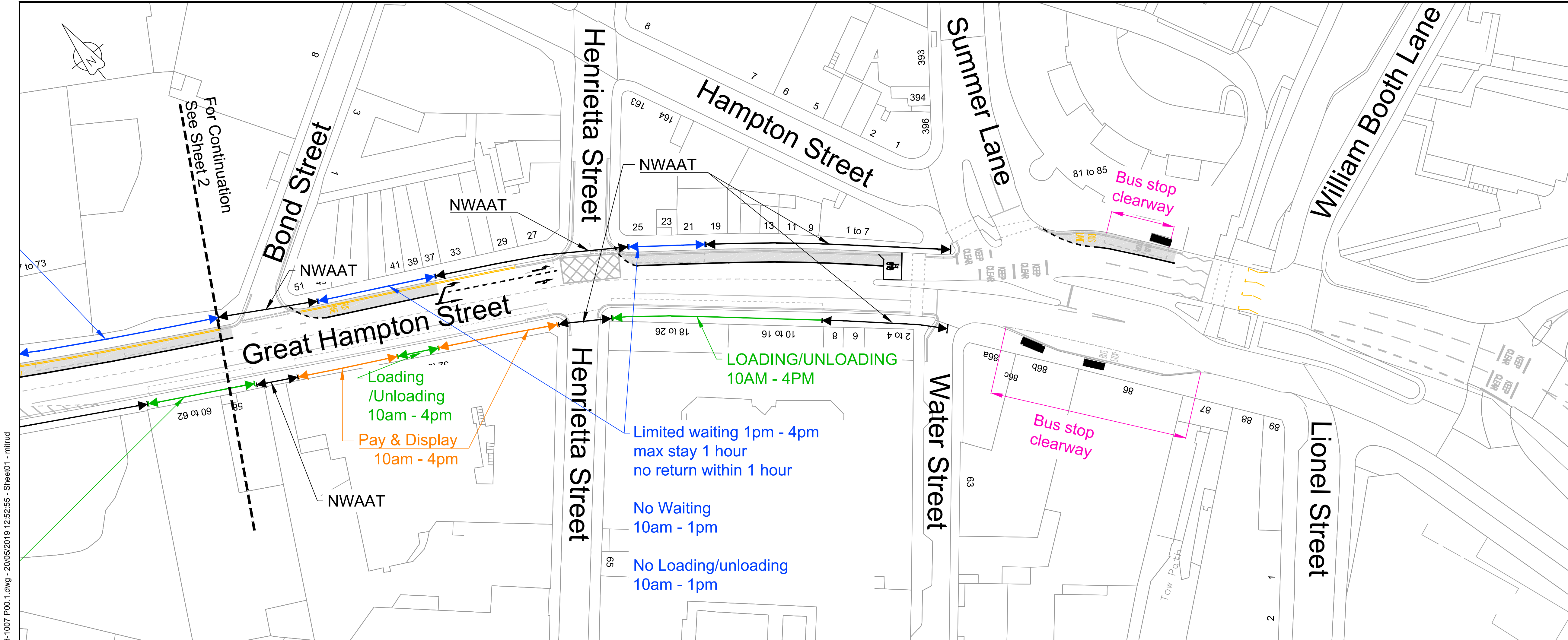

Notes:

- 1) Drawing to be printed in colour.
- 2) Do not scale from this drawing.
- 3) This drawing was produced for consultation purposes only.

Key:

- Bus lane:  
7am - 10am & 4pm - 7pm  
(colour shown for presentation only)
- Existing bus stop to be retained
- Loading/Unloading 10am-4pm
- No Waiting At Any Time (NWAAT)
- Pay & Display 10am-4pm
- Bus stop clearway
- No Waiting At Any Time; No Loading/Unloading  
7am - 10am & 4pm - 7pm
- Limited waiting 1pm-4pm  
max stay 1 hour; no return within 1 hour; No Waiting 10am - 1pm; No Loading/Unloading 10am - 1pm

P00	20/05/19	FOR INFORMATION	MP	DM	DM	PE	
Rev	Rev. Date	Purpose of revision	Drawn	Checked	Rev'd	Apprv'd	

**JACOBS**  
7th Floor, 2 Colmore Square, 38 Colmore Circus  
Queensway, Birmingham, B4 6BN  
Tel: +44(0)121 237 4000 www.jacobs.com



Project  
**CLEAN AIR ZONE  
(EARLY MEASURES-BUS PRIORITY SCHEMES)**

Drawing title  
**HOCKLEY HILL  
PUBLIC CONSULTATION  
OPTION B  
SHEET 3 OF 3**

Drawing status	FIT FOR INFORMATION	
Scale	NTS	DO NOT SCALE
Jacobs No.	B2309014	
Client no.	1807-06	
Drawing number	B2309014-JAC-CON-04_01-DR-CH-1007	Rev P00

© Copyright 2019 Jacobs U.K. Limited. The concepts and information contained in this document are the property of Jacobs. Use or copying of this document in whole or in part without the written permission of Jacobs constitutes an infringement of copyright. Limitation: This drawing has been prepared on behalf of, and for the exclusive use of, Jacobs' Client, and is subject to, and issued in accordance with, the provisions of the contract between Jacobs and the Client. Jacobs accepts no liability or responsibility whatsoever for, or in respect of, any use of, or reliance upon, this drawing by any third party.