













- Notes:**
1. All dimensions in metres unless stated otherwise.
  2. Do not scale from this drawing.
  3. Break in cycle buffer required at vehicle accesses.
  4. Proposed road markings are indicative.
  5. Blue colouring is for illustrative purposes, the route will have blue surfacing at key points only (e.g. at junctions).

Key:

-  OS base
-  Highway boundary
-  Proposed cycleway at carriageway level
-  Proposed cycleway at footway level
-  Footway
-  Shared footway/cycleway
-  Proposed lane separator unit
-  Proposed Dutch style entrance kerbing
-  Proposed kerbing
-  Proposed car bays
-  Proposed City Centre Segments parking bays
-  Existing trees

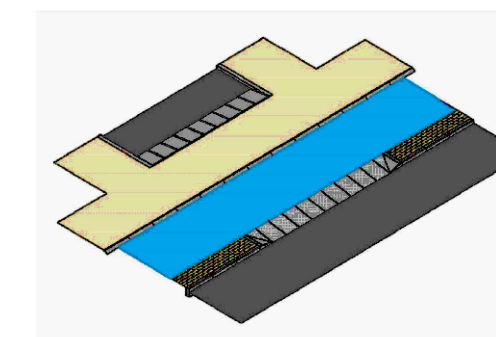

### DUTCH ENTRANCE ILLUSTRATION



### EXAMPLE OF LANE SEPARATOR UNIT

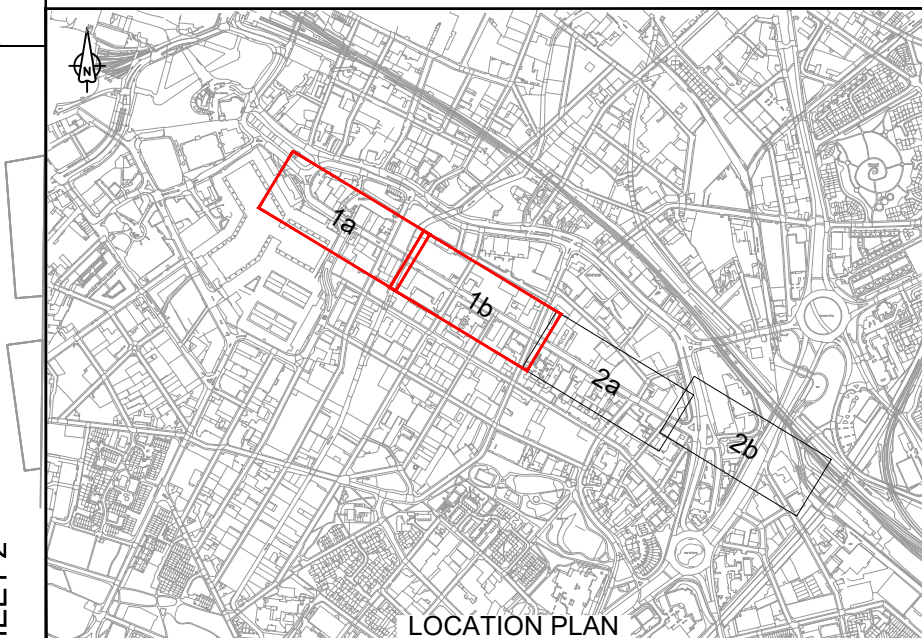

### LOCATION PLAN

P00	20/08/21	SUITABLE FOR REVIEW AND COMMENT	KG	MH	MP	MF
P01	14/10/21	SUITABLE FOR CONSULTATION	KG	MH	MP	MF
P02	22/10/21	SUITABLE FOR CONSULTATION	KG	MH	MP	MF
P03	28/10/21	SUITABLE FOR CONSULTATION	MP	KG	KG	MF
P04	01/11/21	SUITABLE FOR CONSULTATION	KG	MH	MH	MF
Rev	Rev. Date	Purpose of revision	Drawn	Checked	Rev'd	Approved

246 **Designers**

# Jacobs

7th Floor, 2 Colmore Square, 38 Colmore Circus  
Queensway, Birmingham, B4 6BN  
Tel: +44(0)121 237 4000 [www.jacobs.com](http://www.jacobs.com)

Client



Project

ACTIVE TRAVEL FUND  
TRANCHE 2

Drawing title
---------------

BRADFORD STREET  
CYCLE LANES  
CONSULTATION PLANS  
SHEET 1 OF 2

Drawing status

S2 - SUITABLE FOR INFORMATION

Scale

Scale	1:500@AT
Jacobs No	B2309512

	Jacobs No.
	Client no.

Client no.		104
Drawing number	B2309512-JAC-HGN-05-DR-CH-0010	

© Copyright 2021 Jacobs U.K. Limited. The concepts and information contained in this document are the property of Jacobs. Use or copying of this document in whole or in part without the written permission of Jacobs constitutes an infringement of copyright. Limitation: This drawing has been prepared on behalf of, and for the exclusive use of Jacobs' Client, and is subject to, and issued in accordance with, the provisions of the contract between Jacobs and the Client. Jacobs accepts no liability for any situation that arises out of the use of this drawing in any form, or for any consequences that may arise therefrom.



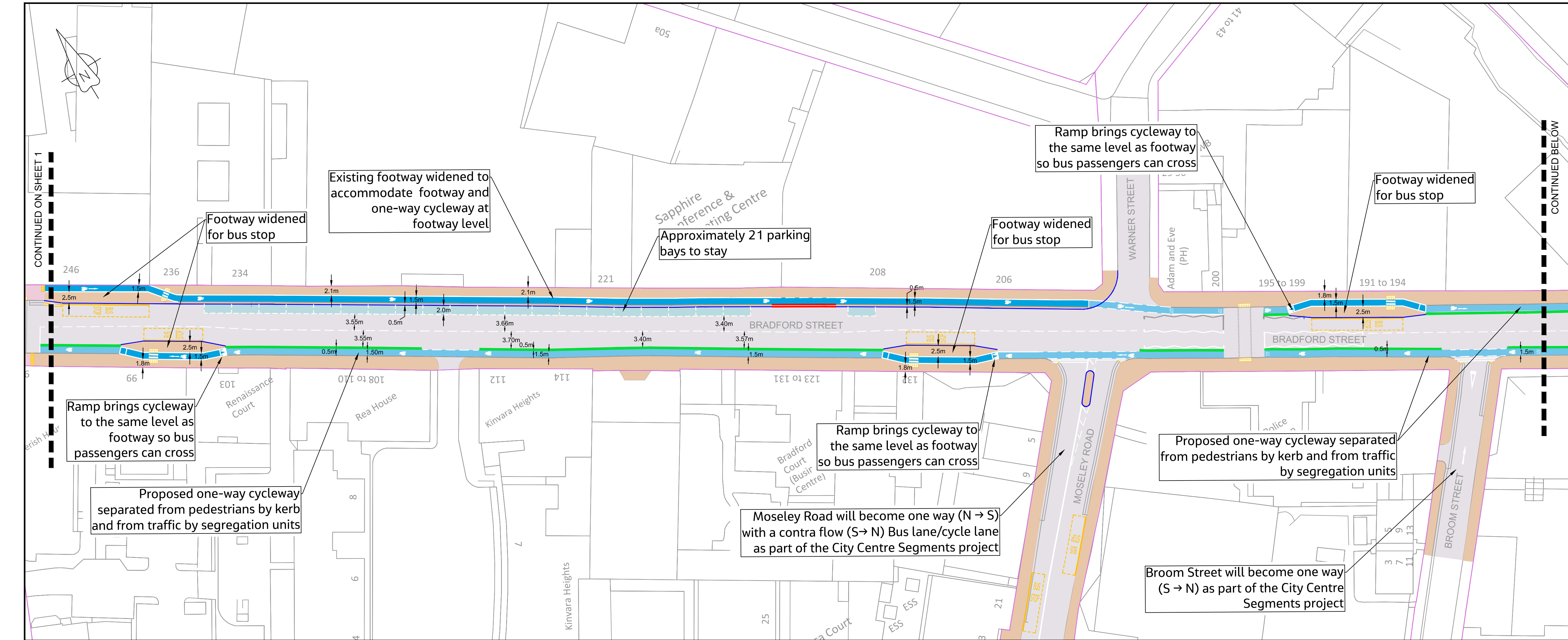

- Notes:
1. All dimensions in metres unless stated otherwise.
  2. Do not scale from this drawing.
  3. Break in cycle buffer required at vehicle accesses.
  4. Proposed road markings are indicative.
  5. Blue colouring is for illustrative purposes, the route will have blue surfacing at key points only (e.g. at junctions).

- Key:
- OS base
  - Highway boundary
  - Proposed cycleway at carriageway level
  - Proposed cycleway at footway level
  - Footway
  - Shared footway/cycleway
  - Proposed lane separator unit
  - Proposed Dutch style entrance kerbing
  - Proposed kerbing
  - Proposed car bays
  - Proposed City Centre Segments parking bays
  - Existing trees

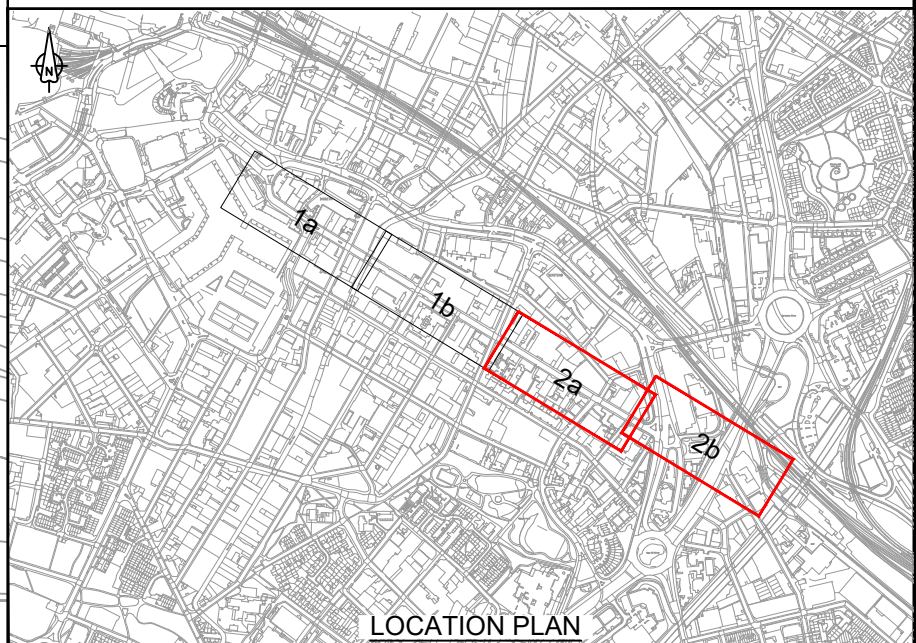
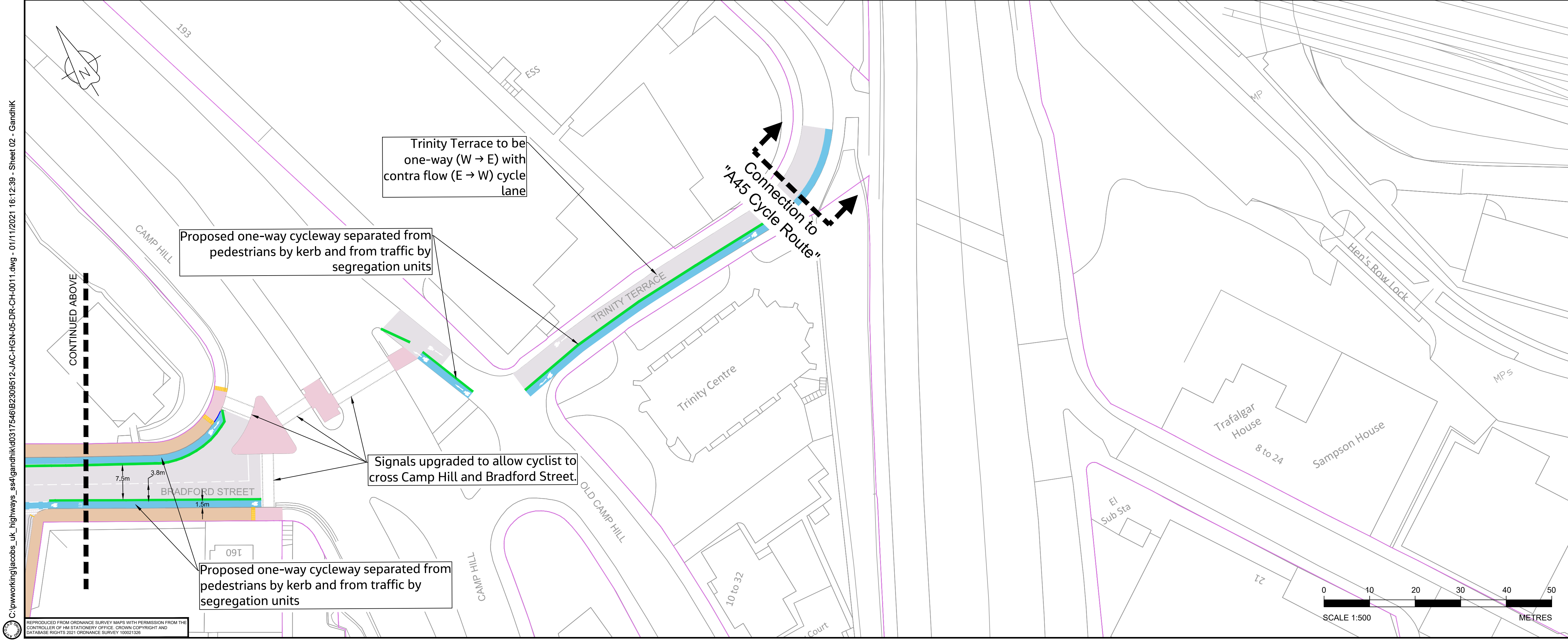
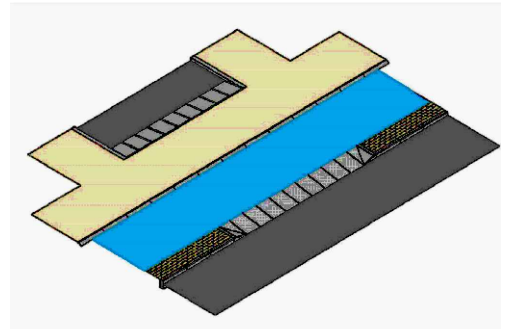

Rev	Rev. Date	Purpose of revision	Drawn	Checked	Rev'd	App'd
P00	20/08/21	SUITABLE FOR REVIEW AND COMMENT	KG	MH	MP	MP
P01	14/10/21	SUITABLE FOR CONSULTATION	KG	MH	MP	MP
P02	22/10/21	SUITABLE FOR CONSULTATION	KG	MH	MP	MP
P03	28/10/21	SUITABLE FOR CONSULTATION	MP	KG	KG	MP
P04	01/11/21	SUITABLE FOR CONSULTATION	KG	MH	MH	MP

Designer:

**Jacobs**

7th Floor, 2 Colmore Square, 38 Colmore Circus  
Queensway, Birmingham, B4 6BN  
Tel: +44(0)121 237 4000 www.jacobs.com

Client:

**Birmingham City Council**

**West Midlands Cycle & Walk**

Project:

ACTIVE TRAVEL FUND  
TRANCHE 2

Drawing title:

BRADFORD STREET  
CYCLE LANES  
CONSULTATION PLANS  
SHEET 2 OF 2

Drawing status:

S2 - SUITABLE FOR INFORMATION

Scale:

1:500@A1

DO NOT SCALE

Jacobs No.:

B2309512

Rev:

P04

Client no.:

Drawing number:

B2309512-JAC-HGN-05-DR-CH-0011

© Copyright 2021 Jacobs U.K. Limited. The concepts and information contained in this document are the property of Jacobs. Use or copying of this document in whole or in part without the written permission of Jacobs constitutes an infringement of copyright. Limitation: This drawing has been prepared on behalf of, and for the exclusive use of, Jacobs' Client, and is subject to, and issued in accordance with, the provisions of the contract between Jacobs and the Client. Jacobs accepts no liability or responsibility whatsoever for, or in respect of, any use of, or reliance upon, this drawing by any third party.