

SIGN SCHEDULE

- Notes:**
- All signs to be in accordance with the Traffic Signs Regulations and General Directions (TSRGD) 2016 and amendments
 - Mounting height to be a minimum of 2.1m above pedestrian footways or 2.3m where cycle movements allowed
 - Minimum 450mm clearance to be provided between edge of carriageway and sign
 - Exact sign installation arrangement to be determined by the Contractor on site
 - Signs should be mounted on existing street furniture where feasible
 - Where new post installation is required, a portable foundation base (NAL Temporary Foundations or similar) is to be used
 - For signs that require direct illumination, a solar power lighting unit (Simmonsigns' Solar LUA or similar) is to be used
 - No excavation is expected for the proposed sign installation. Where excavation is deemed to be required due to specific site constraints, the Contractor shall ensure existing utilities are determined

Sign Ref	TSRGD Diagram No.	Description	x-height (mm)	Width (mm)	Height (mm)	Directly Lit?	Preferred Installation Arrangement
S01	616	No entry		450	450	Yes	On new post
S02A	616	No entry		450	450	Yes	On new post
S02B	-	'Except Cycles' Plate	50	435	290	n/a	
S03A	960.1v	Mandatory contra-flow cycle lane		825	475	Yes	On existing light column
S03B	606	Turn left		450	450	Yes	n/a
S03C	-	'One way' Plate	50	515	190	n/a	
S04	-	Cyclists dismount at crossing	35	570	270	No	On existing street furniture, signal pole or guardrail
S05	960.1v	Mandatory contra-flow cycle lane		825	475	Yes	On new post
S06	960.1v	Mandatory contra-flow cycle lane		825	475	Yes	On existing light column
S07	956	Shared use footway		450	450	No	On existing pole, replacing 'End of Route' Sign
S08	-	Cyclists dismount at crossing	35	570	270	No	On existing street furniture, signal pole or guardrail
S09	-	Cyclists dismount at crossing	35	570	270	No	On existing street furniture, signal pole or guardrail
S10	956	Shared use footway		150	150	No	On new bollard
S11	956	Shared use footway		150	150	No	On new bollard
S12	-	Cyclists dismount at crossing	35	570	270	No	On existing street furniture, signal pole or guardrail
S13	-	Cyclists dismount at crossing	35	570	270	No	On existing street furniture, signal pole or guardrail
S14	-	Cyclists dismount at crossing	35	570	270	No	On existing street furniture, signal pole or guardrail
S15	956	Shared use footway		150	150	No	On new bollard
S16	956	Shared use footway		150	150	No	On new bollard
S17	956	Shared use footway		150	150	No	On new bollard
S18	956	Shared use footway		150	150	No	On new bollard
S19	956	Shared use footway		150	150	No	On new bollard
S20	-	Cyclists dismount at crossing	35	570	270	No	On existing street furniture, signal pole or guardrail
S21	956	Shared use footway		150	150	No	On new bollard
S22	956	Shared use footway		150	150	No	On new bollard
S23	652	One-way traffic		300	450	Yes	On new post
S24	652	One-way traffic		300	450	Yes	On new post
S25A	606	Turn left		450	450	Yes	On existing light column
S25B	-	'One way' Plate	50	515	190	n/a	
S26A	613	No left turn		450	450	Yes	On new post
S26B	-	'Except Cycles' Plate	50	435	290	n/a	
S26C	616	No entry		450	450	Yes	n/a
S27A	616	No entry		450	450	Yes	On new post
S27B	-	'Except Cycles' Plate	50	435	290	n/a	
S28	652	One-way traffic		300	450	Yes	On new post
S29	616	No entry		450	450	Yes	On new post
S30A	616	No entry		450	450	Yes	On new post
S30B	-	'Except Cycles' Plate	50	435	290	n/a	
S31A	616	No entry		450	450	Yes	On new post
S31B	-	'Except Cycles' Plate	50	435	290	n/a	
S32	616	No entry		450	450	Yes	On new post
S33A	616	No entry		450	450	Yes	On new post
S33B	-	'Except Cycles' Plate	50	435	290	n/a	
S34	957	Shared use footway		150	150	No	On new bollard
S35	652	One-way traffic		300	450	Yes	On new post
S36	652	One-way traffic		300	450	Yes	On existing light column
S37	652	One-way traffic		300	450	Yes	On new post
S38	652	One-way traffic		300	450	Yes	On existing light column
S39	652	One-way traffic		300	450	Yes	On new post
S40	652	One-way traffic		300	450	Yes	On existing light column
S41	956	Shared use footway		150	150	No	On new bollard
S42	956	Shared use footway		150	150	No	On new bollard
S43	956	Shared use footway		150	150	No	On new bollard
S44	652	One-way traffic		300	450	Yes	On new post
S45	652	One-way traffic		300	450	Yes	On new post
S46	956	Shared use footway		150	150	No	On new bollard
S47	956	Shared use footway		150	150	No	On new bollard
S48	956	Shared use footway		150	150	No	On new bollard
S49	956	Shared use footway		150	150	No	On new bollard
S50	956	Shared use footway		150	150	No	On new bollard
S51	956	Shared use footway		150	150	No	On new bollard
S52	956	Shared use footway		150	150	No	On new bollard
S53	956	Shared use footway		150	150	No	On new bollard
S54	-	Cyclists dismount at crossing	35	570	270	No	On existing street furniture, signal pole or guardrail
S55	956	Shared use footway		150	150	No	On new bollard
S56	956	Shared use footway		150	150	No	On new bollard
S57	-	Cyclists dismount at crossing	35	570	270	No	On existing street furniture, signal pole or guardrail
S58	-	Cyclists dismount at crossing	35	570	270	No	On existing street furniture, signal pole or guardrail
S59	956	Shared use footway		150	150	No	On new bollard
S60	-	Cyclists dismount at crossing	35	570	270	No	On existing street furniture, signal pole or guardrail
S61	-	Cyclists dismount at crossing	35	570	270	No	On existing street furniture, signal pole or guardrail
S62	956	Shared use footway		150	150	No	On new bollard
S63	-	Cyclists dismount at crossing	35	570	270	No	On existing street furniture, signal pole or guardrail
S64	956	Shared use footway		150	150	No	On new bollard
S65A	606	Turn left		450	450	Yes	On new post
S65B	-	'One way' Plate	50	515	190	n/a	
S66A	606	Turn left		450	450	Yes	On new post
S66B	-	'One way' Plate	50	515	190	n/a	
S67A	606	Turn left		450	450	Yes	On new post
S67B	-	'One way' Plate	50	515	190	n/a	
S68A	606	Turn left		450	450	Yes	On new post
S68B	-	'One way' Plate	50	515	190	n/a	
S69	956	Shared use footway		150	150	No	On new bollard
S70	-	'Except Cycles' Plate	50	435	290	n/a	On existing post
S71	517	Road narrows		600	680	n/a	On new post

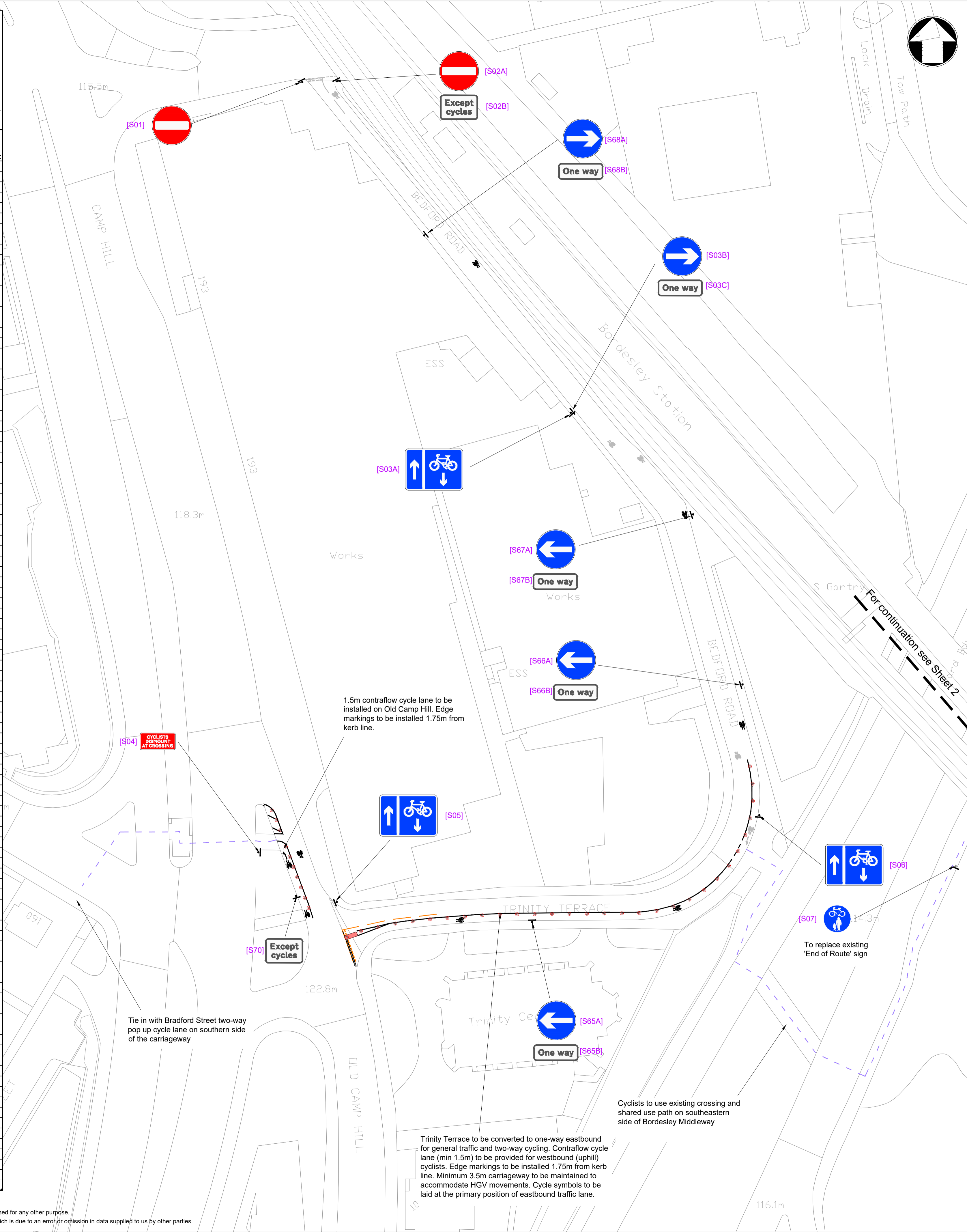

- Notes**
- Existing road markings and street furniture arrangements are indicative and for the purposes of illustrating proposed design arrangements only. Not all arrangements are shown and they are subject to verification on site.
 - Where existing speed cushions intersect proposed cycle lanes, the speed cushion is to be removed and made level. Method to be proposed by the Contractor.
 - Where temporary footway buildout is to be constructed, the Contractor is to incorporate temporary drainage system and maintain access to utility chambers.
 - Unless otherwise specified, existing signs in conflict with proposed arrangement are to be covered or removed.
 - Refer to Sign Schedule and associated notes for traffic signs arrangement.
 - Where existing vegetation encroaches on proposed cycle track or obstructs visibility of proposed signs, vegetation is to be cut back.
 - Localised carriageway repair should be undertaken where appropriate, in consultation with BCC.

Key to symbols

In general, arrangements and symbols shown in:

- GREY represents existing to be retained
- ORANGE represents existing to be removed
- ANY OTHER COLOUR represents proposed

- Symbols:**
- Proposed route for cyclists (wayfinding provisions to be determined)
 - Proposed kerbline
 - Proposed sign installation (see sign schedule)
 - Proposed plastic wand (nominal 2.5m spacing unless specified)
 - Proposed new footway construction
 - Proposed coloured surface treatment (exact colour to be agreed with BCC)
 - Proposed temporary surface matting
 - Proposed tactile paving (corduroy hazard warning)
 - Proposed tactile paving (ladder and tramline)

Reference drawings

Rev	Date	Drawn	Description	Ch'k'd	App'd
A	29/07/2020	JM	For Construction	PJC	CS
P01	24/07/2020	JM	First Issue	PJC	CS

MOTT MACDONALD

35 Newhall Street
Birmingham
B3 3PU
United Kingdom

T +44 (0)121 234 1500
F 44 (0)121 200 3295
W mottmac.com

Client

Birmingham City Council

Title

EBTP Road Space Reallocation
Developed Design
Pop-up Cycle Lanes: City Centre to Small Heath (A45 corridor)
Sheet 1

Designed	J.Man	JM	Eng check	P.Crowther	PJC
Drawn	J.Man	JM	Coordination	C.Kwok	CK
Dwg check	P.Crowther	PJC	Approved	C.Searson	CS
Scale at A1	Status	Rev	Security		
1:500	CON	A	STD		
Drawing Number					
419867-MMD-C01-XX-DR-D-0101					

© Crown copyright and database rights 2020 OS [100021326]
This document is issued for the party which commissioned it and for specific purposes connected with the captioned project only. It should not be relied upon by any other party or used for any other purpose.
We accept no responsibility for the consequences of this document being relied upon by any other party, or being used for any other purpose, or containing any error or omission which is due to an error or omission in data supplied to us by other parties.

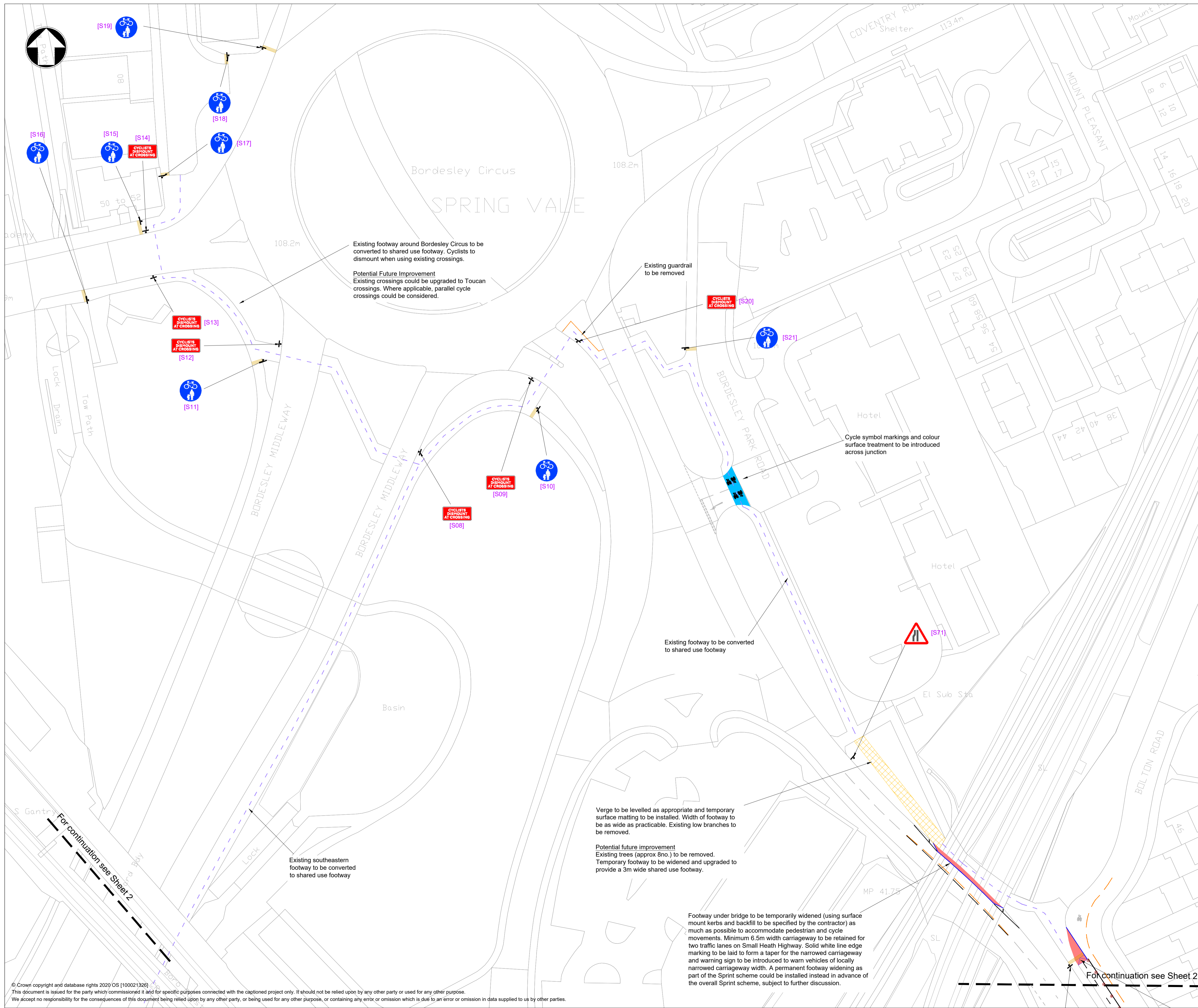

- Notes**
- Existing road markings and street furniture arrangements are indicative and for the purposes of illustrating proposed design arrangements only. Not all arrangements are shown and they are subject to verification on site.
 - Where existing speed cushions intersect proposed cycle lanes, the speed cushion is to be removed and made level. Method to be proposed by the Contractor.
 - Where temporary footway buildout is to be constructed, the Contractor is to incorporate temporary drainage system and maintain access to utility chambers.
 - Unless otherwise specified, existing signs in conflict with proposed arrangement are to be covered or removed.
 - Refer to Sign Schedule and associated notes for traffic signs arrangement.
 - Where existing vegetation encroaches on proposed cycle track or obstructs visibility of proposed signs, vegetation is to be cut back.
 - Localised carriageway repair should be undertaken where appropriate, in consultation with BCC.

Key to symbols

In general, arrangements and symbols shown in:

- GREY represents existing to be retained
- ORANGE represents existing to be removed
- ANY OTHER COLOUR represents proposed

Symbols:

- Proposed route for cyclists (wayfinding provisions to be determined)
- Proposed kerbline
- Proposed sign installation (see sign schedule)
- Proposed plastic wand (nominal 2.5m spacing unless specified)
- Proposed new footway construction
- Proposed coloured surface treatment (exact colour to be agreed with BCC)
- Proposed temporary surface matting
- Proposed tactile paving (corduroy hazard warning)
- Proposed tactile paving (ladder and tramline)

Reference drawings

Rev	Date	Drawn	Description	Ch'k'd	App'd
A	29/07/2020	JM	For Construction	PJC	CS
P01	24/07/2020	JM	First Issue	PJC	CS

MOTT MACDONALD

35 Newhall Street
Birmingham
B3 3PU
United Kingdom

T +44 (0)121 234 1500
F 44 (0)121 200 3295
W mottmac.com

Client

Birmingham City Council

Title

**EBTP Road Space Reallocation
Developed Design
Pop-up Cycle Lanes: City Centre to
Small Heath (A45 corridor)
Sheet 2**

Designed	J.Man	JM	Eng check	P.Crowther	PJC
Drawn	J.Man	JM	Coordination	C.Kwok	CK
Dwg check	P.Crowther	PJC	Approved	C.Searson	CS
Scale at A1	Status	Rev	Security		
1:500	CON	A	STD		

Drawing Number
419867-MMD-C01-XX-DR-D-0102

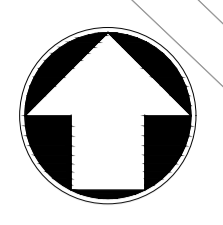
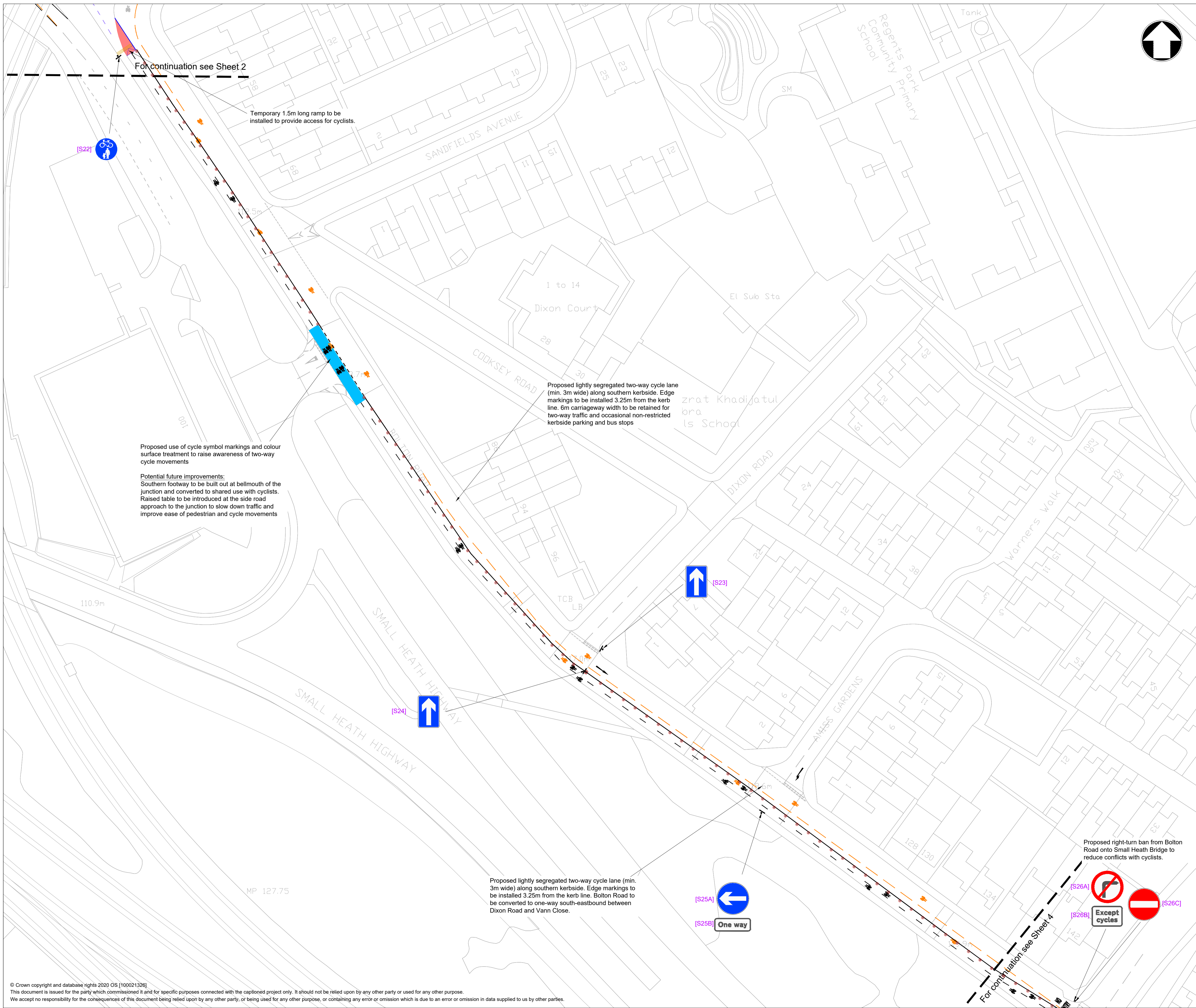

- Notes
- Existing road markings and street furniture arrangements are indicative and for the purposes of illustrating proposed design arrangements only. Not all arrangements are shown and they are subject to verification on site.
 - Where existing speed cushions intersect proposed cycle lanes, the speed cushion is to be removed and made level. Method to be proposed by the Contractor.
 - Where temporary footway buildout is to be constructed, the Contractor is to incorporate temporary drainage system and maintain access to utility chambers.
 - Unless otherwise specified, existing signs in conflict with proposed arrangement are to be covered or removed.
 - Refer to Sign Schedule and associated notes for traffic signs arrangement.
 - Where existing vegetation encroaches on proposed cycle track or obstructs visibility of proposed signs, vegetation is to be cut back.
 - Localised carriageway repair should be undertaken where appropriate, in consultation with BCC.

Key to symbols

In general, arrangements and symbols shown in:

- GREY represents existing to be retained
- ORANGE represents existing to be removed
- ANY OTHER COLOUR represents proposed

Symbols:

- Proposed route for cyclists (wayfinding provisions to be determined)
- Proposed kerbline
- Proposed sign installation (see sign schedule)
- Proposed plastic wand (nominal 2.5m spacing unless specified)
- Proposed new footway construction
- Proposed coloured surface treatment (exact colour to be agreed with BCC)
- Proposed temporary surface matting
- Proposed tactile paving (corduroy hazard warning)
- Proposed tactile paving (ladder and tramline)

Reference drawings

Rev	Date	Drawn	Description	Ch'k'd	App'd
A	29/07/2020	JM	For Construction	PJC	CS
P01	24/07/2020	JM	First Issue	PJC	CS

MOTT MACDONALD

35 Newhall Street
Birmingham
B3 3PU
United Kingdom

T +44 (0)121 234 1500
F 44 (0)121 200 3295
W mottmac.com

Client

Birmingham City Council

Title

**EBTP Road Space Reallocation
Developed Design
Pop-up Cycle Lanes: City Centre to
Small Heath (A45 corridor)
Sheet 3**

Designed	J.Man	JM	Eng check	P.Crowther	PJC
Drawn	J.Man	JM	Coordination	C.Kwok	CK
Dwg check	P.Crowther	PJC	Approved	C.Season	CS
Scale at A1	1:500	Status	CON	Rev	A
		Security	STD		
Drawing Number	419867-MMD-C01-XX-DR-D-0103				

© Crown copyright and database rights 2020 OS [100021326]
This document is issued for the party which commissioned it and for specific purposes connected with the captioned project only. It should not be relied upon by any other party or used for any other purpose.
We accept no responsibility for the consequences of this document being relied upon by any other party, or being used for any other purpose, or containing any error or omission which is due to an error or omission in data supplied to us by other parties.

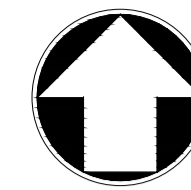
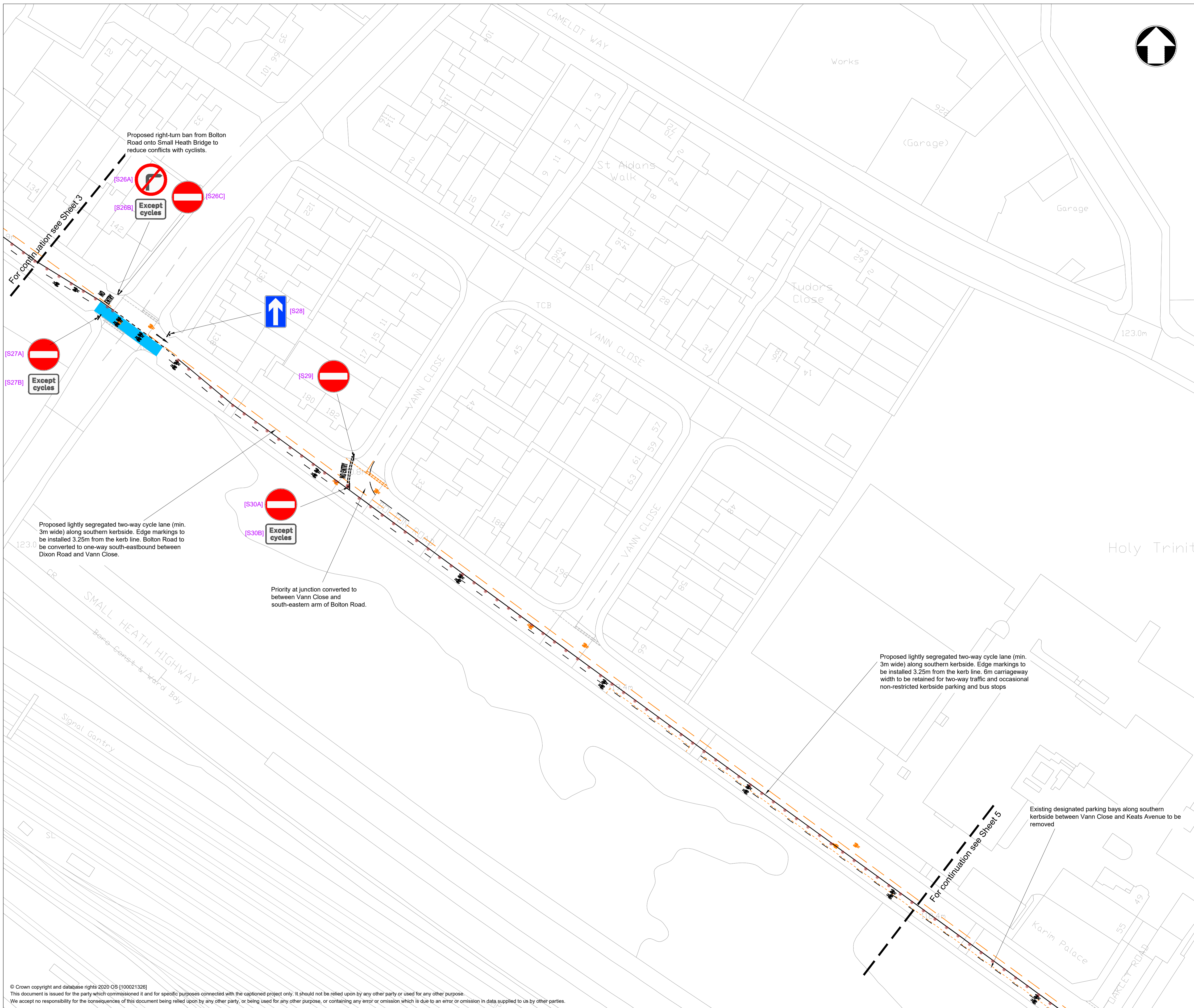

- Notes**
- Existing road markings and street furniture arrangements are indicative and for the purposes of illustrating proposed design arrangements only. Not all arrangements are shown and they are subject to verification on site.
 - Where existing speed cushions intersect proposed cycle lanes, the speed cushion is to be removed and made level. Method to be proposed by the Contractor.
 - Where temporary footway buildout is to be constructed, the Contractor is to incorporate temporary drainage system and maintain access to utility chambers.
 - Unless otherwise specified, existing signs in conflict with proposed arrangement are to be covered or removed.
 - Refer to Sign Schedule and associated notes for traffic signs arrangement.
 - Where existing vegetation encroaches on proposed cycle track or obstructs visibility of proposed signs, vegetation is to be cut back.
 - Localised carriageway repair should be undertaken where appropriate, in consultation with BCC.

Key to symbols

In general, arrangements and symbols shown in:

- GREY represents existing to be retained
- ORANGE represents existing to be removed
- ANY OTHER COLOUR represents proposed

Symbols:

- Proposed route for cyclists (wayfinding provisions to be determined)
- Proposed kerblines
- Proposed sign installation (see sign schedule)
- Proposed plastic wand (nominal 2.5m spacing unless specified)
- Proposed new footway construction
- Proposed coloured surface treatment (exact colour to be agreed with BCC)
- Proposed temporary surface matting
- Proposed tactile paving (corduroy hazard warning)
- Proposed tactile paving (ladder and tramline)

Reference drawings

A	Date	Drawn	Description	Ch'k'd	App'd
A	29/07/2020	JM	For Construction	PJC	CS
P01	24/07/2020	JM	First Issue	PJC	CS

MOTT MACDONALD

35 Newhall Street
Birmingham
B3 3PU
United Kingdom

T +44 (0)121 234 1500
F 44 (0)121 200 3295
W mottmac.com

Client

Birmingham City Council

Title

EBTP Road Space Reallocation
Developed Design
Pop-up Cycle Lanes: City Centre to
Small Heath (A45 corridor)
Sheet 4

Designed	J.Man	JM	Eng check	P.Crowther	PJC
Drawn	J.Man	JM	Coordination	C.Kwok	CK
Dwg check	P.Crowther	PJC	Approved	C.Searson	CS
Scale at A1	1:500	Status	CON	Rev	A
		Security			STD
Drawing Number					
419867-MMD-C01-XX-DR-D-0104					

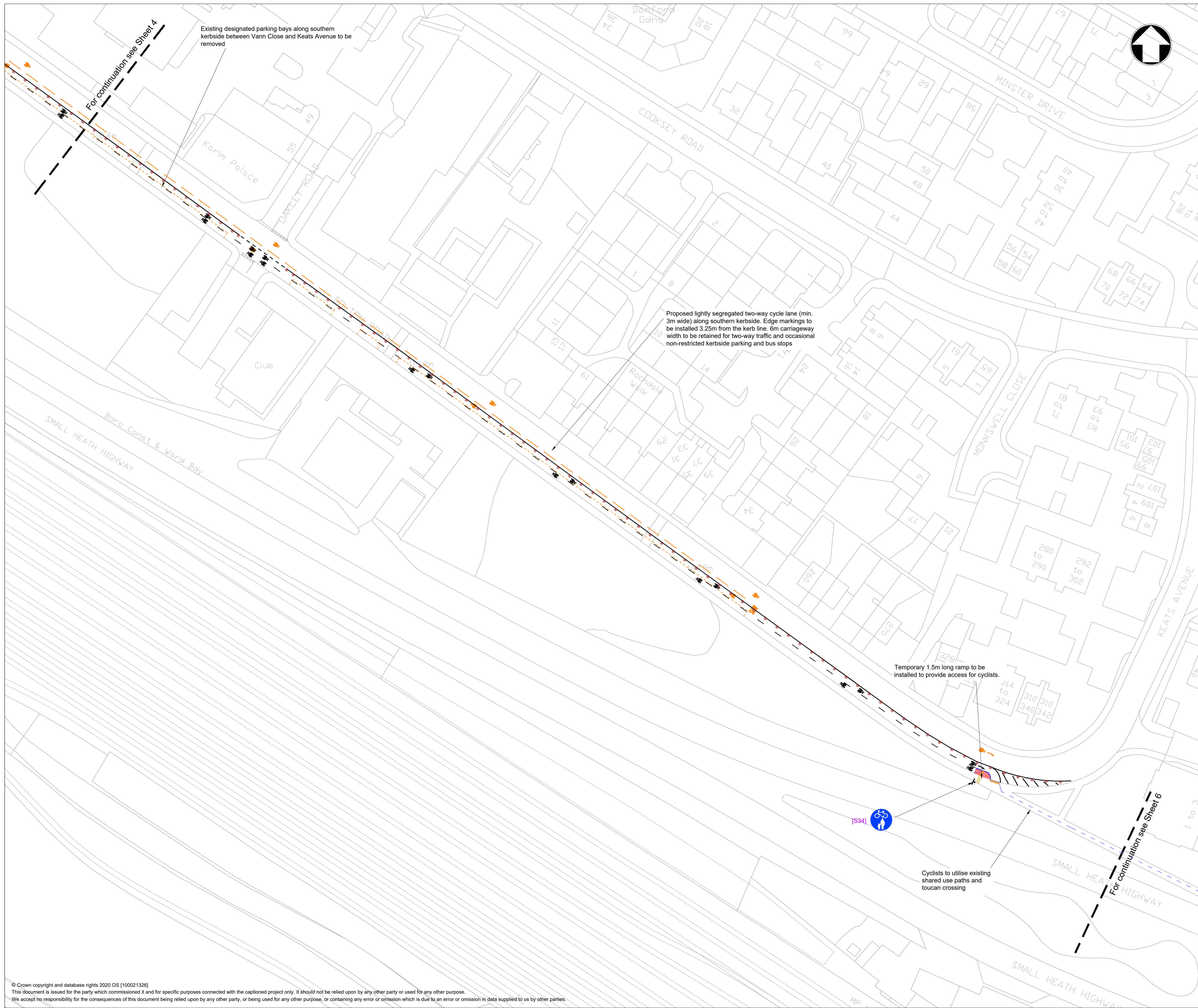

Existing designated parking bays along southern kerbside between Vann Close and Keats Avenue to be removed

Proposed lightly segregated two-way cycle lane (min. 3m wide) along southern kerbside. Edge markings to be installed 3.25m from the kerb line. 6m carriageway width to be retained for two-way traffic and occasional non-restricted kerbside parking and bus stops

Temporary 1.5m long ramp to be installed to provide access for cyclists.

Cyclists to utilise existing shared use paths and toucan crossing

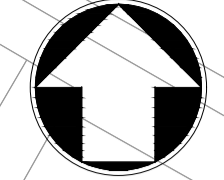

For continuation see Sheet 4

For continuation see Sheet 6

- Notes
- Existing road markings and street furniture arrangements are indicative and for the purposes of illustrating proposed design arrangements only. Not all arrangements are shown and they are subject to verification on site.
 - Where existing speed cushions intersect proposed cycle lanes, the speed cushion is to be removed and made level. Method to be proposed by the Contractor.
 - Where temporary footway buildout is to be constructed, the Contractor is to incorporate temporary drainage system and maintain access to utility chambers.
 - Unless otherwise specified, existing signs in conflict with proposed arrangement are to be covered or removed.
 - Refer to Sign Schedule and associated notes for traffic signs arrangement.
 - Where existing vegetation encroaches on proposed cycle track or obstructs visibility of proposed signs, vegetation is to be cut back.
 - Localised carriageway repair should be undertaken where appropriate, in consultation with BCC.

Key to symbols

In general, arrangements and symbols shown in:

- GREY represents existing to be retained
- ORANGE represents existing to be removed
- ANY OTHER COLOUR represents proposed

- Symbols:
- Proposed route for cyclists (wayfinding provisions to be determined)
 - Proposed kerblines
 - Proposed sign installation (see sign schedule)
 - Proposed plastic wand (nominal 2.5m spacing unless specified)
 - Proposed new footway construction
 - Proposed coloured surface treatment (exact colour to be agreed with BCC)
 - Proposed temporary surface matting
 - Proposed tactile paving (corduroy hazard warning)
 - Proposed tactile paving (ladder and tramline)

Reference drawings

Rev	Date	Drawn	Description	Ch'k'd	App'd
A	29/07/2020	JM	For Construction	PJC	CS
P01	24/07/2020	JM	First Issue	PJC	CS

MOTT MACDONALD

35 Newhall Street
Birmingham
B3 3PU
United Kingdom

T +44 (0)121 234 1500
F 44 (0)121 200 3295
W mottmac.com

Client

Birmingham City Council

Title

**EBTP Road Space Reallocation
Developed Design
Pop-up Cycle Lanes: City Centre to
Small Heath (A45 corridor)
Sheet 5**

Designed	J.Man	JM	Eng check	P.Crowther	PJC
Drawn	J.Man	JM	Coordination	C.Kwok	CK
Dwg check	P.Crowther	PJC	Approved	C.Searson	CS
Scale at A1	Status	Rev	Security		
1:500	CON	A	STD		
Drawing Number					
419867-MMD-C01-XX-DR-D-0105					

© Crown copyright and database rights 2020 OS [100021326]
This document is issued for the party which commissioned it and for specific purposes connected with the captioned project only. It should not be relied upon by any other party or used for any other purpose.
We accept no responsibility for the consequences of this document being relied upon by any other party, or being used for any other purpose, or containing any error or omission which is due to an error or omission in data supplied to us by other parties.

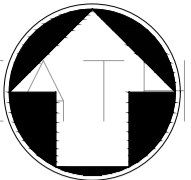
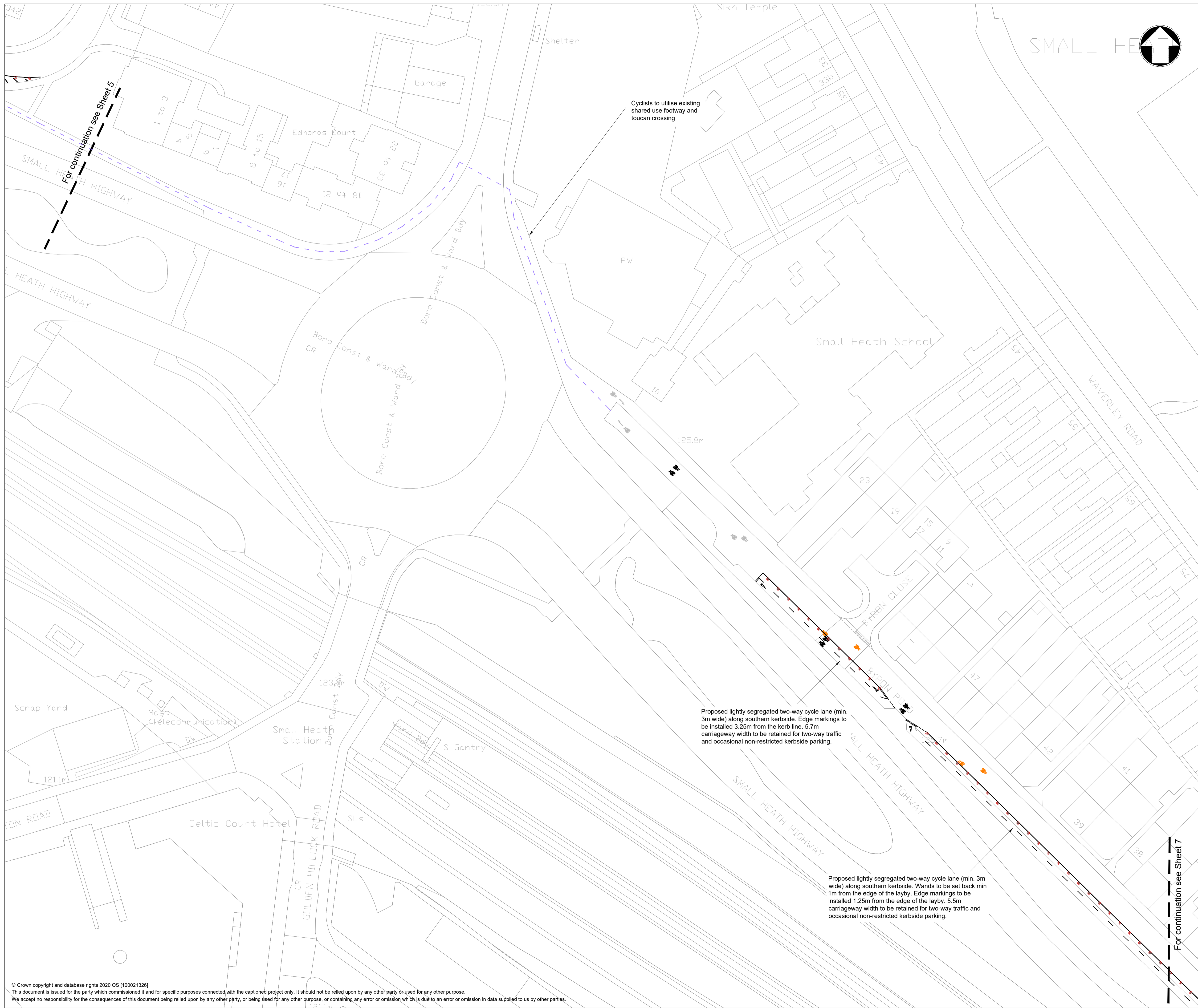

- Notes
- Existing road markings and street furniture arrangements are indicative and for the purposes of illustrating proposed design arrangements only. Not all arrangements are shown and they are subject to verification on site.
 - Where existing speed cushions intersect proposed cycle lanes, the speed cushion is to be removed and made level. Method to be proposed by the Contractor.
 - Where temporary footway buildout is to be constructed, the Contractor is to incorporate temporary drainage system and maintain access to utility chambers.
 - Unless otherwise specified, existing signs in conflict with proposed arrangement are to be covered or removed.
 - Refer to Sign Schedule and associated notes for traffic signs arrangement.
 - Where existing vegetation encroaches on proposed cycle track or obstructs visibility of proposed signs, vegetation is to be cut back.
 - Localised carriageway repair should be undertaken where appropriate, in consultation with BCC.

Key to symbols

In general, arrangements and symbols shown in:

- GREY represents existing to be retained
- ORANGE represents existing to be removed
- ANY OTHER COLOUR represents proposed

Symbols:

- Proposed route for cyclists (*wayfinding provisions to be determined*)
- Proposed kerbline
- Proposed sign installation (see sign schedule)
- Proposed plastic wand (nominal 2.5m spacing unless specified)
- Proposed new footway construction
- Proposed coloured surface treatment (exact colour to be agreed with BCC)
- Proposed temporary surface matting
- Proposed tactile paving (corduroy hazard warning)
- Proposed tactile paving (ladder and tramline)

Reference drawings

Rev	Date	Drawn	Description	Ch'k'd	App'd
A	29/07/2020	JM	For Construction	PJC	CS
P01	24/07/2020	JM	First Issue	PJC	CS

MOTT MACDONALD

35 Newhall Street
Birmingham
B3 3PU
United Kingdom

T +44 (0)121 234 1500
F 44 (0)121 200 3295
W mottmac.com

Client

Birmingham City Council

Title

**EBTP Road Space Reallocation
Developed Design
Pop-up Cycle Lanes: City Centre to
Small Heath (A45 corridor)
Sheet 6**

Designed	J.Man	JM	Eng check	P.Crowther	PJC
Drawn	J.Man	JM	Coordination	C.Kwok	CK
Dwg check	P.Crowther	PJC	Approved	C.Searson	CS
Scale at A1	1:500	Status	CON	Rev	A
				Security	STD
Drawing Number					
419867-MMD-C01-XX-DR-D-0106					

© Crown copyright and database rights 2020 OS [100021326]
This document is issued for the party which commissioned it and for specific purposes connected with the captioned project only. It should not be relied upon by any other party or used for any other purpose.
We accept no responsibility for the consequences of this document being relied upon by any other party, or being used for any other purpose, or containing any error or omission which is due to an error or omission in data supplied to us by other parties.

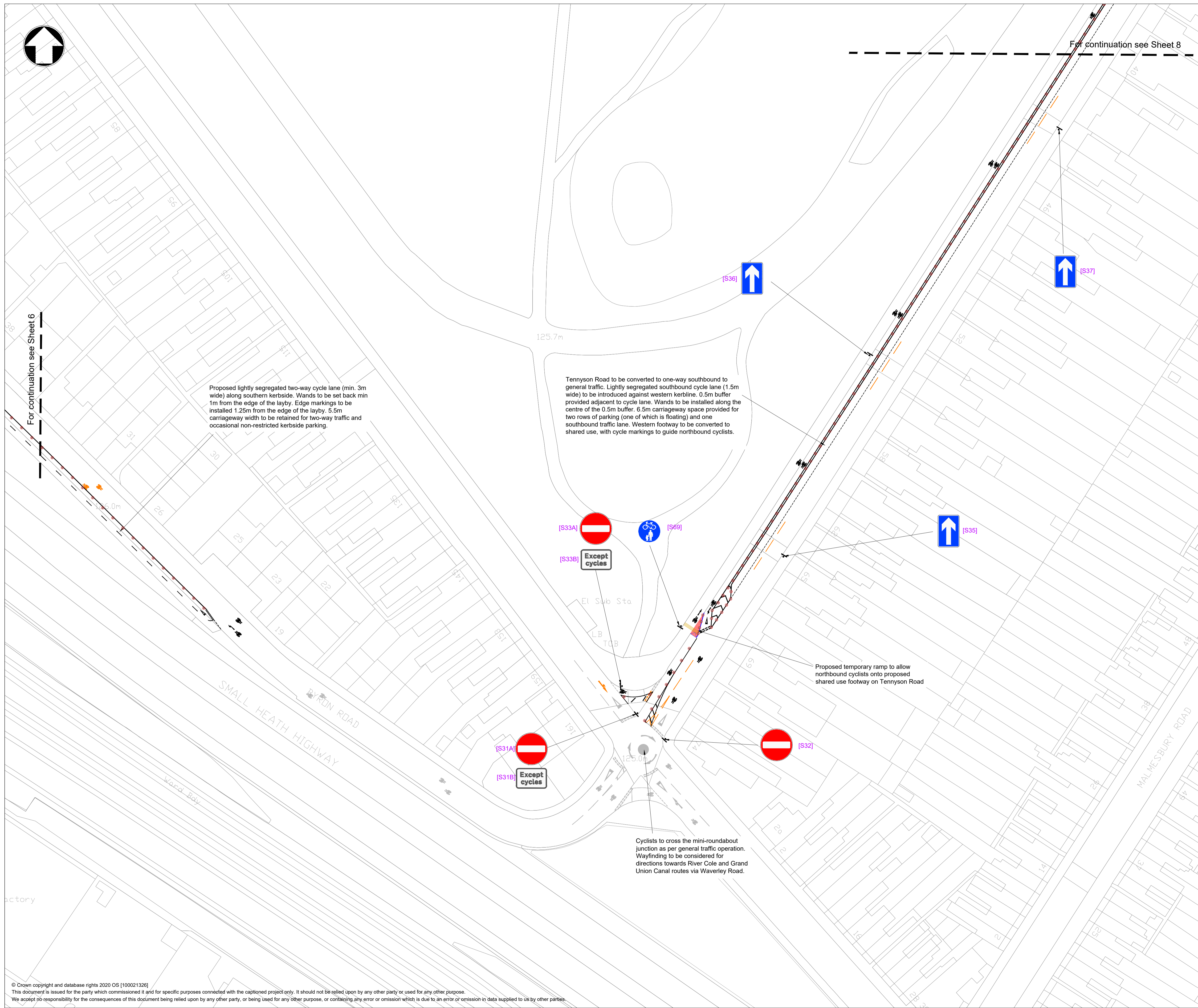

- Notes
- Existing road markings and street furniture arrangements are indicative and for the purposes of illustrating proposed design arrangements only. Not all arrangements are shown and they are subject to verification on site.
 - Where existing speed cushions intersect proposed cycle lanes, the speed cushion is to be removed and made level. Method to be proposed by the Contractor.
 - Where temporary footway buildout is to be constructed, the Contractor is to incorporate temporary drainage system and maintain access to utility chambers.
 - Unless otherwise specified, existing signs in conflict with proposed arrangement are to be covered or removed.
 - Refer to Sign Schedule and associated notes for traffic signs arrangement.
 - Where existing vegetation encroaches on proposed cycle track or obstructs visibility of proposed signs, vegetation is to be cut back.
 - Localised carriageway repair should be undertaken where appropriate, in consultation with BCC.

Key to symbols

In general, arrangements and symbols shown in:

- GREY represents existing to be retained
- ORANGE represents existing to be removed
- ANY OTHER COLOUR represents proposed

Symbols:

- Proposed route for cyclists (wayfinding provisions to be determined)
- Proposed kerbline
- Proposed sign installation (see sign schedule)
- Proposed plastic wand (nominal 2.5m spacing unless specified)
- Proposed new footway construction
- Proposed coloured surface treatment (exact colour to be agreed with BCC)
- Proposed temporary surface matting
- Proposed tactile paving (corduroy hazard warning)
- Proposed tactile paving (ladder and tramline)

Reference drawings

Rev	Date	Drawn	Description	Ch'k'd	App'd
A	29/07/2020	JM	For Construction	PJC	CS
P01	24/07/2020	JM	First Issue	PJC	CS

MOTT MACDONALD

35 Newhall Street
Birmingham
B3 3PU
United Kingdom

T +44 (0)121 234 1500
F 44 (0)121 200 3295
W mottmac.com

Client

Birmingham City Council

Title

**EBTP Road Space Reallocation
Developed Design
Pop-up Cycle Lanes: City Centre to
Small Heath (A45 corridor)
Sheet 7**

Designed	J.Man	JM	Eng check	P.Crowther	PJC
Drawn	J.Man	JM	Coordination	C.Kwok	CK
Dwg check	P.Crowther	PJC	Approved	C.Searson	CS
Scale at A1	1:500	Status	CON	Rev	A
				Security	STD
Drawing Number					
419867-MMD-C01-XX-DR-D-0107					

© Crown copyright and database rights 2020 OS [100021326]
This document is issued for the party which commissioned it and for specific purposes connected with the captioned project only. It should not be relied upon by any other party or used for any other purpose.
We accept no responsibility for the consequences of this document being relied upon by any other party, or being used for any other purpose, or containing any error or omission which is due to an error or omission in data supplied to us by other parties.

C:\Users\w92277ne\Drive - Mott MacDonald
projects\AutoCAD.dwg Feb 21, 2020 - 09:11AM Autodesk

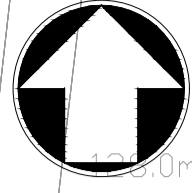

Small Heath Park



Tennyson Road to be converted to one-way southbound to general traffic. Lightly segregated southbound cycle lane (1.5m wide) to be introduced against western kerbline. 0.5m buffer provided adjacent to cycle lane. Wands to be installed along the centre of the 0.5m buffer. 6.5m carriageway space provided for two rows of parking (one of which is floating) and one southbound traffic lane. Western footway to be converted to shared use, with cycle markings to guide northbound cyclists.

127.6m

Lake

For continuation see Sheet 9

For continuation see Sheet 7

- Notes
- Existing road markings and street furniture arrangements are indicative and for the purposes of illustrating proposed design arrangements only. Not all arrangements are shown and they are subject to verification on site.
 - Where existing speed cushions intersect proposed cycle lanes, the speed cushion is to be removed and made level. Method to be proposed by the Contractor.
 - Where temporary footway buildout is to be constructed, the Contractor is to incorporate temporary drainage system and maintain access to utility chambers.
 - Unless otherwise specified, existing signs in conflict with proposed arrangement are to be covered or removed.
 - Refer to Sign Schedule and associated notes for traffic signs arrangement.
 - Where existing vegetation encroaches on proposed cycle track or obstructs visibility of proposed signs, vegetation is to be cut back.
 - Localised carriageway repair should be undertaken where appropriate, in consultation with BCC.

- Key to symbols
- In general, arrangements and symbols shown in:
- GREY represents existing to be retained
 - ORANGE represents existing to be removed
 - ANY OTHER COLOUR represents proposed
- Symbols:
- Proposed route for cyclists (wayfinding provisions to be determined)
 - Proposed kerbline
 - Proposed sign installation (see sign schedule)
 - Proposed plastic wand (nominal 2.5m spacing unless specified)
 - Proposed new footway construction
 - Proposed coloured surface treatment (exact colour to be agreed with BCC)
 - Proposed temporary surface matting
 - Proposed tactile paving (corduroy hazard warning)
 - Proposed tactile paving (ladder and tramline)

Reference drawings

A	29/07/2020	JM	For Construction	PJC	CS
P01	24/07/2020	JM	First Issue	PJC	CS
Rev	Date	Drawn	Description	Ch'k'd	App'd

MOTT MACDONALD

35 Newhall Street
Birmingham
B3 3PU
United Kingdom

T +44 (0)121 234 1500
F 44 (0)121 200 3295
W mottmac.com

Client
Birmingham City Council

Title
**EBTP Road Space Reallocation
Developed Design
Pop-up Cycle Lanes: City Centre to
Small Heath (A45 corridor)
Sheet 8**

Designed	J.Man	JM	Eng check	P.Crowther	PJC
Drawn	J.Man	JM	Coordination	C.Kwok	CK
Dwg check	P.Crowther	PJC	Approved	C.Searson	CS

Scale at A1	Status	Rev	Security
1:500	CON	A	STD

Drawing Number
419867-MMD-C01-XX-DR-D-0108

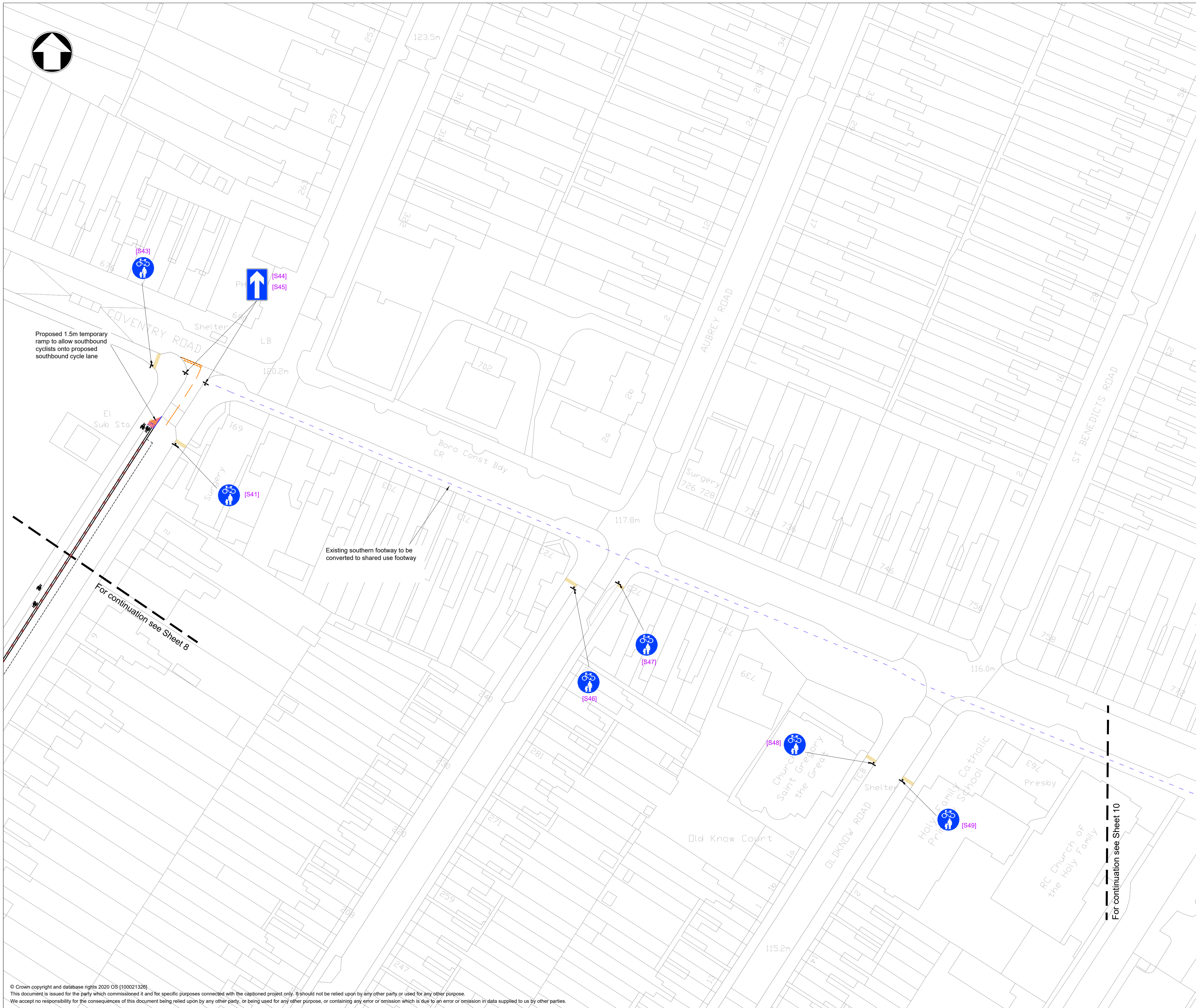

- Notes**
- Existing road markings and street furniture arrangements are indicative and for the purposes of illustrating proposed design arrangements only. Not all arrangements are shown and they are subject to verification on site.
 - Where existing speed cushions intersect proposed cycle lanes, the speed cushion is to be removed and made level. Method to be proposed by the Contractor.
 - Where temporary footway buildout is to be constructed, the Contractor is to incorporate temporary drainage system and maintain access to utility chambers.
 - Unless otherwise specified, existing signs in conflict with proposed arrangements are to be covered or removed.
 - Refer to Sign Schedule and associated notes for traffic signs arrangement.
 - Where existing vegetation encroaches on proposed cycle track or obstructs visibility of proposed signs, vegetation is to be cut back.
 - Localised carriageway repair should be undertaken where appropriate, in consultation with BCC.

Key to symbols

In general, arrangements and symbols shown in:

- GREY represents existing to be retained
- ORANGE represents existing to be removed
- ANY OTHER COLOUR represents proposed

Symbols:

- Proposed route for cyclists (*wayfinding provisions to be determined*)
- Proposed kerbline
- Proposed sign installation (see sign schedule)
- Proposed plastic wand (nominal 2.5m spacing unless specified)
- Proposed new footway construction
- Proposed coloured surface treatment (exact colour to be agreed with BCC)
- Proposed temporary surface matting
- Proposed tactile paving (corduroy hazard warning)
- Proposed tactile paving (ladder and tramline)

Reference drawings

Rev	Date	Drawn	Description	Ch'k'd	App'd
A	29/07/2020	JM	For Construction	PJC	CS
P01	24/07/2020	JM	First Issue	PJC	CS

MOTT MACDONALD

35 Newhall Street
Birmingham
B3 3PU
United Kingdom

T +44 (0)121 234 1500
F 44 (0)121 200 3295
W mottmac.com

Client

Birmingham City Council

Title

EBTP Road Space Reallocation
Developed Design
Pop-up Cycle Lanes: City Centre to Small Heath (A45 corridor)
Sheet 9

Designed	J.Man	JM	Eng check	P.Crowther	PJC
Drawn	J.Man	JM	Coordination	C.Kwok	CK
Dwg check	P.Crowther	PJC	Approved	C.Searson	CS
Scale at A1	Status	Rev	Security		
1:500	CON	A	STD		
Drawing Number					
419867-MMD-C01-XX-DR-D-0109					

© Crown copyright and database rights 2020 OS [100021326].
This document is issued for the party which commissioned it and for specific purposes connected with the captioned project only. It should not be relied upon by any other party or used for any other purpose.
We accept no responsibility for the consequences of this document being relied upon by any other party, or being used for any other purpose, or containing any error or omission which is due to an error or omission in data supplied to us by other parties.

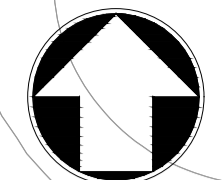
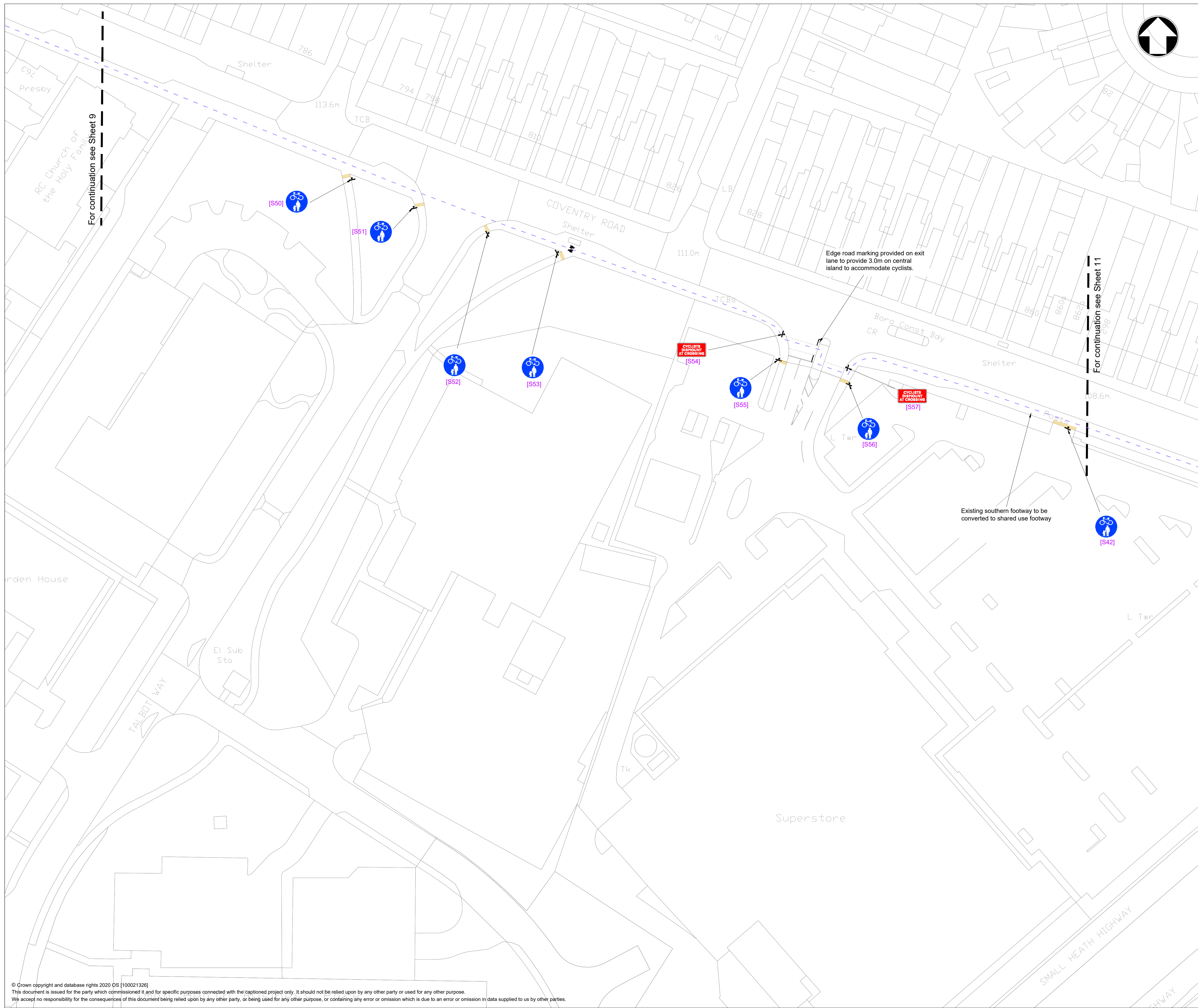

- Notes**
- Existing road markings and street furniture arrangements are indicative and for the purposes of illustrating proposed design arrangements only. Not all arrangements are shown and they are subject to verification on site.
 - Where existing speed cushions intersect proposed cycle lanes, the speed cushion is to be removed and made level. Method to be proposed by the Contractor.
 - Where temporary footway buildout is to be constructed, the Contractor is to incorporate temporary drainage system and maintain access to utility chambers.
 - Unless otherwise specified, existing signs in conflict with proposed arrangements are to be covered or removed.
 - Refer to Sign Schedule and associated notes for traffic signs arrangement.
 - Where existing vegetation encroaches on proposed cycle track or obstructs visibility of proposed signs, vegetation is to be cut back.
 - Localised carriageway repair should be undertaken where appropriate, in consultation with BCC.

- Key to symbols**
- In general, arrangements and symbols shown in:
- GREY represents existing to be retained
 - ORANGE represents existing to be removed
 - ANY OTHER COLOUR represents proposed
- Symbols:**
- Proposed route for cyclists (wayfinding provisions to be determined)
 - Proposed kerblines
 - Proposed sign installation (see sign schedule)
 - Proposed plastic wand (nominal 2.5m spacing unless specified)
 - Proposed new footway construction
 - Proposed coloured surface treatment (exact colour to be agreed with BCC)
 - Proposed temporary surface matting
 - Proposed tactile paving (corduroy hazard warning)
 - Proposed tactile paving (ladder and tramline)

Reference drawings

A	29/07/2020	JM	For Construction	PJC	CS
P01	24/07/2020	JM	First Issue	PJC	CS
Rev	Date	Drawn	Description	Ch'k'd	App'd

MOTT MACDONALD

35 Newhall Street
Birmingham
B3 3PU
United Kingdom

T +44 (0)121 234 1500
F 44 (0)121 200 3295
W mottmac.com

Client

Birmingham City Council

Title

EBTP Road Space Reallocation
Developed Design
Pop-up Cycle Lanes: City Centre to Small Heath (A45 corridor)
Sheet 10

Designed	J.Man	JM	Eng check	P.Crowther	PJC
Drawn	J.Man	JM	Coordination	C.Kwok	CK
Dwg check	P.Crowther	PJC	Approved	C.Searson	CS
Scale at A1	Status	Rev	Security		
1:500	CON	A	STD		

Drawing Number

419867-MMD-C01-XX-DR-D-0110

© Crown copyright and database rights 2020 OS [100021326]
This document is issued for the party which commissioned it and for specific purposes connected with the captioned project only. It should not be relied upon by any other party or used for any other purpose.
We accept no responsibility for the consequences of this document being relied upon by any other party, or being used for any other purpose, or containing any error or omission which is due to an error or omission in data supplied to us by other parties.

C:\Users\wo92277\neDrive - Mott MacDonald
projects\AutoCAD.dwg Feb 21, 2020 - 09:11AM Autodesk

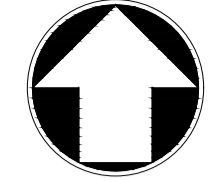
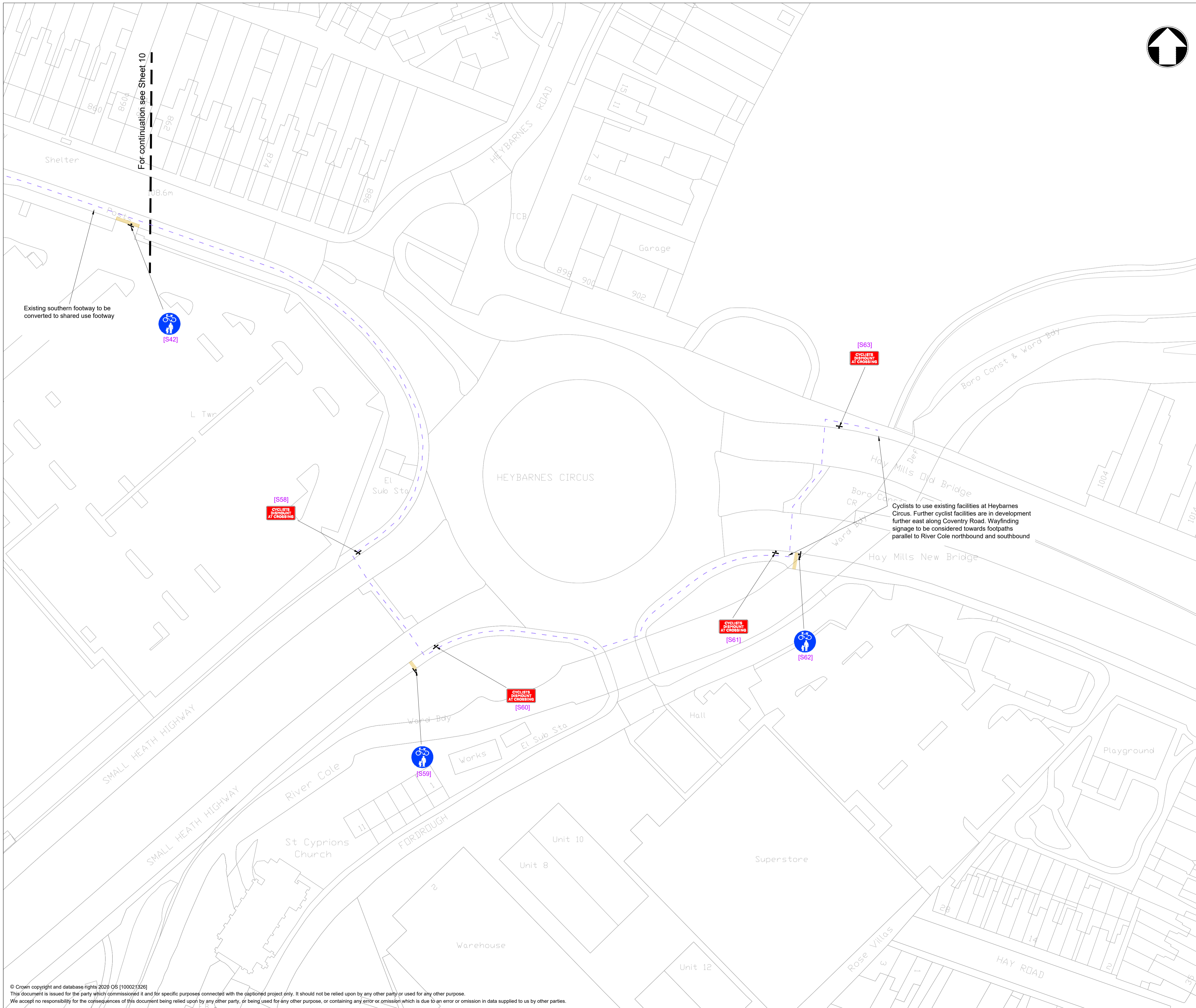

Notes

- Existing road markings and street furniture arrangements are indicative and for the purposes of illustrating proposed design arrangements only. Not all arrangements are shown and they are subject to verification on site.
- Where existing speed cushions intersect proposed cycle lanes, the speed cushion is to be removed and made level. Method to be proposed by the Contractor.
- Where temporary footway buildout is to be constructed, the Contractor is to incorporate temporary drainage system and maintain access to utility chambers.
- Unless otherwise specified, existing signs in conflict with proposed arrangement are to be covered or removed.
- Refer to Sign Schedule and associated notes for traffic signs arrangement.
- Where existing vegetation encroaches on proposed cycle track or obstructs visibility of proposed signs, vegetation is to be cut back.
- Localised carriageway repair should be undertaken where appropriate, in consultation with BCC.

Key to symbols

In general, arrangements and symbols shown in:
 GREY represents existing to be retained
 ORANGE represents existing to be removed
 ANY OTHER COLOUR represents proposed

- Symbols:
- Proposed route for cyclists (wayfinding provisions to be determined)
 - Proposed kerbline
 - Proposed sign installation (see sign schedule)
 - Proposed plastic wand (nominal 2.5m spacing unless specified)
 - Proposed new footway construction
 - Proposed coloured surface treatment (exact colour to be agreed with BCC)
 - Proposed temporary surface matting
 - Proposed tactile paving (corduroy hazard warning)
 - Proposed tactile paving (ladder and tramline)

Reference drawings

A	29/07/2020	JM	For Construction	PJC	CS
P01	24/07/2020	JM	First Issue	PJC	CS
Rev	Date	Drawn	Description	Ch'k'd	App'd

MOTT MACDONALD

35 Newhall Street
 Birmingham
 B3 3PU
 United Kingdom

T +44 (0)121 234 1500
 F 44 (0)121 200 3295
 W mottmac.com

Client
Birmingham City Council

Title
**EBTP Road Space Reallocation
 Developed Design
 Pop-up Cycle Lanes: City Centre to
 Small Heath (A45 corridor)
 Sheet 11**

Designed	J.Man	JM	Eng check	P.Crowther	PJC
Drawn	J.Man	JM	Coordination	C.Kwok	CK
Dwg check	P.Crowther	PJC	Approved	C.Searson	CS

Scale at A1	Status	Rev	Security
1:500	CON	A	STD

Drawing Number
419867-MMD-C01-XX-DR-D-0111