

Key	
	Proposed Footway Resurfacing
	Proposed Keyloc Grey
	Proposed Buff Surface Dressing
	Proposed Planter
	Remove road surface
	Proposed Carriageway Resurfacing
	Proposed Asphalt Table
	Proposed Kerb
	Proposed Dropped Kerb Flush
	Existing Line Marking
	Existing Line Marking Removed
	Proposed White Line Marking
	Proposed Yellow Line Marking
	Existing / Proposed Tree
	Existing / Proposed Lamp Column
	Existing / Proposed Sign Post
	Existing / Proposed Bollard
	Proposed Fold-down Bollard
	Existing Street Furniture Removed
	Existing / Proposed Gully

These drawings have been produced with reference to the CDM Regulations 2015. Please note that these are pre-construction phase drawings and should be subject to further design risk management as required in accordance with Regulation 9.

Notes

- All measurements in metres unless otherwise stated.
- This drawing is to be read in conjunction with all relevant project drawings and BCC specification
- All electrical works to be carried out by qualified and competent electrician
- Electrical disconnections and reconnections to be organised by BCC/contractor
- All traffic sign and road markings are to comply with Traffic Sign Regulations and General Directions 2016
- All markings are to be laid in thermoplastic screed in accordance with BS EN 1871, with primer applied beforehand
- Unless specified all white markings shall be reflectorized with solid glass beads in accordance with BS 6088 by incorporation (except for pre-formed markings) into the road marking mixture and to the wet surface of the marking
- All symbols to be preformed in accordance with Appendix 12/3 of the specification
- Signs on footway to be mounted at the height of 2.3m and higher where cycling is permitted, a minimum of 2.1m elsewhere
- All signs to have a minimum horizontal clearance of 450mm from face of kerb
- Refer to contract drawings BCC Highways contract drawings for typical construction details

Rev	Date	Description	Drawn	Checked

The Aquarium, King Street,  
Reading, RG1 2AN  
www.pja.co.uk

Drawing No. 04965-PM-L-C-01-0

Scale at A3 1:250

**Project**  
Lozells Traffic Management

**Drawing**  
Archibald Road  
One Way with Cycle Contraflow  
Concept Design

**Client**  
Birmingham City Council

Revision	Status	Date
-	<b>DRAFT</b>	29/09/20
Designed	Checked	Approved
JMC	JMQ	JMQ

Ordnance Survey (c) 2020. All rights reserved. Licence number xxxxxxxx

These drawings have been produced with reference to the CDM Regulations 2015. Please note that these are pre-construction phase drawings and should be subject to further design risk management as required in accordance with Regulation 9.

- Notes
- All measurements in metres unless otherwise stated.
  - This drawing is to be read in conjunction with all relevant project drawings and BCC specification
  - All electrical works to be carried out by qualified and competent electrician
  - Electrical disconnections and reconnections to be organised by BCC contractor
  - All traffic sign and road markings are to comply with Traffic Sign Regulations and General Directions 2016
  - All markings are to be laid in thermoplastic screed in accordance with BS EN 1871, with primer applied beforehand
  - Unless specified all white markings shall be reflectorized with solid glass beads in accordance with BS 6088 by incorporation (except for pre-formed markings) into the road marking mixture and to the wet surface of the marking
  - All symbols to be performed in accordance with Appendix 12/3 of the specification
  - Signs on footway to be mounted at the height of 2.3m and higher where cycling is permitted, a minimum of 2.1m elsewhere
  - All signs to have a minimum horizontal clearance of 450mm from face of kerb
  - Refer to contract drawings BCC Highways contract drawings for typical construction details

- Key
- Proposed Footway Resurfacing
  - Proposed Keybloc Grey
  - Proposed Buff Surface Dressing
  - Proposed Planter
  - Remove road surface
  - Proposed Carriageway Resurfacing
  - Proposed Asphalt Table
  - Proposed Kerb
  - Proposed Dropped Kerb Flush
  - Existing Line Marking
  - Existing Line Marking Removed
  - Proposed White Line Marking
  - Proposed Yellow Line Marking
  - Existing / Proposed Tree
  - Existing / Proposed Lamp Column
  - Existing / Proposed Sign Post
  - Existing / Proposed Bollard
  - Proposed Fold-down Bollard
  - Existing Street Furniture Removed
  - Existing / Proposed Gully

Rev	Date	Description	Drawn	Checked

The Aquarium  
King Street  
Reading  
RG1 2AN  
www.pja.co.uk



**Project**  
Lozells Traffic Management

**Drawing**  
Finch Road  
One Way with Cycle Contraflow  
01 of 03  
Concept Design

**Client**  
Birmingham City Council

**Drawing No.**  
04965-PM-L-C-02-01

Status	Date	Revision
For Discussion	23/09/20	-
Scale at 1:250	Designed: JMC	Checked: JMC
	Approved: JMC	

Ordnance Survey (c) 2020. All rights reserved. Licence number xxxxxxxx

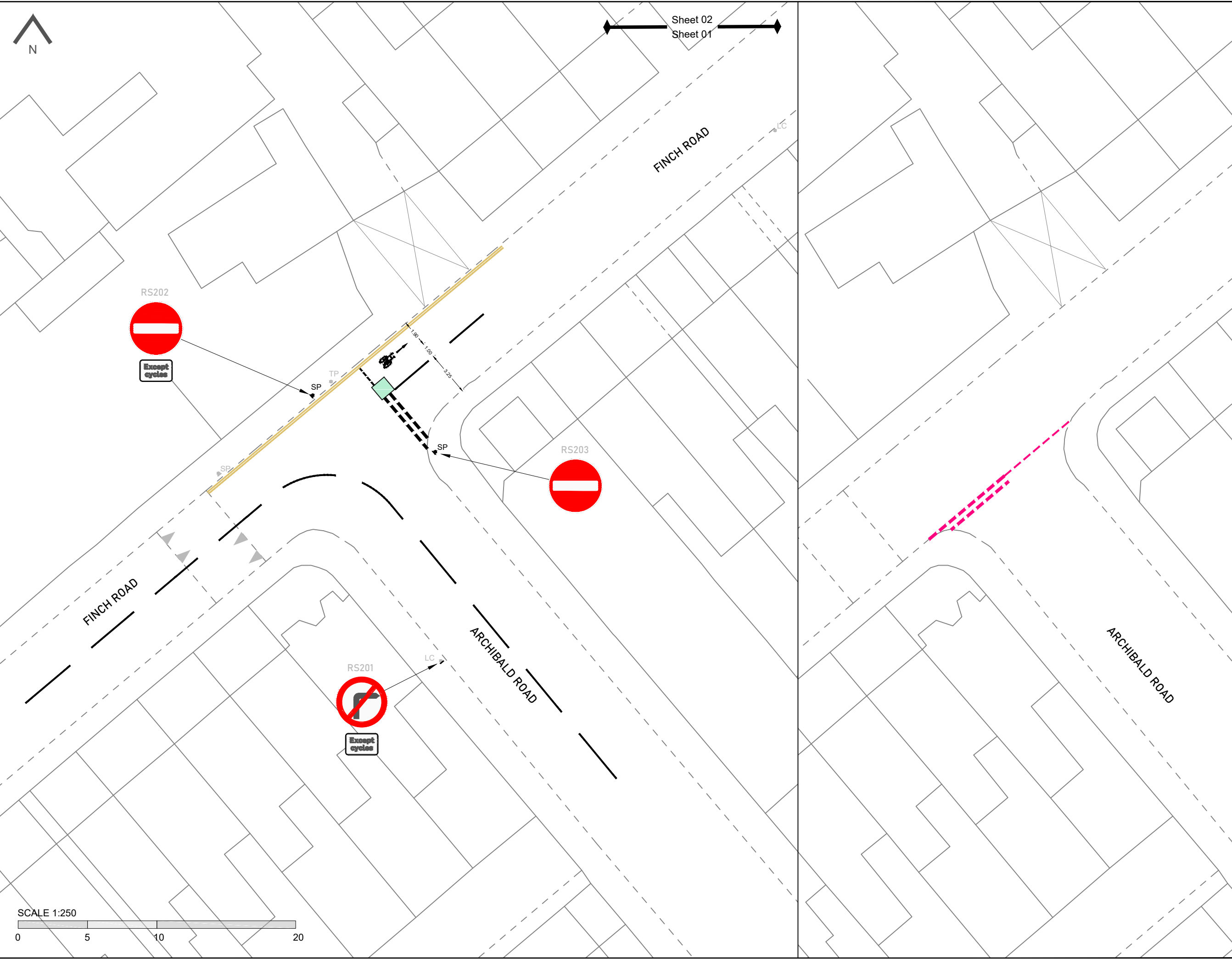

These drawings have been produced with reference to the CDM Regulations 2015. Please note that these are pre-construction phase drawings and should be subject to further design risk management as required in accordance with Regulation 9.

- Notes
- All measurements in metres unless otherwise stated.
  - This drawing is to be read in conjunction with all relevant project drawings and BCC specification
  - All electrical works to be carried out by qualified and competent electrician
  - Electrical disconnections and reconnections to be organised by BCC contractor
  - All traffic sign and road markings are to comply with Traffic Sign Regulations and General Directions 2016
  - All markings are to be laid in thermoplastic screed in accordance with BS EN 1871, with primer applied beforehand
  - Unless specified all white markings shall be reflectorized with solid glass beads in accordance with BS 6088 by incorporation (except for pre-formed markings) into the road marking mixture and to the wet surface of the marking
  - All symbols to be preformed in accordance with Appendix 12/3 of the specification
  - Signs on footway to be mounted at the height of 2.3m and higher where cycling is permitted, a minimum of 2.1m elsewhere
  - All signs to have a minimum horizontal clearance of 450mm from face of kerb
  - Refer to contract drawings BCC Highways contract drawings for typical construction details

- Key
- Proposed Footway Resurfacing
  - Proposed Keybloc Grey
  - Proposed Buff Surface Dressing
  - Proposed Planter
  - Remove road surface
  - Proposed Carriageway Resurfacing
  - Proposed Asphalt Table
  - Proposed Kerb
  - Proposed Dropped Kerb Flush
  - Existing Line Marking
  - Existing Line Marking Removed
  - Proposed White Line Marking
  - Proposed Yellow Line Marking
  - Existing / Proposed Tree
  - Existing / Proposed Lamp Column
  - Existing / Proposed Sign Post
  - Existing / Proposed Bollard
  - Proposed Fold-down Bollard
  - Existing Street Furniture Removed
  - Existing / Proposed Gully

Rev	Date	Description	Drawn	Checked

The Aquarium  
King Street  
Reading  
RG1 2AN  
www.pja.co.uk



**Project**  
Lozells Traffic Management

**Drawing**  
Finch Road  
One way with Cycle Contraflow  
02 of 03  
Concept Design

**Client**  
Birmingham City Council

**Drawing No.**  
04965-PM-L-C-02-02

Status	Date	Revision
For Discussion	23/09/20	-
Designed	JMC	JMC
Checked	JMQ	JMQ
Approved	JMQ	JMQ

Ordnance Survey (c) 2020. All rights reserved. Licence number xxxxxxxx

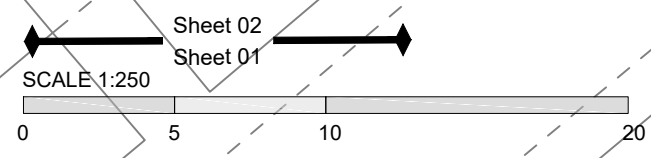
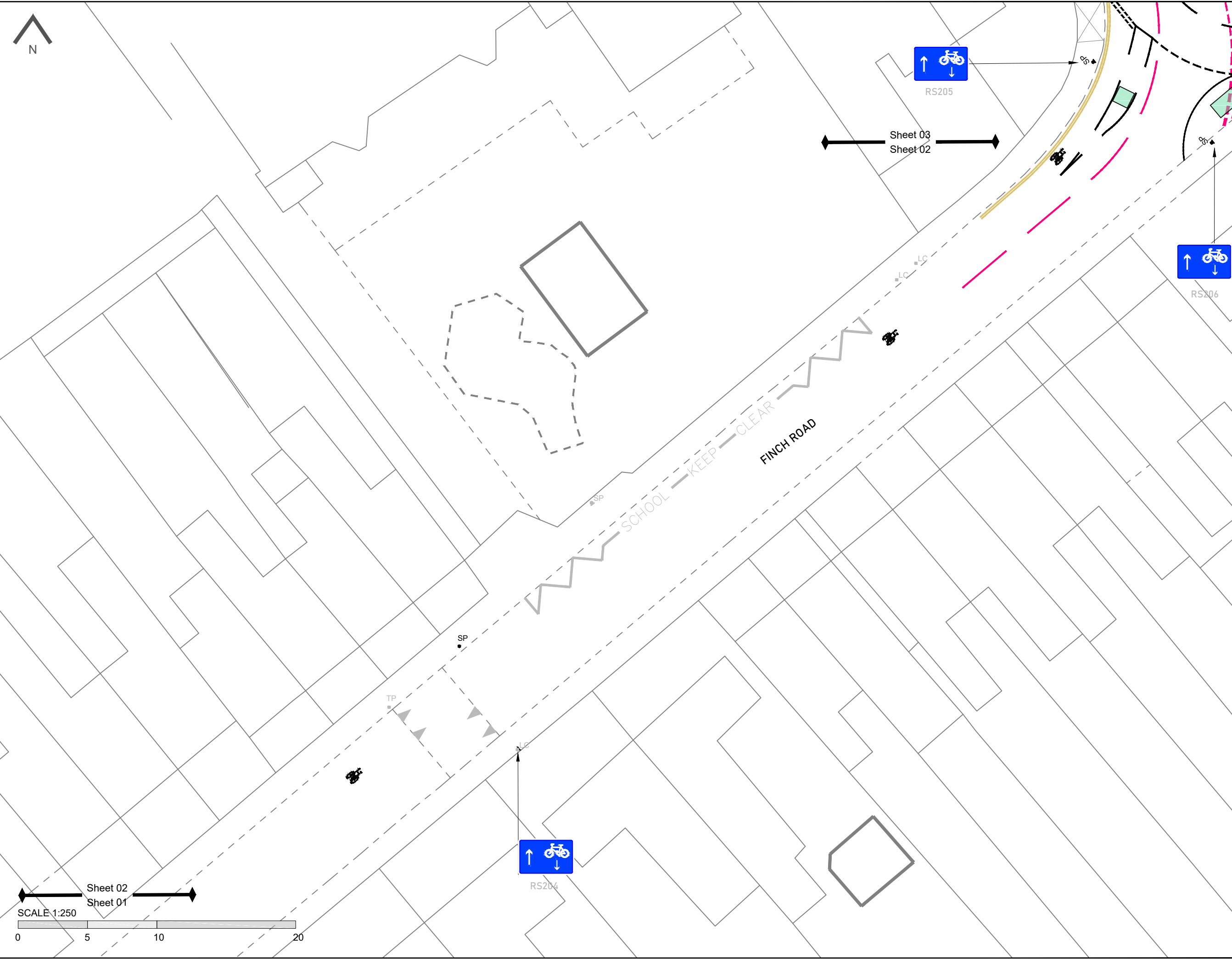

These drawings have been produced with reference to the CDM Regulations 2015. Please note that these are pre-construction phase drawings and should be subject to further design risk management as required in accordance with Regulation 9.

- Notes**
- All measurements in metres unless otherwise stated.
  - This drawing is to be read in conjunction with all relevant project drawings and BCC specification.
  - All electrical works to be carried out by qualified and competent electrician.
  - Electrical disconnections and reconnections to be organised by BCC contractor.
  - All traffic sign and road markings are to comply with Traffic Sign Regulations and General Directions 2016.
  - All markings are to be laid in thermoplastic screed in accordance with BS EN 1871, with primer applied beforehand.
  - Unless specified all white markings shall be reflectorized with solid glass beads in accordance with BS 6088 by incorporation (except for pre-formed markings) into the road marking mixture and to the wet surface of the marking 12/3 of the specification.
  - All symbols to be preformed in accordance with Appendix 12/3 of the specification.
  - Signs on footway to be mounted at the height of 2.3m and higher where cycling is permitted, a minimum of 2.1m elsewhere.
  - All signs to have a minimum horizontal clearance of 450mm from face of kerb.
  - Refer to contract drawings BCC Highways contract drawings for typical construction details.

- Key**
- Proposed Footway Resurfacing
  - Proposed Keybloc Grey
  - Proposed Buff Surface Dressing
  - Proposed Planter
  - Remove road surface
  - Proposed Carriageway Resurfacing
  - Proposed Asphalt Table
  - Proposed Kerb
  - Proposed Dropped Kerb Flush
  - Existing Line Marking
  - Existing Line Marking Removed
  - Proposed White Line Marking
  - Proposed Yellow Line Marking
  - Existing / Proposed Tree
  - Existing / Proposed Lamp Column
  - Existing / Proposed Sign Post
  - Existing / Proposed Bollard
  - Proposed Fold-down Bollard
  - Existing Street Furniture Removed
  - Existing / Proposed Gully

Rev	Date	Description	Drawn	Checked

The Aquarium  
King Street  
Reading  
RG1 2AN  
www.pja.co.uk



**Project**  
Lozells Traffic Management

**Drawing**  
Finch Road  
One Way with Cycle Contraflow  
03 of 03  
Concept Design

**Client**  
Birmingham City Council

**Drawing No.**  
04965-PM-L-C-02-03

Status	Date	Revision
For Discussion	09/20	-
Designed	JMC	JMQ
Checked	JMQ	JMQ
Approved	JMQ	JMQ

Ordnance Survey (c) 2020. All rights reserved. Licence number xxxxxxxx

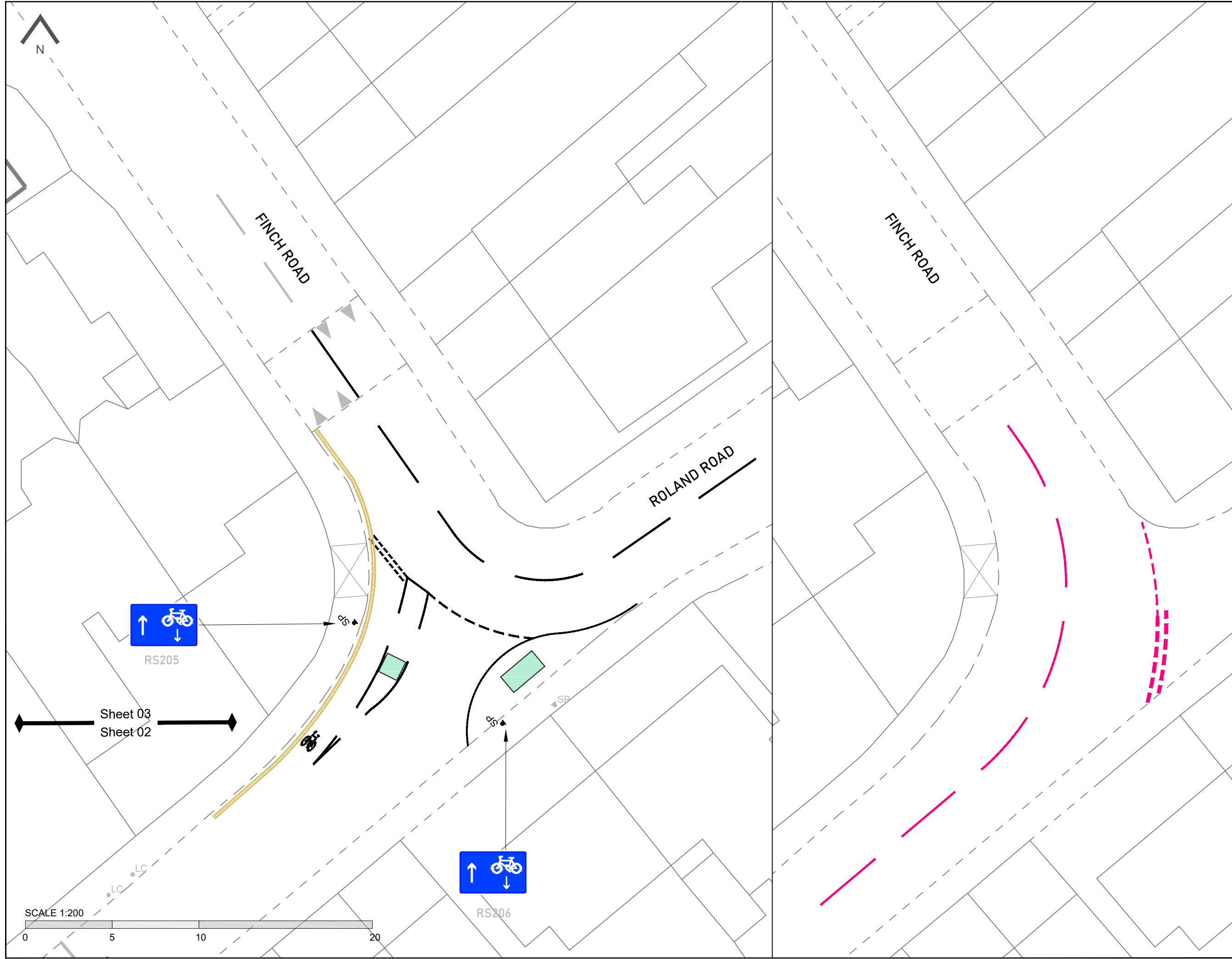



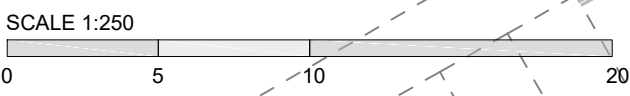
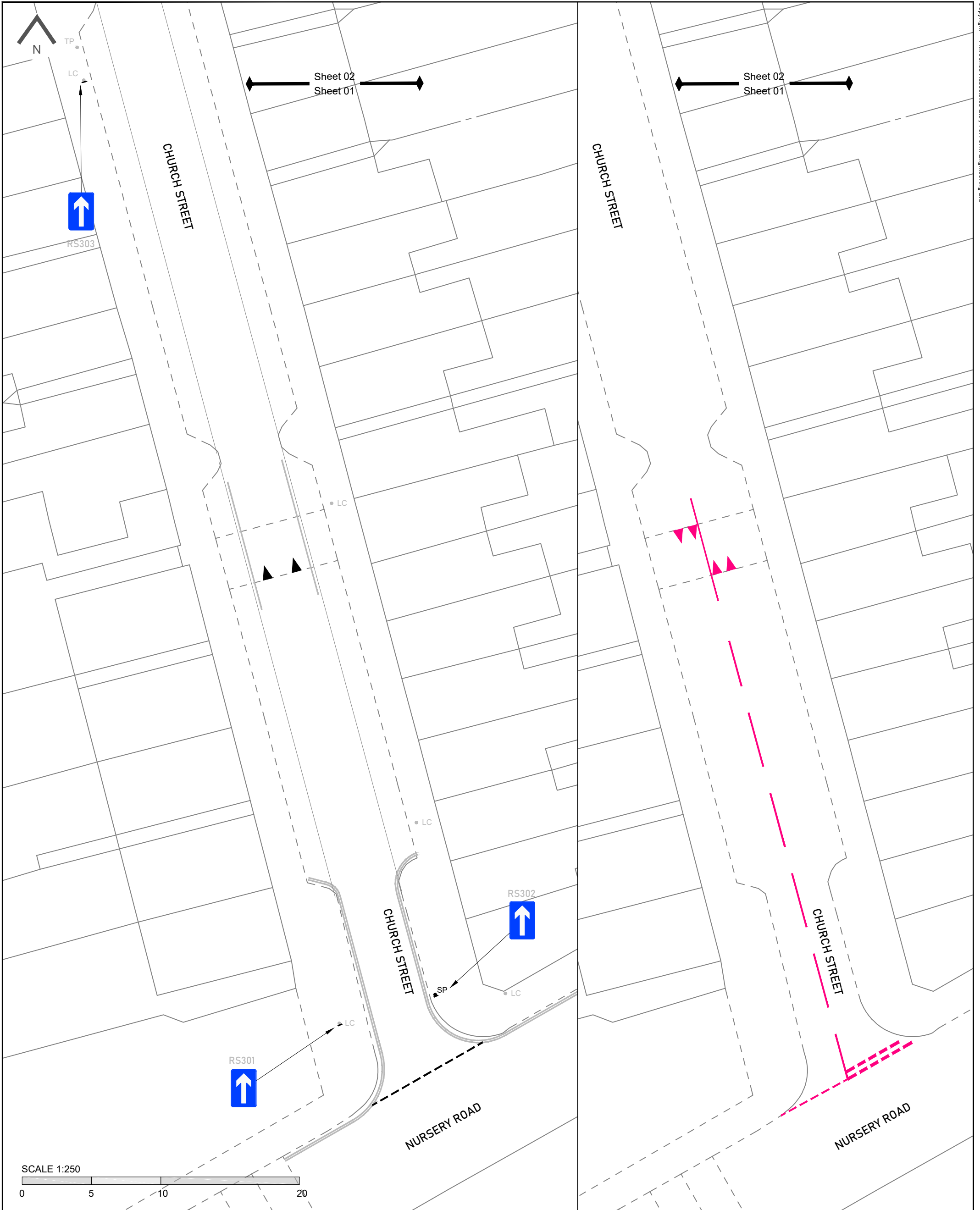

Key	
	Proposed Footway Resurfacing
	Proposed Keyloc Grey
	Proposed Buff Surface Dressing
	Proposed Planter
	Remove road surface
	Proposed Carriageway Resurfacing
	Proposed Asphalt Table
	Proposed Kerb
	Proposed Dropped Kerb Flush
	Existing Line Marking
	Existing Line Marking Removed
	Proposed White Line Marking
	Proposed Yellow Line Marking
	Existing / Proposed Tree
	Existing / Proposed Lamp Column
	Existing / Proposed Sign Post
	Proposed / Existing Bollard
	Existing Street Furniture Removed
	Existing / Proposed Gully

These drawings have been produced with reference to the CDM Regulations 2015. Please note that these are pre-construction phase drawings and should be subject to further design risk management as required in accordance with Regulation 9.

Notes

- All measurements in metres unless otherwise stated.
- This drawing is to be read in conjunction with all relevant project drawings and BCC specification
- All electrical works to be carried out by qualified and competent electrician
- Electrical disconnections and reconnections to be organised by BCC/contractor
- All traffic sign and road markings are to comply with Traffic Sign Regulations and General Directions 2016
- All markings are to be laid in thermoplastic screed in accordance with BS EN 1871, with primer applied beforehand
- Unless specified all white markings shall be reflectorized with solid glass beads in accordance with BS 6088 by incorporation (except for pre-formed markings) into the road marking mixture and to the wet surface of the marking
- All symbols to be preformed in accordance with Appendix 12/3 of the specification
- Signs on footway to be mounted at the height of 2.3m and higher where cycling is permitted, a minimum of 2.1m elsewhere
- All signs to have a minimum horizontal clearance of 450mm from face of kerb
- Refer to contract drawings BCC Highways contract drawings for typical construction details

Rev	Date	Description	Drawn	Checked

**PJA**

The Aquarium, King Street, Reading, RG1 2AN  
www.pja.co.uk

**Project**  
Lozells Traffic Management

**Drawing**  
Church Street - Graham Street - Anglesey Street - One Way System  
01 of 05 Concept Design

**Client**  
Birmingham City Council

**Drawing No.**  
04965-PM-C-03-01

**Scale at A3**  
1:250

**Revision**  
-  
For Discussion

**Status**  
**DRAFT**

**Date**  
29/09/20

**Designed**  
JMC

**Checked**  
JMQ

**Approved**  
JMQ

Ordnance Survey (c) 2020. All rights reserved. Licence number xxxxxxxxx

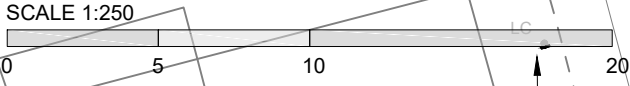
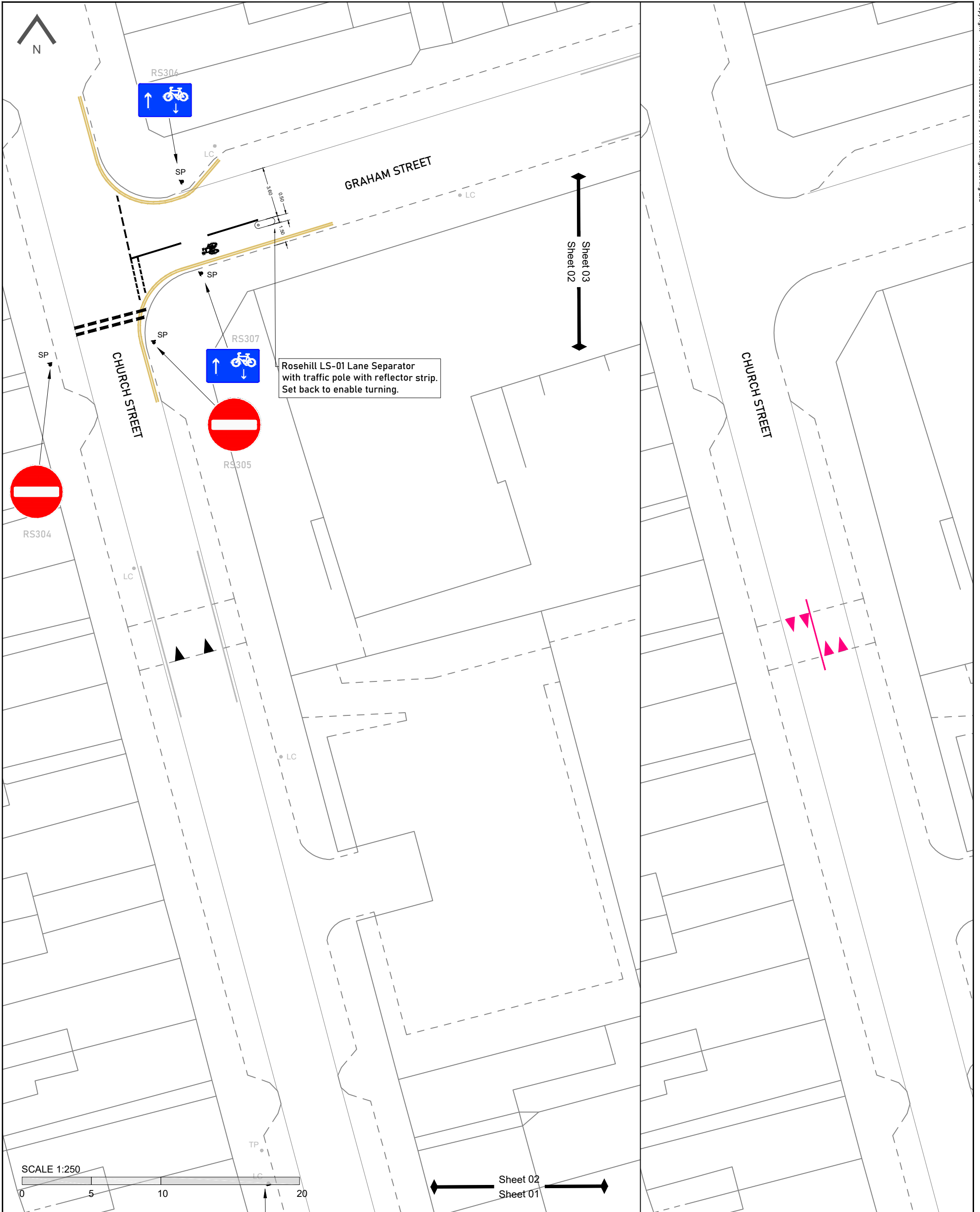

Key	
	Proposed Footway Resurfacing
	Proposed Keyloc Grey
	Proposed Buff Surface Dressing
	Proposed Planter
	Remove road surface
	Proposed Carriageway Resurfacing
	Proposed Asphalt Table
	Proposed Kerb
	Proposed Dropped Kerb Flush
	Existing Line Marking
	Existing Line Marking Removed
	Proposed White Line Marking
	Proposed Yellow Line Marking
	Existing / Proposed Tree
	Existing / Proposed Lamp Column
	Existing / Proposed Sign Post
	Proposed Fold-down Bollard
	Existing Street Furniture Removed
	Existing / Proposed Gully

These drawings have been produced with reference to the CDM Regulations 2015. Please note that these are pre-construction phase drawings and should be subject to further design risk management as required in accordance with Regulation 9.

Notes

- All measurements in metres unless otherwise stated.
- This drawing is to be read in conjunction with all relevant project drawings and BCC specification
- All electrical works to be carried out by qualified and competent electrician
- Electrical disconnections and reconnections to be organised by BCC/contractor
- All traffic sign and road markings are to comply with Traffic Sign Regulations and General Directions 2016
- All markings are to be laid in thermoplastic screed in accordance with BS EN 1871, with primer applied beforehand
- Unless specified all white markings shall be reflectorized with solid glass beads in accordance with BS 6088 by incorporation (except for pre-formed markings) into the road marking mixture and to the wet surface of the marking
- All symbols to be preformed in accordance with Appendix 12/3 of the specification
- Signs on footway to be mounted at the height of 2.3m and higher where cycling is permitted, a minimum of 2.1m elsewhere
- All signs to have a minimum horizontal clearance of 450mm from face of kerb
- Refer to contract drawings BCC Highways contract drawings for typical construction details

Rev	Date	Description	Drawn	Checked

**Project**  
Lozells Traffic Management

**Drawing**  
Church Street - Graham Street  
- Anglesey Street One way System  
02 of 05 Concept Design

**Client**  
Birmingham City Council

The Aquarium, King Street,  
Reading, RG1 2AN  
www.pja.co.uk

**Drawing No.**  
04965-PM-L-C-03-02

**Scale at A3**  
1:250

**Revision**  
-  
Status  
For Discussion  
Date  
29/09/20

**DRAFT**

Designed	Checked	Approved
JMC	JMQ	JMQ

Ordnance Survey (c) 2020. All rights reserved. Licence number xxxxxxxxx

These drawings have been produced with reference to the CDM Regulations 2015. Please note that these are pre-construction phase drawings and should be subject to further design risk management as required in accordance with Regulation 9.

- Notes
- All measurements in metres unless otherwise stated.
  - This drawing is to be read in conjunction with all relevant project drawings and BCC specification
  - All electrical works to be carried out by qualified and competent electrician
  - Electrical disconnections and reconnections to be organised by BCC contractor
  - All traffic sign and road markings are to comply with Traffic Sign Regulations and General Directions 2016
  - All markings are to be laid in thermoplastic screed in accordance with BS EN 1871, with primer applied beforehand
  - Unless specified all white markings shall be reflectorized with solid glass beads in accordance with BS 6088 by incorporation (except for pre-formed markings) into the road marking mixture and to the wet surface of the marking
  - All symbols to be preformed in accordance with Appendix 12/3 of the specification
  - Signs on footway to be mounted at the height of 2.3m and higher where cycling is permitted, a minimum of 2.1m elsewhere
  - All signs to have a minimum horizontal clearance of 450mm from face of kerb
  - Refer to contract drawings BCC Highways contract drawings for typical construction details

- Key
- Proposed Footway Resurfacing
  - Proposed Keybloc Grey
  - Proposed Buff Surface Dressing
  - Proposed Planter
  - Remove road surface
  - Proposed Carriageway Resurfacing
  - Proposed Asphalt Table
  - Proposed Kerb
  - Proposed Dropped Kerb Flush
  - Existing Line Marking
  - Existing Line Marking Removed
  - Proposed White Line Marking
  - Proposed Yellow Line Marking
  - Existing / Proposed Tree
  - Existing / Proposed Lamp Column
  - Existing / Proposed Sign Post
  - Existing / Proposed Bollard
  - Proposed Fold-down Bollard
  - Existing Street Furniture Removed
  - Existing / Proposed Gully

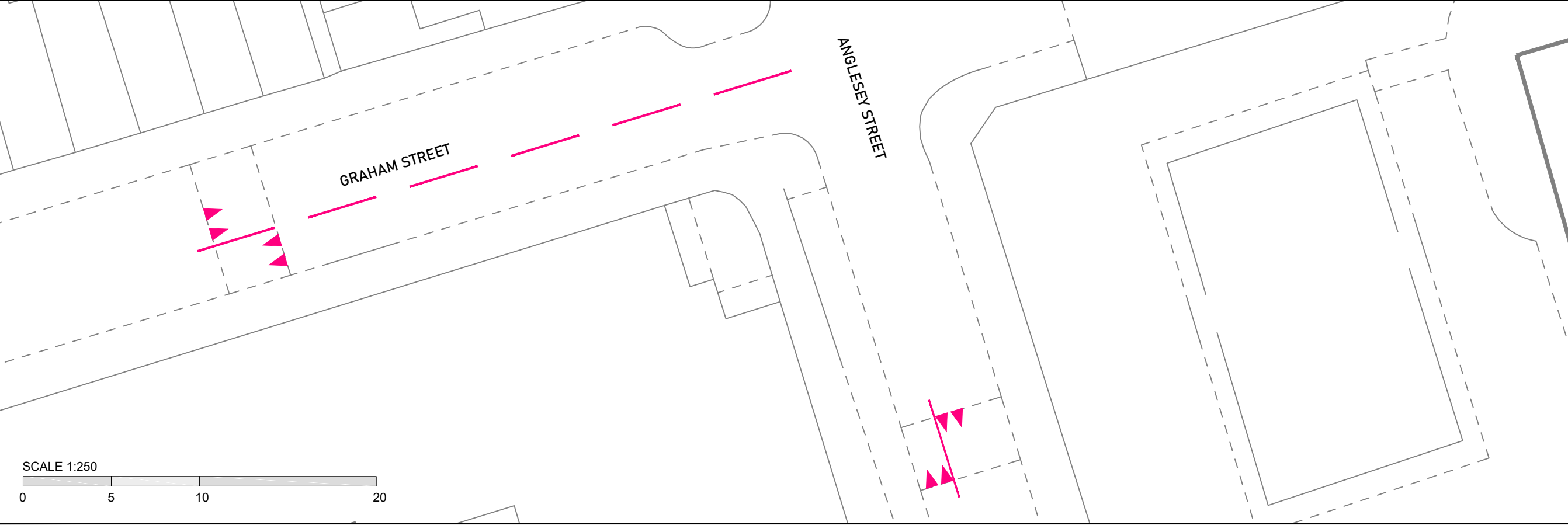
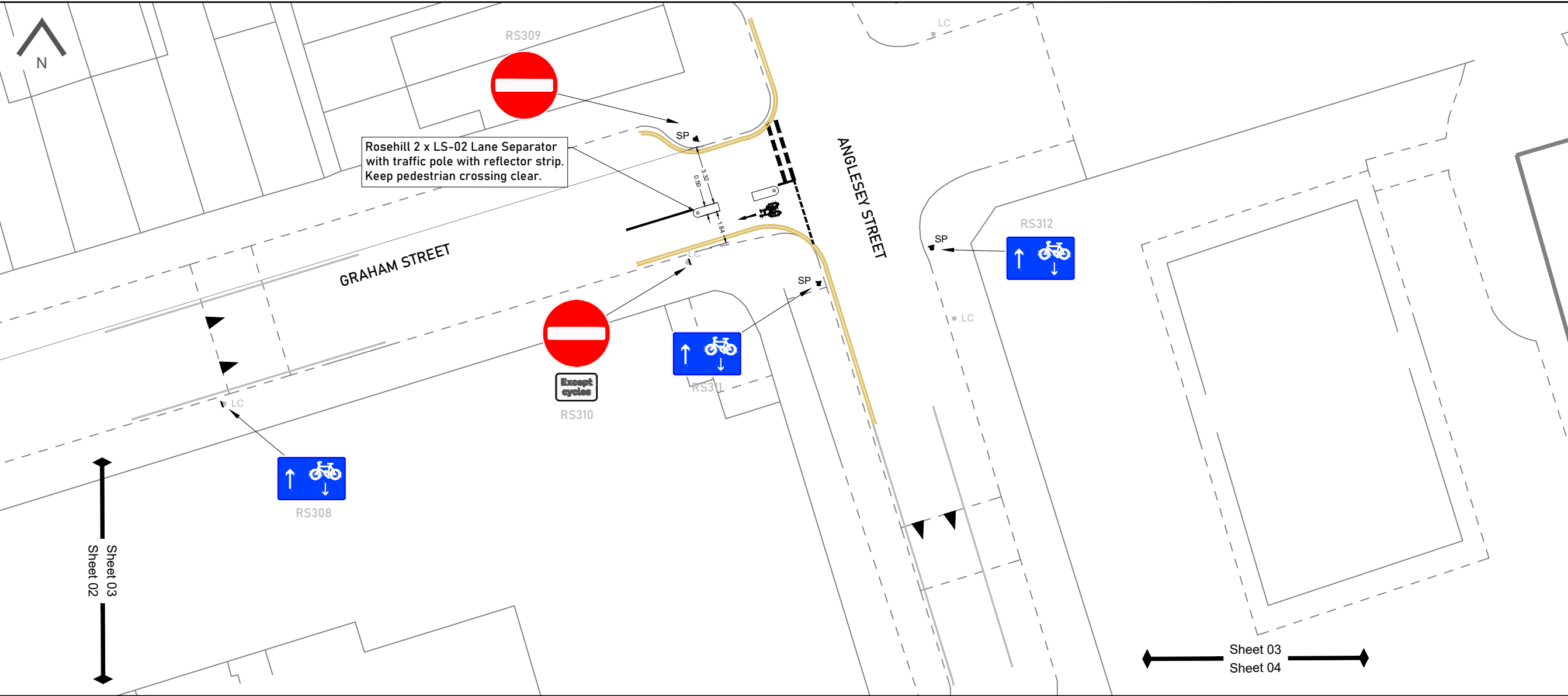

Sheet 03  
Sheet 02

Sheet 03  
Sheet 04

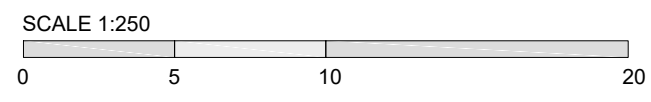

Rev	Date	Description	Drawn	Checked

The Aquarium  
King Street  
Reading  
RG1 2AN  
www.pja.co.uk



**Project**  
Lozells Traffic Management

**Drawing**  
Church Street - Graham Street - Anglesey Street  
One Way System  
03 of 05  
Concept Design

**Client**  
Birmingham City Council

**Drawing No.**  
04965-PM-L-C-03-03

Status	Date	Revision
For Discussion	23/09/20	-
Scale at 1:250	Designed	Checked
1:250	JMC	JMQ
	Approved	JMG

Ordnance Survey (c) 2020. All rights reserved. Licence number xxxxxxxx

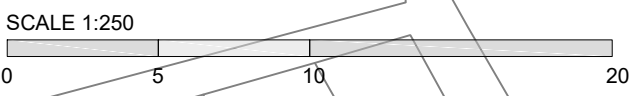
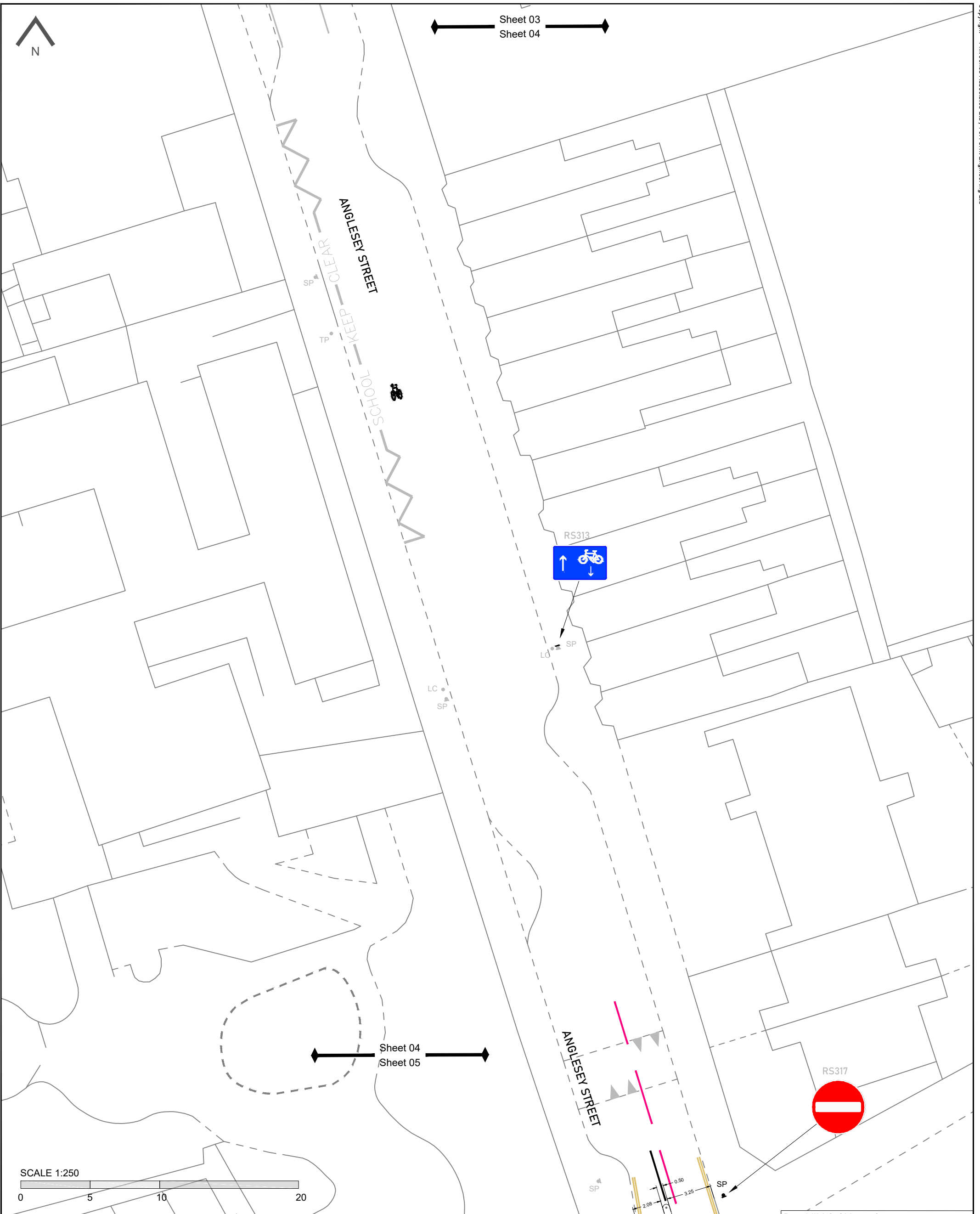

Key	
	Proposed Footway Resurfacing
	Proposed Keyloc Grey
	Proposed Buff Surface Dressing
	Proposed Planter
	Remove road surface
	Proposed Carriageway Resurfacing
	Proposed Asphalt Table
	Proposed Kerb
	Proposed Dropped Kerb Flush
	Existing Line Marking
	Existing Line Marking Removed
	Proposed White Line Marking
	Proposed Yellow Line Marking
	Existing / Proposed Tree
	Existing / Proposed Lamp Column
	Existing / Proposed Sign Post
	Existing / Proposed Bollard
	Proposed Fold-down Bollard
	Existing Street Furniture Removed
	Existing / Proposed Gully

These drawings have been produced with reference to the CDM Regulations 2015. Please note that these are pre-construction phase drawings and should be subject to further design risk management as required in accordance with Regulation 9.

Notes

- All measurements in metres unless otherwise stated.
- This drawing is to be read in conjunction with all relevant project drawings and BCC specification
- All electrical works to be carried out by qualified and competent electrician
- Electrical disconnections and reconnections to be organised by BCC/contractor
- All traffic sign and road markings are to comply with Traffic Sign Regulations and General Directions 2016
- All markings are to be laid in thermoplastic screed in accordance with BS EN 1871, with primer applied beforehand
- Unless specified all white markings shall be reflectorized with solid glass beads in accordance with BS 6088 by incorporation (except for pre-formed markings) into the road marking mixture and to the wet surface of the marking
- All symbols to be preformed in accordance with Appendix 12/3 of the specification
- Signs on footway to be mounted at the height of 2.3m and higher where cycling is permitted, a minimum of 2.1m elsewhere
- All signs to have a minimum horizontal clearance of 450mm from face of kerb
- Refer to contract drawings BCC Highways contract drawings for typical construction details

Rev	Date	Description	Drawn	Checked

The Aquarium, King Street, Reading, RG1 2AN  
www.pja.co.uk

Drawing No. 04965-PM-L-C-03-04

Scale at A3 1:250

Ordnance Survey (c) 2020. All rights reserved. Licence number xxxxxxxxx

**Project**  
Lozells Traffic Management

**Drawing**  
Church Street - Graham Street - Anglesey Street - One Way System 04 of 05 Concept Design

**Client**  
Birmingham City Council

Revision	Status	Date
-	DRAFT	29/09/20
	For Discussion	

Designed	Checked	Approved
JMC	JMQ	JMQ



These drawings have been produced with reference to the CDM Regulations 2015. Please note that these are pre-construction phase drawings and should be subject to further design risk management as required in accordance with Regulation 9.

- Notes
- All measurements in metres unless otherwise stated.
  - This drawing is to be read in conjunction with all relevant project drawings and BCC specification
  - All electrical works to be carried out by qualified and competent electrician
  - Electrical disconnections and reconnections to be organised by BCC contractor
  - All traffic sign and road markings are to comply with Traffic Sign Regulations and General Directions 2016
  - All markings are to be laid in thermoplastic screed in accordance with BS EN 1871, with primer applied beforehand
  - Unless specified all white markings shall be reflectorized with solid glass beads in accordance with BS 6088 by incorporation (except for pre-formed markings) into the road marking mixture and to the wet surface of the marking
  - All symbols to be performed in accordance with Appendix 12/3 of the specification
  - Signs on footway to be mounted at the height of 2.3m and higher where cycling is permitted, a minimum of 2.1m elsewhere
  - All signs to have a minimum horizontal clearance of 450mm from face of kerb
  - Refer to contract drawings BCC Highways contract drawings for typical construction details

- Key
- Proposed Footway Resurfacing
  - Proposed Keybloc Grey
  - Proposed Buff Surface Dressing
  - Proposed Planter
  - Remove road surface
  - Proposed Carriageway Resurfacing
  - Proposed Asphalt Table
  - Proposed Kerb
  - Proposed Dropped Kerb Flush
  - Existing Line Marking
  - Existing Line Marking Removed
  - Proposed White Line Marking
  - Proposed Yellow Line Marking
  - Existing / Proposed Tree
  - Existing / Proposed Lamp Column
  - Existing / Proposed Sign Post
  - Existing / Proposed Bollard
  - Proposed Fold-down Bollard
  - Existing Street Furniture Removed
  - Existing / Proposed Gully

Rev	Date	Description	Drawn	Checked

The Aquarium  
King Street  
Reading  
RG1 2AN  
www.pja.co.uk



**Project**  
Lozells Traffic Management

**Drawing**  
Church Street - Graham Street - Anglesey Street  
One Way System  
05 of 05  
Concept Design

**Client**  
Birmingham City Council

**Drawing No.**  
04965-PM-L-C-03-05

Status	Date	Revision
For Discussion	06/09/20	-
Designed		
Checked		
Approved		

Scale at 1:250  
JMC JMQ JMG

Ordnance Survey (c) 2020. All rights reserved. Licence number xxxxxxxx

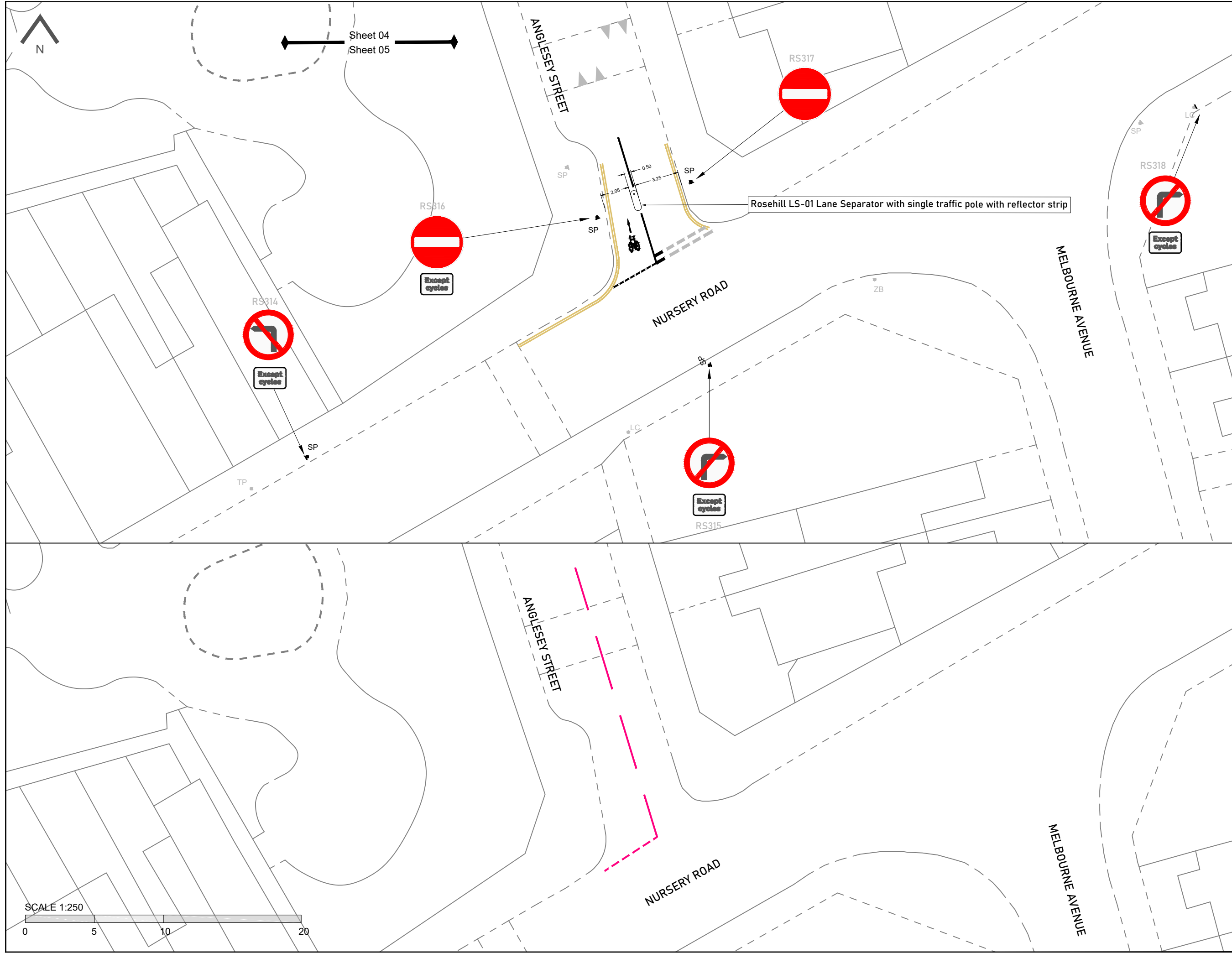

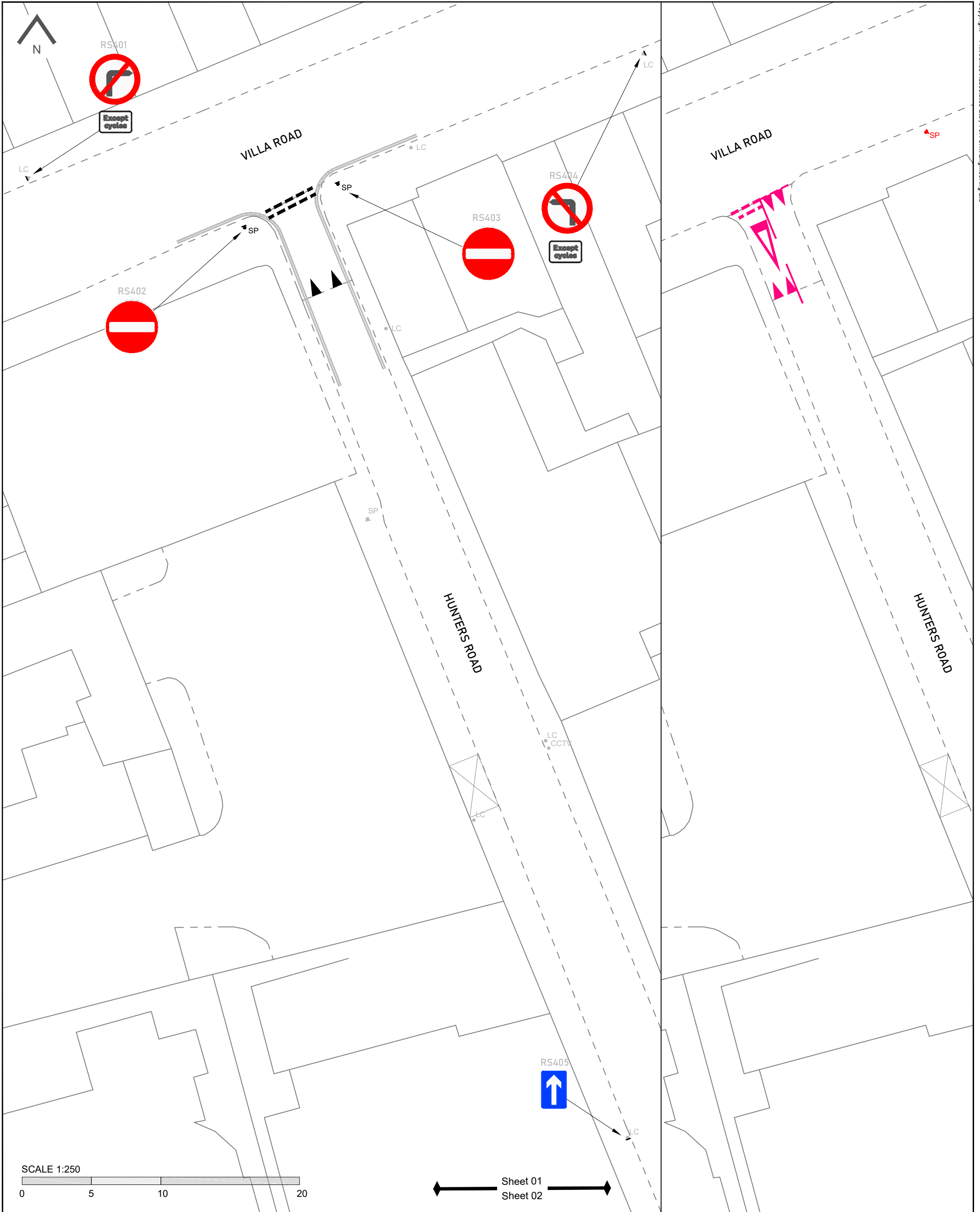

Sheet 01  
Sheet 02

Key	
	Proposed Footway Resurfacing
	Proposed Keyloc Grey
	Proposed Buff Surface Dressing
	Proposed Planter
	Remove road surface
	Proposed Carriageway Resurfacing
	Proposed Asphalt Table
	Proposed Kerb
	Proposed Dropped Kerb Flush
	Existing Line Marking
	Existing Line Marking Removed
	Proposed White Line Marking
	Proposed Yellow Line Marking
	Existing / Proposed Tree
	Existing / Proposed Lamp Column
	Existing / Proposed Sign Post
	Proposed Fold-down Bollard
	Existing Street Furniture Removed
	Existing / Proposed Gully

These drawings have been produced with reference to the CDM Regulations 2015. Please note that these are pre-construction phase drawings and should be subject to further design risk management as required in accordance with Regulation 9.

Notes

- All measurements in metres unless otherwise stated.
- This drawing is to be read in conjunction with all relevant project drawings and BCC specification
- All electrical works to be carried out by qualified and competent electrician
- Electrical disconnections and reconnections to be organised by BCC/contractor
- All traffic sign and road markings are to comply with Traffic Sign Regulations and General Directions 2016
- All markings are to be laid in thermoplastic screed in accordance with BS EN 1871, with primer applied beforehand
- Unless specified all white markings shall be reflectorized with solid glass beads in accordance with BS 6088 by incorporation (except for pre-formed markings) into the road marking mixture and to the wet surface of the marking
- All symbols to be preformed in accordance with Appendix 12/3 of the specification
- Signs on footway to be mounted at the height of 2.3m and higher where cycling is permitted, a minimum of 2.1m elsewhere
- All signs to have a minimum horizontal clearance of 450mm from face of kerb
- Refer to contract drawings BCC Highways contract drawings for typical construction details

Rev	Date	Description	Drawn	Checked

The Aquarium, King Street,  
Reading, RG1 2AN  
www.pja.co.uk

**Project**  
Lozells Traffic Management

**Drawing**  
Hunters Road  
One way street  
01 of 03 Concept Design

**Client**  
Birmingham City Council

**Drawing No.**  
04965-PM-L-C-04-01

**Scale at A3**  
1:250

**Ordnance Survey (c) 2020. All rights reserved. Licence number xxxxxxxxx**

<b>Revision</b>	<b>Status</b>	<b>Date</b>	
-	<b>DRAFT</b>	29/09/20	
<b>Designed</b>	<b>Checked</b>	<b>Approved</b>	
JMC	JMQ	JMQ	

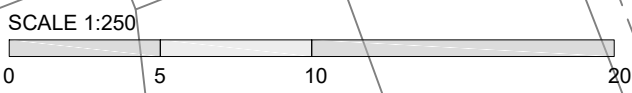
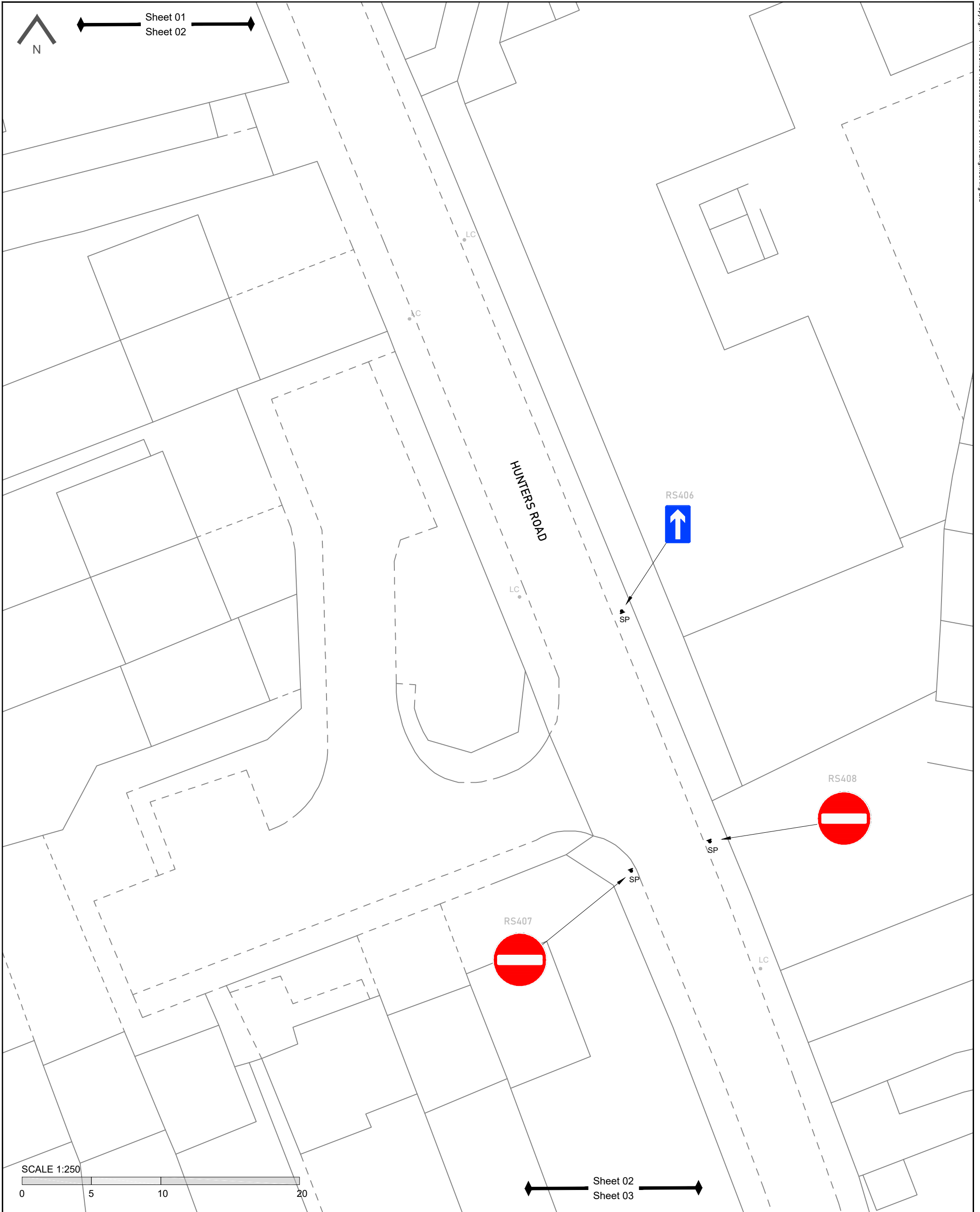

Key	
	Proposed Footway Resurfacing
	Proposed Keyloc Grey
	Proposed Buff Surface Dressing
	Proposed Planter
	Remove road surface
	Proposed Carriageway Resurfacing
	Proposed Asphalt Table
	Proposed Kerb
	Proposed Dropped Kerb Flush
	Existing Line Marking
	Existing Line Marking Removed
	Proposed White Line Marking
	Proposed Yellow Line Marking
	Existing / Proposed Tree
	Existing / Proposed Lamp Column
	Existing / Proposed Sign Post
	Proposed / Existing Bollard
	Proposed Fold-down Bollard
	Existing Street Furniture Removed
	Existing / Proposed Gully

These drawings have been produced with reference to the CDM Regulations 2015. Please note that these are pre-construction phase drawings and should be subject to further design risk management as required in accordance with Regulation 9.

Notes

- All measurements in metres unless otherwise stated.
- This drawing is to be read in conjunction with all relevant project drawings and BCC specification
- All electrical works to be carried out by qualified and competent electrician
- Electrical disconnections and reconnections to be organised by BCC/contractor
- All traffic sign and road markings are to comply with Traffic Sign Regulations and General Directions 2016
- All markings are to be laid in thermoplastic screed in accordance with BS EN 1871, with primer applied beforehand
- Unless specified all white markings shall be reflectorized with solid glass beads in accordance with BS 6088 by incorporation (except for pre-formed markings) into the road marking mixture and to the wet surface of the marking
- All symbols to be preformed in accordance with Appendix 12/3 of the specification
- Signs on footway to be mounted at the height of 2.3m and higher where cycling is permitted, a minimum of 2.1m elsewhere
- All signs to have a minimum horizontal clearance of 450mm from face of kerb
- Refer to contract drawings BCC Highways contract drawings for typical construction details

Rev	Date	Description	Drawn	Checked

The Aquarium, King Street,  
Reading, RG1 2AN  
www.pja.co.uk

Drawing No. 04965-PM-L-C-04-02

Scale at A3 1:250

Ordnance Survey (c) 2020. All rights reserved. Licence number xxxxxxxxx

**Project**  
Lozells Traffic Management

**Drawing**  
Hunters Road  
One way street  
02 of 03 Concept Design

**Client**  
Birmingham City Council

Revision	Status	Date
-	FOR DISCUSSION	29/09/20

Designed: JMC    Checked: JMQ    Approved: JMQ

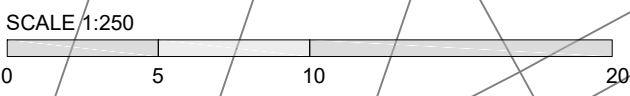
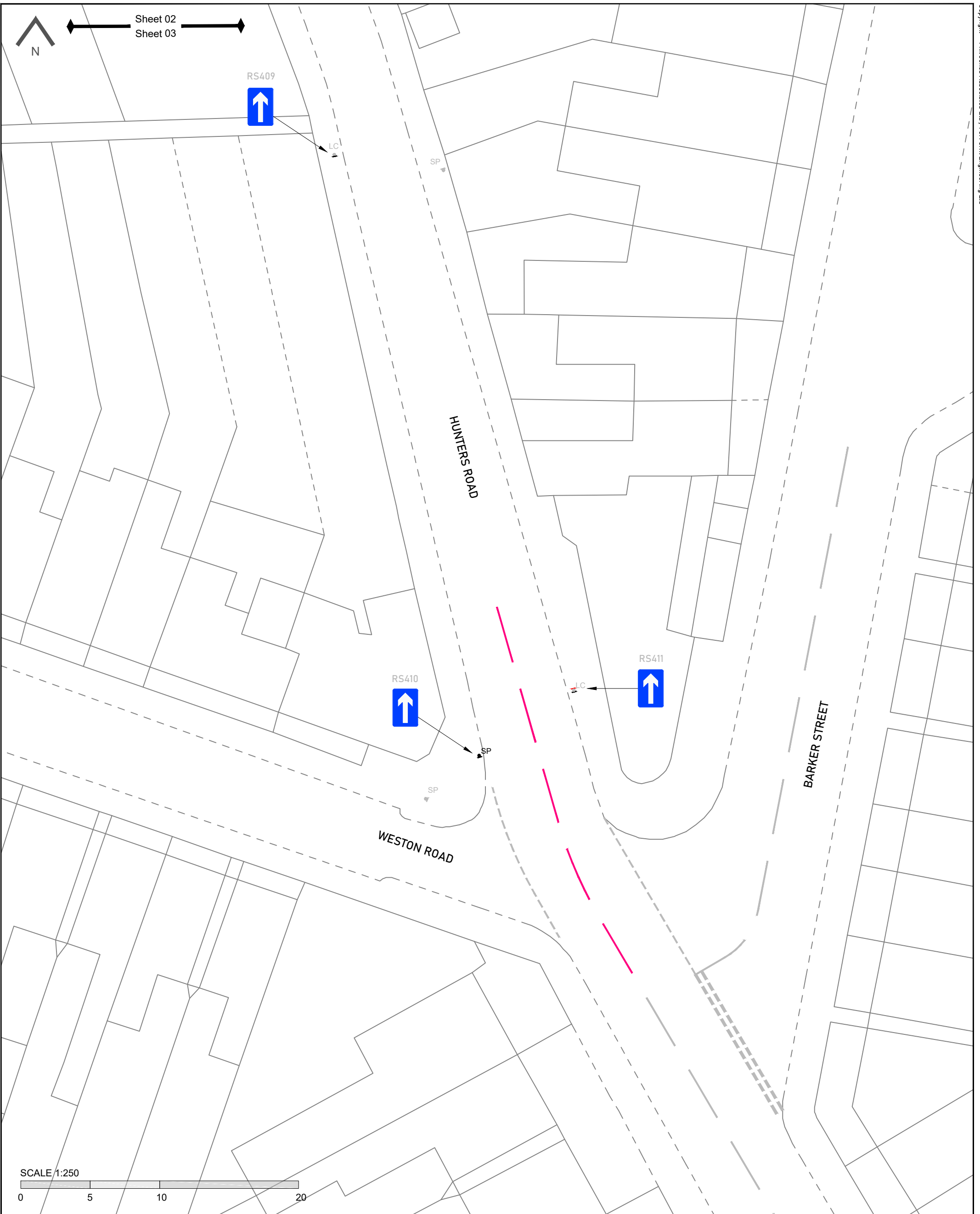

Key	
	Proposed Footway Resurfacing
	Proposed Keyloc Grey
	Proposed Buff Surface Dressing
	Proposed Planter
	Remove road surface
	Proposed Carriageway Resurfacing
	Proposed Asphalt Table
	Proposed Kerb
	Proposed Dropped Kerb Flush
	Existing Line Marking
	Existing Line Marking Removed
	Proposed White Line Marking
	Proposed Yellow Line Marking
	Existing / Proposed Tree
	Existing / Proposed Lamp Column
	Existing / Proposed Sign Post
	Proposed Fold-down Bollard
	Existing Street Furniture Removed
	Existing / Proposed Gully

These drawings have been produced with reference to the CDM Regulations 2015. Please note that these are pre-construction phase drawings and should be subject to further design risk management as required in accordance with Regulation 9.

Notes

- All measurements in metres unless otherwise stated.
- This drawing is to be read in conjunction with all relevant project drawings and BCC specification
- All electrical works to be carried out by qualified and competent electrician
- Electrical disconnections and reconnections to be organised by BCC/contractor
- All traffic sign and road markings are to comply with Traffic Sign Regulations and General Directions 2016
- All markings are to be laid in thermoplastic screed in accordance with BS EN 1871, with primer applied beforehand
- Unless specified all white markings shall be reflectorized with solid glass beads in accordance with BS 6088 by incorporation (except for pre-formed markings) into the road marking mixture and to the wet surface of the marking
- All symbols to be preformed in accordance with Appendix 12/3 of the specification
- Signs on footway to be mounted at the height of 2.3m and higher where cycling is permitted, a minimum of 2.1m elsewhere
- All signs to have a minimum horizontal clearance of 450mm from face of kerb
- Refer to contract drawings BCC Highways contract drawings for typical construction details

Rev	Date	Description	Drawn	Checked

**PJA**

The Aquarium, King Street,  
Reading, RG1 2AN  
www.pja.co.uk

**Project**  
Lozells Traffic Management

**Drawing**  
Hunters Road  
One way street  
03 of 03 Concept Design

**Client**  
Birmingham City Council

DRAFT

Drawing No.	Revision	Status	Date
04965-PM-L-C-04-03	-	For Discussion	29/09/20

Scale at A3	Designed	Checked	Approved
1:250	JMC	JMQ	JMQ

Ordnance Survey (c) 2020. All rights reserved. Licence number xxxxxxxxx