

LONGBRIDGE LANE/ COOMBES LANE/TURVES GREEN SIGNALISED JUNCTION ADDITIONAL PROPOSALS CA_02712_S1_030

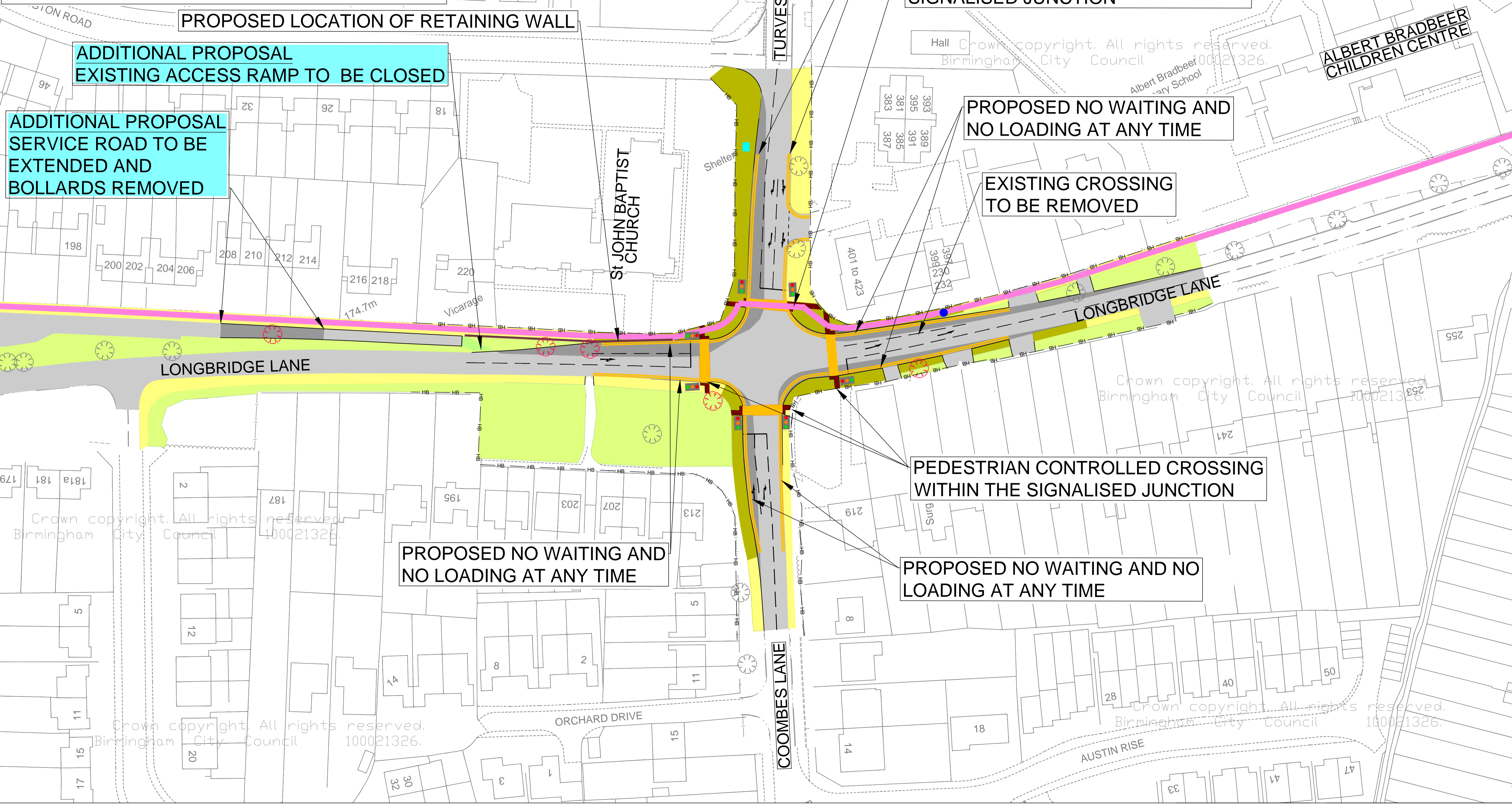
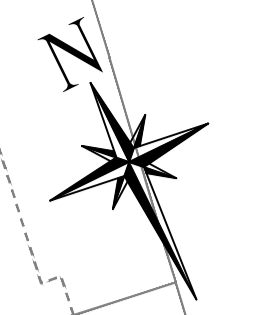

**ADDITIONAL PROPOSAL
EXISTING ACCESS RAMP TO BE CLOSED**

**ADDITIONAL PROPOSAL
SERVICE ROAD TO BE
EXTENDED AND
BOLLARDS REMOVED**

**PROPOSED NO WAITING AND
NO LOADING AT ANY TIME**

**SHARED PEDESTRIAN/CYCLIST
CONTROLLED CROSSING WITHIN THE
SIGNALISED JUNCTION**

**PROPOSED NO WAITING AND
NO LOADING AT ANY TIME**

**EXISTING CROSSING
TO BE REMOVED**

**PEDESTRIAN CONTROLLED CROSSING
WITHIN THE SIGNALISED JUNCTION**

**PROPOSED NO WAITING AND
NO LOADING AT ANY TIME**

**PROPOSED NO WAITING AND NO
LOADING AT ANY TIME**

KEY	
	Proposed landscaping
	Existing Footway
	Existing landscaping
	Existing tree to remain
	Proposed footway
	Proposed pedestrian crossing
	Existing tree to be removed; replacement trees will be provided
	Existing bus stop to be upgraded by Centro
	Proposed traffic signals
	Proposed bus stop to be installed by Centro
	Highway Boundary
	Proposed kerb
	Proposed Carriageway
	Existing Carriageway
	Proposed un-segregated cycle route on footway
	Proposed double yellow lines
	No waiting no loading restriction

Birmingham City Council
ANNE SHAW
HEAD OF TRANSPORTATION SERVICES
1 LANCASTER CIRCUS
BIRMINGHAM B4 7DQ

SCHEME: LONGBRIDGE CONNECTIVITY
LONGBRIDGE LANE/TURVES GREEN/COOMBES LANE
JUNCTION
ADDITIONAL PROPOSALS

DATE	REV	FIRST ISSUE	JM	JAC
15/09/2021	1			
DATE	REV	REVISIONS	JM	JAC
15/09/2021	1			
DRAWN	DESIGNER	PM	REVISION	A
AS/CCM	BJC & AECOW	LB		
DRAWING STATUS	GENERAL	SCALE	1:500	

CONSULTATION DRAWING

bsi ISO 9001 Quality Management
ice award winner
ICE West Midlands Annual Awards

This map is based upon Ordnance Survey material with the permission of Ordnance Survey on behalf of the Controller of Her Majesty's Stationery Office. Copyright. Unauthorised reproduction infringes Crown copyright and may lead to prosecution or civil proceedings. B.G.C. License No: 100021326 Date 2015