

# TESSALL LANE CYCLE IMPROVEMENTS

CA-02712\_S3\_011

For details of cycle route on Tessall Lane towards Bristol Road South see drawing CA-02712\_S3\_012

Crown copyright. All rights reserved.  
Birmingham City Council 100021326.

National Cycle Network Route 5  
off public highway

Carriageway widening to allow u-turn facility  
for vehicles

Proposed bollard to prevent  
vehicular access but still allow  
access for pedestrians and cyclists

This section of road to  
be for cyclists and  
pedestrians use only

Existing on-street car parking to be  
removed. Displaced parking to use  
West Car Park and new multistorey  
car park in Longbridge Town Centre

Existing 'No Entry'  
restriction to remain

Existing footway to remain for pedestrians

Proposed raised surface to  
assist pedestrians crossing

For details of cycle route on  
Longbridge Lane towards  
Lickey Road see drawing  
CA-02712\_S2\_006

For details of cycle route on  
Longbridge Lane towards  
Groveley Lane see drawing  
CA-02712\_S1\_014



- Key:-**
- Proposed pedestrian crossing
  - Proposed carriageway
  - Proposed bollard
  - Proposed kerb
  - Existing footway to remain
  - Existing landscaping to remain
  - Existing carriageway to remain
  - Existing central island to remain
  - Proposed cycleway on carriageway
  - Proposed un-segregated cycle route on footway
  - Existing un-segregated cycle route on footway
  - Existing National Cycle Network Route 5

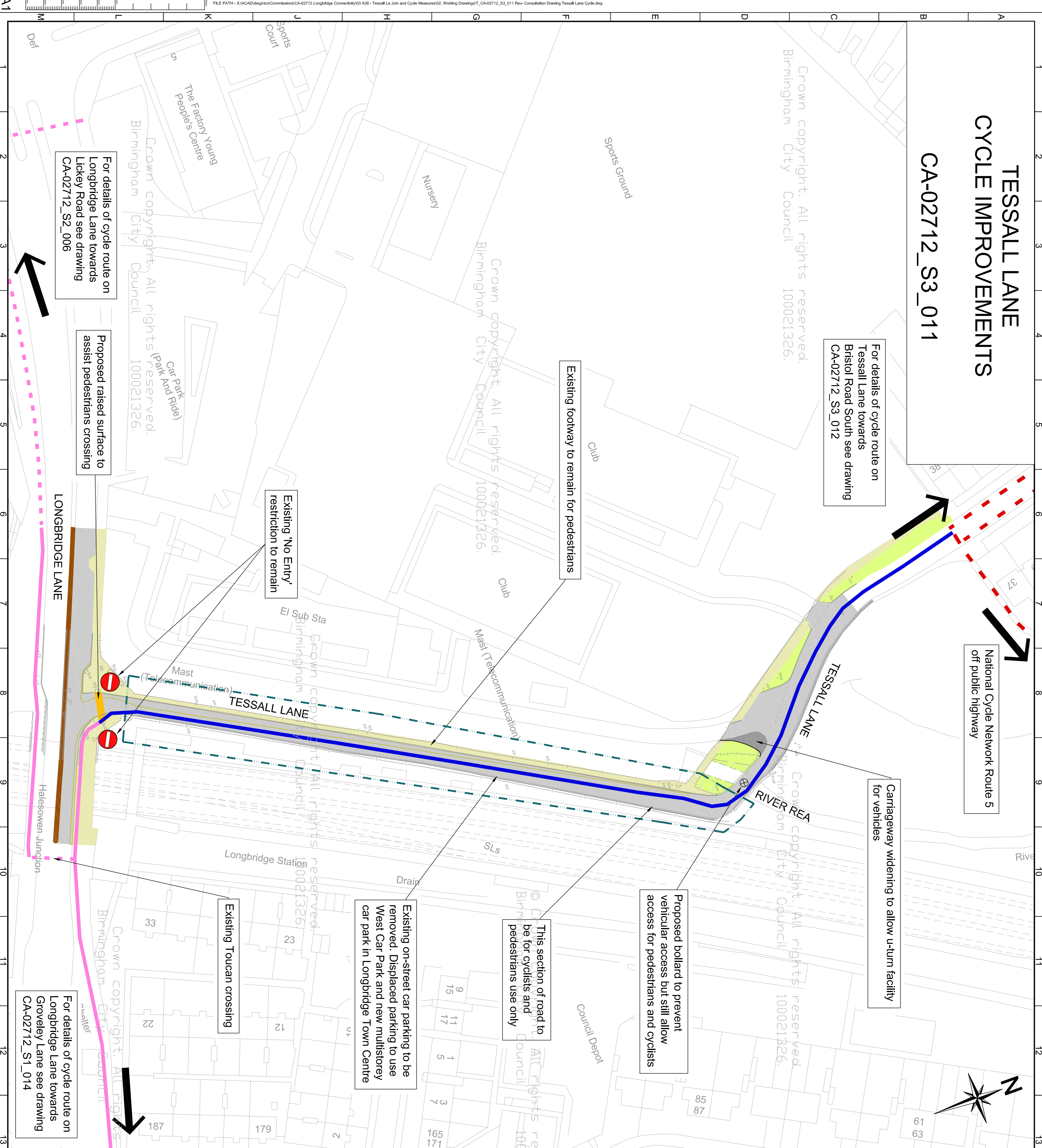

100021326.

**Birmingham City Council**

NAME: SAHM  
ADDRESS: 1, LANDAFTER DRIVE  
BIRMINGHAM B1 1DD

**ice** **IMMEDIATE**  
CONSULTATION SERVICES

SCHEME: LONGBRIDGE CONNECTIVITY  
CYCLE IMPROVEMENTS

DRAWING: CONSULTATION DRAWING

DATE:	DESIGNED BY:	DESIGNED BY:	DESIGNED BY:
15/01/2024	EA	NM	JC
SCALE:	1:500		
GENERAL:	CA-02712_S3_011		