

Why Perry Barr?

Planned Growth

Birmingham's population is set to grow by 156,000 people by 2031 and new housing, jobs and infrastructure is required to support this growth.

Perry Barr is identified in the Birmingham Development Plan as an area of growth in the city and the Commonwealth Games provides a catalyst to accelerate this planned growth.

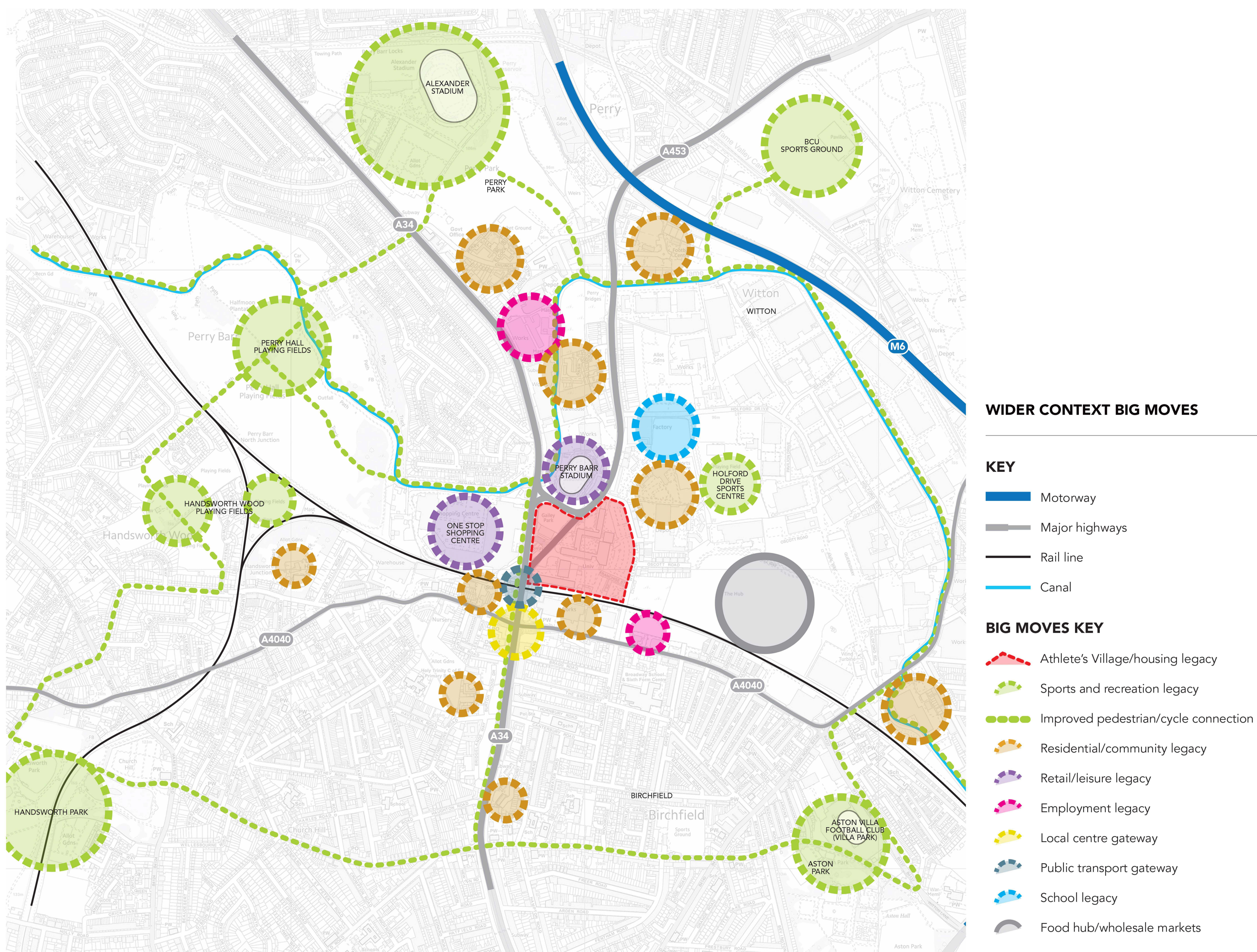

Planned Improvements

The planned growth at Perry Barr will be supported by a number of improvements including:

- Upgrade of Perry Barr railway station
- A new public transport interchange
- Significant highway improvements
- Improvements to the public realm
- Improved sport and leisure provision
- A new school
- New commercial development opportunities

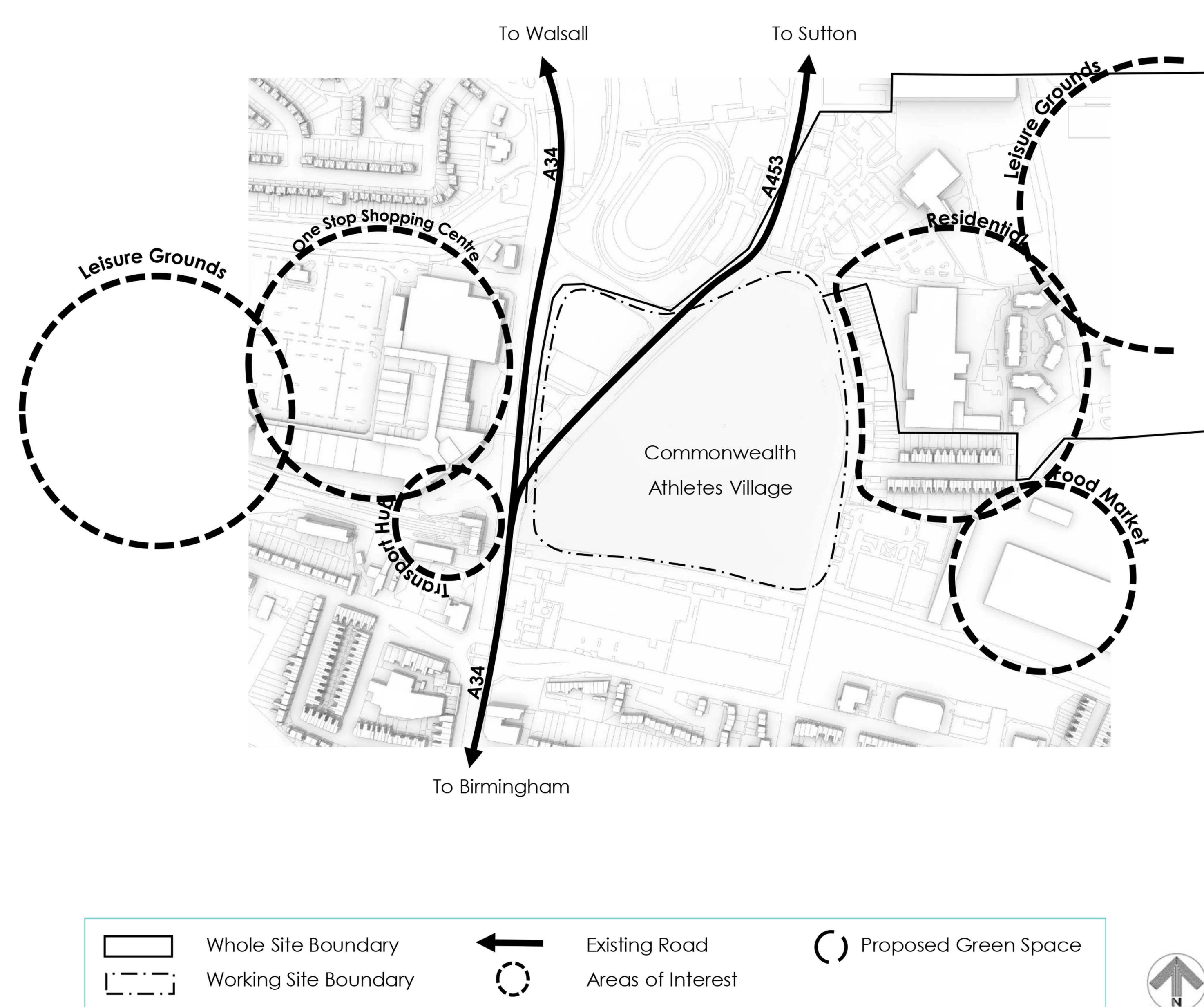
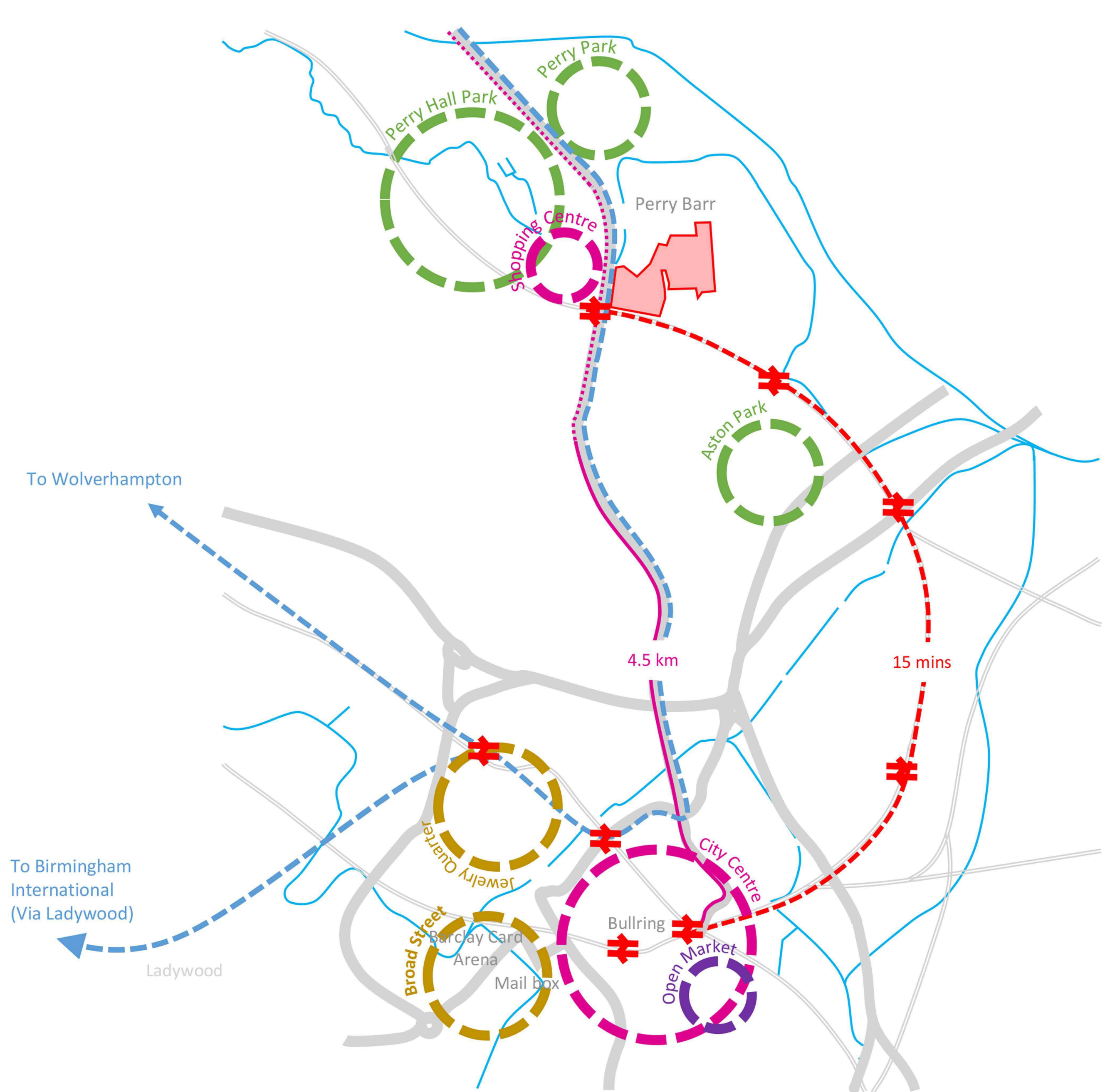

Big Moves diagrams