

A45 - 17

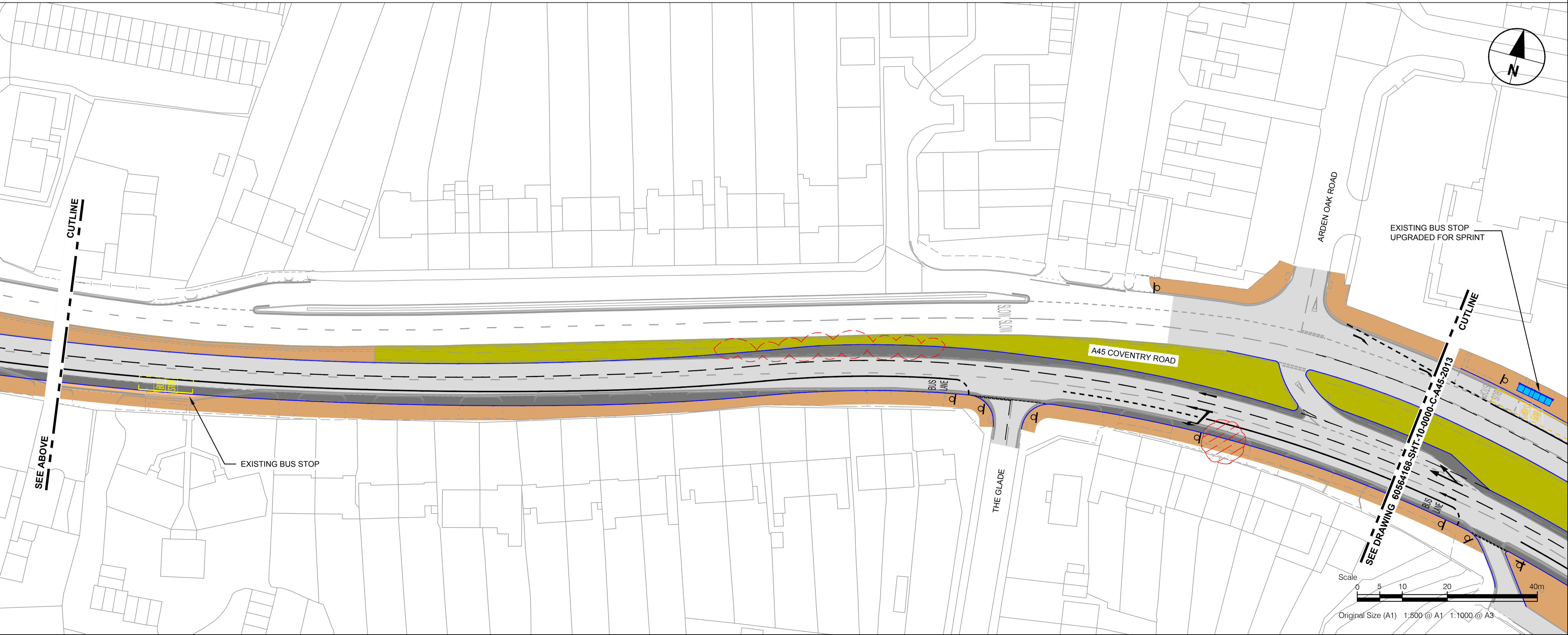

PROJECT

BUS RAPID TRANSIT SPRINT - SOLIHULL AND AIRPORT TO BIRMINGHAM

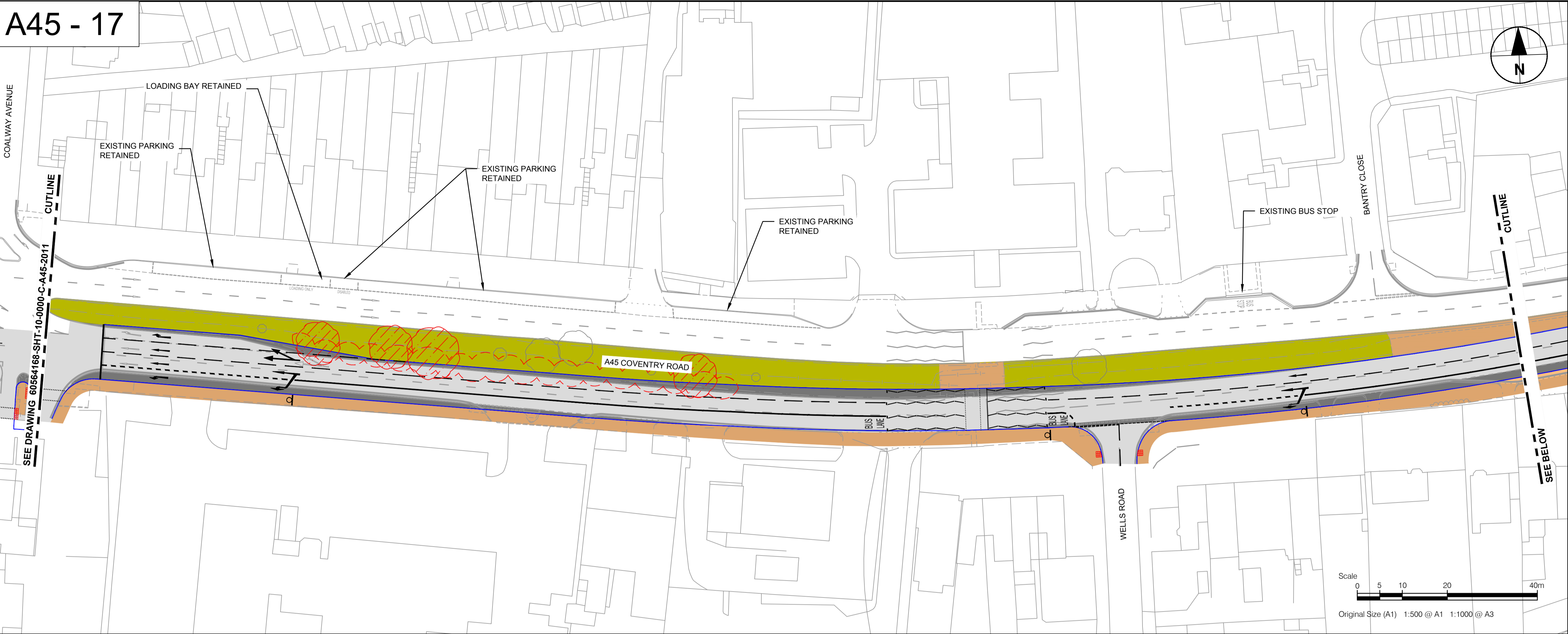

KEY

| | |
|--|--------------------------------------|
| | PROPOSED CARRIAGEWAY |
| | EXISTING CARRIAGEWAY |
| | PROPOSED FOOTWAY |
| | EXISTING FOOTWAY |
| | PROPOSED LANDSCAPING |
| | EXISTING LANDSCAPING |
| | PROPOSED KERB |
| | TREES TO BE REMOVED / AFFECTED TREES |
| | PROPOSED SIGN |
| | PROPOSED SAFETY BARRIER |
| | SPRINT BUS SHELTER |

PROPOSALS

A45 - 18

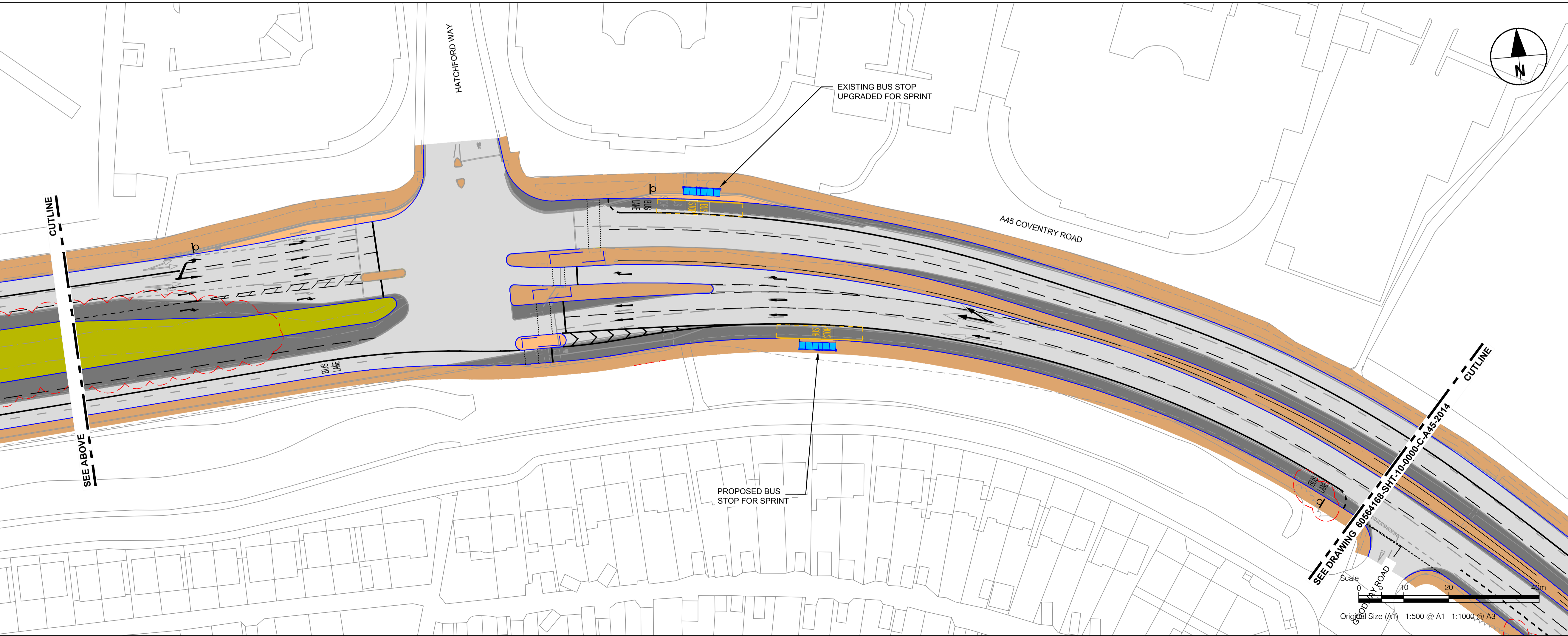
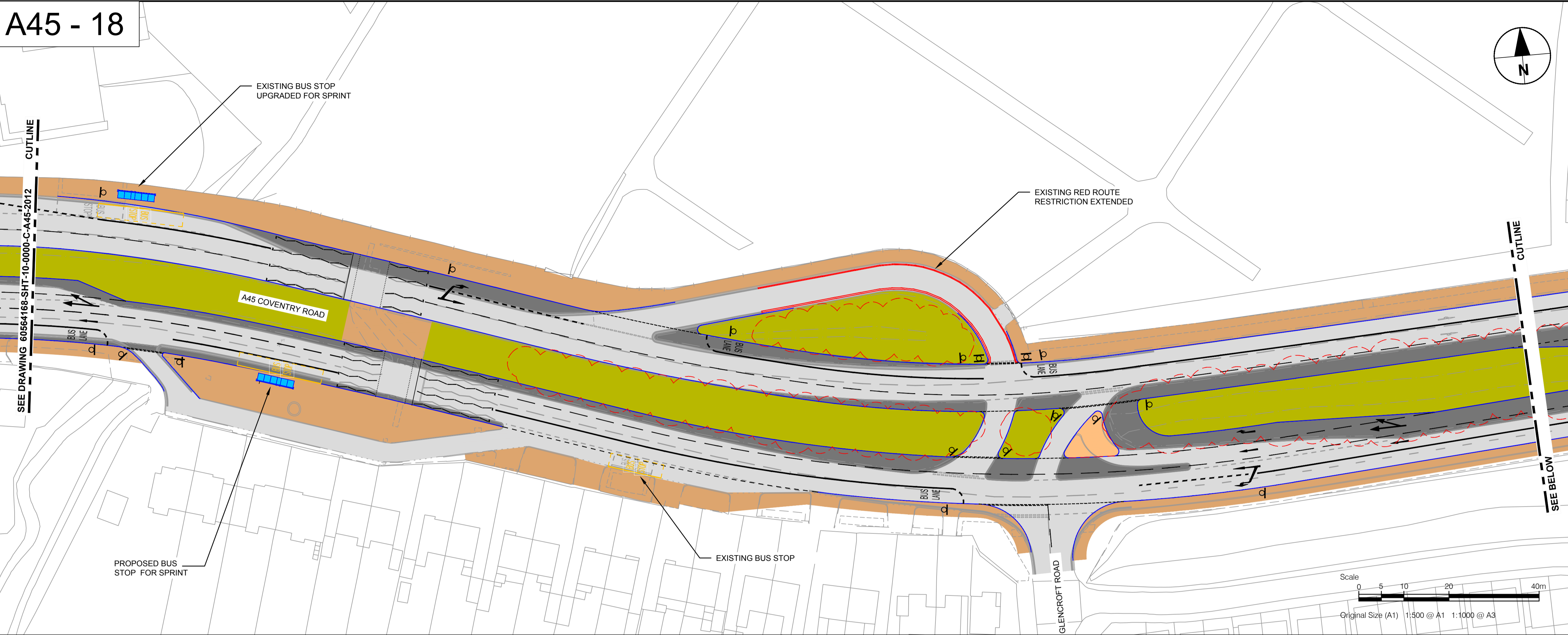

PROJECT

BUS RAPID TRANSIT SPRINT - SOLIHULL AND AIRPORT TO BIRMINGHAM



| KEY | |
|-----|--------------------------------------|
| | PROPOSED CARRIAGEWAY |
| | EXISTING CARRIAGEWAY |
| | PROPOSED FOOTWAY |
| | EXISTING FOOTWAY |
| | PROPOSED LANDSCAPING |
| | EXISTING LANDSCAPING |
| | PROPOSED KERB |
| | TREES TO BE REMOVED / AFFECTED TREES |
| | PROPOSED SIGN |
| | PROPOSED SAFETY BARRIER |
| | SPRINT BUS SHELTER |

PROPOSALS

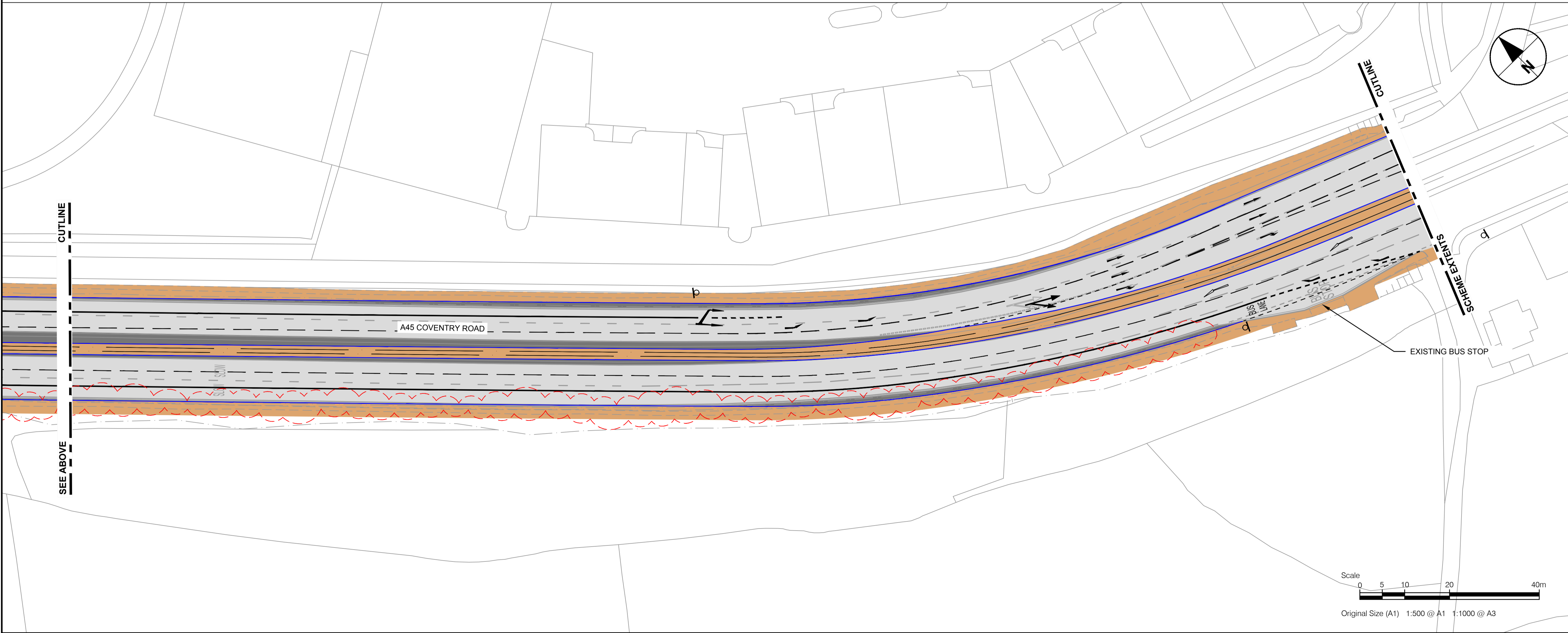
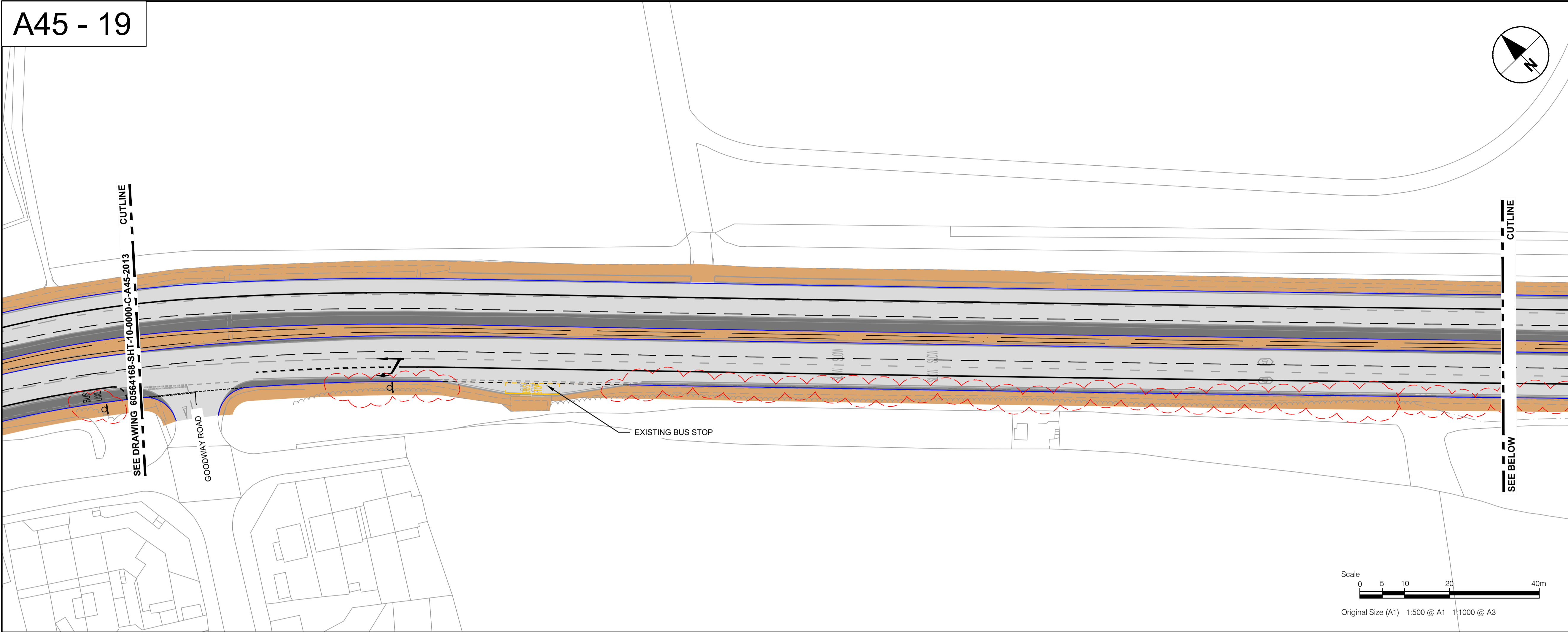

| KEY | |
|-----|-----------------------------------------|
| | PROPOSED CARRIAGEWAY |
| | EXISTING CARRIAGEWAY |
| | PROPOSED FOOTWAY |
| | EXISTING FOOTWAY |
| | PROPOSED LANDSCAPING |
| | EXISTING LANDSCAPING |
| | PROPOSED KERB |
| | TREES TO BE REMOVED / AFFECTED TREES |
| | PROPOSED SIGN |
| | PROPOSED SAFETY BARRIER |
| | SPRINT BUS SHELTER |

PROPOSALS

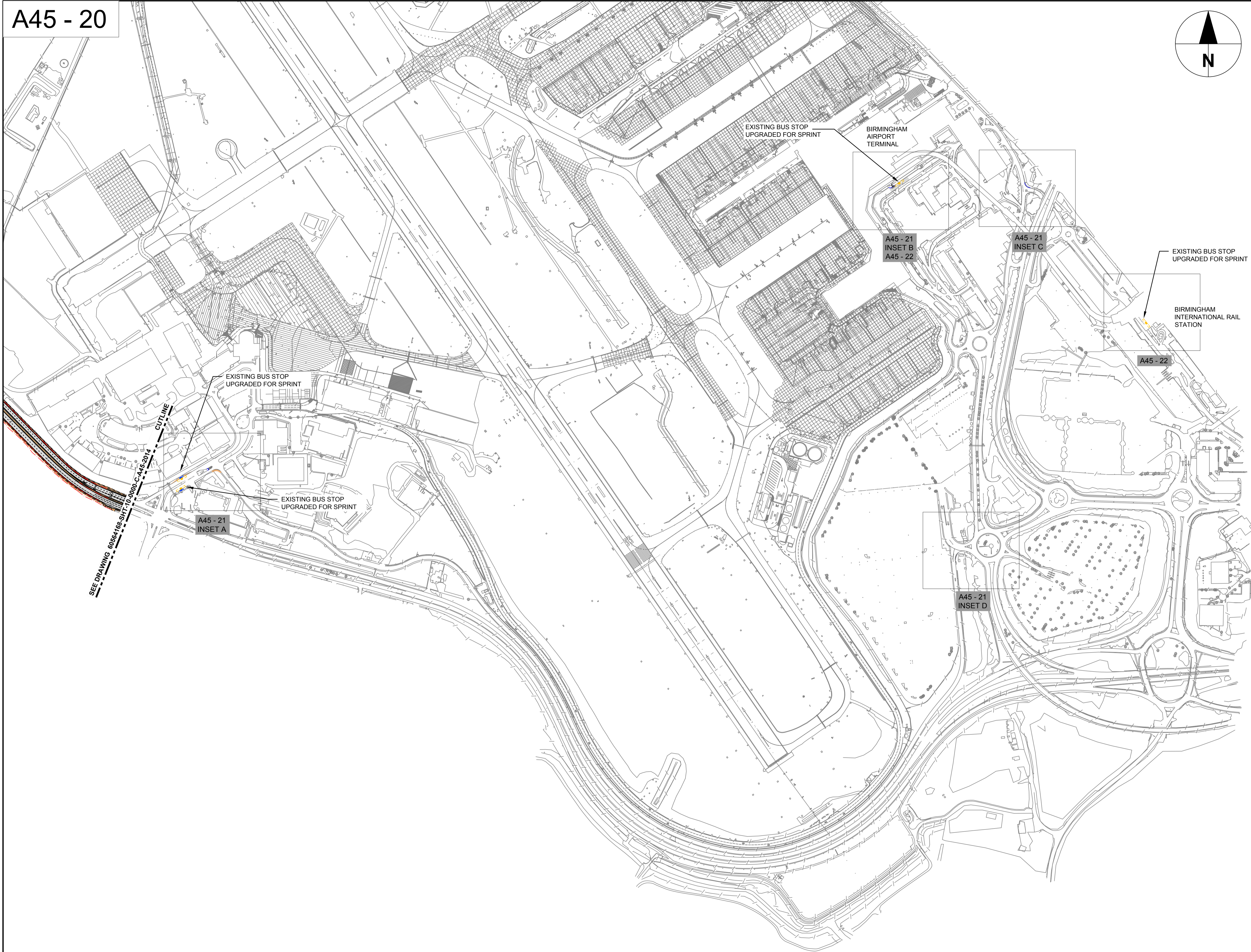
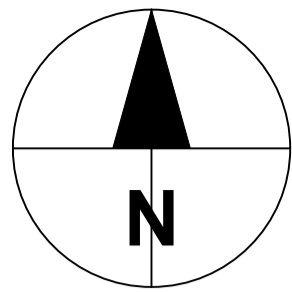

PROJECT

BUS RAPID TRANSIT
SPRINT - SOLIHULL
AND AIRPORT TO
BIRMINGHAM



| KEY | |
|-----|--------------------------------------|
| | PROPOSED CARRIAGEWAY |
| | EXISTING CARRIAGEWAY |
| | PROPOSED FOOTWAY |
| | EXISTING FOOTWAY |
| | PROPOSED LANDSCAPING |
| | EXISTING LANDSCAPING |
| | PROPOSED KERB |
| | TREES TO BE REMOVED / AFFECTED TREES |
| | PROPOSED SIGN |
| | PROPOSED SAFETY BARRIER |
| | SPRINT BUS SHELTER |

PROPOSALS

NOT TO SCALE

This drawing has been prepared for the use of AECOM's client. It may not be used, modified, reproduced or relied upon by third parties, except as agreed by AECOM or as required by law. AECOM accepts no responsibility, and denies any liability whatsoever, to any party that uses or relies on this drawing without AECOM's express written consent. Do not scale this document. All measurements must be obtained from the stated dimensions.

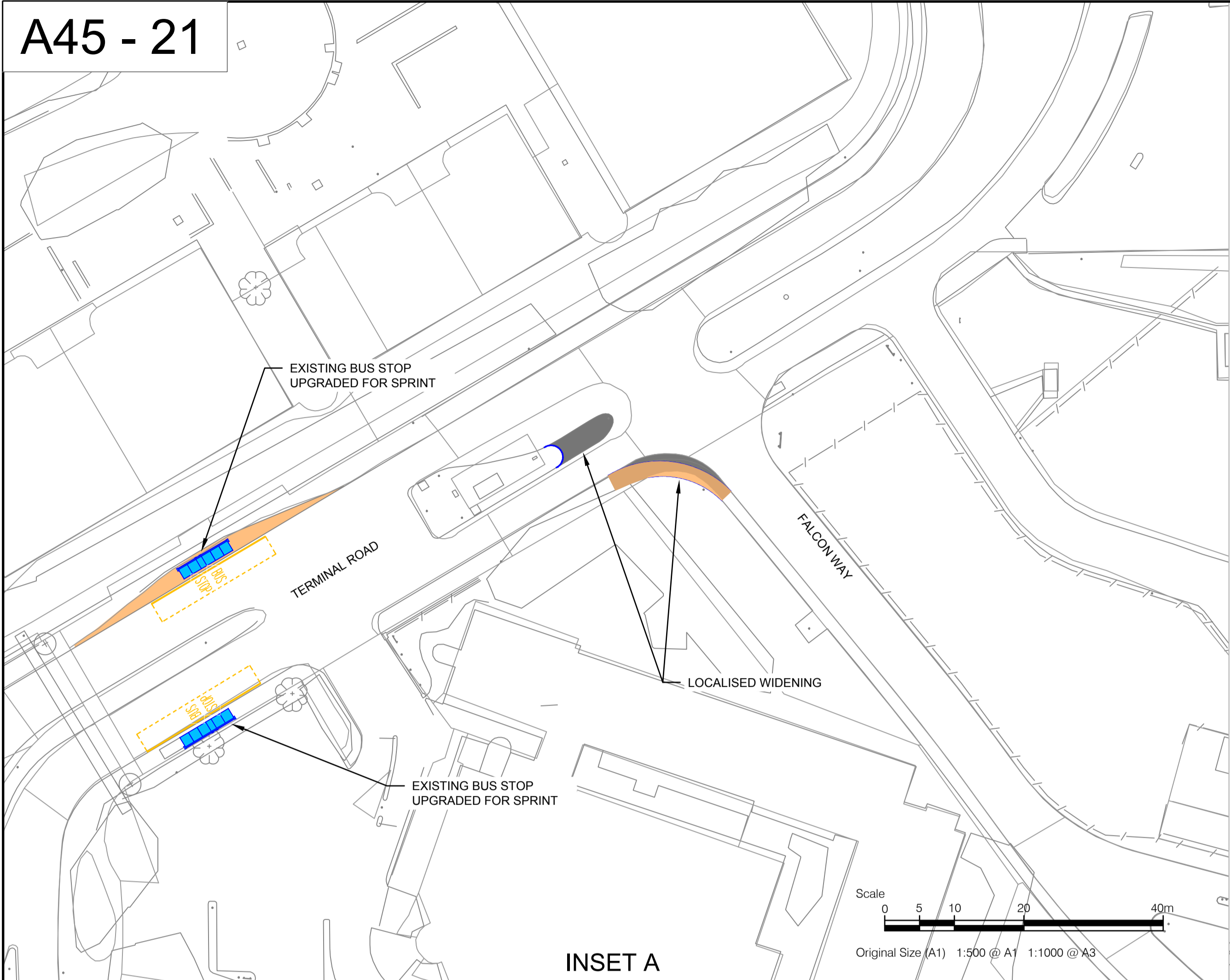

INSET A

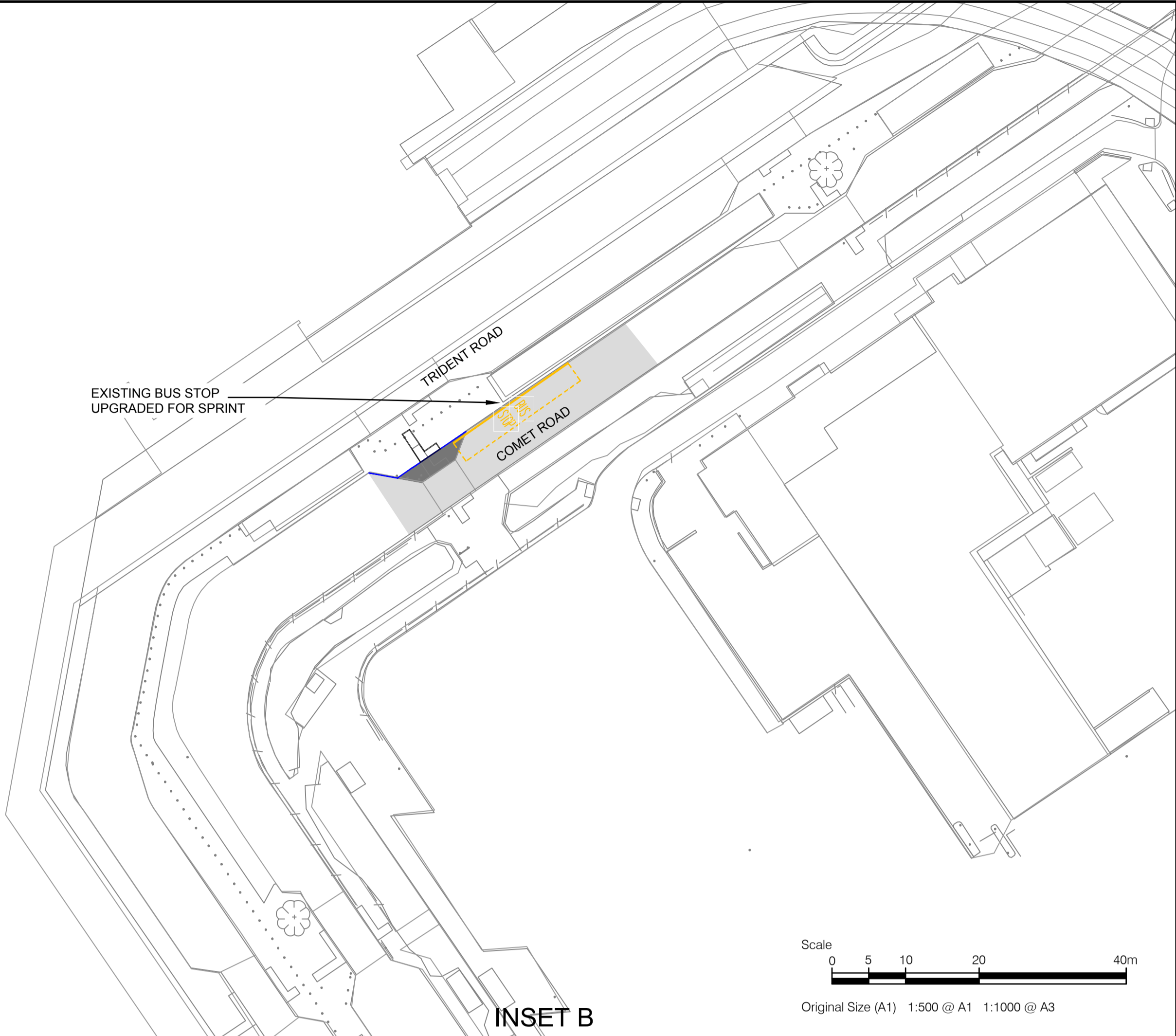

INSET B

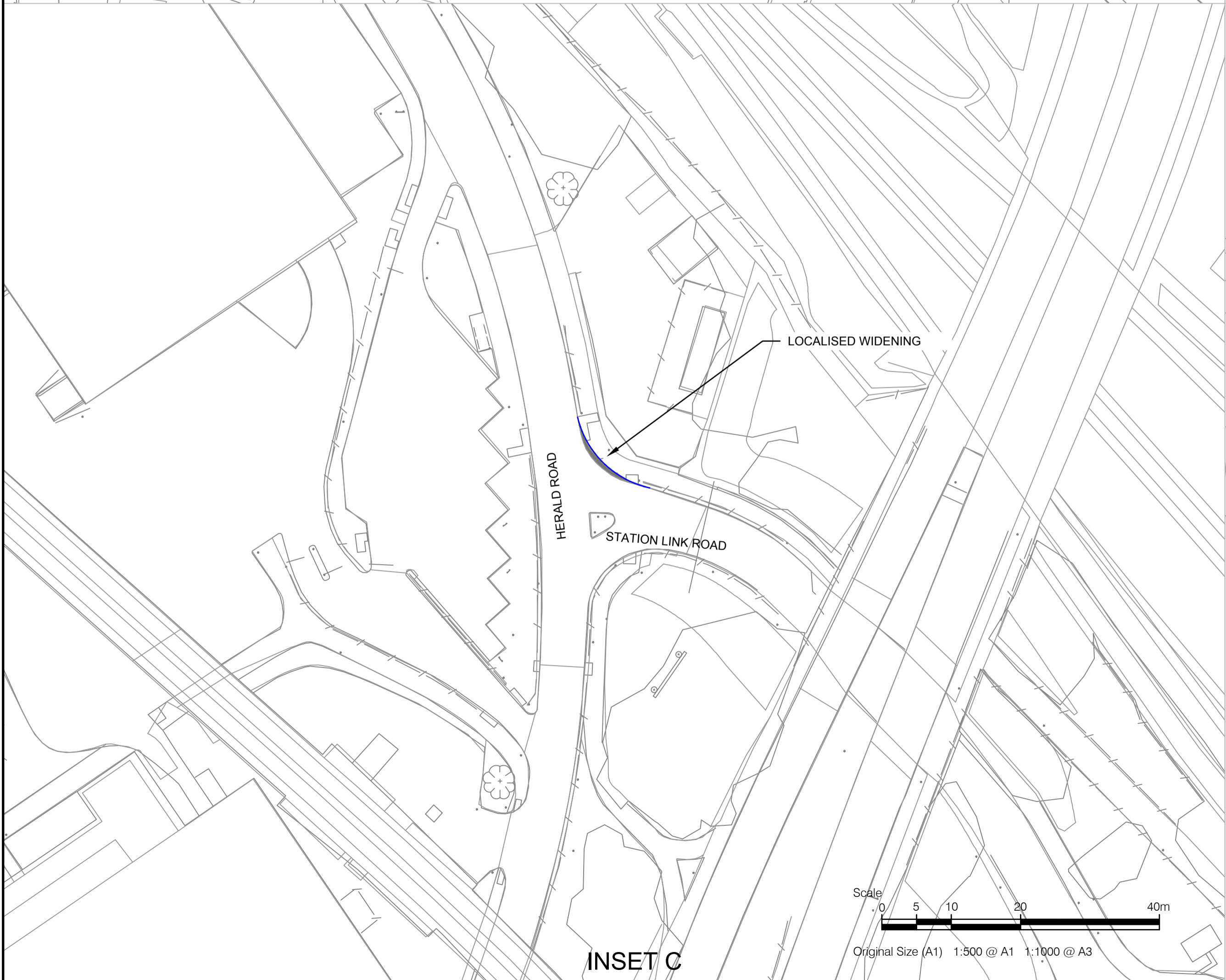

INSET C



INSET D

PROJECT

BUS RAPID TRANSIT
SPRINT - SOLIHULL
AND AIRPORT TO
BIRMINGHAM



KEY

| | |
|--|--------------------------------------|
| | PROPOSED CARRIAGEWAY |
| | EXISTING CARRIAGEWAY |
| | PROPOSED FOOTWAY |
| | EXISTING FOOTWAY |
| | PROPOSED LANDSCAPING |
| | EXISTING LANDSCAPING |
| | PROPOSED KERB |
| | TREES TO BE REMOVED / AFFECTED TREES |
| | PROPOSED SIGN |
| | PROPOSED SAFETY BARRIER |
| | SPRINT BUS SHELTER |

PROPOSALS

BIRMINGHAM AIRPORT TERMINAL

TRIDENT ROAD

COMET ROAD

EXISTING BUILD OUT CUT
BACK FOR SPRINT STOP.
PEDESTRIAN CROSSING
RELOCATED

BIRMINGHAM AIRPORT TERMINAL SPRINT STOP

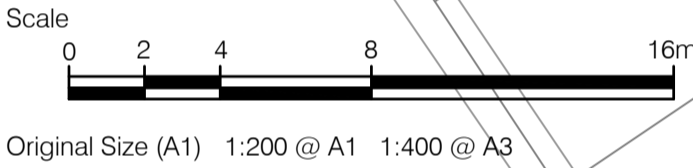

STATION LINK ROAD

BIRMINGHAM INTERNATIONAL RAIL STATION

SPRINT STOP TO BE
LOCATED EXISTING RAIL
STATION DOORS

BIRMINGHAM INTERNATIONAL RAIL STATION SPRINT STOP

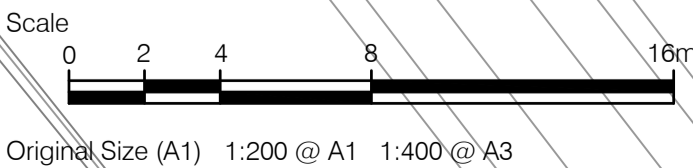

PROJECT

BUS RAPID TRANSIT
SPRINT - SOLIHULL
AND AIRPORT TO
BIRMINGHAM



KEY

| | |
|--|-----------------------------------------|
| | PROPOSED CARRIAGEWAY |
| | EXISTING CARRIAGEWAY |
| | PROPOSED FOOTWAY |
| | EXISTING FOOTWAY |
| | PROPOSED LANDSCAPING |
| | EXISTING LANDSCAPING |
| | PROPOSED KERB |
| | TREES TO BE REMOVED / AFFECTED TREES |
| | PROPOSED SIGN |
| | PROPOSED SAFETY BARRIER |
| | SPRINT BUS SHELTER |

PROPOSALS