

SHEET 19

ISO A1 594mm x 841mm
 Drawn: EMF
 Approved: AC
 Checked: SG
 Designer: —
 Project Management Initials: —
 Revision: C01

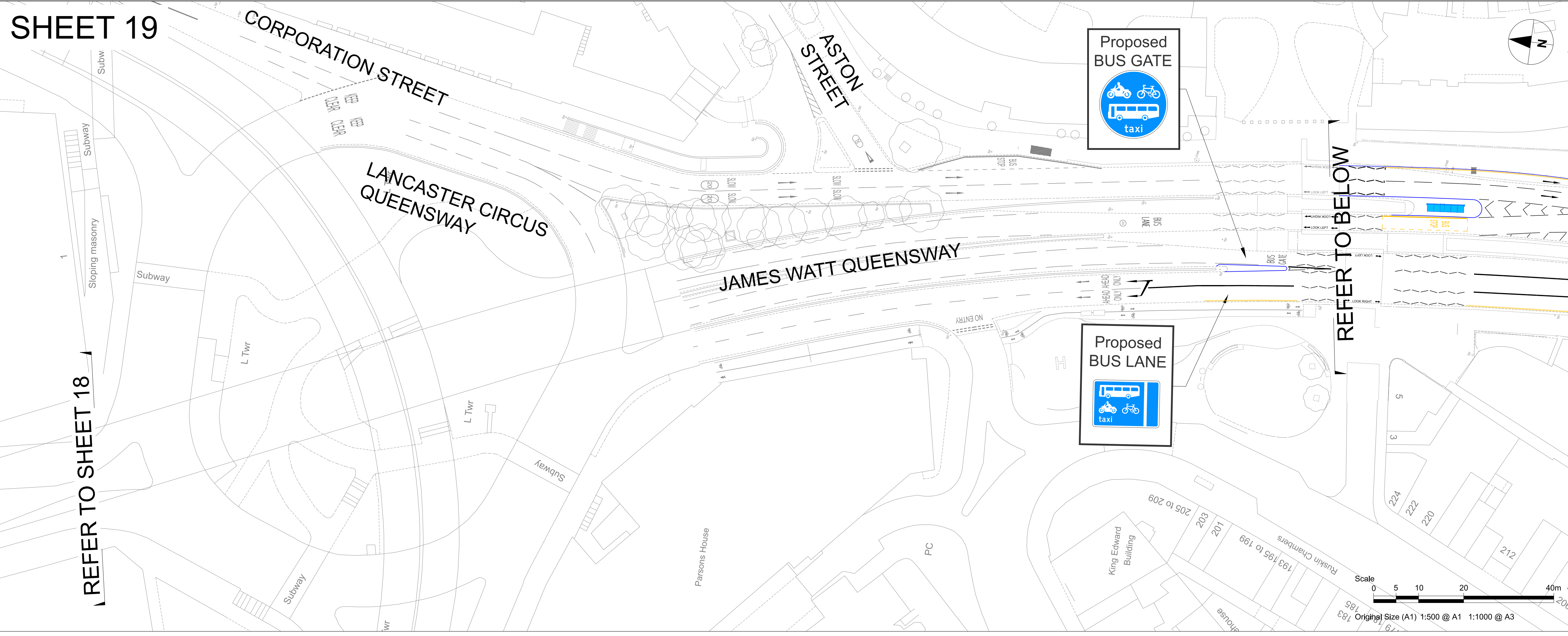

REFER TO SHEET 18

REFER TO BELOW

AECOM

PROJECT
A34 WALSALL TO BIRMINGHAM SPRINT BRT

CLIENT
Transport for West Midlands

CONSULTANT
 AECOM
 The Colmore Building
 Colmore Circus Queensway
 Birmingham
 T:01212621900
 www.aecom.com

REGISTRATION
 Reproduced from the Ordnance Survey map with the permission of the controller of H.M. Stationery Office. © Crown copyright reserved. Licence no. 100031673.

NOTES
 1. ALL WORKS SHALL BE CARRIED OUT IN ACCORDANCE WITH THE CONTRACT SPECIFICATION AND THE MANUAL OF CONTRACT DOCUMENTS FOR HIGHWAY WORKS INCLUDING REVISION/AMENDMENTS AND ANY CLIENT SPECIFIC ADDITIONAL OR SUBSTITUTE CLAUSES.
 2. ANY DISCREPANCIES, ERRORS OR OMISSIONS TO BE BROUGHT TO THE ATTENTION OF THE PROJECT MANAGER.
 3. ALL DIMENSIONS TO BE CHECKED BEFORE COMMENCEMENT OF WORK ON SITE.
 4. ALL DIMENSIONS IN METRES UNLESS OTHERWISE STATED.

KEY
 PROPOSED KERBLINE
 PROPOSED ROAD MARKINGS

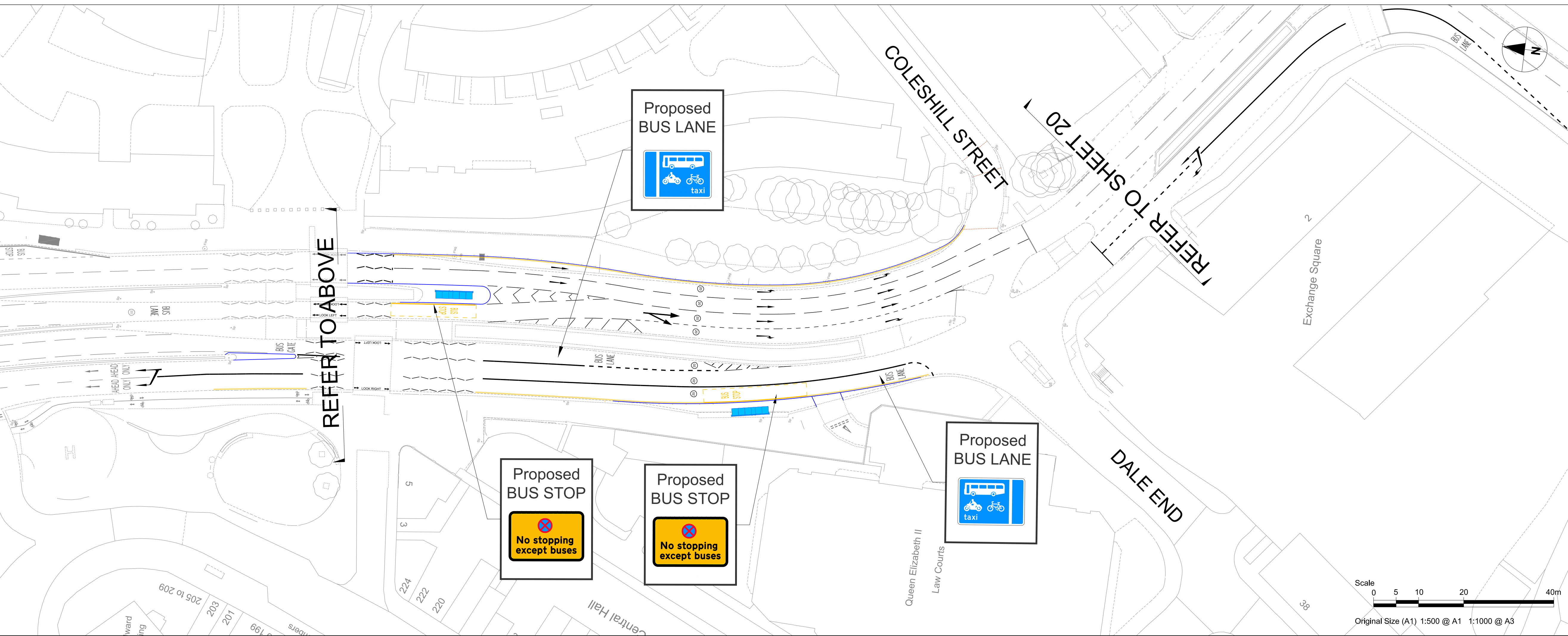

REFER TO ABOVE

REFER TO SHEET 20

UNLESS OTHERWISE STATED EXISTING RESTRICTIONS WILL REMAIN

ISSUE/REVISION

NO	DATE	DESCRIPTION
P01	22/06/20	First Issue
C01	22/06/20	For Advertising
I/R	DATE	DESCRIPTION

ISSUE PURPOSE / SUITABILITY
 FOR ADVERTISING

PROJECT NUMBER
 60599248

SHEET TITLE
 SPRINT A34
 TRO CONSULTATION PLANS
 SHEET 19

SHEET NUMBER
 60599248-ACM-2650-BCC-DR-TR-000019

Last saved by: EVA.TABOADA(2020-02-06) Last Plotter: 2011-05-25
 Filename: C:\pwworking\aecom_us03\uk\vega.garabato@aecom.com\012641460599248-ACM-2650-BCC-DR-TR-000019

This drawing has been prepared for the use of AECOM's client. It may not be used, modified, reproduced or relied upon by third parties, except as agreed by AECOM or as required by law. AECOM accepts no responsibility, and denies any liability, whatsoever, to any party that uses or relies on this drawing without AECOM's express written consent. Do not scale this document. All measurements must be obtained from the stated dimensions.