

KEY

- PROPOSED KERLINE
- BUS LANE - HOURS OF OPERATION 7AM - 7PM
CLASS OF EXEMPT VEHICLE - BUS
LICENSED TAXI
PEDAL CYCLE
MOTOR CYCLE
- BUS LANE - HOURS OF OPERATION 24 HOURS
CLASS OF EXEMPT VEHICLE - BUS
LICENSED TAXI
PEDAL CYCLE
MOTOR CYCLE
- BUS LANE - HOURS OF OPERATION 7AM - 10AM
CLASS OF EXEMPT VEHICLE - BUS
LICENSED TAXI
PEDAL CYCLE
MOTOR CYCLE
- BUS LANE - HOURS OF OPERATION 4PM - 7PM
CLASS OF EXEMPT VEHICLE - BUS
LICENSED TAXI
PEDAL CYCLE
MOTOR CYCLE

NOTE: FINAL BUS LANE LAYOUT SHOWN. DRAWING INCLUDES EXISTING AND PROPOSED BUS LANES

AECOM
 PROJECT
 A34 WALSALL TO
 BIRMINGHAM
 SPRINT BRT
 A3 Scale 1:1250

CLIENT

 Transport for West Midlands
CONSULTANT
 AECOM
 The Colmore Building
 Colmore Circus Queensway
 Birmingham
 T: 01212621900
 www.aecom.com

LOCAL HIGHWAY AUTHORITY

 Birmingham City Council
NOTES
 1. DO NOT SCALE FROM THIS DRAWING
 2. ANY DISCREPANCIES, ERRORS OR OMISSIONS TO BE BROUGHT TO THE ATTENTION OF THE PROJECT MANAGER.

REGISTRATION
 Reproduced from the Ordnance Survey map with the permission of the controller of H.M. Stationery Office. © Crown copyright and database rights 2020. Ordnance Survey 0100031673.
ISSUE PURPOSE
 FOR ADVERTISING
PROJECT NUMBER
 60599248

ISSUE/REVISION

I/R	DATE	DESCRIPTION
P01	30/01/20	First Issue
P02	22/06/20	TRO Amendment
C01	22/06/20	For Advertising

Drawn: EGT	Checked: PE	Approved: SG	Revision: C01
---------------	----------------	-----------------	------------------

SHEET TITLE
 TRAFFIC REGULATION ORDER
 BUS LANE
 SHEET 1
SHEET NUMBER
 60599248-ACM-2600-0000-DR-TR-000001

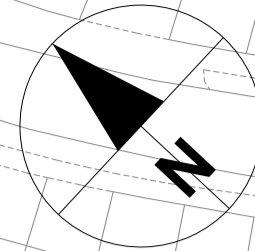
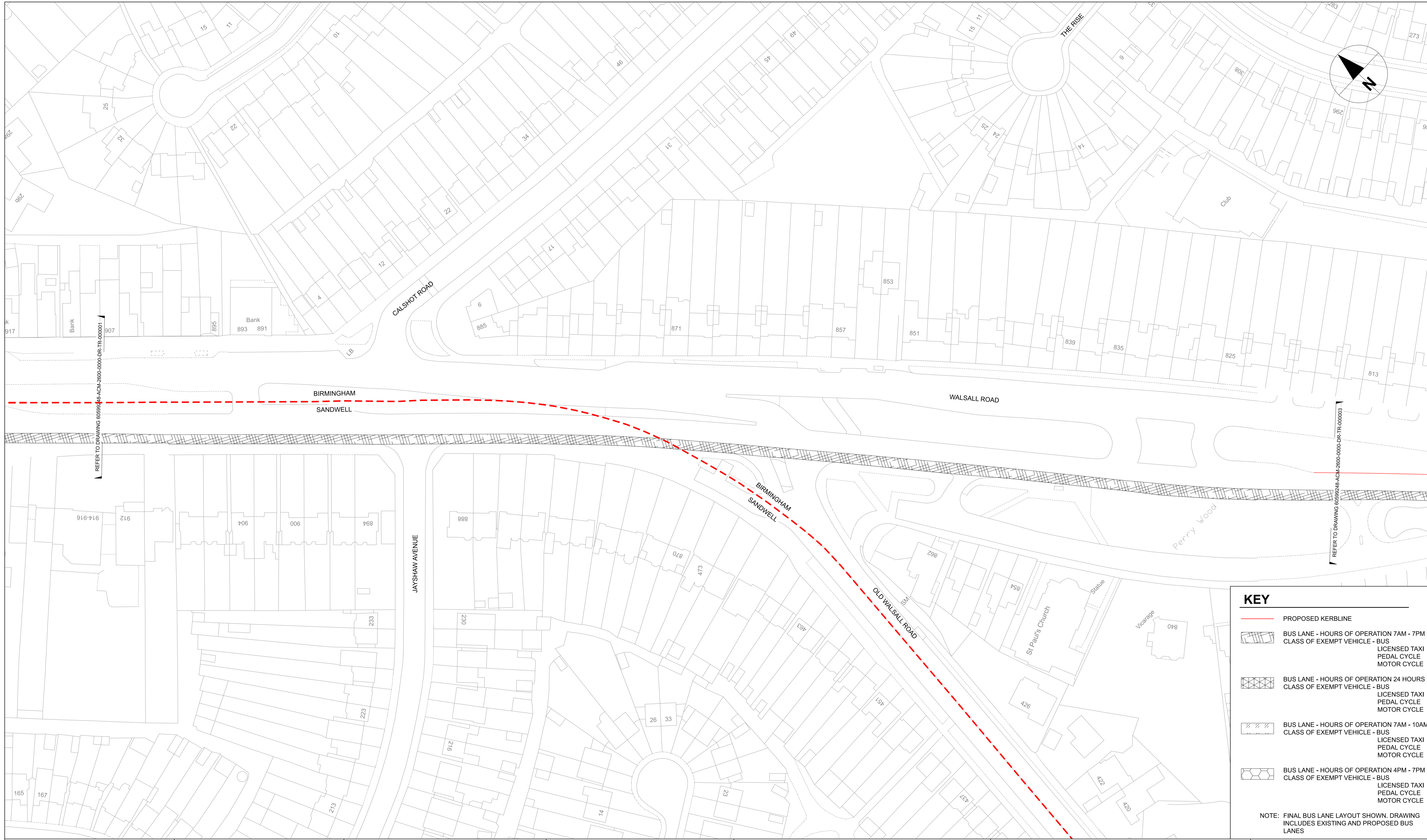

REFER TO DRAWING 60599248-ACM-2600-0000-DR-TR-000001

REFER TO DRAWING 60599248-ACM-2600-0000-DR-TR-000003

KEY	
	PROPOSED KERBLINE
	BUS LANE - HOURS OF OPERATION 7AM - 7PM CLASS OF EXEMPT VEHICLE - BUS LICENSED TAXI PEDAL CYCLE MOTOR CYCLE
	BUS LANE - HOURS OF OPERATION 24 HOURS CLASS OF EXEMPT VEHICLE - BUS LICENSED TAXI PEDAL CYCLE MOTOR CYCLE
	BUS LANE - HOURS OF OPERATION 7AM - 10AM CLASS OF EXEMPT VEHICLE - BUS LICENSED TAXI PEDAL CYCLE MOTOR CYCLE
	BUS LANE - HOURS OF OPERATION 4PM - 7PM CLASS OF EXEMPT VEHICLE - BUS LICENSED TAXI PEDAL CYCLE MOTOR CYCLE

NOTE: FINAL BUS LANE LAYOUT SHOWN. DRAWING INCLUDES EXISTING AND PROPOSED BUS LANES

AECOM
PROJECT
A34 WALSALL TO BIRMINGHAM
SPRINT BRT
A3 Scale 1:1250

CLIENT
Transport for West Midlands
CONSULTANT
AECOM
The Colmore Building
Colmore Circus Queensway
Birmingham
T: 01212621900
www.aecom.com

LOCAL HIGHWAY AUTHORITY
Birmingham City Council
NOTES
1. DO NOT SCALE FROM THIS DRAWING
2. ANY DISCREPANCIES, ERRORS OR OMISSIONS TO BE BROUGHT TO THE ATTENTION OF THE PROJECT MANAGER.

REGISTRATION
Reproduced from the Ordnance Survey map with the permission of the controller of H.M. Stationery Office. © Crown copyright and database rights 2020. Ordnance Survey 0100031673.
ISSUE PURPOSE
FOR ADVERTISING
PROJECT NUMBER
60599248

ISSUE/REVISION

I/R	DATE	DESCRIPTION
P01	30/01/20	First Issue
P02	22/06/20	TRO Amendment
C01	22/06/20	For Advertising

Drawn: EGT	Checked: PE	Approved: SG	Revision: C01
------------	-------------	--------------	---------------

SHEET TITLE
TRAFFIC REGULATION ORDER
BUS LANE
SHEET 2
SHEET NUMBER
60599248-ACM-2600-0000-DR-TR-000002

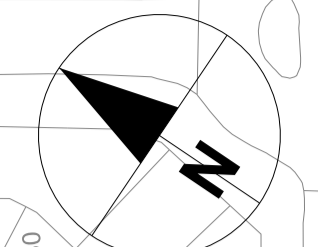

KEY

- PROPOSED KERBLINE
- BUS LANE - HOURS OF OPERATION 7AM - 7PM
CLASS OF EXEMPT VEHICLE - BUS
LICENSED TAXI
PEDAL CYCLE
MOTOR CYCLE
- BUS LANE - HOURS OF OPERATION 24 HOURS
CLASS OF EXEMPT VEHICLE - BUS
LICENSED TAXI
PEDAL CYCLE
MOTOR CYCLE
- BUS LANE - HOURS OF OPERATION 7AM - 10AM
CLASS OF EXEMPT VEHICLE - BUS
LICENSED TAXI
PEDAL CYCLE
MOTOR CYCLE
- BUS LANE - HOURS OF OPERATION 4PM - 7PM
CLASS OF EXEMPT VEHICLE - BUS
LICENSED TAXI
PEDAL CYCLE
MOTOR CYCLE

NOTE: FINAL BUS LANE LAYOUT SHOWN. DRAWING INCLUDES EXISTING AND PROPOSED BUS LANES

AECOM
 PROJECT
 A34 WALSALL TO
 BIRMINGHAM
 SPRINT BRT

A3 Scale 1:1250

CLIENT
 Transport for West Midlands

CONSULTANT
 AECOM
 The Colmore Building
 Colmore Circus Queensway
 Birmingham
 T: 01212621900
 www.aecom.com

LOCAL HIGHWAY AUTHORITY
 Birmingham City Council

NOTES

1. DO NOT SCALE FROM THIS DRAWING
2. ANY DISCREPANCIES, ERRORS OR OMISSIONS TO BE BROUGHT TO THE ATTENTION OF THE PROJECT MANAGER.

REGISTRATION
 Reproduced from the Ordnance Survey map with the permission of the controller of H.M. Stationery Office. © Crown copyright and database rights 2020. Ordnance Survey 0100031673.

ISSUE PURPOSE
 FOR ADVERTISING

PROJECT NUMBER
 60599248

ISSUE/REVISION

I/R	DATE	DESCRIPTION
P01	30/01/20	First Issue
P02	22/06/20	TRO Amendment
C01	22/06/20	For Advertising

Drawn: EGT	Checked: PE	Approved: SG	Revision: C01
---------------	----------------	-----------------	------------------

SHEET TITLE
 TRAFFIC REGULATION ORDER
 BUS LANE
 SHEET 3

SHEET NUMBER
 60599248-ACM-2600-0000-DR-TR-000003

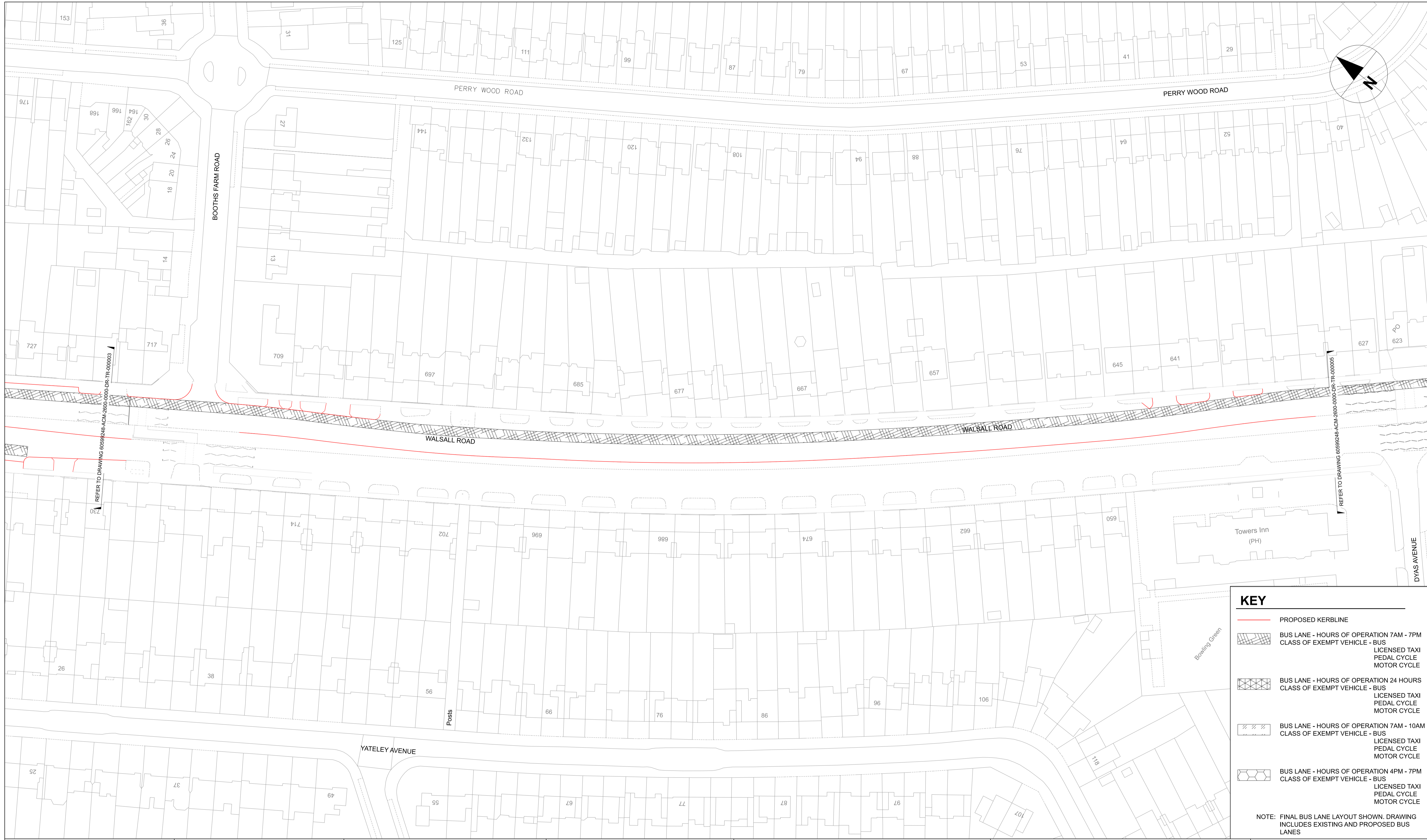

KEY

- PROPOSED KERBLINE
- BUS LANE - HOURS OF OPERATION 7AM - 7PM
CLASS OF EXEMPT VEHICLE - BUS
LICENSED TAXI
PEDAL CYCLE
MOTOR CYCLE
- BUS LANE - HOURS OF OPERATION 24 HOURS
CLASS OF EXEMPT VEHICLE - BUS
LICENSED TAXI
PEDAL CYCLE
MOTOR CYCLE
- BUS LANE - HOURS OF OPERATION 7AM - 10AM
CLASS OF EXEMPT VEHICLE - BUS
LICENSED TAXI
PEDAL CYCLE
MOTOR CYCLE
- BUS LANE - HOURS OF OPERATION 4PM - 7PM
CLASS OF EXEMPT VEHICLE - BUS
LICENSED TAXI
PEDAL CYCLE
MOTOR CYCLE

NOTE: FINAL BUS LANE LAYOUT SHOWN. DRAWING INCLUDES EXISTING AND PROPOSED BUS LANES

AECOM
 PROJECT
 A34 WALSALL TO
 BIRMINGHAM
 SPRINT BRT
 A3 Scale 1:1250

CLIENT

CONSULTANT
 AECOM
 The Colmore Building
 Colmore Circus Queensway
 Birmingham
 T: 01212621900
 www.aecom.com

LOCAL HIGHWAY AUTHORITY

NOTES
 1. DO NOT SCALE FROM THIS DRAWING
 2. ANY DISCREPANCIES, ERRORS OR OMISSIONS TO BE BROUGHT TO THE ATTENTION OF THE PROJECT MANAGER.

REGISTRATION
 Reproduced from the Ordnance Survey map with the permission of the controller of H.M. Stationery Office. © Crown copyright and database rights 2020. Ordnance Survey 0100031673.
ISSUE PURPOSE
 FOR ADVERTISING
PROJECT NUMBER
 60599248

ISSUE/REVISION

I/R	DATE	DESCRIPTION
P01	30/01/20	First Issue
P02	22/06/20	TRO Amendment
C01	22/06/20	For Advertising

Drawn: EGT	Checked: PE	Approved: SG	Revision: C01
---------------	----------------	-----------------	------------------

SHEET TITLE
 TRAFFIC REGULATION ORDER
 BUS LANE
 SHEET 4
SHEET NUMBER
 60599248-ACM-2600-0000-DR-TR-000004



KEY

- PROPOSED KERBLINE
- BUS LANE - HOURS OF OPERATION 7AM - 7PM
CLASS OF EXEMPT VEHICLE - BUS
LICENSED TAXI
PEDAL CYCLE
MOTOR CYCLE
- BUS LANE - HOURS OF OPERATION 24 HOURS
CLASS OF EXEMPT VEHICLE - BUS
LICENSED TAXI
PEDAL CYCLE
MOTOR CYCLE
- BUS LANE - HOURS OF OPERATION 7AM - 10AM
CLASS OF EXEMPT VEHICLE - BUS
LICENSED TAXI
PEDAL CYCLE
MOTOR CYCLE
- BUS LANE - HOURS OF OPERATION 4PM - 7PM
CLASS OF EXEMPT VEHICLE - BUS
LICENSED TAXI
PEDAL CYCLE
MOTOR CYCLE

NOTE: FINAL BUS LANE LAYOUT SHOWN. DRAWING INCLUDES EXISTING AND PROPOSED BUS LANES

Last saved by: EVA.TABOADA(2020-06-22) Last Plotted: 2011-05-25
Filename: C:\pwworking\aecom_d503_uk\eva.garciaaboa@aecom.com\00128414\60599248-ACM-2600-0000-DR-TR-000005

AECOM
PROJECT
A34 WALSALL TO
BIRMINGHAM
SPRINT BRT
A3 Scale 1:1250

CLIENT
 Transport for West Midlands
CONSULTANT
AECOM
The Colmore Building
Colmore Circus Queensway
Birmingham
T: 01212621900
www.aecom.com

LOCAL HIGHWAY AUTHORITY
 Birmingham City Council
NOTES
1. DO NOT SCALE FROM THIS DRAWING
2. ANY DISCREPANCIES, ERRORS OR OMISSIONS TO BE BROUGHT TO THE ATTENTION OF THE PROJECT MANAGER.

REGISTRATION
Reproduced from the Ordnance Survey map with the permission of the controller of H.M. Stationery Office. © Crown copyright and database rights 2020. Ordnance Survey 0100031673.
ISSUE PURPOSE
FOR ADVERTISING
PROJECT NUMBER
60599248

ISSUE/REVISION

I/R	DATE	DESCRIPTION
P01	30/01/20	First Issue
P02	22/06/20	TRO Amendment
C01	22/06/20	For Advertising

Drawn: EGT	Checked: PE	Approved: SG	Revision: C01
---------------	----------------	-----------------	------------------

SHEET TITLE
TRAFFIC REGULATION ORDER
BUS LANE
SHEET 5
SHEET NUMBER
60599248-ACM-2600-0000-DR-TR-000005

This drawing has been prepared for the use of AECOM's client. It may not be used, modified, reproduced or relied upon by third parties, except as agreed by AECOM or as required by law. AECOM accepts no responsibility, and denies any liability whatsoever, to any party that uses or relies on this drawing without AECOM's express written consent. Do not scale this document. All measurements must be obtained from the stated dimensions.

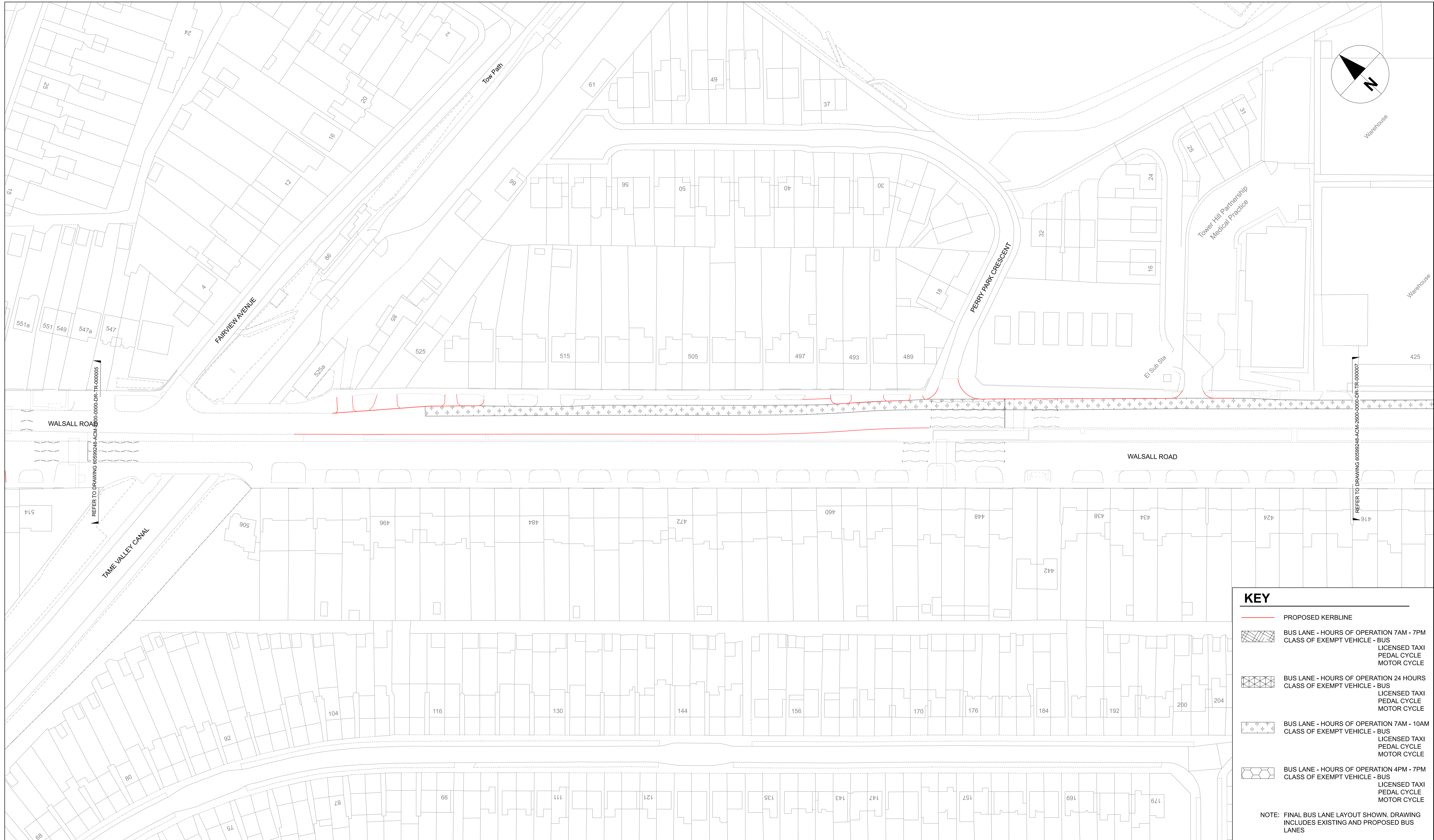

KEY	
	PROPOSED KERBLINE
	BUS LANE - HOURS OF OPERATION 7AM - 7PM CLASS OF EXEMPT VEHICLE - BUS LICENSED TAXI PEDAL CYCLE MOTOR CYCLE
	BUS LANE - HOURS OF OPERATION 24 HOURS CLASS OF EXEMPT VEHICLE - BUS LICENSED TAXI PEDAL CYCLE MOTOR CYCLE
	BUS LANE - HOURS OF OPERATION 7AM - 10AM CLASS OF EXEMPT VEHICLE - BUS LICENSED TAXI PEDAL CYCLE MOTOR CYCLE
	BUS LANE - HOURS OF OPERATION 4PM - 7PM CLASS OF EXEMPT VEHICLE - BUS LICENSED TAXI PEDAL CYCLE MOTOR CYCLE

NOTE: FINAL BUS LANE LAYOUT SHOWN. DRAWING INCLUDES EXISTING AND PROPOSED BUS LANES

AECOM
 PROJECT
 A34 WALSALL TO BIRMINGHAM
 SPRINT BRT
 A3 Scale 1:1250

CLIENT
 Transport for West Midlands
CONSULTANT
 AECOM
 The Colmore Building
 Colmore Circus Queensway
 Birmingham
 T: 01212621900
 www.aecom.com

LOCAL HIGHWAY AUTHORITY

NOTES
 1. DO NOT SCALE FROM THIS DRAWING
 2. ANY DISCREPANCIES, ERRORS OR OMISSIONS TO BE BROUGHT TO THE ATTENTION OF THE PROJECT MANAGER.

REGISTRATION
 Reproduced from the Ordnance Survey map with the permission of the controller of H.M. Stationery Office. © Crown copyright and database rights 2020. Ordnance Survey 0100031673.
ISSUE PURPOSE
 FOR ADVERTISING
PROJECT NUMBER
 60599248

ISSUE/REVISION

I/R	DATE	DESCRIPTION
P01	30/01/20	First Issue
P02	22/06/20	TRO Amendment
C01	22/06/20	For Advertising

Drawn: EGT	Checked: PE	Approved: SG	Revision: C01
---------------	----------------	-----------------	------------------

SHEET TITLE
 TRAFFIC REGULATION ORDER
 BUS LANE
 SHEET 6
SHEET NUMBER
 60599248-ACM-2600-0000-DR-TR-000006



KEY

- PROPOSED KERBLINE
- BUS LANE - HOURS OF OPERATION 7AM - 7PM
CLASS OF EXEMPT VEHICLE - BUS
LICENSED TAXI
PEDAL CYCLE
MOTOR CYCLE
- BUS LANE - HOURS OF OPERATION 24 HOURS
CLASS OF EXEMPT VEHICLE - BUS
LICENSED TAXI
PEDAL CYCLE
MOTOR CYCLE
- BUS LANE - HOURS OF OPERATION 7AM - 10AM
CLASS OF EXEMPT VEHICLE - BUS
LICENSED TAXI
PEDAL CYCLE
MOTOR CYCLE
- BUS LANE - HOURS OF OPERATION 4PM - 7PM
CLASS OF EXEMPT VEHICLE - BUS
LICENSED TAXI
PEDAL CYCLE
MOTOR CYCLE

NOTE: FINAL BUS LANE LAYOUT SHOWN. DRAWING INCLUDES EXISTING AND PROPOSED BUS LANES



PROJECT
 A34 WALSALL TO
 BIRMINGHAM
 SPRINT BRT

A3 Scale 1:1250

CLIENT



CONSULTANT

AECOM
 The Colmore Building
 Colmore Circus Queensway
 Birmingham
 T: 01212621900
 www.aecom.com

LOCAL HIGHWAY AUTHORITY



NOTES

1. DO NOT SCALE FROM THIS DRAWING
2. ANY DISCREPANCIES, ERRORS OR OMISSIONS TO BE BROUGHT TO THE ATTENTION OF THE PROJECT MANAGER.

REGISTRATION

Reproduced from the Ordnance Survey map with the permission of the controller of H.M. Stationery Office. © Crown copyright and database rights 2020. Ordnance Survey 0100031673.

ISSUE PURPOSE

FOR ADVERTISING

PROJECT NUMBER

60599248

ISSUE/REVISION

I/R	DATE	DESCRIPTION
P01	30/01/20	First Issue
P02	22/06/20	TRO Amendment
C01	22/06/20	For Advertising

Drawn: EGT	Checked: PE	Approved: SG	Revision: C01
---------------	----------------	-----------------	------------------

SHEET TITLE





TRAFFIC REGULATION ORDER
 BUS LANE
 SHEET 7

SHEET NUMBER

60599248-ACM-2600-0000-DR-TR-000007

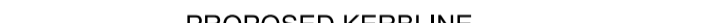
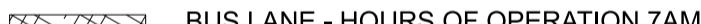

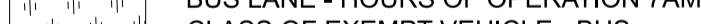
KEY

-  PROPOSED KERBLINE
-  BUS LANE - HOURS OF OPERATION 7AM - 7PM
CLASS OF EXEMPT VEHICLE - BUS
LICENSED TAXI
PEDAL CYCLE
MOTOR CYCLE
-  BUS LANE - HOURS OF OPERATION 24 HOURS
CLASS OF EXEMPT VEHICLE - BUS
LICENSED TAXI
PEDAL CYCLE
MOTOR CYCLE
-  BUS LANE - HOURS OF OPERATION 7AM - 10AM
CLASS OF EXEMPT VEHICLE - BUS
LICENSED TAXI
PEDAL CYCLE
MOTOR CYCLE
-  BUS LANE - HOURS OF OPERATION 4PM - 7PM
CLASS OF EXEMPT VEHICLE - BUS
LICENSED TAXI
PEDAL CYCLE
MOTOR CYCLE

NOTE: FINAL BUS LANE LAYOUT SHOWN. DRAWING INCLUDES EXISTING AND PROPOSED BUS LANES

AECOM
PROJECT
 A34 WALSALL TO BIRMINGHAM
 SPRINT BRT
A3 Scale 1:1250

CLIENT
 Transport for West Midlands
CONSULTANT
 AECOM
 The Colmore Building
 Colmore Circus Queensway
 Birmingham
 T: 01212621900
 www.aecom.com

LOCAL HIGHWAY AUTHORITY
 Birmingham City Council
NOTES
 1. DO NOT SCALE FROM THIS DRAWING
 2. ANY DISCREPANCIES, ERRORS OR OMISSIONS TO BE BROUGHT TO THE ATTENTION OF THE PROJECT MANAGER.

REGISTRATION
 Reproduced from the Ordnance Survey map with the permission of the controller of H.M. Stationery Office. © Crown copyright and database rights 2020. Ordnance Survey 0100031673.
ISSUE PURPOSE
 FOR ADVERTISING
PROJECT NUMBER
 60599248

ISSUE/REVISION

I/R	DATE	DESCRIPTION
P01	30/01/20	First Issue
P02	22/06/20	TRO Amendment
C01	22/06/20	For Advertising

Drawn:	Checked:	Approved:	Revision:
EGT	PE	SG	C01

SHEET TITLE
 TRAFFIC REGULATION ORDER
 BUS LANE
 SHEET 8
SHEET NUMBER
 60599248-ACM-2600-0000-DR-TR-000008



KEY

	PROPOSED KERBLINE
	BUS LANE - HOURS OF OPERATION 7AM - 7PM CLASS OF EXEMPT VEHICLE - BUS LICENSED TAXI PEDAL CYCLE MOTOR CYCLE
	BUS LANE - HOURS OF OPERATION 24 HOURS CLASS OF EXEMPT VEHICLE - BUS LICENSED TAXI PEDAL CYCLE MOTOR CYCLE
	BUS LANE - HOURS OF OPERATION 7AM - 10AM CLASS OF EXEMPT VEHICLE - BUS LICENSED TAXI PEDAL CYCLE MOTOR CYCLE
	BUS LANE - HOURS OF OPERATION 4PM - 7PM CLASS OF EXEMPT VEHICLE - BUS LICENSED TAXI PEDAL CYCLE MOTOR CYCLE

NOTE: FINAL BUS LANE LAYOUT SHOWN. DRAWING INCLUDES EXISTING AND PROPOSED BUS LANES

AECOM
PROJECT
A34 WALSALL TO BIRMINGHAM
SPRINT BRT
A3 Scale 1:1250

CLIENT
 Transport for West Midlands
CONSULTANT
AECOM
The Colmore Building
Colmore Circus Queensway
Birmingham
T: 01212621900
www.aecom.com

LOCAL HIGHWAY AUTHORITY
 Birmingham City Council
NOTES
1. DO NOT SCALE FROM THIS DRAWING
2. ANY DISCREPANCIES, ERRORS OR OMISSIONS TO BE BROUGHT TO THE ATTENTION OF THE PROJECT MANAGER.

REGISTRATION
Reproduced from the Ordnance Survey map with the permission of the controller of H.M. Stationery Office. © Crown copyright and database rights 2020. Ordnance Survey 0100031673.
ISSUE PURPOSE
FOR ADVERTISING
PROJECT NUMBER
60599248

ISSUE/REVISION

I/R	DATE	DESCRIPTION
P01	30/01/20	First Issue
P02	22/06/20	TRO Amendment
C01	22/06/20	For Advertising

Drawn: EGT	Checked: PE	Approved: SG	Revision: C01
---------------	----------------	-----------------	------------------

SHEET TITLE
TRAFFIC REGULATION ORDER
BUS LANE
SHEET 9
SHEET NUMBER
60599248-ACM-2600-0000-DR-TR-000009

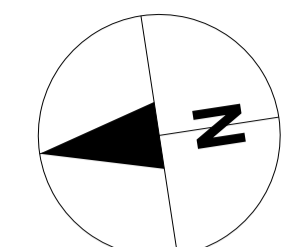

REFER TO DRAWING 60599248-ACM-2600-0000-DR-TR-000011

KEY

- PROPOSED KERBLINE
- BUS LANE - HOURS OF OPERATION 7AM - 7PM
CLASS OF EXEMPT VEHICLE - BUS
LICENSED TAXI
PEDAL CYCLE
MOTOR CYCLE
- BUS LANE - HOURS OF OPERATION 24 HOURS
CLASS OF EXEMPT VEHICLE - BUS
LICENSED TAXI
PEDAL CYCLE
MOTOR CYCLE
- BUS LANE - HOURS OF OPERATION 7AM - 10AM
CLASS OF EXEMPT VEHICLE - BUS
LICENSED TAXI
PEDAL CYCLE
MOTOR CYCLE
- BUS LANE - HOURS OF OPERATION 4PM - 7PM
CLASS OF EXEMPT VEHICLE - BUS
LICENSED TAXI
PEDAL CYCLE
MOTOR CYCLE

NOTE: FINAL BUS LANE LAYOUT SHOWN. DRAWING INCLUDES EXISTING AND PROPOSED BUS LANES

AECOM
 PROJECT
 A34 WALSALL TO BIRMINGHAM
 SPRINT BRT
 A3 Scale 1:1250

CLIENT
 Transport for West Midlands
CONSULTANT
 AECOM
 The Colmore Building
 Colmore Circus Queensway
 Birmingham
 T: 01212621900
 www.aecom.com

LOCAL HIGHWAY AUTHORITY

NOTES
 1. DO NOT SCALE FROM THIS DRAWING
 2. ANY DISCREPANCIES, ERRORS OR OMISSIONS TO BE BROUGHT TO THE ATTENTION OF THE PROJECT MANAGER.

REGISTRATION
 Reproduced from the Ordnance Survey map with the permission of the controller of H.M. Stationery Office. © Crown copyright and database rights 2020. Ordnance Survey 0100031673.
ISSUE PURPOSE
 FOR ADVERTISING
PROJECT NUMBER
 60599248

ISSUE/REVISION

I/R	DATE	DESCRIPTION
P01	30/01/20	First Issue
P02	22/06/20	TRO Amendment
C01	22/06/20	For Advertising

Drawn: EGT	Checked: PE	Approved: SG	Revision: C01
---------------	----------------	-----------------	------------------

SHEET TITLE
 TRAFFIC REGULATION ORDER
 BUS LANE
 SHEET 10
SHEET NUMBER
 60599248-ACM-2600-0000-DR-TR-000010



KEY

- PROPOSED KERBLINE
- BUS LANE - HOURS OF OPERATION 7AM - 7PM
CLASS OF EXEMPT VEHICLE - BUS
LICENSED TAXI
PEDAL CYCLE
MOTOR CYCLE
- BUS LANE - HOURS OF OPERATION 24 HOURS
CLASS OF EXEMPT VEHICLE - BUS
LICENSED TAXI
PEDAL CYCLE
MOTOR CYCLE
- BUS LANE - HOURS OF OPERATION 7AM - 10AM
CLASS OF EXEMPT VEHICLE - BUS
LICENSED TAXI
PEDAL CYCLE
MOTOR CYCLE
- BUS LANE - HOURS OF OPERATION 4PM - 7PM
CLASS OF EXEMPT VEHICLE - BUS
LICENSED TAXI
PEDAL CYCLE
MOTOR CYCLE

NOTE: FINAL BUS LANE LAYOUT SHOWN. DRAWING INCLUDES EXISTING AND PROPOSED BUS LANES

AECOM
 PROJECT
 A34 WALSALL TO
 BIRMINGHAM
 SPRINT BRT
 A3 Scale 1:1250

CLIENT

CONSULTANT
 AECOM
 The Colmore Building
 Colmore Circus Queensway
 Birmingham
 T: 01212621900
 www.aecom.com

LOCAL HIGHWAY AUTHORITY

NOTES
 1. DO NOT SCALE FROM THIS DRAWING
 2. ANY DISCREPANCIES, ERRORS OR OMISSIONS TO BE BROUGHT TO THE ATTENTION OF THE PROJECT MANAGER.

REGISTRATION
 Reproduced from the Ordnance Survey map with the permission of the controller of H.M. Stationery Office. © Crown copyright and database rights 2020. Ordnance Survey 0100031673.
ISSUE PURPOSE
 FOR ADVERTISING
PROJECT NUMBER
 60599248

ISSUE/REVISION

I/R	DATE	DESCRIPTION
P01	31/01/20	First Issue
P02	22/06/20	TRO Amendment
C01	22/06/20	For Advertising

Drawn: EGT	Checked: PE	Approved: SG	Revision: C01
---------------	----------------	-----------------	------------------

SHEET TITLE
 TRAFFIC REGULATION ORDER
 BUS LANE
 SHEET 11
SHEET NUMBER
 60599248-ACM-2600-0000-DR-TR-000011

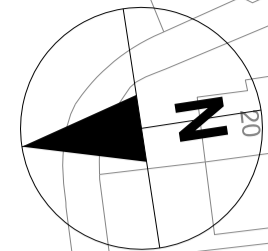

KEY	
	PROPOSED KERBLINE
	BUS LANE - HOURS OF OPERATION 7AM - 7PM CLASS OF EXEMPT VEHICLE - BUS LICENSED TAXI PEDAL CYCLE MOTOR CYCLE
	BUS LANE - HOURS OF OPERATION 24 HOURS CLASS OF EXEMPT VEHICLE - BUS LICENSED TAXI PEDAL CYCLE MOTOR CYCLE
	BUS LANE - HOURS OF OPERATION 7AM - 10AM CLASS OF EXEMPT VEHICLE - BUS LICENSED TAXI PEDAL CYCLE MOTOR CYCLE
	BUS LANE - HOURS OF OPERATION 4PM - 7PM CLASS OF EXEMPT VEHICLE - BUS LICENSED TAXI PEDAL CYCLE MOTOR CYCLE
	EXISTING BUS LANE REMOVED

NOTE: FINAL BUS LANE LAYOUT SHOWN. DRAWING INCLUDES EXISTING AND PROPOSED BUS LANES

AECOM
 PROJECT
 A34 WALSALL TO BIRMINGHAM
 SPRINT BRT
 A3 Scale 1:1250

CLIENT
 Transport for West Midlands

CONSULTANT
 AECOM
 The Colmore Building
 Colmore Circus Queensway
 Birmingham
 T: 01212621900
 www.aecom.com

LOCAL HIGHWAY AUTHORITY

NOTES
 1. DO NOT SCALE FROM THIS DRAWING
 2. ANY DISCREPANCIES, ERRORS OR OMISSIONS TO BE BROUGHT TO THE ATTENTION OF THE PROJECT MANAGER.

REGISTRATION
 Reproduced from the Ordnance Survey map with the permission of the controller of H.M. Stationery Office. © Crown copyright and database rights 2020. Ordnance Survey 0100031673.

ISSUE PURPOSE
 FOR ADVERTISING

PROJECT NUMBER
 60599248

ISSUE/REVISION

I/R	DATE	DESCRIPTION
P01	31/01/20	First Issue
P02	22/06/20	TRO Amendment
C01	22/06/20	For Advertising

Drawn: EGT	Checked: PE	Approved: SG	Revision: C01
---------------	----------------	-----------------	------------------

SHEET TITLE
 TRAFFIC REGULATION ORDER
 BUS LANE
 SHEET 12

SHEET NUMBER
 60599248-ACM-2600-0000-DR-TR-000012

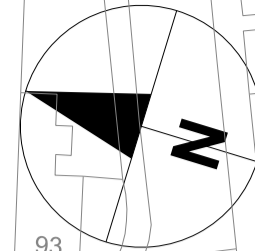

KEY	
	PROPOSED KERPLINE
	BUS LANE - HOURS OF OPERATION 7AM - 7PM CLASS OF EXEMPT VEHICLE - BUS LICENSED TAXI PEDAL CYCLE MOTOR CYCLE
	BUS LANE - HOURS OF OPERATION 24 HOURS CLASS OF EXEMPT VEHICLE - BUS LICENSED TAXI PEDAL CYCLE MOTOR CYCLE
	BUS LANE - HOURS OF OPERATION 7AM - 10AM CLASS OF EXEMPT VEHICLE - BUS LICENSED TAXI PEDAL CYCLE MOTOR CYCLE
	BUS LANE - HOURS OF OPERATION 4PM - 7PM CLASS OF EXEMPT VEHICLE - BUS LICENSED TAXI PEDAL CYCLE MOTOR CYCLE
	EXISTING BUS LANE REMOVED

NOTE: FINAL BUS LANE LAYOUT SHOWN, DRAWING INCLUDES EXISTING AND PROPOSED BUS LANES

AECOM
 PROJECT
 A34 WALSALL TO
 BIRMINGHAM
 SPRINT BRT
 A3 Scale 1:1250

CLIENT

CONSULTANT
 AECOM
 The Colmore Building
 Colmore Circus Queensway
 Birmingham
 T: 01212621900
 www.aecom.com

LOCAL HIGHWAY AUTHORITY

NOTES
 1. DO NOT SCALE FROM THIS DRAWING
 2. ANY DISCREPANCIES, ERRORS OR OMISSIONS TO BE BROUGHT TO THE ATTENTION OF THE PROJECT MANAGER.

REGISTRATION
 Reproduced from the Ordnance Survey map with the permission of the controller of H.M. Stationery Office. © Crown copyright and database rights 2020. Ordnance Survey 0100031673.
ISSUE PURPOSE
 FOR ADVERTISING
PROJECT NUMBER
 60599248

ISSUE/REVISION

I/R	DATE	DESCRIPTION
P01	31/01/20	First Issue
P02	22/06/20	TRO Amendment
C01	22/06/20	For Advertising

Drawn: EGT	Checked: PE	Approved: SG	Revision: C01
---------------	----------------	-----------------	------------------

SHEET TITLE
 TRAFFIC REGULATION ORDER
 BUS LANE
 SHEET 13
SHEET NUMBER
 60599248-ACM-2600-0000-DR-TR-000013

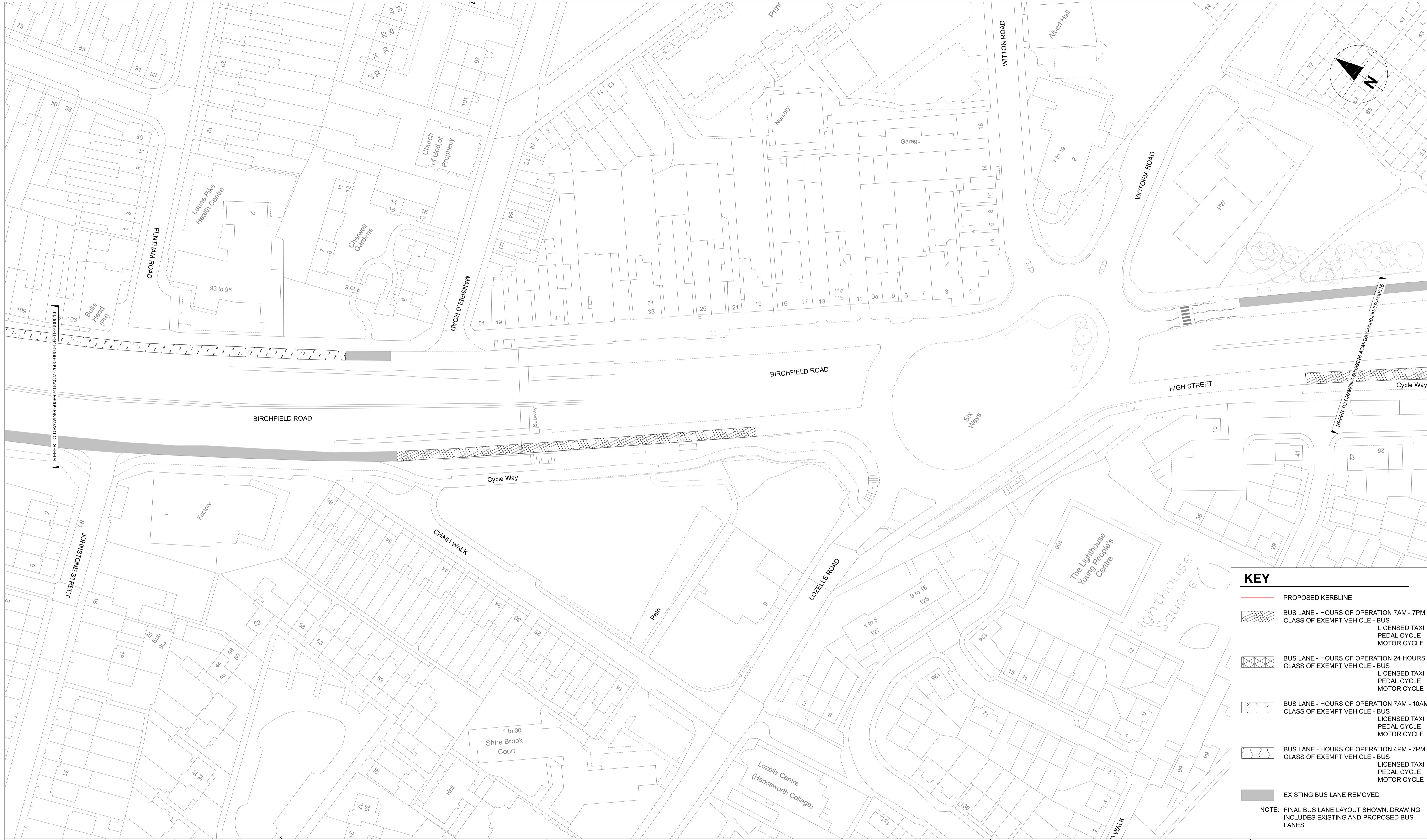

KEY	
	PROPOSED KERBLINE
	BUS LANE - HOURS OF OPERATION 7AM - 7PM CLASS OF EXEMPT VEHICLE - BUS LICENSED TAXI PEDAL CYCLE MOTOR CYCLE
	BUS LANE - HOURS OF OPERATION 24 HOURS CLASS OF EXEMPT VEHICLE - BUS LICENSED TAXI PEDAL CYCLE MOTOR CYCLE
	BUS LANE - HOURS OF OPERATION 7AM - 10AM CLASS OF EXEMPT VEHICLE - BUS LICENSED TAXI PEDAL CYCLE MOTOR CYCLE
	BUS LANE - HOURS OF OPERATION 4PM - 7PM CLASS OF EXEMPT VEHICLE - BUS LICENSED TAXI PEDAL CYCLE MOTOR CYCLE
	EXISTING BUS LANE REMOVED

NOTE: FINAL BUS LANE LAYOUT SHOWN. DRAWING INCLUDES EXISTING AND PROPOSED BUS LANES

AECOM
 PROJECT
 A34 WALSALL TO
 BIRMINGHAM
 SPRINT BRT
 A3 Scale 1:1250

CLIENT

 Transport for West Midlands
CONSULTANT
 AECOM
 The Colmore Building
 Colmore Circus Queensway
 Birmingham
 T: 01212621900
 www.aecom.com

LOCAL HIGHWAY AUTHORITY

 Birmingham City Council
NOTES
 1. DO NOT SCALE FROM THIS DRAWING
 2. ANY DISCREPANCIES, ERRORS OR OMISSIONS TO BE BROUGHT TO THE ATTENTION OF THE PROJECT MANAGER.

REGISTRATION
 Reproduced from the Ordnance Survey map with the permission of the controller of H.M. Stationery Office. © Crown copyright and database rights 2020. Ordnance Survey 0100031673.
ISSUE PURPOSE
 FOR ADVERTISING
PROJECT NUMBER
 60599248

ISSUE/REVISION

I/R	DATE	DESCRIPTION
P01	31/01/20	First Issue
P02	22/06/20	TRO Amendment
C01	22/06/20	For Advertising

Drawn: EGT	Checked: PE	Approved: SG	Revision: C01
---------------	----------------	-----------------	------------------

SHEET TITLE
 TRAFFIC REGULATION ORDER
 BUS LANE
 SHEET 14
SHEET NUMBER
 60599248-ACM-2600-0000-DR-TR-000014

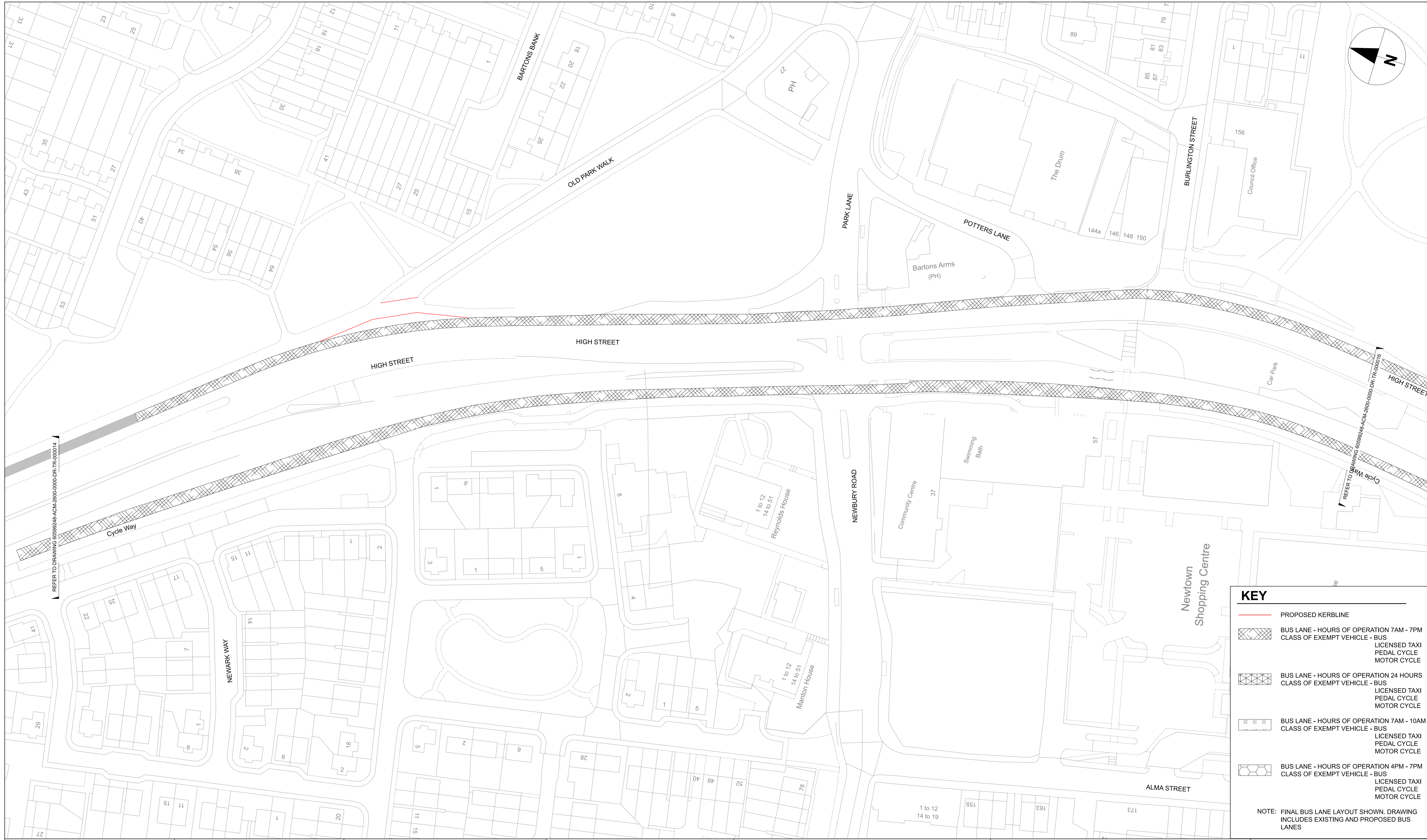

KEY

- PROPOSED KERPLINE
- BUS LANE - HOURS OF OPERATION 7AM - 7PM
CLASS OF EXEMPT VEHICLE - BUS
LICENSED TAXI
PEDAL CYCLE
MOTOR CYCLE
- BUS LANE - HOURS OF OPERATION 24 HOURS
CLASS OF EXEMPT VEHICLE - BUS
LICENSED TAXI
PEDAL CYCLE
MOTOR CYCLE
- BUS LANE - HOURS OF OPERATION 7AM - 10AM
CLASS OF EXEMPT VEHICLE - BUS
LICENSED TAXI
PEDAL CYCLE
MOTOR CYCLE
- BUS LANE - HOURS OF OPERATION 4PM - 7PM
CLASS OF EXEMPT VEHICLE - BUS
LICENSED TAXI
PEDAL CYCLE
MOTOR CYCLE

NOTE: FINAL BUS LANE LAYOUT SHOWN. DRAWING INCLUDES EXISTING AND PROPOSED BUS LANES

AECOM
 PROJECT
 A34 WALSALL TO
 BIRMINGHAM
 SPRINT BRT
 A3 Scale 1:1250

CLIENT

 Transport for West Midlands
CONSULTANT
 AECOM
 The Colmore Building
 Colmore Circus Queensway
 Birmingham
 T: 01212621900
 www.aecom.com

LOCAL HIGHWAY AUTHORITY

 Birmingham City Council
NOTES
 1. DO NOT SCALE FROM THIS DRAWING
 2. ANY DISCREPANCIES, ERRORS OR OMISSIONS TO BE BROUGHT TO THE ATTENTION OF THE PROJECT MANAGER.

REGISTRATION
 Reproduced from the Ordnance Survey map with the permission of the controller of H.M. Stationery Office. © Crown copyright and database rights 2020. Ordnance Survey 0100031673.
ISSUE PURPOSE
 FOR ADVERTISING
PROJECT NUMBER
 60599248

ISSUE/REVISION

I/R	DATE	DESCRIPTION
P01	31/01/20	First Issue
P01	26/02/20	First Issue
P02	22/06/20	TRO Amendment
C01	22/06/20	For Advertising

Drawn: EGT	Checked: PE	Approved: SG	Revision: C01
---------------	----------------	-----------------	------------------

SHEET TITLE
 TRAFFIC REGULATION ORDER
 BUS LANE
 SHEET 15
SHEET NUMBER
 60599248-ACM-2600-0000-DR-TR-000015



KEY

- PROPOSED KERBLINE
- BUS LANE - HOURS OF OPERATION 7AM - 7PM
CLASS OF EXEMPT VEHICLE - BUS
LICENSED TAXI
PEDAL CYCLE
MOTOR CYCLE
- BUS LANE - HOURS OF OPERATION 24 HOURS
CLASS OF EXEMPT VEHICLE - BUS
LICENSED TAXI
PEDAL CYCLE
MOTOR CYCLE
- BUS LANE - HOURS OF OPERATION 7AM - 10AM
CLASS OF EXEMPT VEHICLE - BUS
LICENSED TAXI
PEDAL CYCLE
MOTOR CYCLE
- BUS LANE - HOURS OF OPERATION 4PM - 7PM
CLASS OF EXEMPT VEHICLE - BUS
LICENSED TAXI
PEDAL CYCLE
MOTOR CYCLE

NOTE: FINAL BUS LANE LAYOUT SHOWN. DRAWING INCLUDES EXISTING AND PROPOSED BUS LANES

AECOM
 PROJECT
 A34 WALSALL TO
 BIRMINGHAM
 SPRINT BRT
 A3 Scale 1:1250

CLIENT

CONSULTANT
 AECOM
 The Colmore Building
 Colmore Circus Queensway
 Birmingham
 T: 01212621900
 www.aecom.com

LOCAL HIGHWAY AUTHORITY

NOTES
 1. DO NOT SCALE FROM THIS DRAWING
 2. ANY DISCREPANCIES, ERRORS OR OMISSIONS TO BE BROUGHT TO THE ATTENTION OF THE PROJECT MANAGER.

REGISTRATION
 Reproduced from the Ordnance Survey map with the permission of the controller of H.M. Stationery Office. © Crown copyright and database rights 2020. Ordnance Survey 0100031673.
ISSUE PURPOSE
 FOR ADVERTISING
PROJECT NUMBER
 60599248

ISSUE/REVISION

I/R	DATE	DESCRIPTION
P01	31/01/20	First Issue
P02	22/06/20	TRO Amendment
C01	22/06/20	For Advertising

Drawn: EGT	Checked: PE	Approved: SG	Revision: C01
---------------	----------------	-----------------	------------------

SHEET TITLE
 TRAFFIC REGULATION ORDER
 BUS LANE
 SHEET 16
SHEET NUMBER
 60599248-ACM-2600-0000-DR-TR-000016

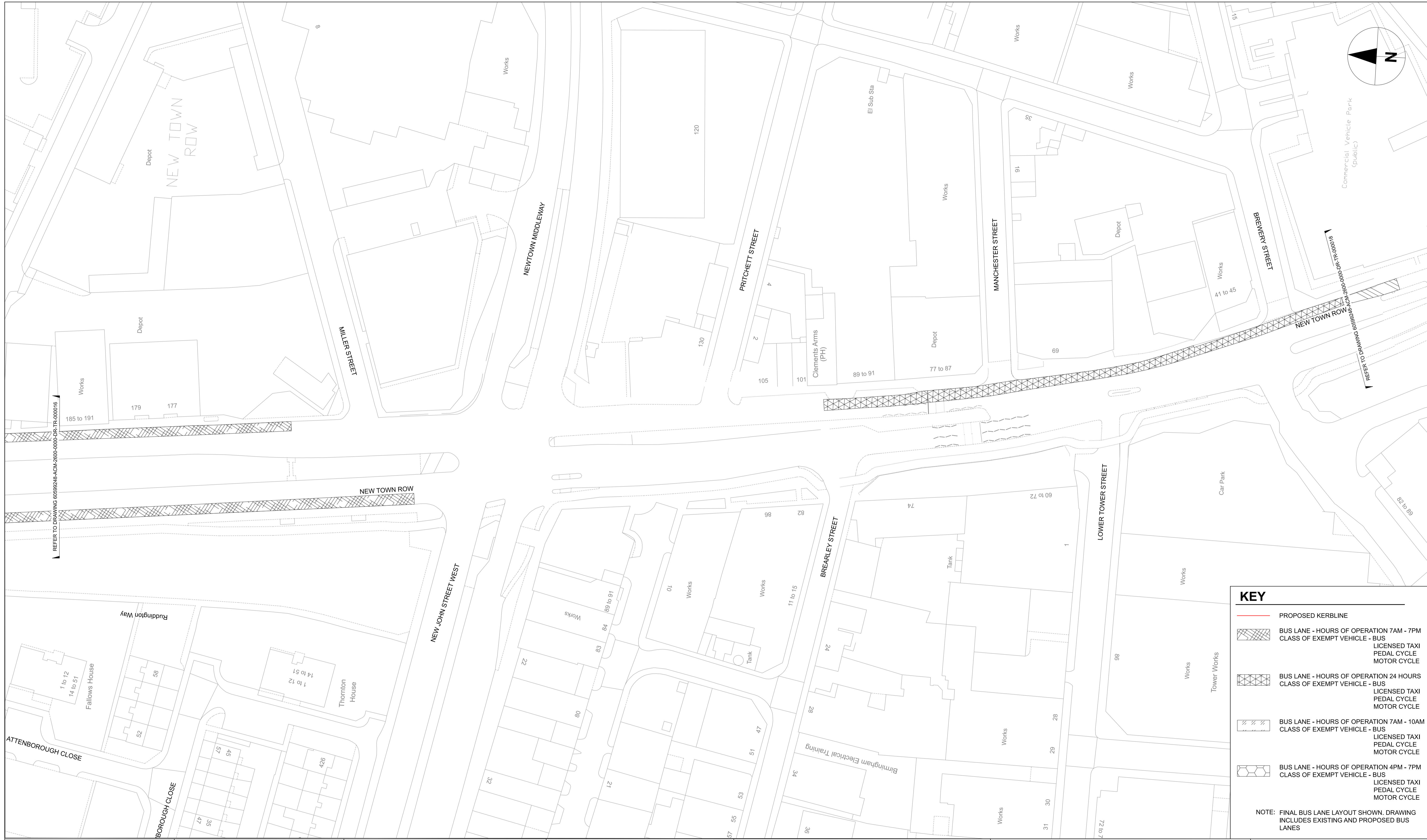

KEY

- PROPOSED KERBLINE
- BUS LANE - HOURS OF OPERATION 7AM - 7PM
CLASS OF EXEMPT VEHICLE - BUS
LICENSED TAXI
PEDAL CYCLE
MOTOR CYCLE
- BUS LANE - HOURS OF OPERATION 24 HOURS
CLASS OF EXEMPT VEHICLE - BUS
LICENSED TAXI
PEDAL CYCLE
MOTOR CYCLE
- BUS LANE - HOURS OF OPERATION 7AM - 10AM
CLASS OF EXEMPT VEHICLE - BUS
LICENSED TAXI
PEDAL CYCLE
MOTOR CYCLE
- BUS LANE - HOURS OF OPERATION 4PM - 7PM
CLASS OF EXEMPT VEHICLE - BUS
LICENSED TAXI
PEDAL CYCLE
MOTOR CYCLE

NOTE: FINAL BUS LANE LAYOUT SHOWN. DRAWING INCLUDES EXISTING AND PROPOSED BUS LANES

AECOM
 PROJECT
 A34 WALSALL TO BIRMINGHAM
 SPRINT BRT
 A3 Scale 1:1250

CLIENT
 Transport for West Midlands
CONSULTANT
 AECOM
 The Colmore Building
 Colmore Circus Queensway
 Birmingham
 T: 01212621900
 www.aecom.com

LOCAL HIGHWAY AUTHORITY

NOTES
 1. DO NOT SCALE FROM THIS DRAWING
 2. ANY DISCREPANCIES, ERRORS OR OMISSIONS TO BE BROUGHT TO THE ATTENTION OF THE PROJECT MANAGER.

REGISTRATION
 Reproduced from the Ordnance Survey map with the permission of the controller of H.M. Stationery Office. © Crown copyright and database rights 2020. Ordnance Survey 0100031673.
ISSUE PURPOSE
 FOR ADVERTISING
PROJECT NUMBER
 60599248

ISSUE/REVISION

I/R	DATE	DESCRIPTION
P01	31/01/20	First Issue
P02	22/06/20	TRO Amendment
C01	22/06/20	For Advertising

Drawn: EGT	Checked: PE	Approved: SG	Revision: C01
---------------	----------------	-----------------	------------------

SHEET TITLE
 TRAFFIC REGULATION ORDER
 BUS LANE
 SHEET 17
SHEET NUMBER
 60599248-ACM-2600-0000-DR-TR-000017

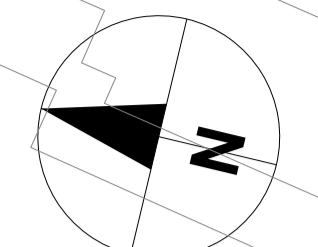
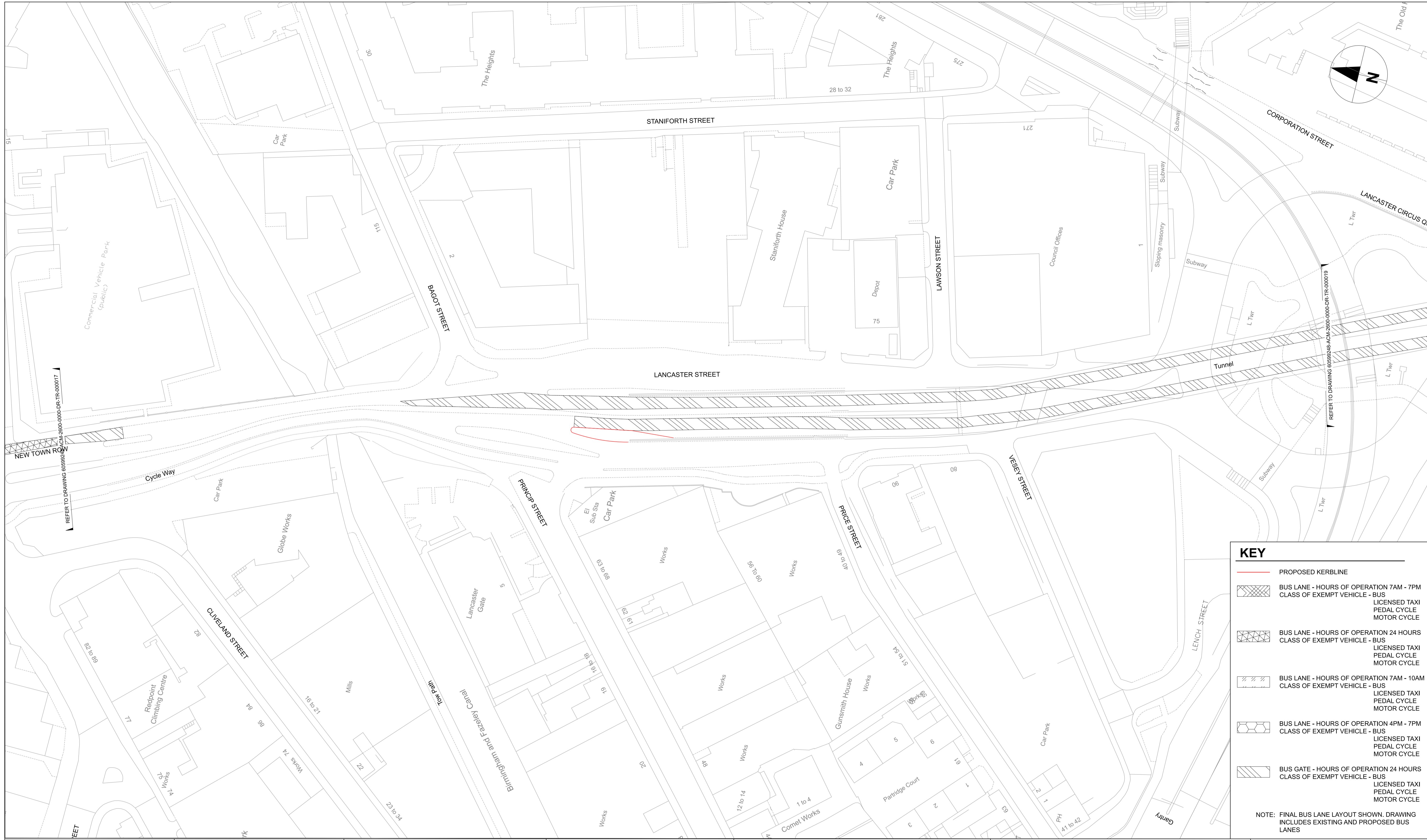

KEY

- PROPOSED KERBLINE
- BUS LANE - HOURS OF OPERATION 7AM - 7PM
CLASS OF EXEMPT VEHICLE - BUS
LICENSED TAXI
PEDAL CYCLE
MOTOR CYCLE
- BUS LANE - HOURS OF OPERATION 24 HOURS
CLASS OF EXEMPT VEHICLE - BUS
LICENSED TAXI
PEDAL CYCLE
MOTOR CYCLE
- BUS LANE - HOURS OF OPERATION 7AM - 10AM
CLASS OF EXEMPT VEHICLE - BUS
LICENSED TAXI
PEDAL CYCLE
MOTOR CYCLE
- BUS LANE - HOURS OF OPERATION 4PM - 7PM
CLASS OF EXEMPT VEHICLE - BUS
LICENSED TAXI
PEDAL CYCLE
MOTOR CYCLE
- BUS GATE - HOURS OF OPERATION 24 HOURS
CLASS OF EXEMPT VEHICLE - BUS
LICENSED TAXI
PEDAL CYCLE
MOTOR CYCLE

NOTE: FINAL BUS LANE LAYOUT SHOWN. DRAWING INCLUDES EXISTING AND PROPOSED BUS LANES

AECOM
 PROJECT
 A34 WALSALL TO
 BIRMINGHAM
 SPRINT BRT
 A3 Scale 1:1250

CLIENT
 Transport for West Midlands
CONSULTANT
 AECOM
 The Colmore Building
 Colmore Circus Queensway
 Birmingham
 T: 01212621900
 www.aecom.com

LOCAL HIGHWAY AUTHORITY
 Birmingham City Council
NOTES
 1. DO NOT SCALE FROM THIS DRAWING
 2. ANY DISCREPANCIES, ERRORS OR OMISSIONS TO BE BROUGHT TO THE ATTENTION OF THE PROJECT MANAGER.

REGISTRATION
 Reproduced from the Ordnance Survey map with the permission of the controller of H.M. Stationery Office. © Crown copyright and database rights 2020. Ordnance Survey 0100031673.
ISSUE PURPOSE
 FOR ADVERTISING
PROJECT NUMBER
 60599248

ISSUE/REVISION

I/R	DATE	DESCRIPTION
P01	31/01/20	First Issue
P02	28/02/20	TRO Amendment
P03	22/06/20	TRO Amendment
C01	22/06/20	For Advertising
I/R	DATE	DESCRIPTION

Drawn: RS Checked: PE Approved: AC Revision: C01

SHEET TITLE
 TRAFFIC REGULATION ORDER
 BUS LANE
 SHEET 18
SHEET NUMBER
 60599248-ACM-2600-0000-DR-TR-000018

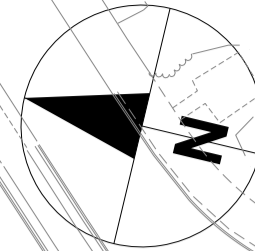

KEY	
	PROPOSED KERBLINE
	BUS LANE - HOURS OF OPERATION 7AM - 7PM CLASS OF EXEMPT VEHICLE - BUS LICENSED TAXI PEDAL CYCLE MOTOR CYCLE
	BUS LANE - HOURS OF OPERATION 24 HOURS CLASS OF EXEMPT VEHICLE - BUS LICENSED TAXI PEDAL CYCLE MOTOR CYCLE
	BUS LANE - HOURS OF OPERATION 7AM - 10AM CLASS OF EXEMPT VEHICLE - BUS LICENSED TAXI PEDAL CYCLE MOTOR CYCLE
	BUS LANE - HOURS OF OPERATION 4PM - 7PM CLASS OF EXEMPT VEHICLE - BUS LICENSED TAXI PEDAL CYCLE MOTOR CYCLE
	BUS GATE - HOURS OF OPERATION 24 HOURS CLASS OF EXEMPT VEHICLE - BUS LICENSED TAXI PEDAL CYCLE MOTOR CYCLE
NOTE: FINAL BUS LANE LAYOUT SHOWN. DRAWING INCLUDES EXISTING AND PROPOSED BUS LANES	

AECOM
 PROJECT
A34 WALSALL TO BIRMINGHAM SPRINT BRT
A3 Scale 1:1250

CLIENT

CONSULTANT
AECOM
 The Colmore Building
 Colmore Circus Queensway
 Birmingham
 T: 01212621900
 www.aecom.com

LOCAL HIGHWAY AUTHORITY

NOTES
 1. DO NOT SCALE FROM THIS DRAWING
 2. ANY DISCREPANCIES, ERRORS OR OMISSIONS TO BE BROUGHT TO THE ATTENTION OF THE PROJECT MANAGER.

REGISTRATION
 Reproduced from the Ordnance Survey map with the permission of the controller of H.M. Stationery Office. © Crown copyright and database rights 2020. Ordnance Survey 0100031673.
ISSUE PURPOSE
 FOR ADVERTISING
PROJECT NUMBER
 60599248

ISSUE/REVISION		
I/R	DATE	DESCRIPTION
P01	30/01/20	First Issue
P02	28/02/20	TRO Amendment
P03	22/06/20	TRO Amendment
C01	22/06/20	For Advertising
Drawn:	Checked:	Approved:
RS	PE	AC
		Revision:
		C01

SHEET TITLE
 TRAFFIC REGULATION ORDER
 BUS LANE
 SHEET 19
SHEET NUMBER
 60599248-ACM-2600-0000-DR-TR-000019



KEY

- PROPOSED KERBLINE
- BUS LANE - HOURS OF OPERATION 7AM - 7PM
CLASS OF EXEMPT VEHICLE - BUS
LICENSED TAXI
PEDAL CYCLE
MOTOR CYCLE
- BUS LANE - HOURS OF OPERATION 24 HOURS
CLASS OF EXEMPT VEHICLE - BUS
LICENSED TAXI
PEDAL CYCLE
MOTOR CYCLE
- BUS LANE - HOURS OF OPERATION 7AM - 10AM
CLASS OF EXEMPT VEHICLE - BUS
LICENSED TAXI
PEDAL CYCLE
MOTOR CYCLE
- BUS LANE - HOURS OF OPERATION 4PM - 7PM
CLASS OF EXEMPT VEHICLE - BUS
LICENSED TAXI
PEDAL CYCLE
MOTOR CYCLE

NOTE: FINAL BUS LANE LAYOUT SHOWN. DRAWING INCLUDES EXISTING AND PROPOSED BUS LANES

Last saved by: EVA.TABOADA(2020-06-22) Last Plotted: 2011-05-25
 Filename: C:\pwworking\aecom_d803_uk\eva.garciaaboa@aecom.com\00128414\60599248-ACM-2600-0000-DR-TR-000020

AECOM
 PROJECT
 A34 WALSALL TO
 BIRMINGHAM
 SPRINT BRT
 A3 Scale 1:1250

CLIENT

 Transport for West Midlands
CONSULTANT
 AECOM
 The Colmore Building
 Colmore Circus Queensway
 Birmingham
 T: 01212621900
 www.aecom.com

LOCAL HIGHWAY AUTHORITY

 Birmingham City Council
NOTES
 1. DO NOT SCALE FROM THIS DRAWING
 2. ANY DISCREPANCIES, ERRORS OR OMISSIONS TO BE BROUGHT TO THE ATTENTION OF THE PROJECT MANAGER.

REGISTRATION
 Reproduced from the Ordnance Survey map with the permission of the controller of H.M. Stationery Office. © Crown copyright and database rights 2020. Ordnance Survey 0100031673.
ISSUE PURPOSE
 FOR ADVERTISING
PROJECT NUMBER
 60599248

ISSUE/REVISION

I/R	DATE	DESCRIPTION
P01	28/02/20	First Issue
P02	22/06/20	TRO Amendment
C01	22/06/20	For Advertising

Drawn: RS	Checked: PE	Approved: AC	Revision: C01
-----------	-------------	--------------	---------------

SHEET TITLE
 TRAFFIC REGULATION ORDER
 BUS LANE
 SHEET 20
SHEET NUMBER
 60599248-ACM-2600-0000-DR-TR-000020

This drawing has been prepared for the use of AECOM's client. It may not be used, modified, reproduced or relied upon by third parties, except as agreed by AECOM or as required by law. AECOM accepts no responsibility, and denies any liability whatsoever, to any party that uses or relies on this drawing without AECOM's express written consent. Do not scale this document. All measurements must be obtained from the stated dimensions.