

KEY	
	PROPOSED KERBLINE
	PROPOSED BACK OF FOOTWAY
	BUS LANE - 24h, 7 days. Class of exempt vehicle: Bus, Licensed taxi, Motorcycles, Pedal Cycles.
	BUS LANE - 24h, 7 days. Class of exempt vehicle: Bus

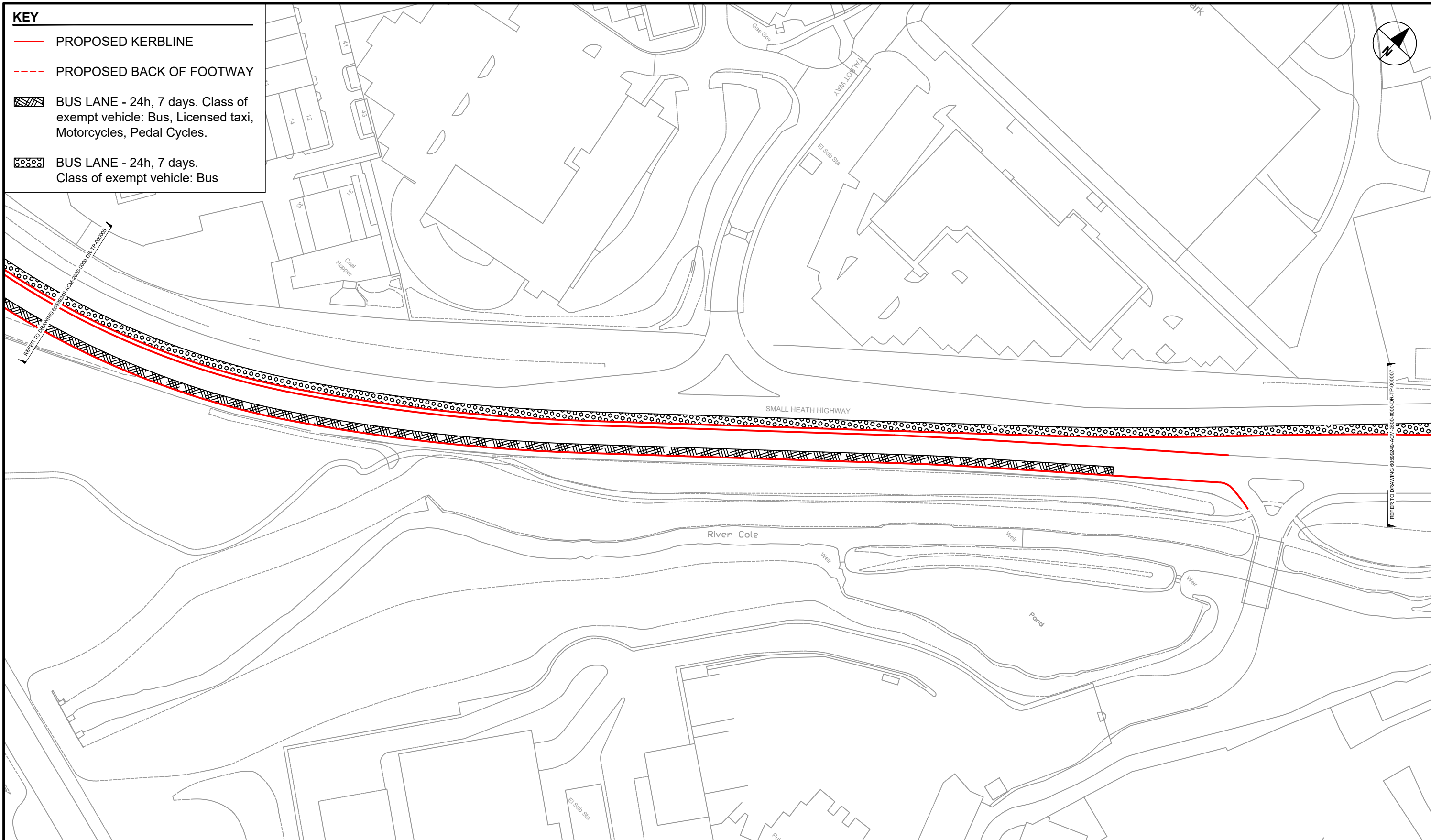

AECOM
PROJECT
 A45 Birmingham to Solihull and Airport SPRINT BRT
A3 Scale 1:1250

CLIENT

CONSULTANT
 AECOM
 The Colmore Building
 Colmore Circus Queensway
 Birmingham
 T: 01212621900
 www.aecom.com

LOCAL HIGHWAY AUTHORITY

NOTES
 1. DO NOT SCALE FROM THIS DRAWING
 2. ANY DISCREPANCIES, ERRORS OR OMISSIONS TO BE BROUGHT TO THE ATTENTION OF THE PROJECT MANAGER.

REGISTRATION
 Reproduced from the Ordnance Survey map with the permission of the controller of H.M. Stationery Office. © Crown copyright and database rights 2020. Ordnance Survey 0100031673.
ISSUE PURPOSE
 FOR ADVERTISING
PROJECT NUMBER
 60599249

ISSUE/REVISION		
I/R	DATE	DESCRIPTION
P01	28/01/20	First Issue
P02	19/06/20	Amendments to Key
C01	19/06/20	For Advertising

Drawn: EMF	Checked: RG	Approved: AC	Revision: C01
---------------	----------------	-----------------	------------------

SHEET TITLE
 BIRMINGHAM CITY COUNCIL
 BUS LANE
 TRAFFIC REGULATION ORDER
 SHEET 6
SHEET NUMBER
 60599249-ACM-2600-0000-DR-TP-000006