

SHEET 15

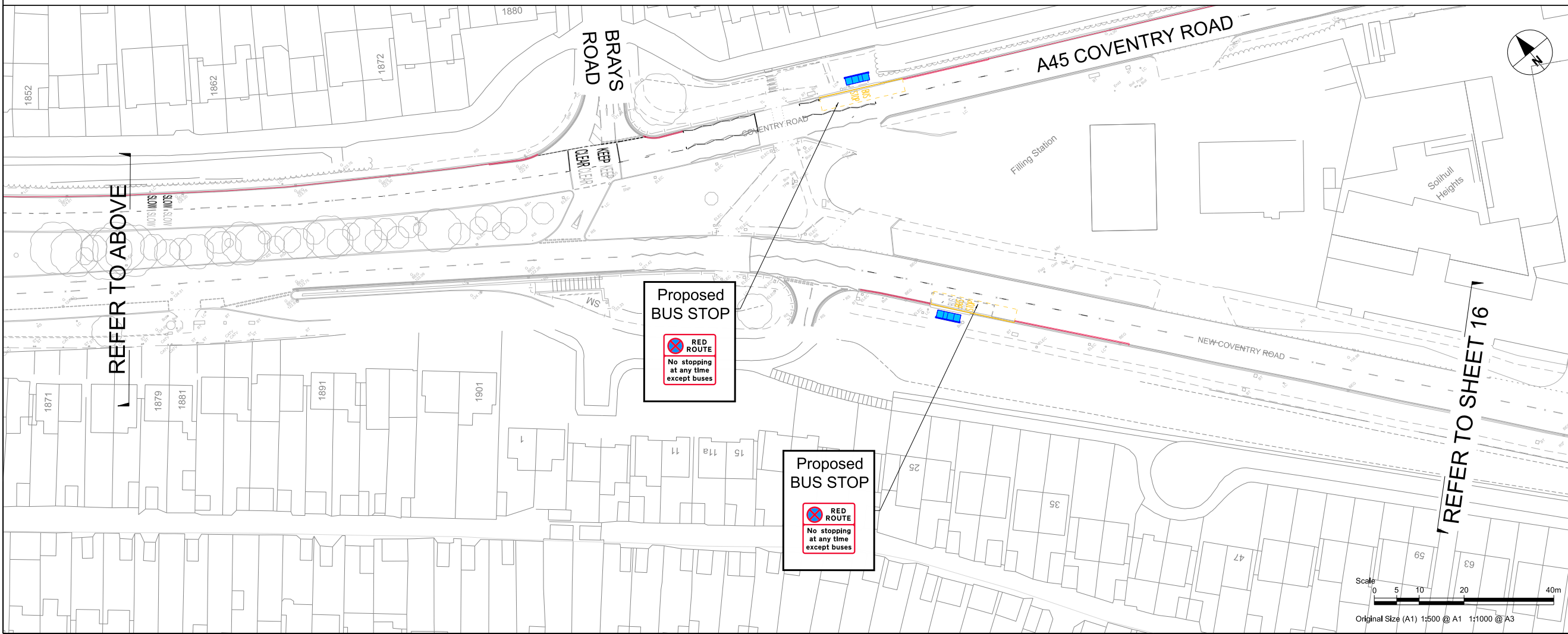
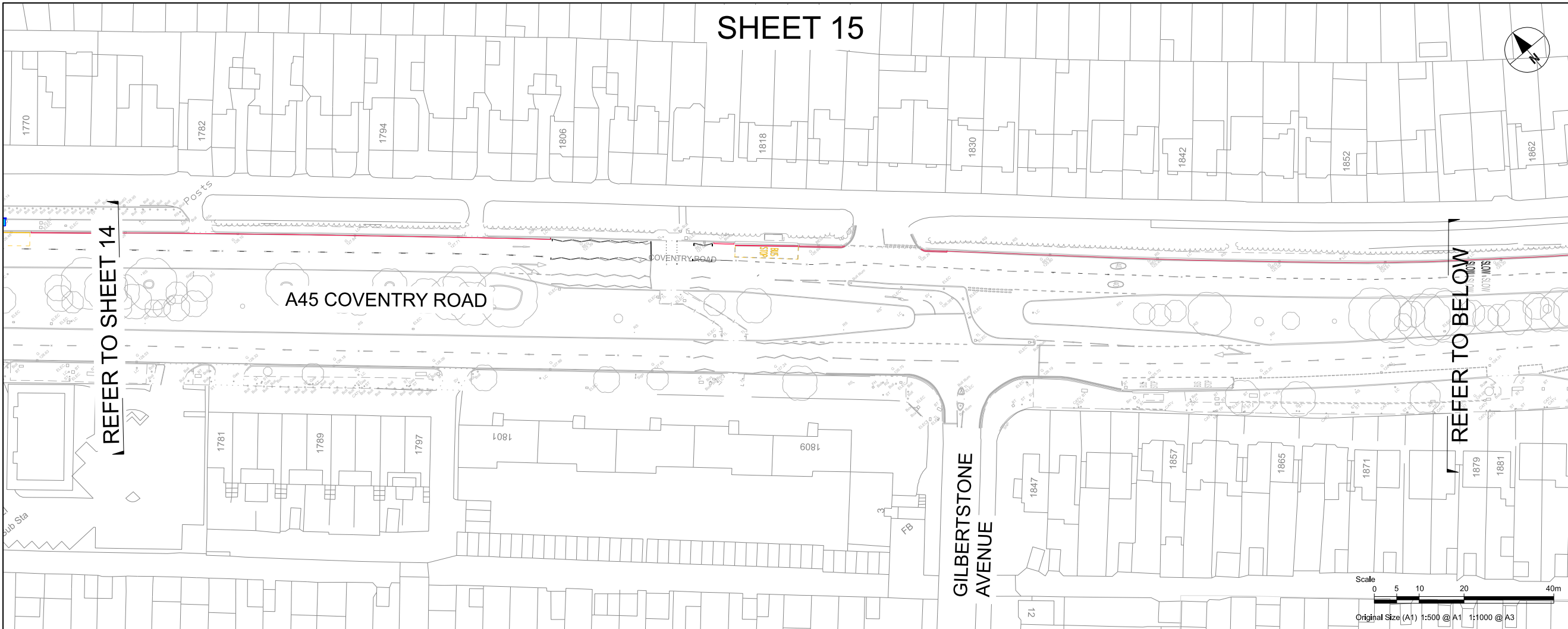

REFER TO SHEET 14

REFER TO BELOW

REFER TO ABOVE

REFER TO SHEET 16



PROJECT
 A45 Birmingham
 to Solihull and Airport
 SPRINT BRT

CLIENT

 Transport for
 West Midlands

CONSULTANT
 AECOM
 The Colmore Building
 Colmore Circus Queensway
 Birmingham
 T: 0121 621 9000
 www.aecom.com

REGISTRATION
 Reproduced from the Ordnance Survey map with the permission of the controller of H.M. Stationery Office. © Crown copyright and database rights 2020. Ordnance Survey 0100031673.

NOTES

1. ALL WORKS SHALL BE CARRIED OUT IN ACCORDANCE WITH THE CONTRACT SPECIFICATION AND THE MANUAL OF CONTRACT DOCUMENTS FOR HIGHWAY WORKS INCLUDING REVISION/AMENDMENTS AND ANY CLIENT SPECIFIC ADDITIONAL OR SUBSTITUTE CLAUSES.
2. ANY DISCREPANCIES, ERRORS OR OMISSIONS TO BE BROUGHT TO THE ATTENTION OF THE PROJECT MANAGER.
3. ALL DIMENSIONS TO BE CHECKED BEFORE COMMENCEMENT OF WORK ON SITE.
4. ALL DIMENSIONS IN METRES UNLESS OTHERWISE STATED.

KEY

- PROPOSED BACK OF FOOTWAY
- PROPOSED KERBLINE
- PROPOSED ROAD MARKING

UNLESS OTHERWISE STATED
 EXISTING RESTRICTIONS WILL
 REMAIN

ISSUE/REVISION

NO	DATE	DESCRIPTION
P01	19/06/20	First Issue
C01	22/06/20	For Advertising
IR	DATE	DESCRIPTION

ISSUE PURPOSE / SUITABILITY
 FOR ADVERTISING

PROJECT NUMBER
 60599249

SHEET TITLE
 SPRINT A45
 TRO CONSULTATION PLANS
 SHEET 15

SHEET NUMBER
 60599249-ACM-2650-BCC-DR-TP-000015

This drawing has been prepared for the use of AECOM's client. It may not be used, modified, reproduced or relied upon by third parties, except as agreed by AECOM or as required by law. AECOM accepts no responsibility, and denies any liability whatsoever, to any party that uses or relies on this drawing without AECOM's express written consent. Do not scale this document. All measurements must be obtained from the stated dimensions.