

FILE PATH: X:\Commissions\CA-02526 - BCR313 Variable 20mph Speed Limit (Swanshurst School and Leisure Centre).dwg

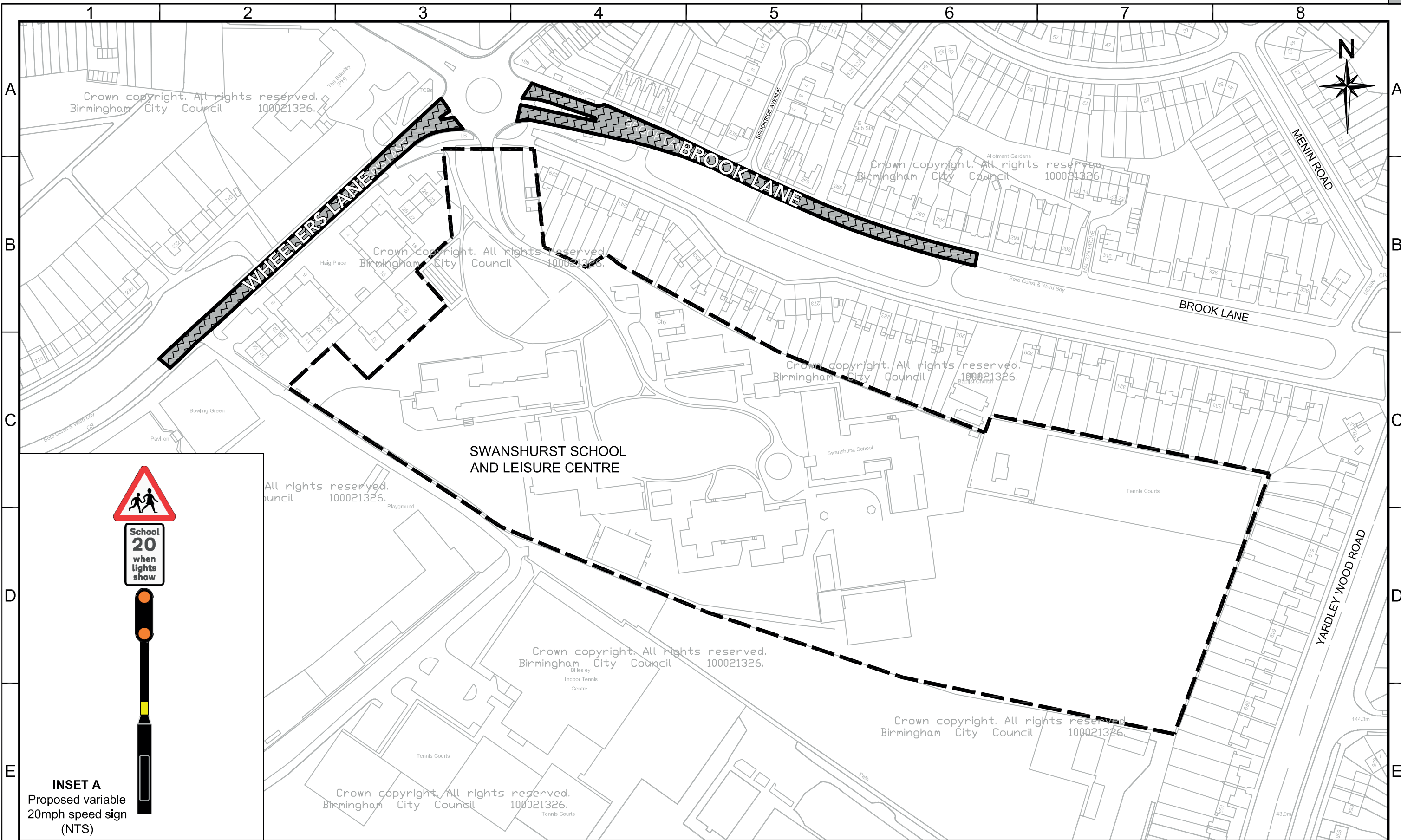

School  
20  
when  
lights  
show



**INSET A**  
Proposed variable  
20mph speed sign  
(NTS)

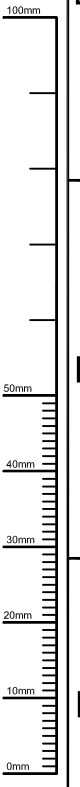

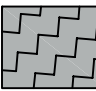
**Key:-**  
 Proposed section of the road affected by the variable 20mph speed limit



SCHEME		VARIABLE 20MPH SPEED LIMITS OUTSIDE SCHOOLS			
DRAWING		SWANSHURST SCHOOL AND LEISURE CENTRE			
DATE	REV.	DESIGNER		REVISIONS	
NH	20/01/17	RSM	20/01/17	PS	20/01/17
DRAWING STATUS					DRN
GENERAL					PM
DWG. No					REVISION
CA-02526_S13_018					-
					SCALE
					1:1000

This map is based upon Ordnance Survey material with the permission of Ordnance Survey on behalf of the Controller of Her Majesty's Stationery Office Crown copyright. Unauthorised reproduction infringes Crown copyright and may lead to prosecution or civil proceedings. B.C.C. Licence No 100021326 Date 2016

A3