

MERE GREEN OUTDOOR GYM

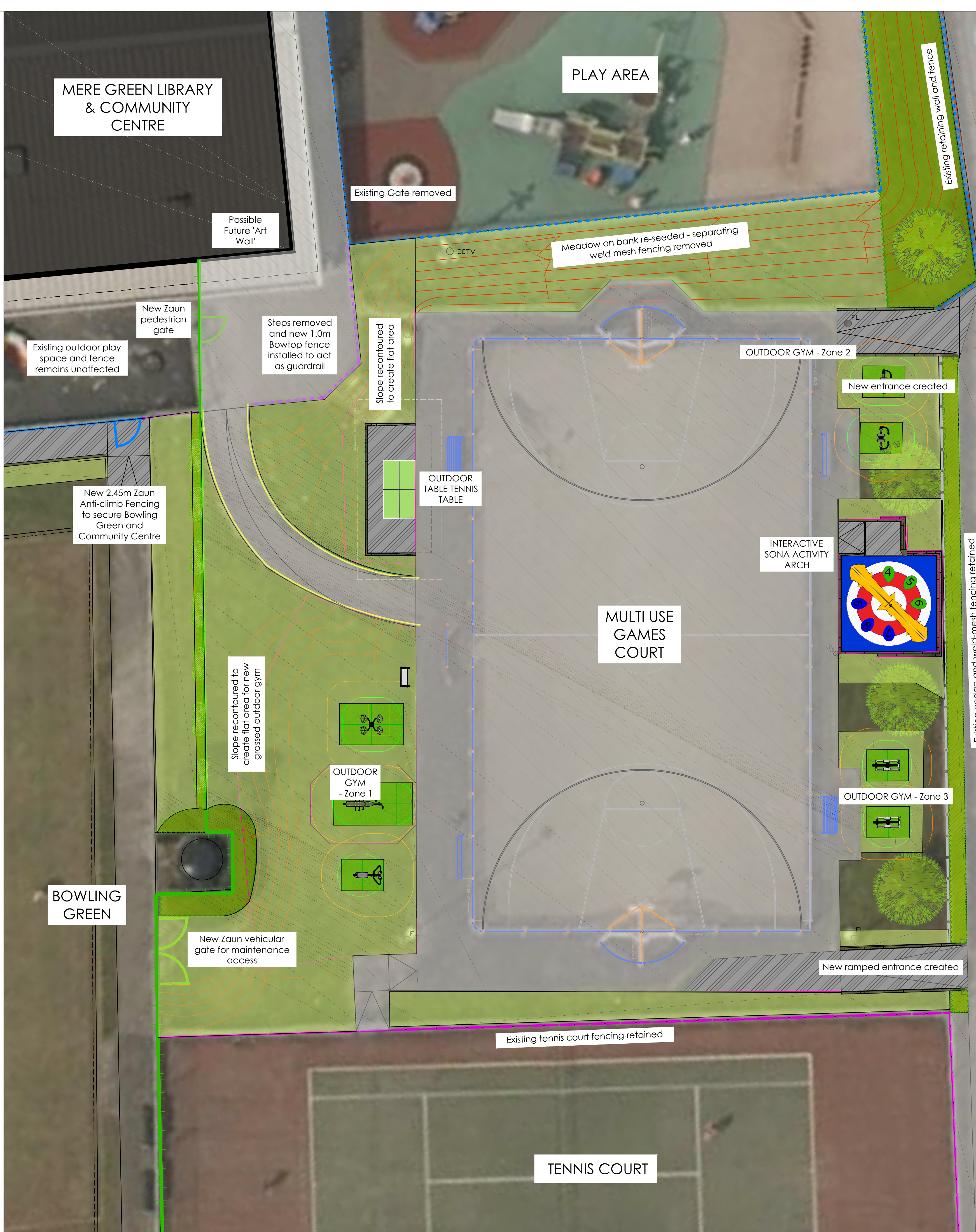

INTERACTIVE PLAY EQUIPMENT

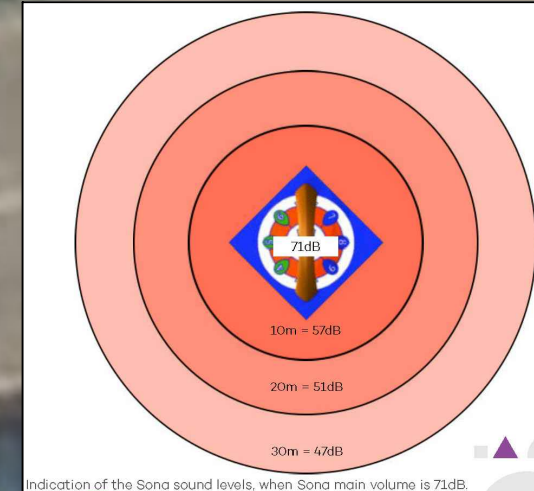

Jupiter Play - My Yalp Sona PLAY ARCH

The Sona is an interactive sound game device of a new generation. The big orange Bow (BigBow) with the colorful play floor (FunkyFloor) underneath is easily recognizable at a distance. With a big push button it is easy to choose one of the various games. The advanced camera technology tracks the movement of the players on the floor, and makes it possible to play the different games.

Playing with the Sona is very simple. The play floor is freely accessible and multiple children can play at the same time. The games are easy to understand and will be clear right away.

- Key points:
- Fun for the young and the elderly
 - Continuously innovative
 - Eye-catcher
 - Fits the imagination world of the new generation of kids
 - Easy with a low threshold
 - Freely accessible, also for handicapped
 - Multiple children at the same time



Games overview

- Freeze**
Freeze is a really fun game to play with a big group. The music starts to play and everyone starts dancing around. When the music stops you hear 'Freeze!' and everybody stands still. If you move your number will be called and you are out. This goes on until there is one winner left!
- DanceBattle**
DanceBattle is an interactive dancing competition, featuring different music styles. You play it with 2 groups. One on the blue numbers, one on green. During the dancing round the movement is monitored. The more movement and variation, the better. After a dancing round the winners are called, and treated with applause!
- ReactionRace**
Reaction Race is a game of speed and agility. The goal is to reach a high level by going as quickly as possible to the number that is being called out. Stay focused! The numbers on the floor are not placed in logical order! The game will go quicker and quicker every level. Who will set the best high score?
- AnimalQuest**
Try and find the right animal sounds! The Sona asks to look for a certain animal. For example: 'Look for the cow!' Having on different spots on the floor triggers different animal sounds. Once you find the right animal, you will hear 'Well done!' The Sona will call out another animal to look for. Beware: The animals hardly ever stay on the same spot!
- ResultRace**
Math, but then outdoor! In ResultRace the goal is to jump to the right solution of the sums that you hear. When you jump on the right number, the next sum is called out. Once you score a couple of good answers in a row, the level goes up. That means you have less and less time! You will not make only running fast, you have got to think fast too!
- Commando**
Commando is all about teamwork. 'On the even numbers! On Blue! Beneath the arch! Off the floor!', are just a few examples of assignments you have to fulfil together with your team. Stay closely together, and listen well! Do this with success, and try to get to a higher level!
- RunTime**
With RunTime the Sona measures the time you set on your own trail. Not restricted to the play floor, you can use the direct surroundings and your fantasy to make a challenging trail. Ready, go! You start and finish beneath the arch, the Sona will call out your time! Who is the fastest?
- Codebreaker**
Try to remember the code the Sona tells you, and walk to the right numbers. Starting with a code of 3 numbers, the code gets longer each level. Focus, and use your memory or team-work to get to a higher level.
- ResultRace Pro**
Just as with ResultRace you have to solve the equations within time to get to a higher level. This time, the equations are more difficult!
- ReactionRace Chinese**
Learn to count in Chinese with this game! (In China, the game is the other way around, in English). First you hear the Chinese number, then the English translation. Go to the right number! Later in the game you only hear Chinese.
- MoveMaker**
Dancing game, doing different moves every round of 1 minute. Who can do the best move?

ART WALL SUGGESTION



GYM EQUIPMENT

HAGS SMP Fitness Range



Lat Pull Down & Chest Press (FS033-055)

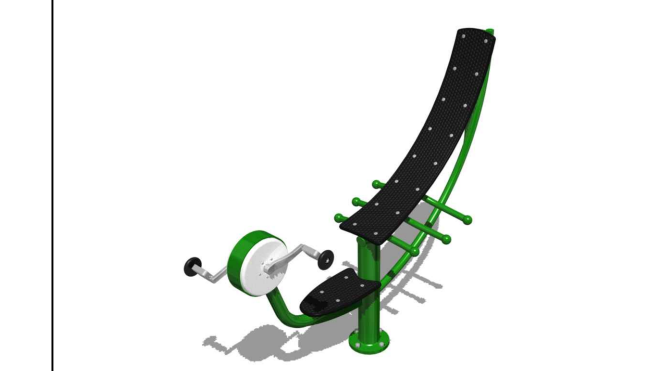

Trinity Cycle (FS016N-008)



Push Hands (FS010N-002)



Rower (FS032-004)



Air Walker (FS031-002)



Ski Stepper (FS001N)



The Landscape Practice Group
Birmingham City Council
PO Box 16837
1 Lancaster Circus
Queensway, Birmingham B4 7DU

T 0121 303 3555
E lpg@birmingham.gov.uk

Client: BCC Parkc

Project: MERE GREEN OUTDOOR GYM

Title: LAYOUT PLAN

Drawing Number: CONSULT01

Revision:

Paper: A1 Scale: 1:100 Drawn by: AWD Check by: Date: 24.08.17 Status: CONSULTATION

0 50mm 100mm DWG File: V:\B0411 Mere Green Outdoor Gym\3 Design\4 Drawings\Layout Plan 23.08.17.dwg

Do not scale from this drawing.