



New carpet tiles in all classrooms, learners room, female toilet lobby, refuge, landings, new stores and 1 to rooms. Prepare floor surface with self leveling screed. Allow for threshold strips at floor finish changes.

New suspended ceilings in all classrooms, learners room, new stores and 1 to rooms. Danoline Micro acoustic perforated 600x600mm tegular edge ceiling tiles with S15 grid.

Form new refuge on each landing with an emergency voice communication (EVC) system to comply with BS 5839-9:2004.

New stud partitions (shown in red): Full height stud partitions 3.6M to structural soffit. 110mm thickness, 2 layer of 15mm wallboard and skim each side of 48mm "C" studs. Assumed requirement 45dB and 30 minutes fire resistance.

Allow for new internal room signage.  
 Allow for new room reference signage.  
 Allow for door ironmongery, locks and suiting.  
 Allow for fire signage.  
 Allow for smoke detection L2.

All new doors and frames (shown in red):  
 Solid core doors with wood veneer finish.  
 Acoustic rating to achieve Rw39 db sound insulation.  
 VP = Vision Panels.  
 FD30S = Half hour fire door with smoke seals.

New acoustic movable wall: Acoustic Products Limited, Series AP 75 Multifold Sliding Partition System. Including floor track and additional support structure for head track.

Schematic drawing Do Not Scale.

All details and dimensions will be subject to confirmation by a future, more detailed investigations and surveys.

Allow for re-decoration throughout:  
 Walls: Dulux diamond matt emulsion, Colour Reference RAL 9010 (White). Also additional colours for branding and zoning.

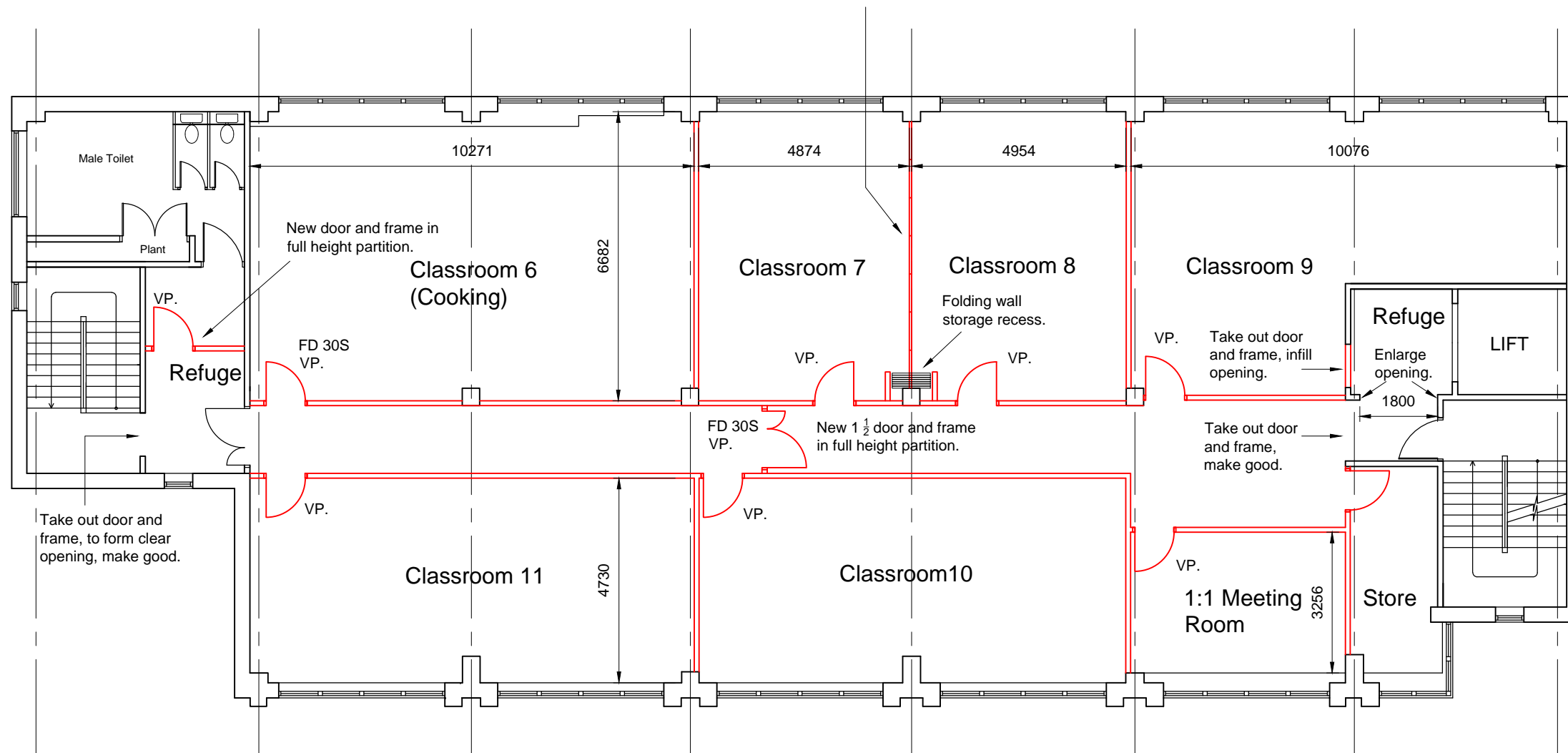

SECOND FLOOR

NOTE  
 ALL DIMENSIONS TO BE CHECKED ON SITE  
 NO DIMENSIONS TO BE SCALED FROM THIS DRAWING  
 THIS DRAWING IS TO BE READ IN CONJUNCTION WITH RELEVANT CONSULTANTS DRAWINGS

© Crown Copyright and database right 2015. Ordnance Survey 100021326 (2015). You are not permitted to copy, sub-licence, distribute or sell any of this data to third parties in any form.  
 CHECK GUIDANCE BEFORE ISSUING O.S. DATA IN DWG FORMAT

FIRST ISSUE

REV	DATE	DESCRIPTION	CHKD	DRN

FEASIBILITY



3rd FLOOR, 1 LANCASTER CIRCUS, QUEENSWAY, BIRMINGHAM, B4 7DJ  
 T 0121 303 6719 F 0121 303 7501

CLIENT  
 BPS

PROJECT  
 CIVIC HOUSE  
 107 SUTTON NEW ROAD

JOB NUMBER:	93018
DATE	11 MAR 2015
SCALE:	1:125 @A3
DRAWN	RSM
CHECKED	
FILE NAME	93018-010-012_Proposed_Plans

DRAWING  
 PROPOSED SECOND  
 FLOOR PLAN

DRAWING NUMBER	REVISION
----------------	----------

93018\A\012

COPYRIGHT©