



Unisex Toilets:
 Washbasins: Armitage Shanks Contour Range, Contour 21 370mm hand rinse basin Reference S21540 complete with one centre taphole and chrome plated cylindrical shallow bottle trap
 Taps: Jasper Morrison single lever basin mixer tap Reference E6397AA

WCs: Type: Armitage Shanks Contour 21 back to wall WC pan Reference S309501 complete with cover and seat and concealed cistern with Armitage Shanks chrome plated dual flush plate Reference S4397 (AA). Allow for IPS system and all necessary pipework and drainage. Connect into existing stub stack.

Cleaners:
 Armitage Shanks Birch Cleaner's Sink with fitted bucket grating Reference S5915 complete with stainless steel legs
 Taps: Armitage Shanks Alterna Quadrant bib taps Reference S7190

Upgrade accessible toilet facility: Renew toilet seat with contrasting toilet seat in colour to match grab rails. Renew alarm string pull and test alarm operation. Renew air admittance valve.

Ceramic tiling: Make good ceramic tiles to cleaners and provide new splashbacks to WHBs in unisex toilets cleaners sink.

Toilets lobby, Unisex Toilets and existing accessible toilet: Vinyl flooring: Altro Suprema non slip sheet safety flooring, Colour Reference from full colour range. Cove skirting.

Form new refuge on each landing with an emergency voice communication (EVC) system to comply with BS 5839-9:2004.

New stud partitions (shown in red):
 Full height stud partitions 3.6M to structural soffit. 110mm thickness, 2 layer of 15mm wallboard and skim each side of 48mm "C" studs. Assumed requirement 45dB and 30 minutes fire resistance.

New suspended ceilings in all classrooms, learners room, new stores and 1 to rooms. Danoline Micro acoustic perforated 600x600mm tegular edge ceiling tiles with S15 grid.

New carpet tiles in all classrooms, learners room, female toilet lobby, refuge, landings, new stores and 1 to rooms. Prepare floor surface with self leveling screed. Allow for threshold strips at floor finish changes.

New suspended ceilings in toilets zone and existing accessible WC. Armstrong metal Orcal Axial suspended ceiling.

All new doors and frames (shown in red):
 Solid core doors with wood veneer finish. Acoustic rating to achieve Rw39 db sound insulation. VP = Vision Panels. FD30S = Half hour fire door with smoke seals.

Schematic drawing Do Not Scale.

All details and dimensions will be subject to confirmation by a future, more detailed investigations and surveys.

Allow for re-decoration throughout:
 Walls: Dulux diamond matt emulsion, Colour Reference RAL 9010 (White). Also additional colours for branding and zoning.

Allow for fire signage.

Allow for smoke detection L2.

Allow for new internal room signage.

Allow for new room reference signage.

Allow for door ironmongery, locks and suiting.

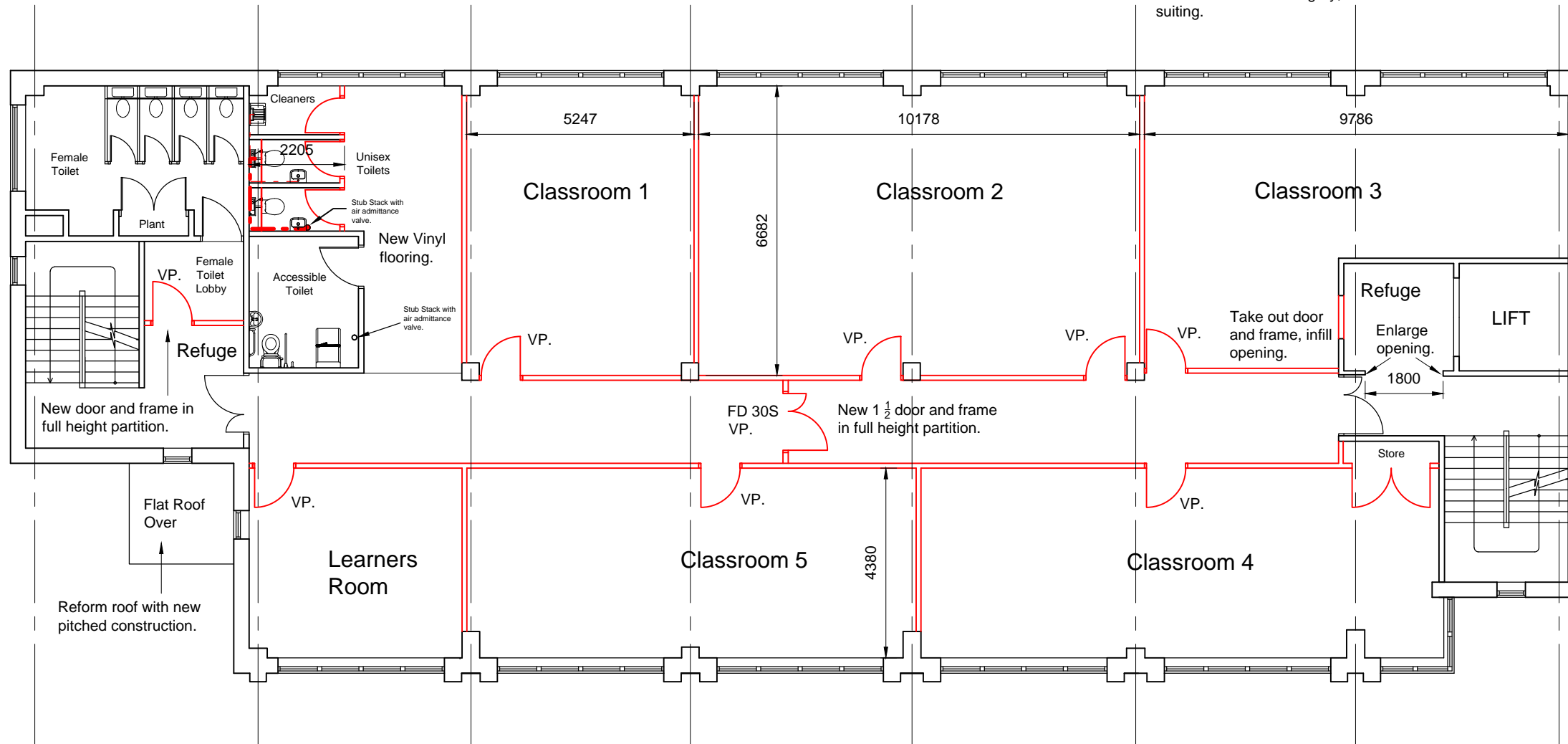

FIRST FLOOR

NOTE
 ALL DIMENSIONS TO BE CHECKED ON SITE
 NO DIMENSIONS TO BE SCALED FROM THIS DRAWING
 THIS DRAWING IS TO BE READ IN CONJUNCTION WITH RELEVANT CONSULTANTS DRAWINGS

© Crown Copyright and database right 2015. Ordnance Survey 100021326 (2015). You are not permitted to copy, sub-licence, distribute or sell any of this data to third parties in any form.
 CHECK GUIDANCE BEFORE ISSUING O.S. DATA IN DWG FORMAT

FIRST ISSUE

REV	DATE	DESCRIPTION	CHKD	DRN

FEASIBILITY

Acivico
 3rd FLOOR, 1 LANCASTER CIRCUS, QUEENSWAY,
 BIRMINGHAM, B4 7DJ
 T 0121 303 6719 F 0121 303 7501

CLIENT
 BPS

PROJECT
 CIVIC HOUSE
 107 SUTTON NEW ROAD

JOB NUMBER:	93018
DATE	11 MAR 2015
SCALE:	1:125 @A3
DRAWN	RSM
CHECKED	
FILE NAME	93018-010-012_Proposed_Plans

DRAWING
 PROPOSED FIRST
 FLOOR PLAN

DRAWING NUMBER REVISION

93018\A\011

COPYRIGHT©