



**1** THE EXISTING FORMER TENNIS COURTS AT CLYDESDALE/ THE FARRIERS WESTERN END OF SCP, OPTIONS FOR THE FUTURE:

- UPGRADE TO TENNIS COURTS
- CONVERT TO GRASS/ WILDFLOWER
- CAR PARK AREA.



**2** THE FORMER PLAYGROUND CONCRETE CIRCLE: REMOVE & CONVERT TO GRASS/ WILDFLOWER



**3** THE FORMER TENNIS COURTS NEAR TO THE FARM COULD BE A TEMPORARY OVERFLOW CAR PARK IN THE SUMMER. DURING THE WINTER WHEN THE FIELDS' GROUND IS FROZEN THE CATTLE AND OTHER ANIMALS CAN BE KEPT ON THE HARD STANDING.

**OLD RECTORY FARM**



**5** ONE OF MANY ENTRANCE ROUTES INTO THE COUNTRY PARK WHICH WILL NEED REGRADING, RESURFACING AND ANTI MOTORBIKE GATE INSTALLED.

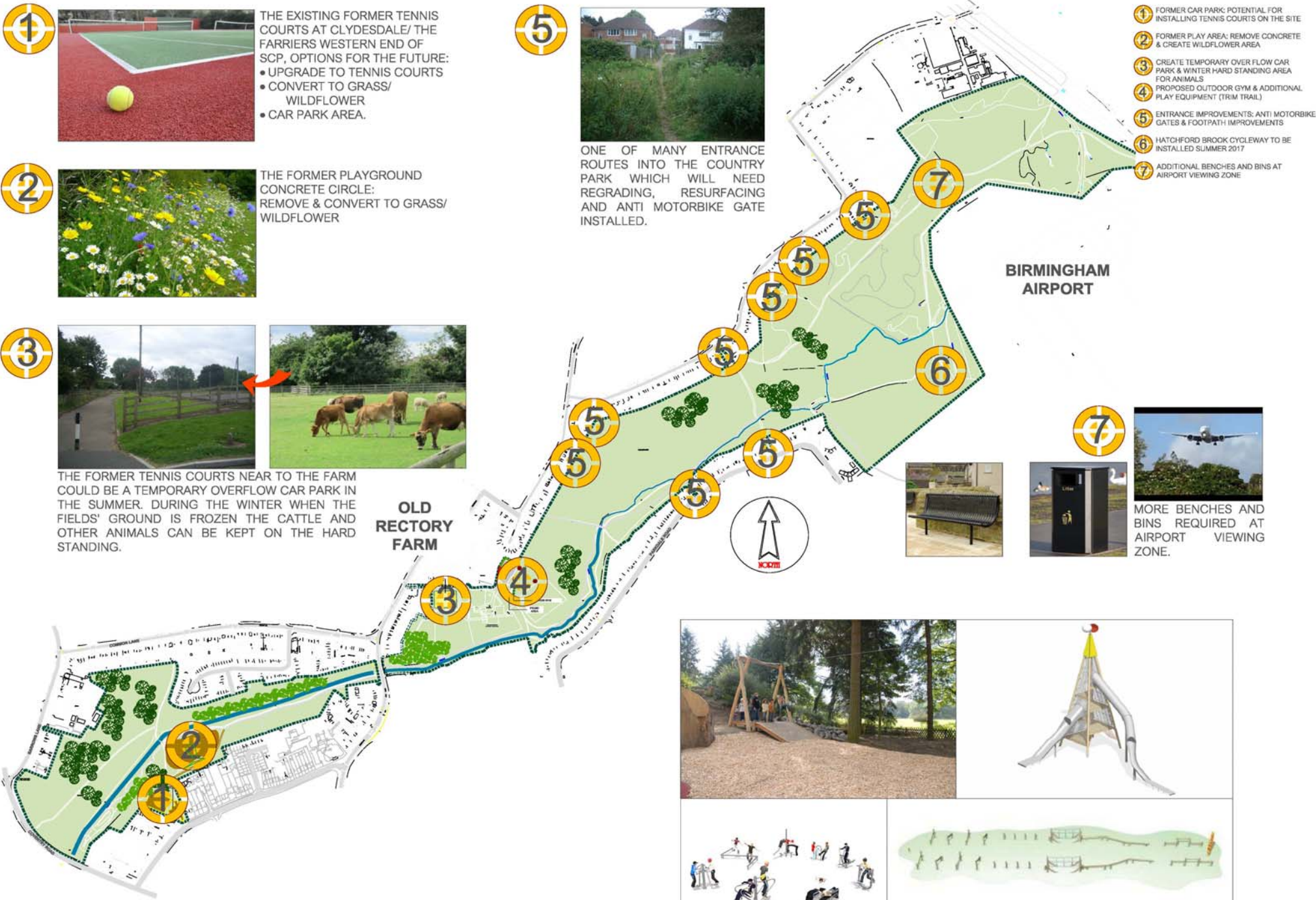

- 1** FORMER CAR PARK: POTENTIAL FOR INSTALLING TENNIS COURTS ON THE SITE
- 2** FORMER PLAY AREA: REMOVE CONCRETE & CREATE WILDFLOWER AREA
- 3** CREATE TEMPORARY OVER FLOW CAR PARK & WINTER HARD STANDING AREA FOR ANIMALS
- 4** PROPOSED OUTDOOR GYM & ADDITIONAL PLAY EQUIPMENT (TRIM TRAIL)
- 5** ENTRANCE IMPROVEMENTS: ANTI MOTORBIKE GATES & FOOTPATH IMPROVEMENTS
- 6** HATCHFORD BROOK CYCLEWAY TO BE INSTALLED SUMMER 2017
- 7** ADDITIONAL BENCHES AND BINS AT AIRPORT VIEWING ZONE

**BIRMINGHAM AIRPORT**



**7** MORE BENCHES AND BINS REQUIRED AT AIRPORT VIEWING ZONE.

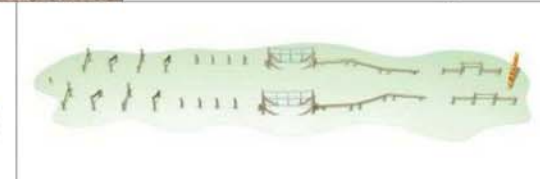
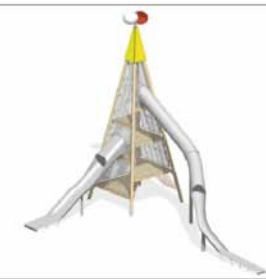

**4** IDEAS FOR THE PLAY AREA EXTENSION & OUTDOOR GYM EQUIPMENT. A TRIM TRAIL IS PROPOSED ON THE EXISTING GRASS AREA IN FRONT OF THE CAR PARK